

NO.	DATE	DESCRIPTION

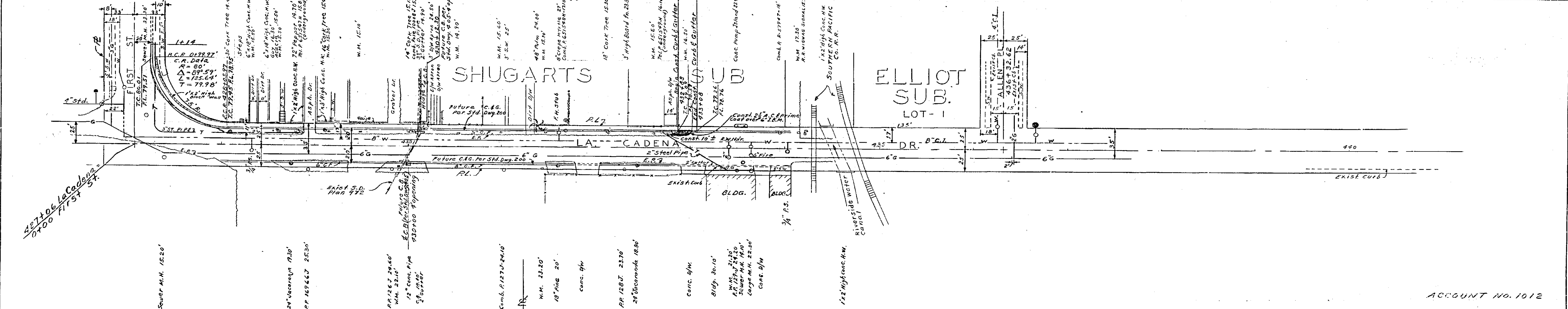

NO.	DATE	DESCRIPTION

NOTE:
All construction shall be in accordance with Standards and Specifications No. 461 of the City of Riverside, Department of Public Works.

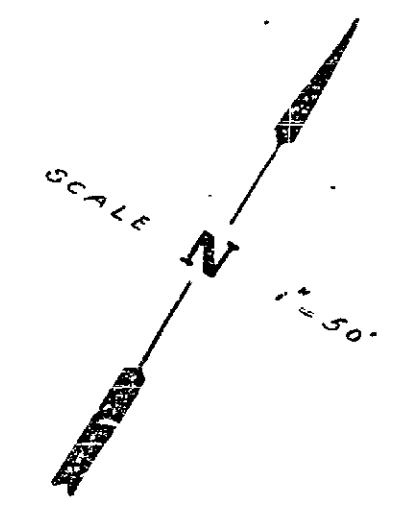
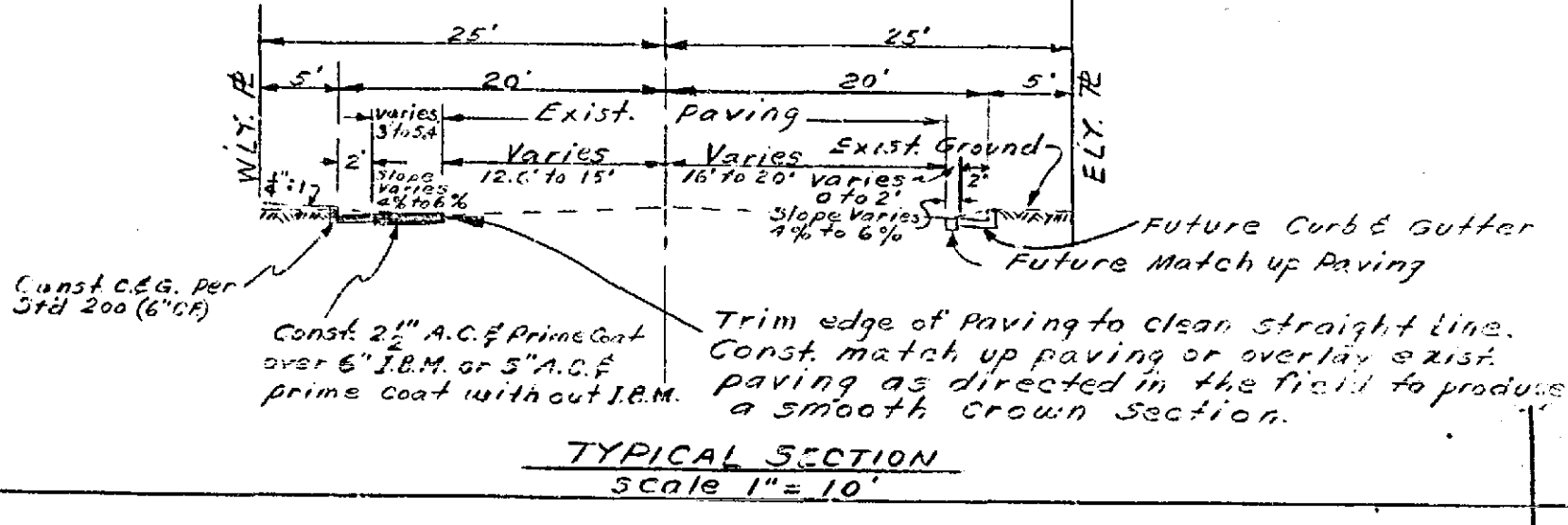

REVISIONS			CITY OF RIVERSIDE CALIFORNIA DEPARTMENT OF PUBLIC WORKS	
MARK	DATE	DESCRIPTION	LA CADENA DR. FIRST ST. TO ALLEN PL.	

DESIGNED BY <i>M.B.</i>	CHECKED BY <i>E.H.</i>	APPROVED BY <i>A. Martell</i> DIRECTOR OF PUBLIC WORKS	R-530 SHEET 1 OF 1
RECOMMENDED BY <i>A. Martell</i> ASSISTANT CITY ENGINEER	DATE 8-14-62		