

B.M. 859.85 S.F.L. in North End of West Headwall of Culvert Mary St. and Riv. Water Co. Canal P2-13
 F.B.
 Scale Horizontal: 1" = 20'
 Vertical: 1" = 2'

Estimated Pay Quantities

Remove Bituminous Paving	297	S.Y.
Aggregate Base Material	66	C.Y.
Asphalt Concrete	54	Ton
Curb and Gutter	134	L.F.
Sidewalk	150	S.F.
D/W Approach	145	S.F.
Bridge		Lump Sum

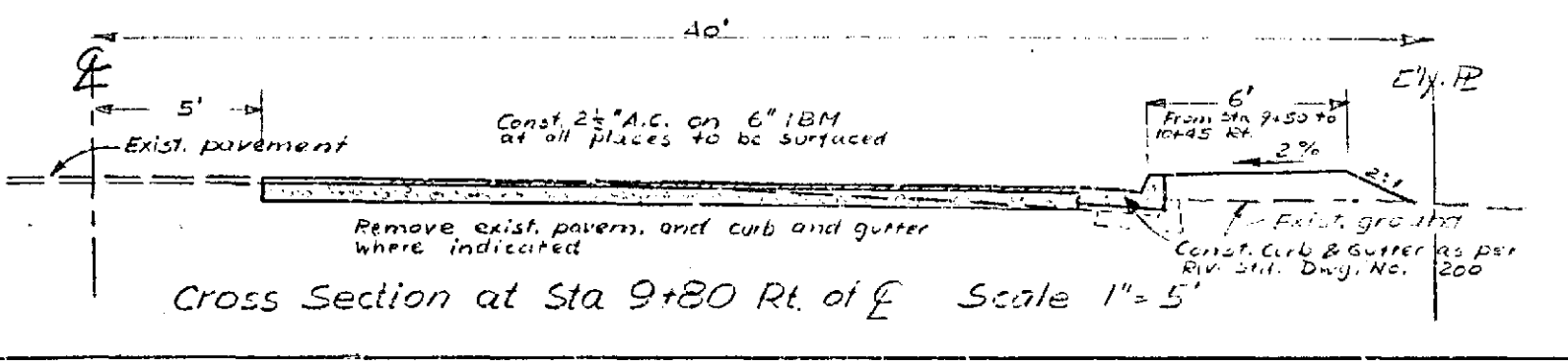
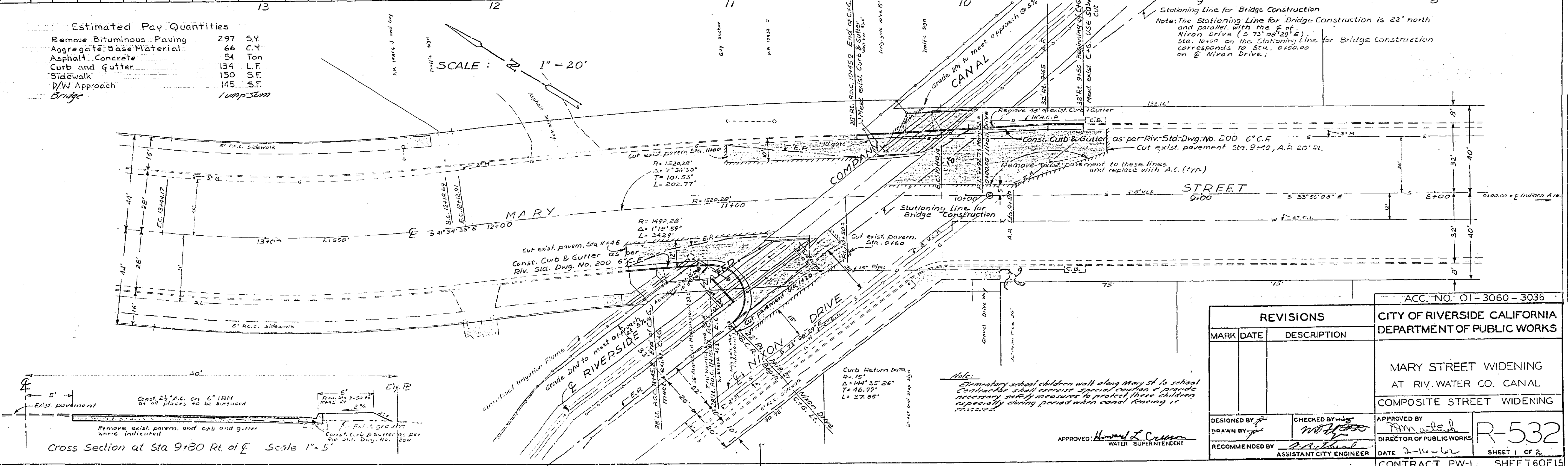

REVISIONS		
MARK	DATE	DESCRIPTION

ACC. NO. 01-3060-3036

CITY OF RIVERSIDE CALIFORNIA
 DEPARTMENT OF PUBLIC WORKS

MARY STREET WIDENING
 AT RIV. WATER CO. CANAL
 COMPOSITE STREET WIDENING

DESIGNED BY: *[Signature]*
 DRAWN BY: *[Signature]*
 RECOMMENDED BY: *[Signature]*
 ASSISTANT CITY ENGINEER

CHECKED BY: *[Signature]*
 WATER SUPERINTENDENT

APPROVED BY: *[Signature]*
 DIRECTOR OF PUBLIC WORKS

DATE: 2-16-62

R-532
 SHEET 1 OF 2
 CONTRACT PW-1, SHEET 6 OF 15

NO.	DATE	DESCRIPTION

NO.	DATE	DESCRIPTION

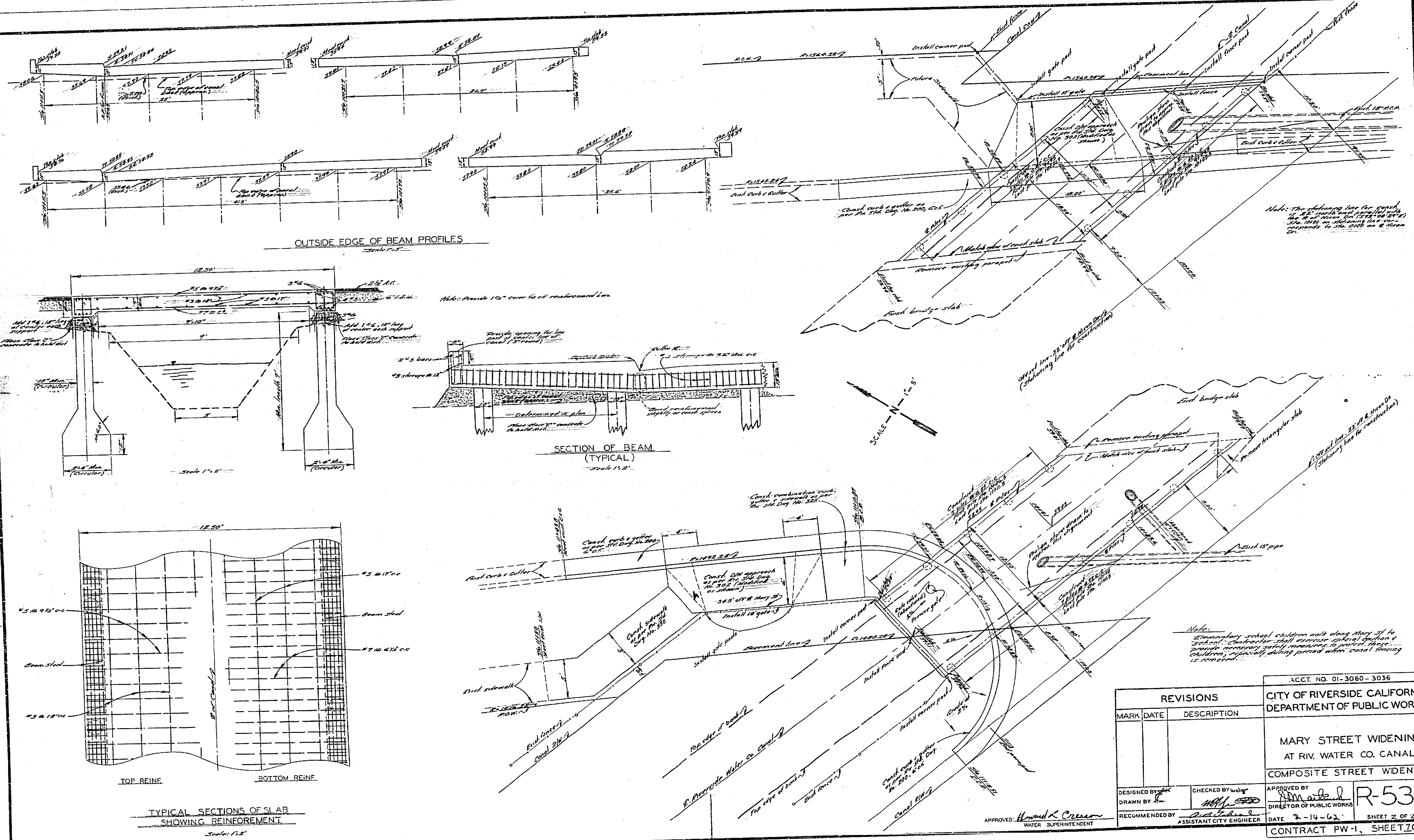

Note: The stationing here for points to 25' north and parallel with the 2nd Main Dr. (248+00 to 248+250) corresponds to the 2485 on E Main Dr.

Note: Proposed line 25' off E Main Dr. (stationing line for construction)

Note: Elementary school children walk along Mary St. to school. Contractor shall exercise special caution to provide necessary safety measures to protect these children, especially during period when canal fencing is removed.

ACCT. NO. 01-3060-3036		CITY OF RIVERSIDE CALIFORNIA DEPARTMENT OF PUBLIC WORKS	
MARY STREET WIDENING AT RIV. WATER CO. CANAL COMPOSITE STREET WIDENING			
DESIGNED BY [Signature]		APPROVED BY [Signature]	
DRAWN BY [Signature]		DIRECTOR OF PUBLIC WORKS	
RECOMMENDED BY [Signature]		DATE 2-14-62	
ASSISTANT CITY ENGINEER		SHEET 2 OF 2	
CONTRACT PW-1, SHEET 2 OF 15			

APPROVED: Howard K. Creamer
WATER SUPERINTENDENT