

W 14 R.

E 14 R.

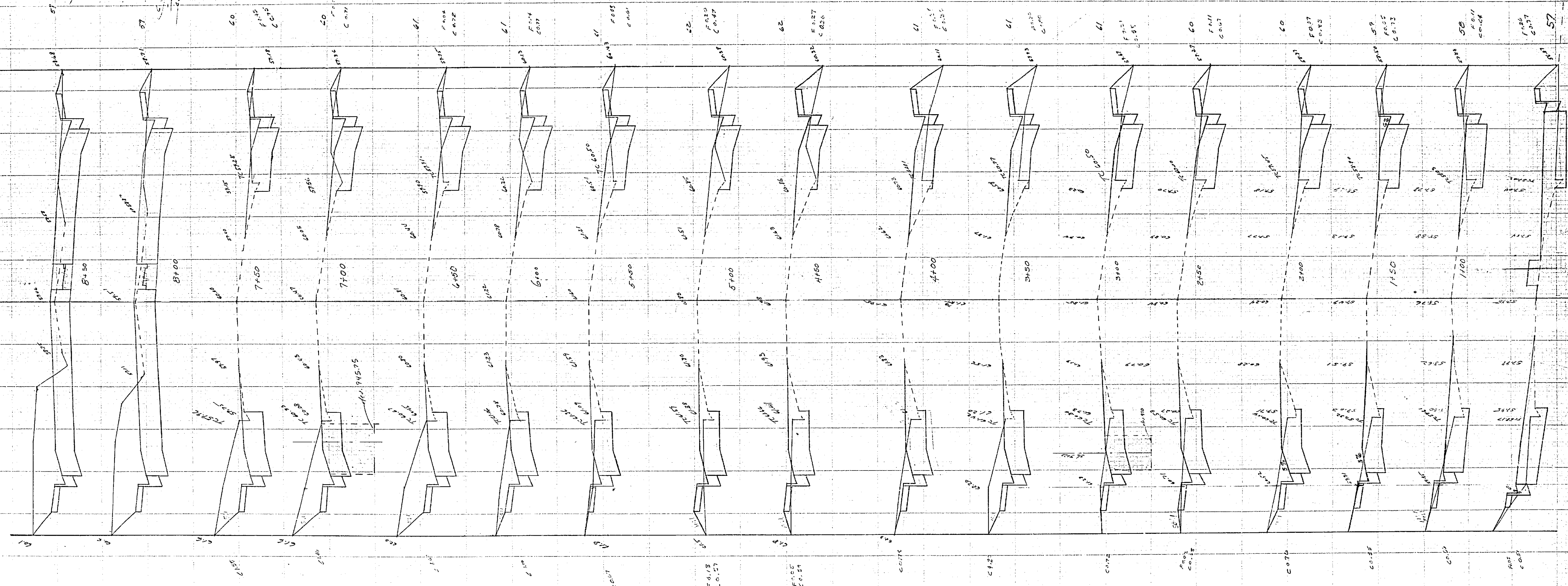

2-536  
 Scale  
 1/2" = 1'-0"  
 1/4" = 1'-0"  
 Chicago Ave. Widening  
 8th St. to 10th St.  
 1909, Plotted E.M.

CLEVELAND, OHIO

CLEVELAND, OHIO

CLEVELAND, OHIO

R-536



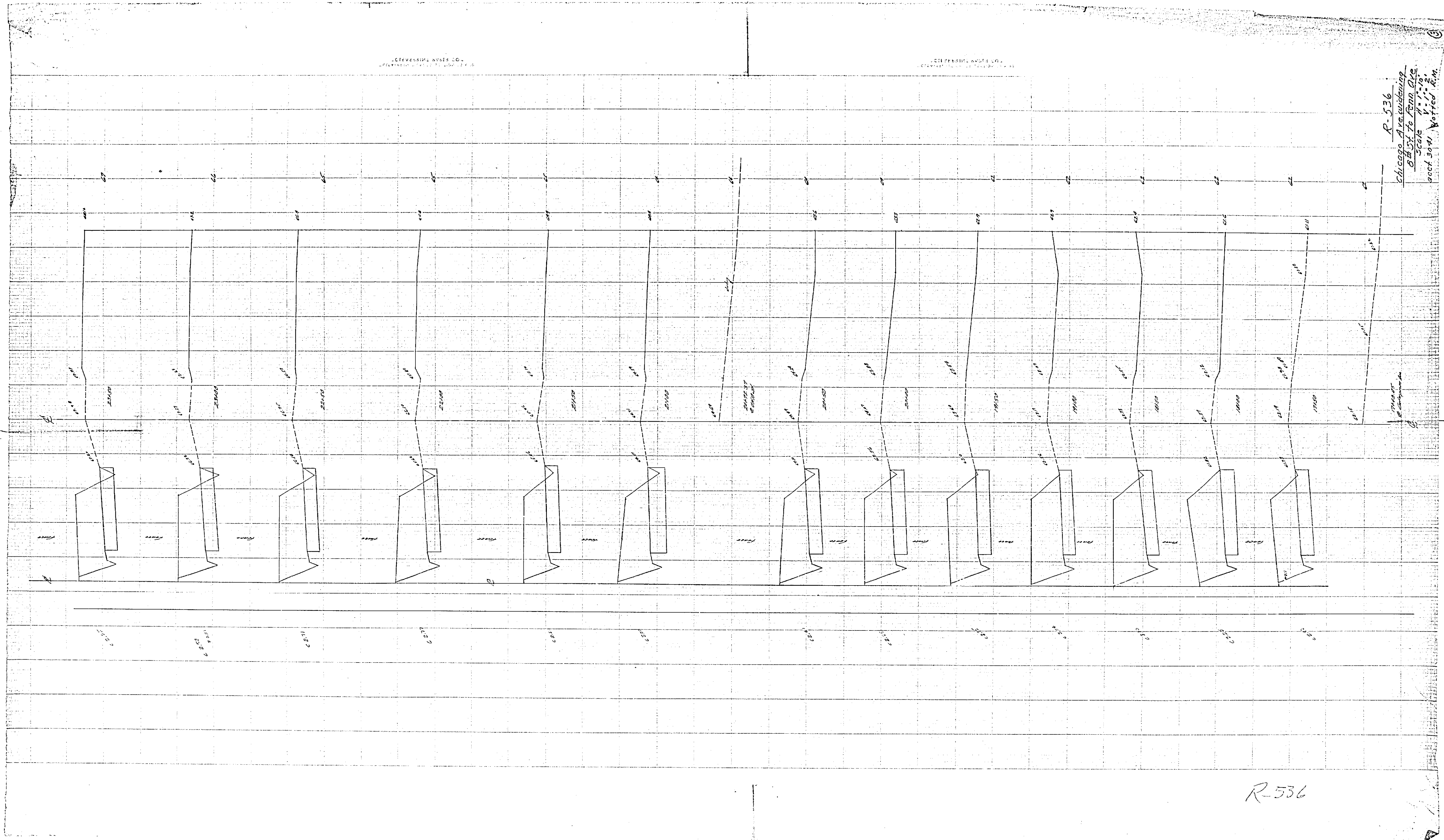

R-536  
Chicago Ave. widening  
8th St. to Fern Ave.  
SCALE 1" = 20'  
sheet 30 of 31

R-536

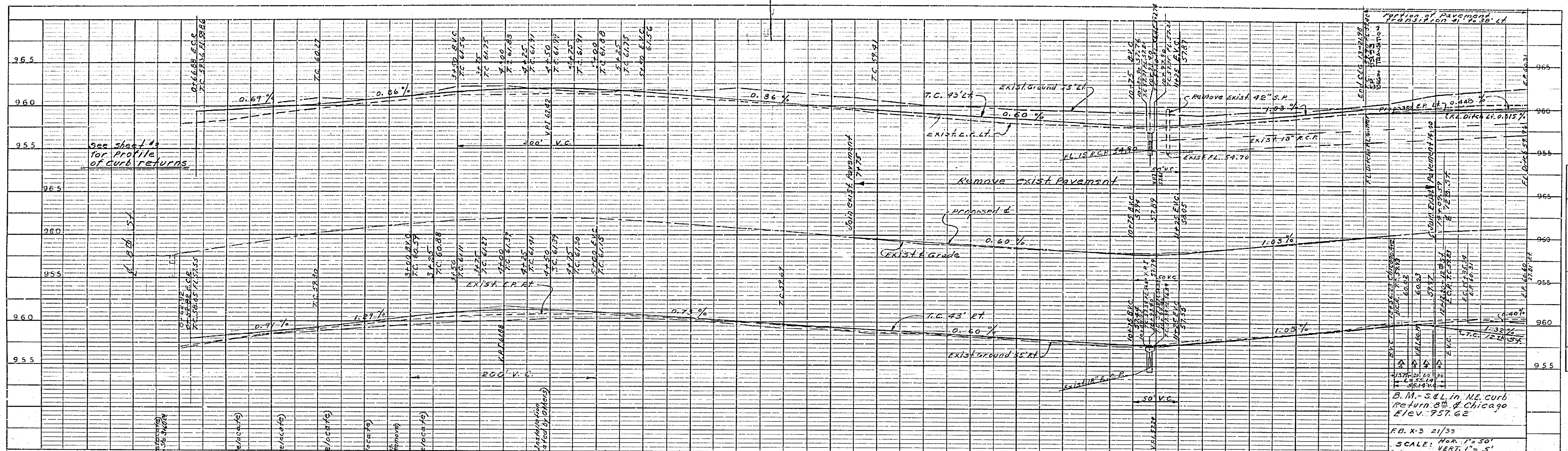

| NO. | DATE | DESCRIPTION |
|-----|------|-------------|
| 1   |      | AS SHOWN    |
| 2   |      | REVISION    |
| 3   |      | REVISION    |
| 4   |      | REVISION    |
| 5   |      | REVISION    |

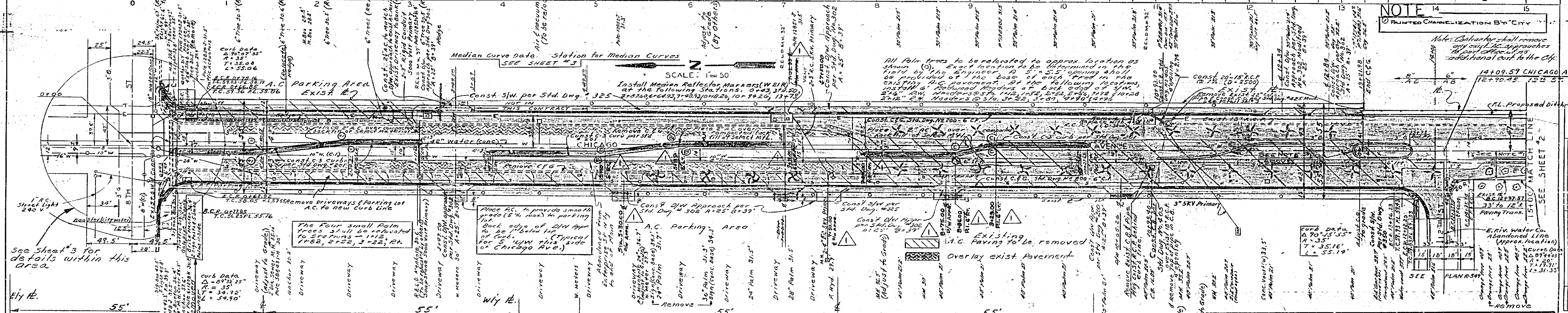

| NO. | DATE | DESCRIPTION |
|-----|------|-------------|
| 1   |      | AS SHOWN    |
| 2   |      | REVISION    |
| 3   |      | REVISION    |
| 4   |      | REVISION    |
| 5   |      | REVISION    |

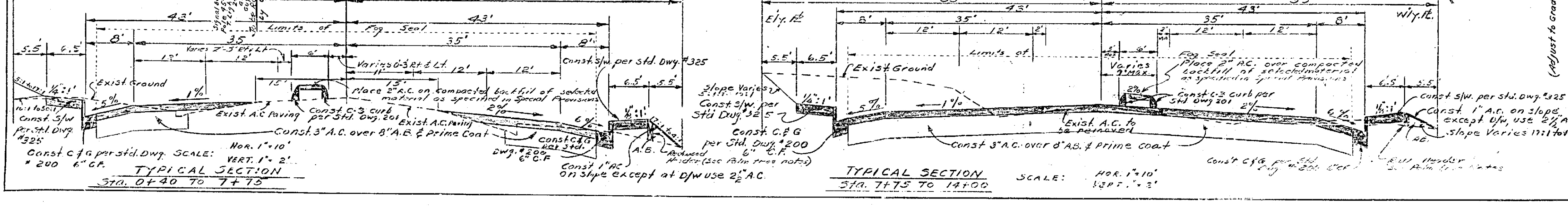

| REVISIONS   |              |                           | CITY OF RIVERSIDE, CALIFORNIA<br>DEPARTMENT OF PUBLIC WORKS |      |
|-------------|--------------|---------------------------|---|------|
| MARK        | DATE         | DESCRIPTION               | MAJOR CITY STREET PROJ. NO. 114                             |      |
| 1           | 10-15-67     | REVISED MEDIAN CURVE DATA | CHICAGO AVE.  |      |
| 2           | 10-15-67     | REVISED MEDIAN CURVE DATA | EIGHTH ST. TO PENN. AVE.                                    |      |
| 3           | 10-15-67     | REVISED MEDIAN CURVE DATA | EIGHTH ST. TO TWELFTH ST.                                   |      |
| DESIGNED BY | SUBMITTED BY | APPROVED BY               | PROJ. NO.   | 3041 |
| DRAWN BY    | PARK DEPT.   | TRAFFIC DIV.              | R-536   |      |
| CHECKED BY  | DATE         | 10-15-67                  | SHEET 1 OF 3  |      |

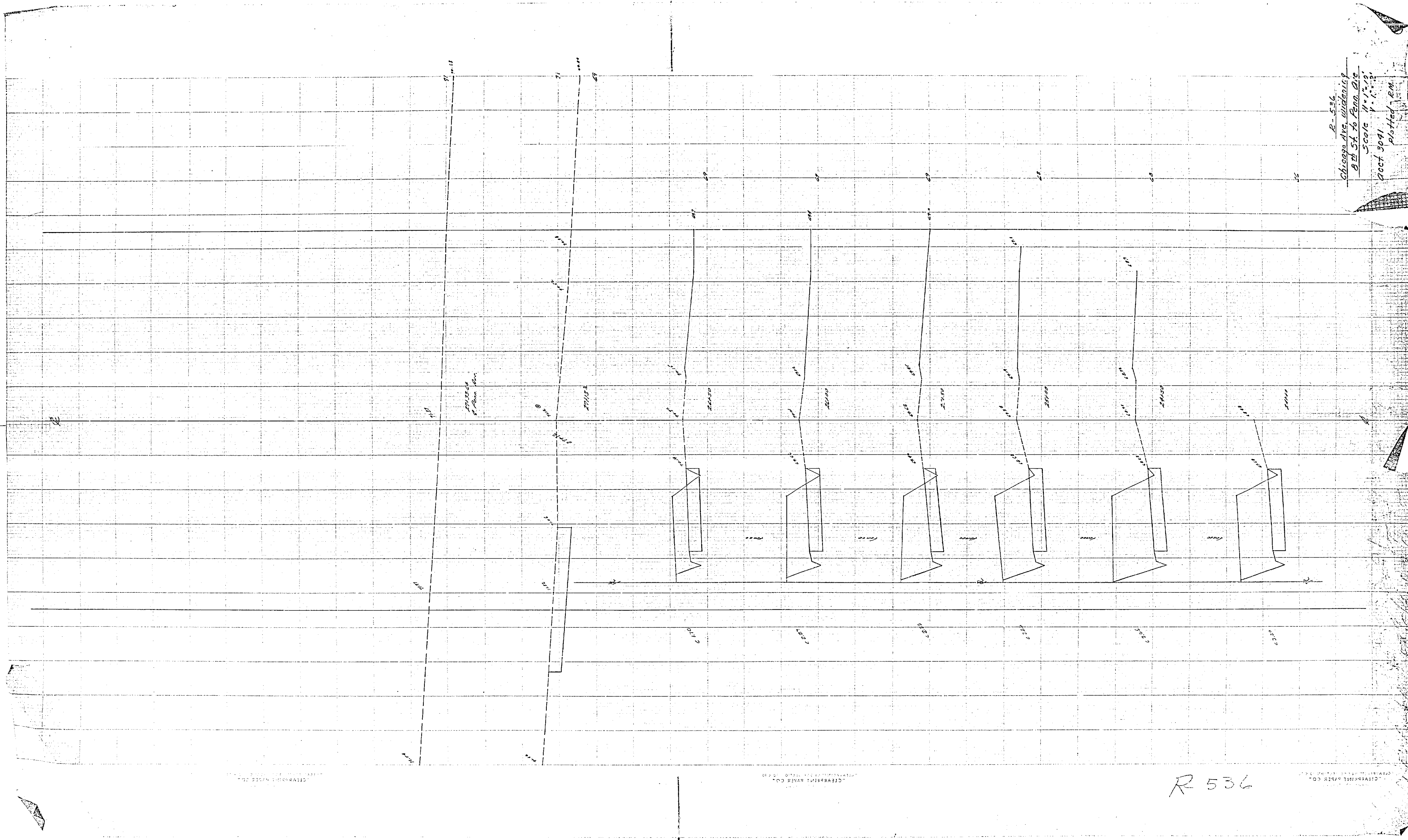

R-536  
Chicago Ave. Widening  
8th St. to 7th St.  
Scale 1/4" = 1'-0"  
Prof. 30d. 1.1.13  
Plotted, P.M.

R 536

CHICAGO PLANING CO.  
110 N. WABASH ST. CHICAGO, ILL.

CHICAGO PLANING CO.  
110 N. WABASH ST. CHICAGO, ILL.

CHICAGO PLANING CO.  
110 N. WABASH ST. CHICAGO, ILL.

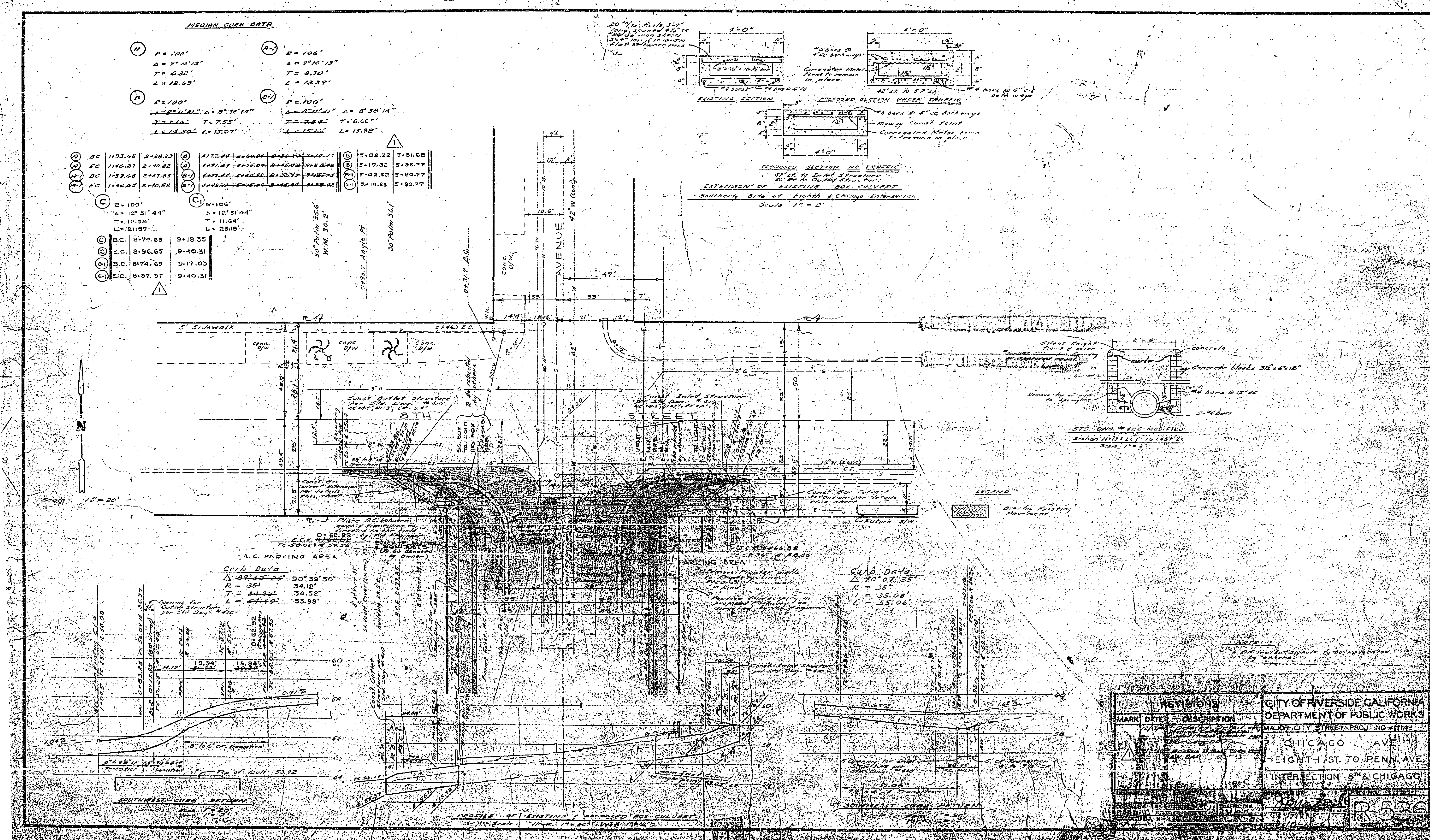

**MEDIAN CURB DATA**

|                |                |
|----------------|----------------|
| (H) R=100'     | (RV) R=106'    |
| Δ = 7° 14' 13" | Δ = 7° 14' 13" |
| T = 6.32'      | T = 6.70'      |
| L = 12.63'     | L = 13.39'     |

  

|                |                |
|----------------|----------------|
| (B) R=100'     | (BV) R=100'    |
| Δ = 9° 38' 14" | Δ = 9° 38' 14" |
| T = 7.55'      | T = 6.00'      |
| L = 15.30'     | L = 15.98'     |

|                  |             |             |             |             |             |             |             |             |              |
|------------------|-------------|-------------|-------------|-------------|-------------|-------------|-------------|-------------|--------------|
| (1) B.C. 1133.48 | (2) 2+28.23 | (3) 1133.48 | (4) 2+28.23 | (5) 1133.48 | (6) 2+28.23 | (7) 1133.48 | (8) 2+28.23 | (9) 1133.48 | (10) 2+28.23 |
| (1) E.C. 1140.27 | (2) 2+40.82 | (3) 1140.27 | (4) 2+40.82 | (5) 1140.27 | (6) 2+40.82 | (7) 1140.27 | (8) 2+40.82 | (9) 1140.27 | (10) 2+40.82 |
| (1) B.C. 1132.68 | (2) 2+27.85 | (3) 1132.68 | (4) 2+27.85 | (5) 1132.68 | (6) 2+27.85 | (7) 1132.68 | (8) 2+27.85 | (9) 1132.68 | (10) 2+27.85 |
| (1) E.C. 1148.88 | (2) 2+40.88 | (3) 1148.88 | (4) 2+40.88 | (5) 1148.88 | (6) 2+40.88 | (7) 1148.88 | (8) 2+40.88 | (9) 1148.88 | (10) 2+40.88 |

|                 |                 |
|-----------------|-----------------|
| (C) R=100'      | (C) R=106'      |
| Δ = 12° 31' 44" | Δ = 12° 31' 44" |
| T = 16.95'      | T = 11.54'      |
| L = 21.87'      | L = 23.18'      |

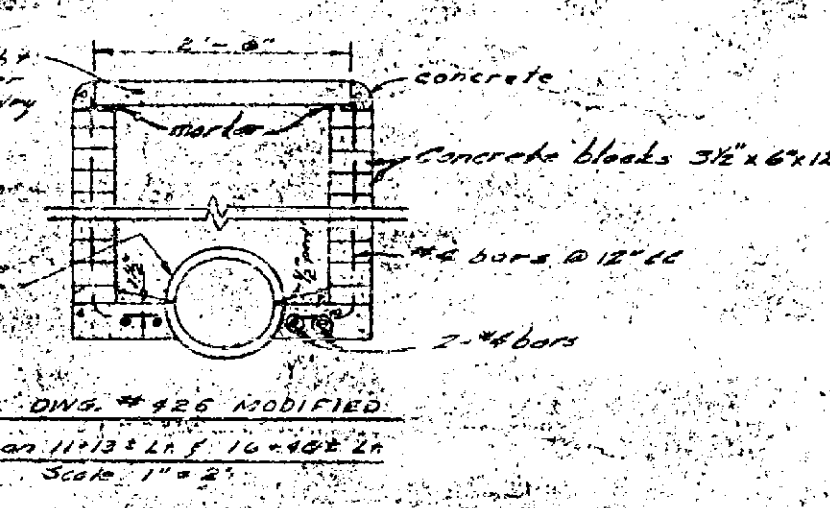
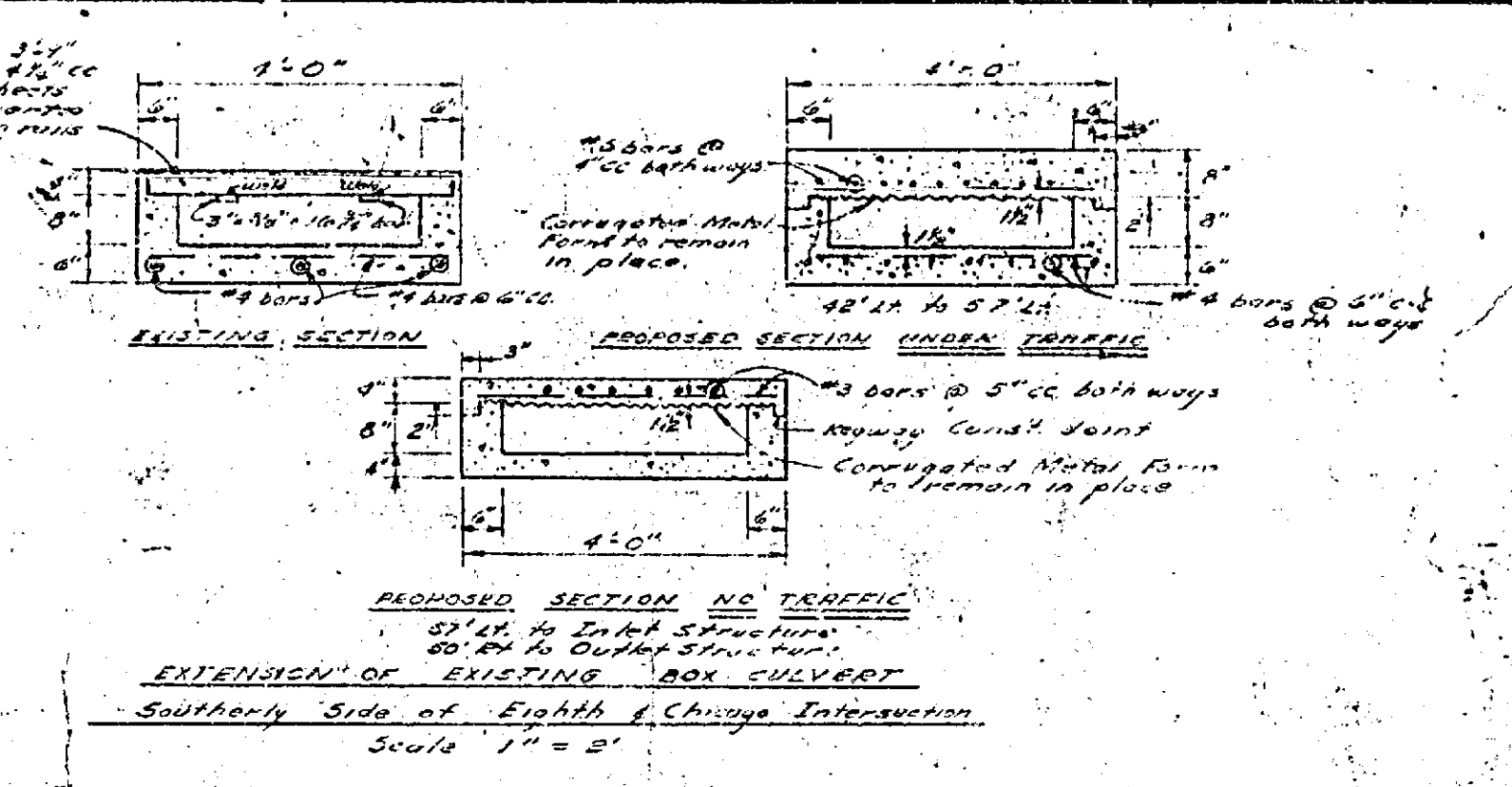

**Curb Data**

|                 |             |
|-----------------|-------------|
| Δ = 32° 52' 25" | 30° 39' 50" |
| R = 38'         | 34.12'      |
| T = 24.22'      | 34.52'      |
| L = 44.49'      | 33.99'      |

**Curb Data**

|                 |
|-----------------|
| Δ = 30° 07' 35" |
| R = 35'         |
| T = 35.08'      |
| L = 55.06'      |

|                  |        |   |
|------------------|--------|---|
| <b>REVISIONS</b> |        | <b>CITY OF RIVERSIDE CALIFORNIA</b><br>DEPARTMENT OF PUBLIC WORKS<br>MAJOR CITY STREET PROJ. NO. 7112<br><b>CHICAGO AVE</b><br>EIGHTH ST. TO PENN. AVE.<br>INTERSECTION 8TH & CHICAGO |
| MARK             | DATE   |   |
| 1                | 1/1/50 | R. B. 26<br>1/1/50  |
| 2                | 1/1/50 |   |

PLATE 1 - PLAN PROFILE & R. STANDARDS  
THE RIVERSIDE POST CO., CHICAGO

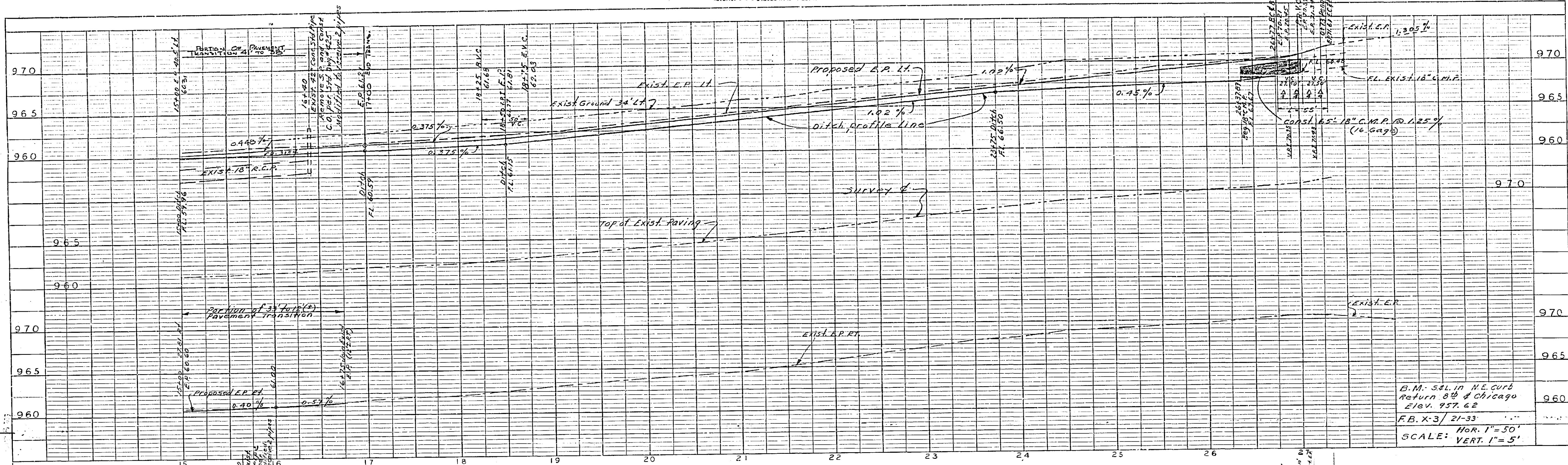

| PROFILE | PROJECT      | DATE |
|---------|--------------|------|
| NO. 100 | CHICAGO AVE. |      |
| NO. 101 | CHICAGO AVE. |      |
| NO. 102 | CHICAGO AVE. |      |

B.M. 541 in N.E. CURB  
Return 8th & Chicago  
Elev. 957.62  
F.B. X-3/21-33  
Hor. 1"=50'  
SCALE: VERT. 1"=5'

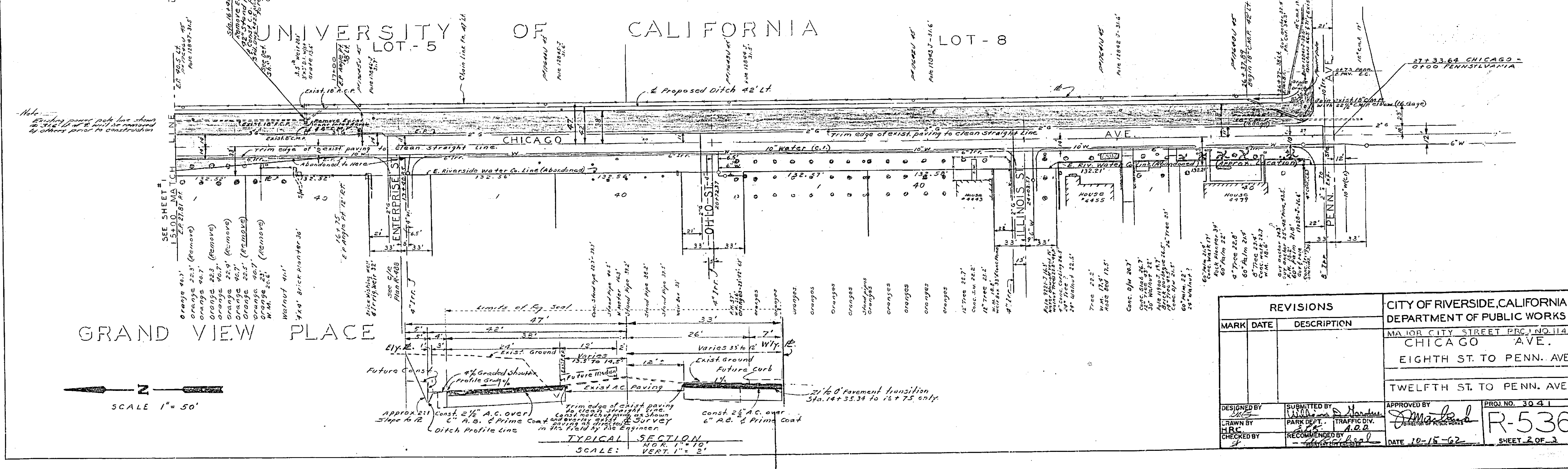

GRAND VIEW PLACE

SCALE 1"=50'

TYPICAL SECTION  
SCALE: VERT. 1"=20'

| REVISIONS   |                           |             | CITY OF RIVERSIDE, CALIFORNIA<br>DEPARTMENT OF PUBLIC WORKS  |              |
|-------------|---------------------------|-------------|--|--------------|
| MARK        | DATE                      | DESCRIPTION |  |              |
|             |                           |             | MAJOR CITY STREET PROJ. NO. 114<br>CHICAGO AVE.<br>EIGHTH ST. TO PENN. AVE.<br>TWELFTH ST. TO PENN. AVE. |              |
| DESIGNED BY | SUBMITTED BY              | APPROVED BY | PROJ. NO.  | 3041         |
| DRAWN BY    | PARK DEPT. - TRAFFIC DIV. | DATE        | R-536  | SHEET 2 OF 3 |
| CHECKED BY  | RECOMMENDED BY            | DATE        | 10-15-62   |              |

| PLAN    | PROJECT      | DATE |
|---------|--------------|------|
| NO. 100 | CHICAGO AVE. |      |
| NO. 101 | CHICAGO AVE. |      |
| NO. 102 | CHICAGO AVE. |      |