

NO.	2	REVISIONS
DATE	10/1/42	
BY	W.E.	
CHKD.		
APP'D.		

NO.	1	REVISIONS
DATE	9/15/42	
BY	W.E.	
CHKD.		
APP'D.		

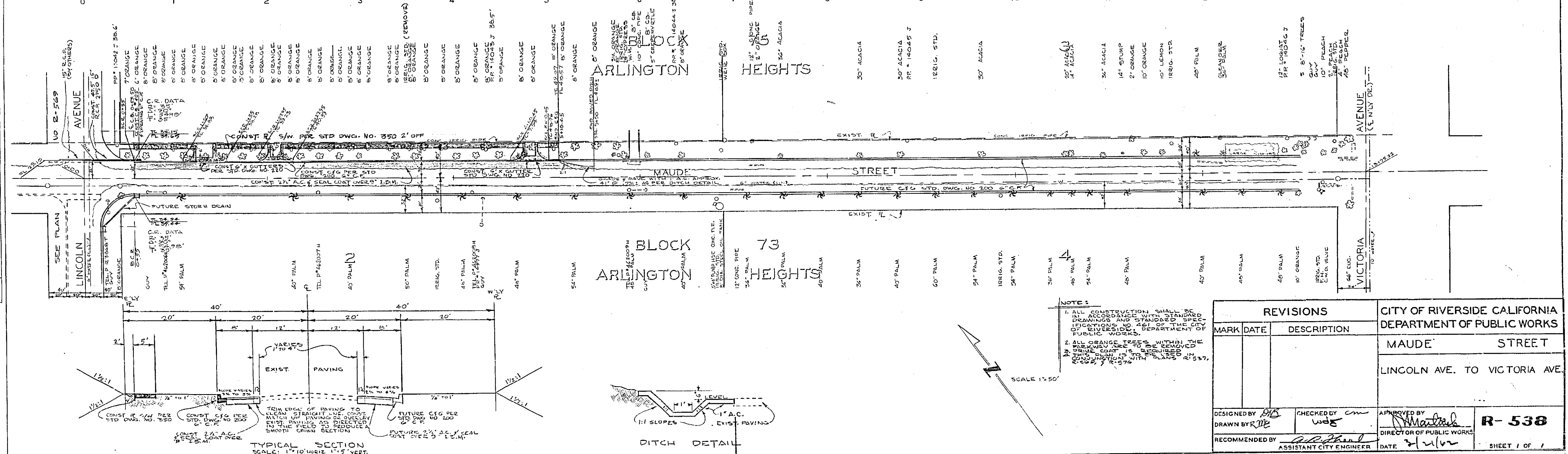
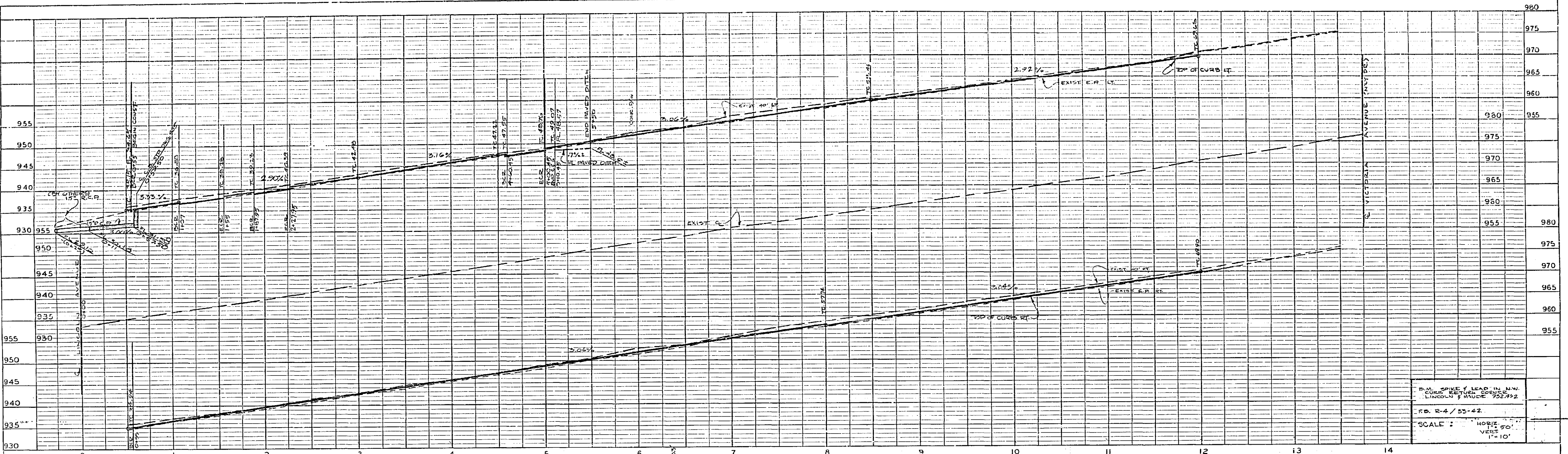

P.M. SPIKE & LEAD IN N.W. CURB RETURN CORNER LINCOLN & MAUDE
 R.B. 2-4 / 53-42
 SCALE: HORIZ. 1" = 50' VERT. 1" = 10'

- NOTES:
1. ALL CONSTRUCTION SHALL BE IN ACCORDANCE WITH THE STANDARD SPECIFICATIONS NO. 401 OF THE CITY OF RIVERSIDE, DEPARTMENT OF PUBLIC WORKS.
 2. ALL ORANGE TREES WITHIN THE DRIVEWAY ARE TO BE REMOVED AND REPLACED WITH PALMS.

REVISIONS		CITY OF RIVERSIDE CALIFORNIA DEPARTMENT OF PUBLIC WORKS	
MARK	DATE	DESCRIPTION	
			MAUDE STREET LINCOLN AVE. TO VICTORIA AVE.
DESIGNED BY	W.E.	CHECKED BY	cm
DRAWN BY	W.E.	APPROVED BY	<i>[Signature]</i> DIRECTOR OF PUBLIC WORKS
RECOMMENDED BY	<i>[Signature]</i> ASSISTANT CITY ENGINEER	DATE	2/1/42

R-538
 SHEET 1 OF 1