

PLAN
 SURVEILED:
 AUTHENTIC CHECKED:
 REF. OF WAY CHECKED:
 NO.:

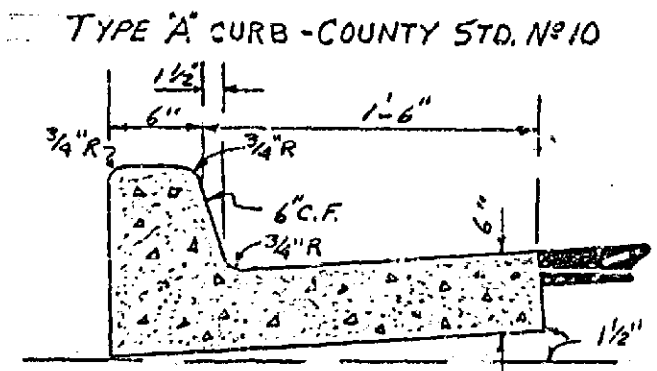

TYPICAL SECTION CURB & GUTTER

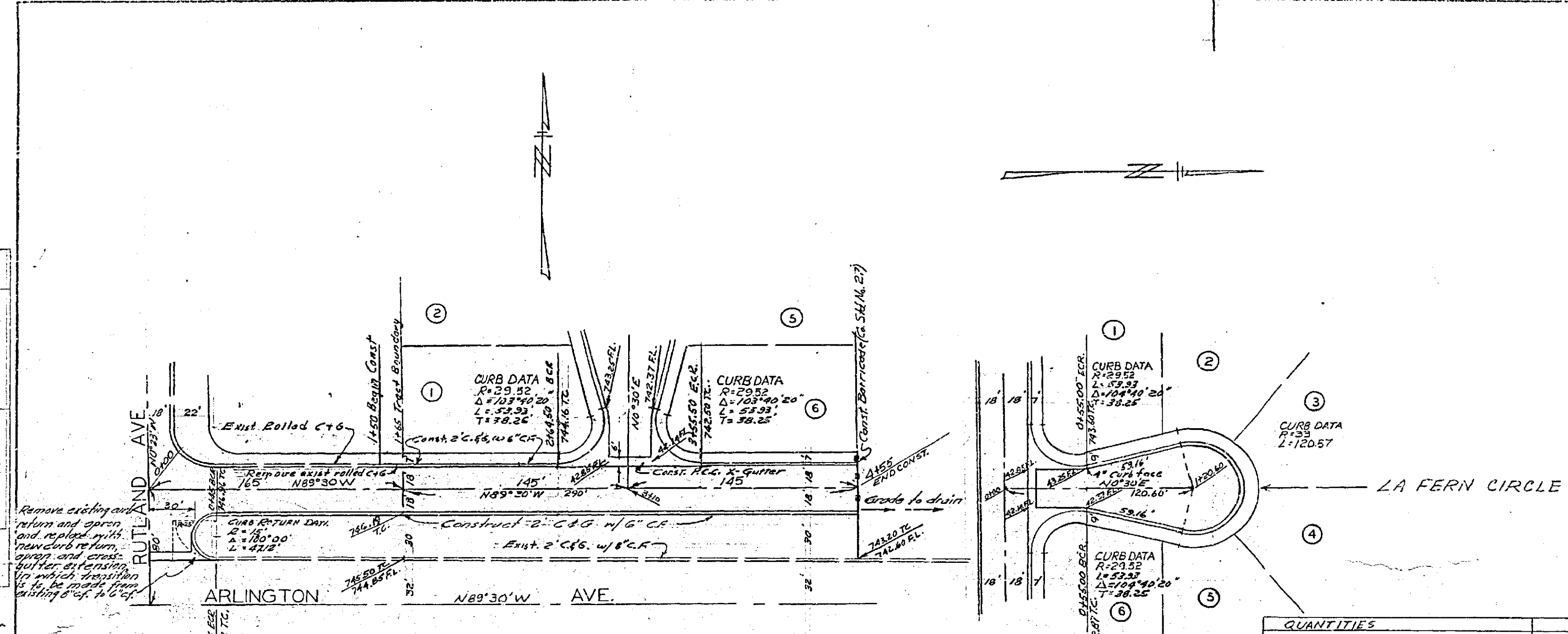
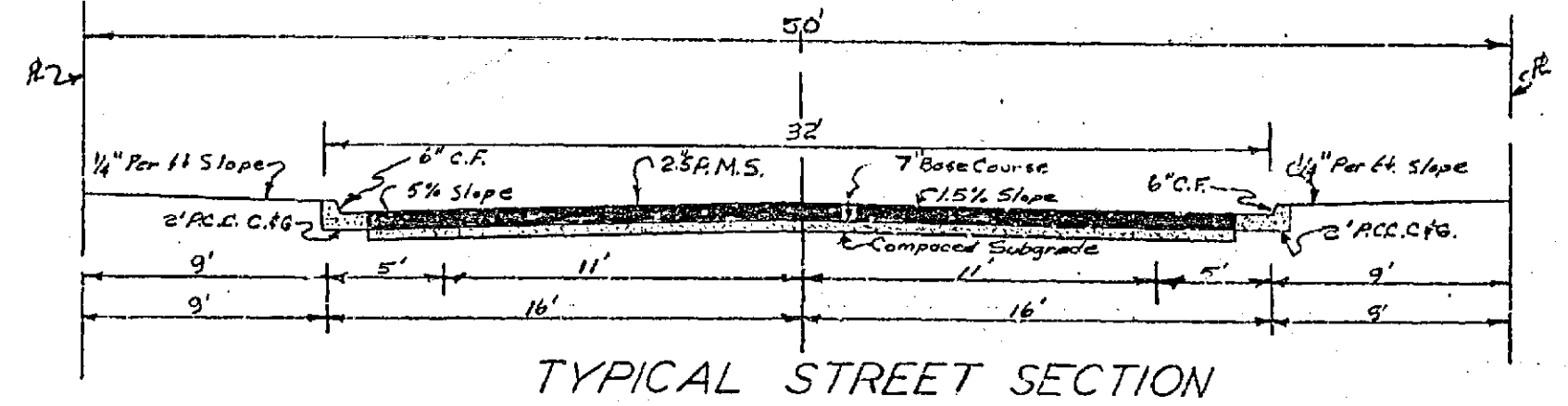

TYPICAL STREET SECTION

STREET PLAN & PROFILE

QUANTITIES	
Roadway Excavation	750 yds ³
Import Material	316 yds ³
Plant Mix Surfacing	184 tons
Type "A" PCC Curb & Gutter	47.2 yds ³

APPROVED: G. 24-67
 ROAD COMMISSIONER
 RIVERSIDE COUNTY

RIVERSIDE ENGINEERING CO.
 RIVERSIDE, CALIFORNIA
 FOR ARLANZA CO.
 HAMPSHIRE SUBDIVISION
 DRAWN BY: MLE CHECKED BY: SCALE: 1"=50'
 DATE: 5-7-54 REVISED: 6-24-57 CIVIL ENGINEER NO. 1125
 JOB NO. 886 SHEET 1 OF 1

PROFILE
 NO.:

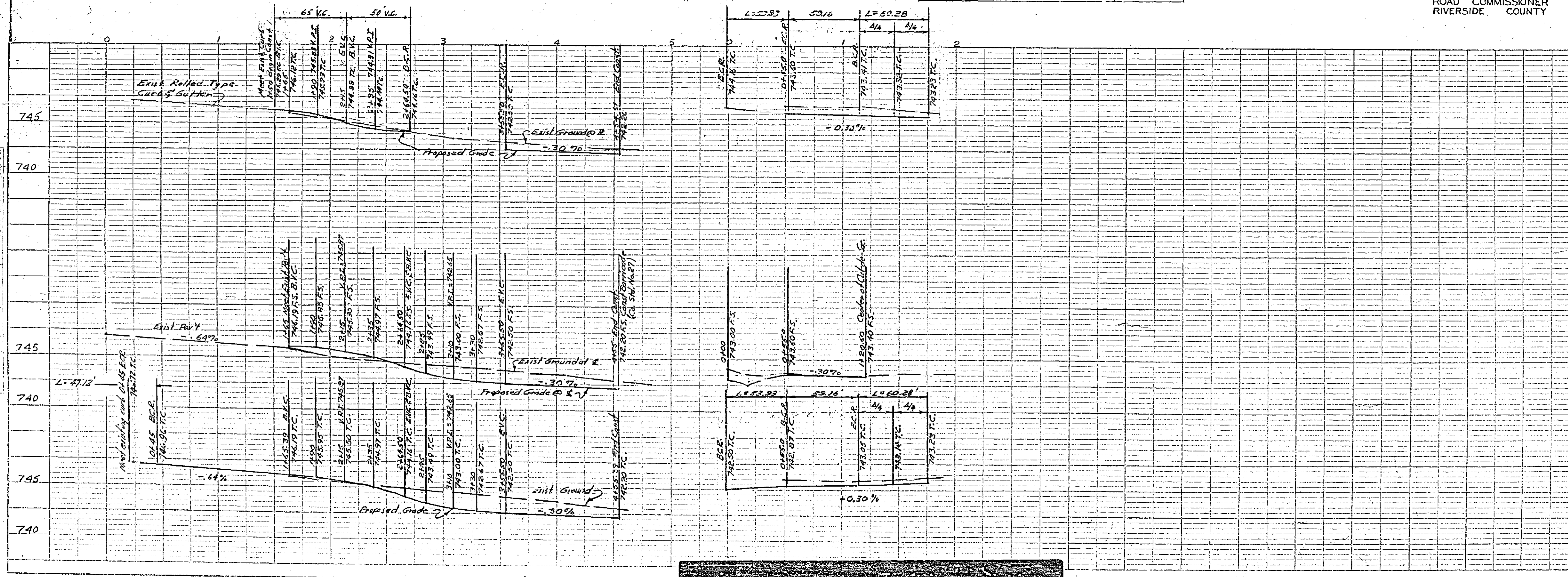

BENCHMARK: CROSS ON WEST CURB OF RUTLAND AVENUE, WEST OF SOUTH WEST CORNER OF LOT 28 OF ARLANZA GOV. SUBDIVISION, N. 1/2 ELEVATION: 741.12 FEET

General Notes:
 Any relocation of existing utilities to clear the proposed work shall be the responsibility of the subdivider.
 Subdivider will install street name signs conforming to County Standard No. 28, as directed.
 All work shall conform to the requirements of the Riverside County, East Department of Specifications for the Improvement of Subdivision Streets, dated 1950.
 All work east of the 1000' mark and west of Hampshire Subdivision, and will be done by County Forces.

COUNTY OF RIVERSIDE
 Office of the Road Commissioner

R-548 724-0