

BENCH MARK
 CITY B.M. - 547 IN NORTH END CORNER
 HEADWALL WLY SIDE OF
 OLDFORD ST. APPROX. 100 FT. W. OF
 B.M. CITY ROAD # 410
 Elev. 871.41

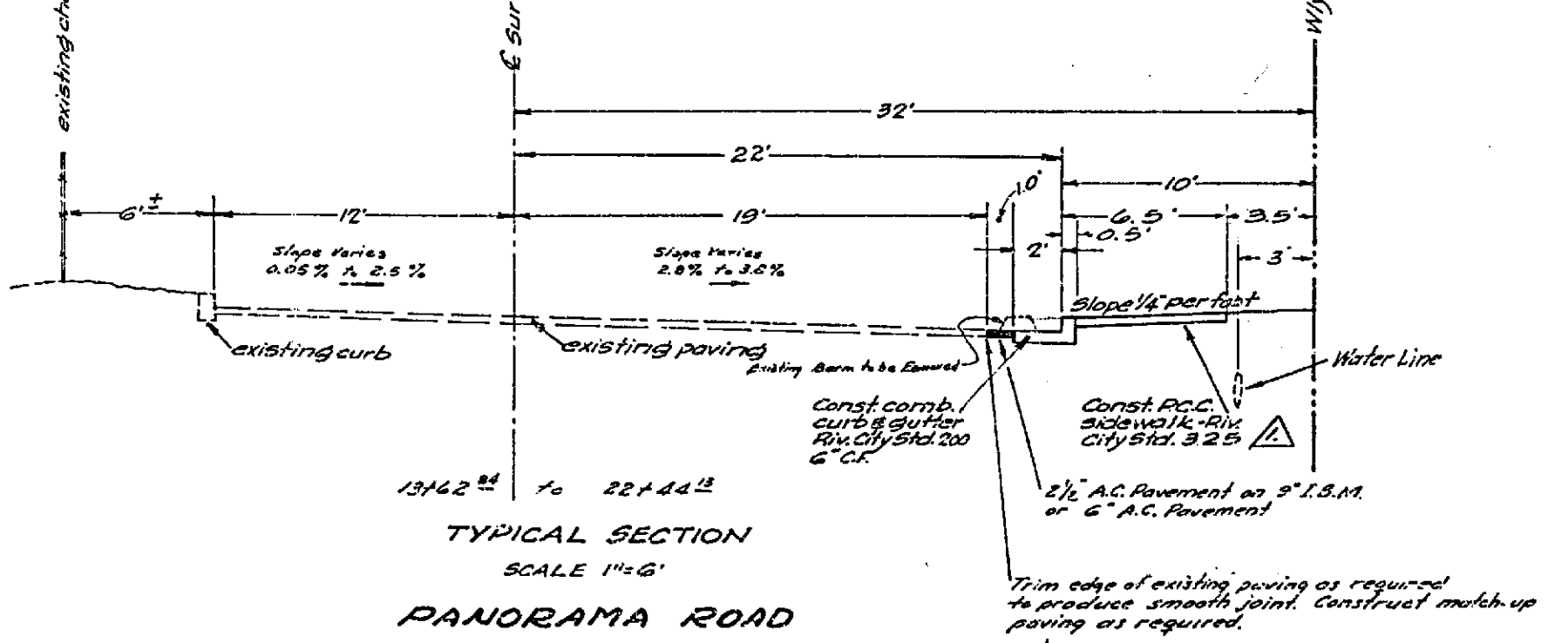

REVISIONS		
MARK	DATE	DESCRIPTION
Δ	5-6-68	Revised plans physical sections for sidewalk, subwork, etc. City 200' 200' 200'

DESIGNED BY: _____
 DRAWN BY: _____
 RECOMMENDED BY: _____ ASSISTANT CITY ENGINEER

CHECKED BY D. R. B. A.D.P. _____
 APPROVED BY: _____
 DATE: 3-20-68

J. F. DAVIDSON - CIVIL ENGINEER
 R.E. NO. 862
 RIVERSIDE, CALIFORNIA
 APPROVED BY: _____ DATE: 3-20-68
CITY OF RIVERSIDE, CALIFORNIA
DEPARTMENT OF PUBLIC WORKS
STREET PLAN & PROFILE
PANORAMA ROAD
 R.S. # 644
 HORIZ. SCALE 1"=40' VERT. SCALE 1"=4'
 NO. R-581
 SHEET 2 OF 2

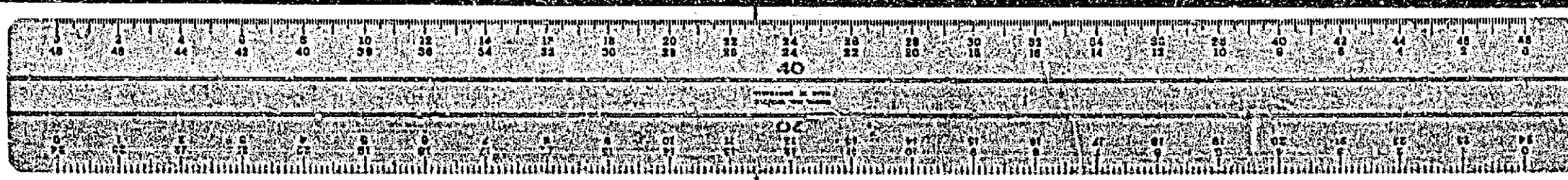

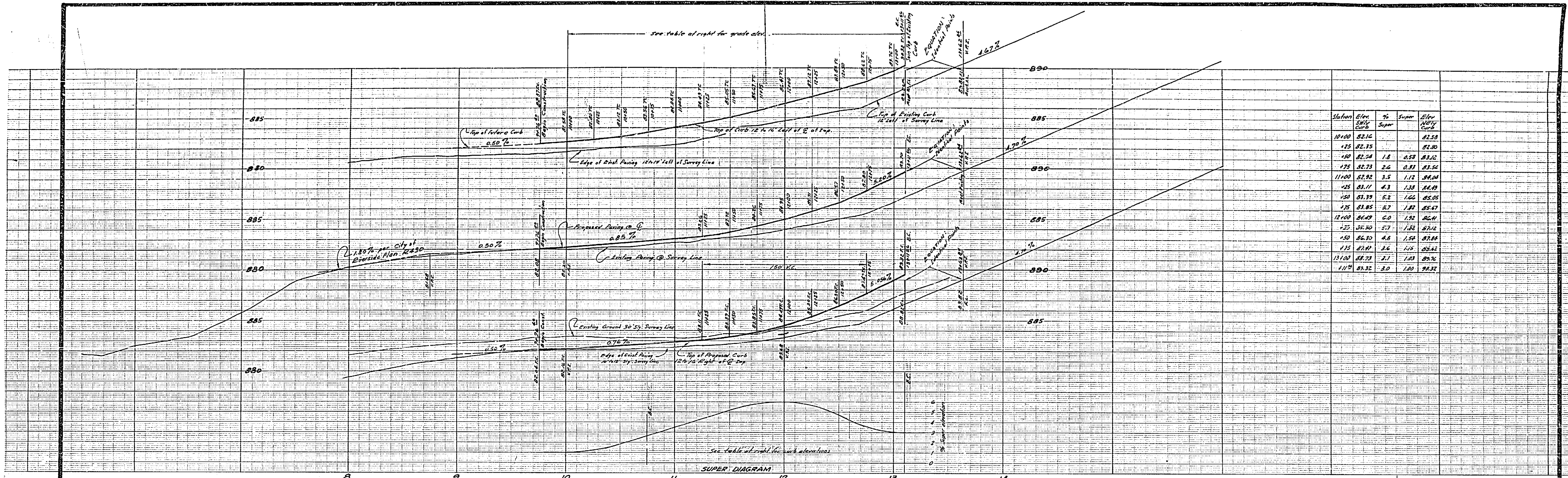

BENCH MARK
 CITY B.M. SET IN NORTH END CANAL
 HEADWALL WLY SIDE OF
 OLIVWOOD @ ELMWOOD CT.
 REC. CITY PLAN E-430.
 ELEV. 87.41

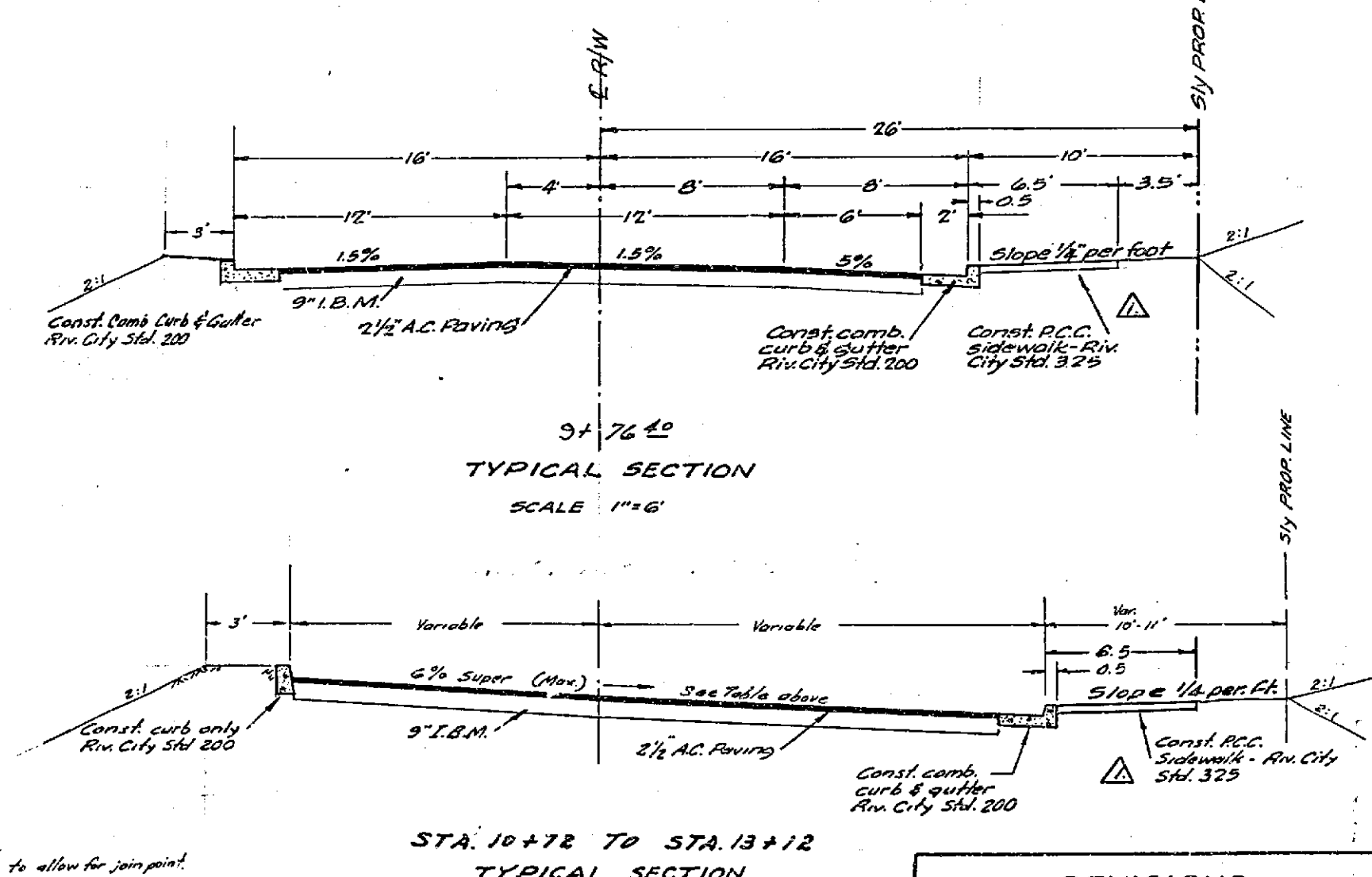
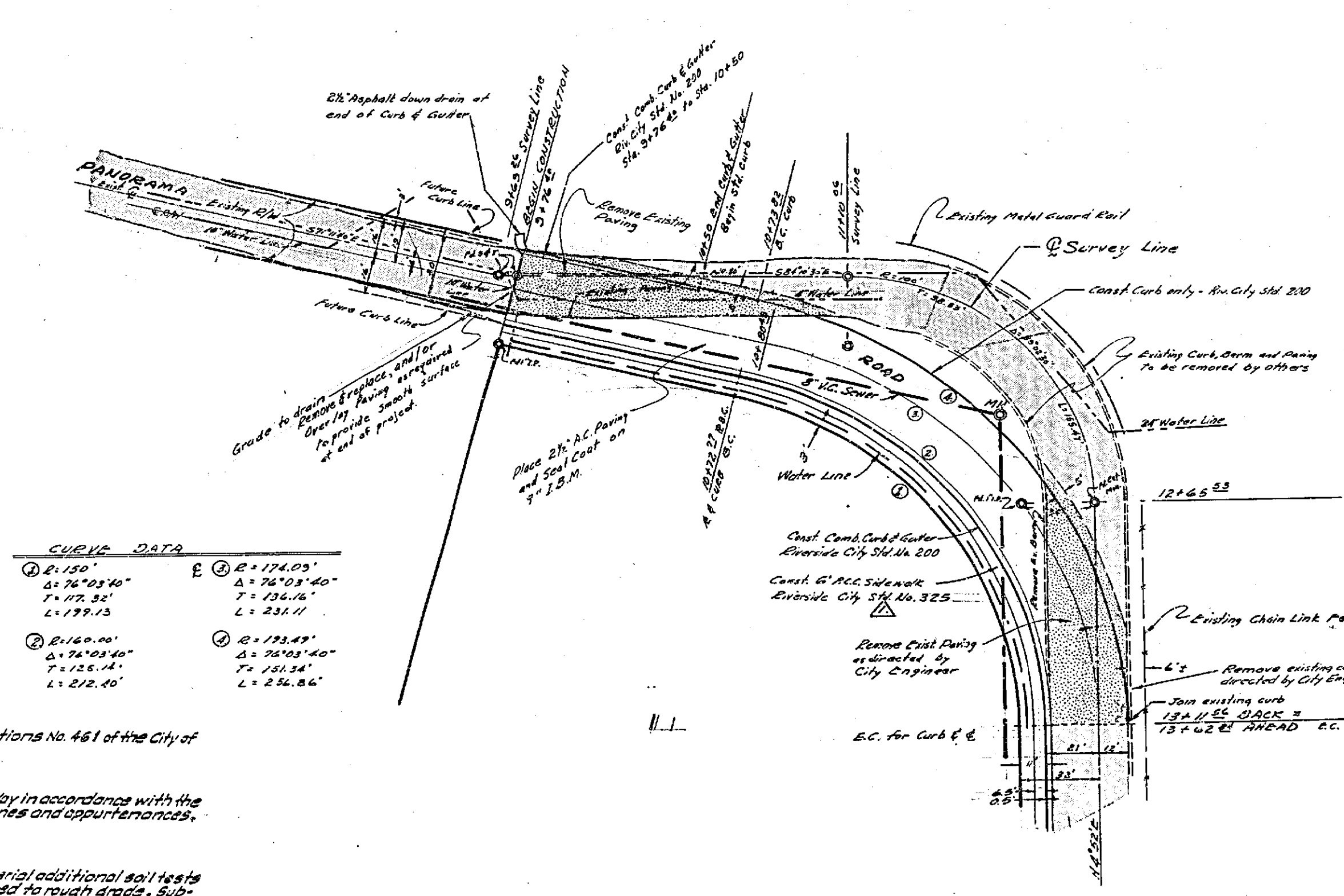

CURVE DATA

Station	Δ	T	L
① 11+50	24°05'40"	177.32'	1799.13'
② 11+60	24°03'40"	158.14'	212.40'
③ 11+74.03	174.03'	136.76'	231.11'
④ 11+93.49	24°03'40"	158.14'	212.40'
⑤ 12+24.88	24°03'40"	158.14'	212.40'

- GENERAL NOTES**
- All construction shall be in accordance with Standards and Specifications No. 461 of the City of Riverside Department of Public Works.
 - It shall be the responsibility of the Contractor to clear the Right of Way in accordance with the provisions of law as it affects each utility including irrigation lines and appurtenances, and at no extra cost to the City of Riverside.
 - If the Subdivider desires to reduce requirements on import base material additional soil tests may be taken at the Subdivider's expense after plans are prepared to rough grade. Subdivider will contact inspection division, City of Riverside before making test. The City of Riverside will make test of base material in place before paving can be installed. Results of this test must indicate that the base material is satisfactory to the inspection division.
 - Prime coat and paint binder required.

J. F. DAVIDSON-CIVIL ENGINEER
 R.E. NO. 862
 RIVERSIDE, CALIFORNIA
 APPROVED BY: [Signature] DATE: 2-27-62

CITY OF RIVERSIDE, CALIFORNIA
 DEPARTMENT OF PUBLIC WORKS
STREET PLAN & PROFILE
PANORAMA ROAD
 R.S. 644
 HORIZ. SCALE 1"=40' VERT. SCALE 1"=4'

DESIGNED BY: [Signature]
 DRAWN BY: [Signature]
 RECOMMENDED BY: [Signature] ASSISTANT CITY ENGINEER

CHECKED BY D.R.G. A.D.R. W.D.S.
 APPROVED BY: [Signature] DIRECTOR OF PUBLIC WORKS
 DATE: 3/20/62

NO. R 581
 SHEET 1 OF 2

