

McKee & CRAWLEY
SURVEYORS AND ENGINEERS
Riverside, California
Approved: *George O. Crawley* Field Bk. No. 3-62
R.E. No. 9455

REVISIONS		DESCRIPTION
MARK	DATE	

DESIGNED BY: *[Signature]* CHECKED BY: *[Signature]* APPROVED BY: *[Signature]*
DRAWN BY: *[Signature]* ASSISTANT CITY ENGINEER DIRECTOR OF PUBLIC WORKS
RECOMMENDED BY: *[Signature]* DATE: *May 21, 1961*

TRACT NO. 2353
STREETPLAN & PROFILE
CRYSTAL AVENUE &
SNOWBERRY STREET

R-597
SHEET 1 OF 3

PROFILE
NO. 0524
DATE: 5/21/61
BY: [Signature]

P.A.M.
NO. 0524
DATE: 5/21/61
BY: [Signature]

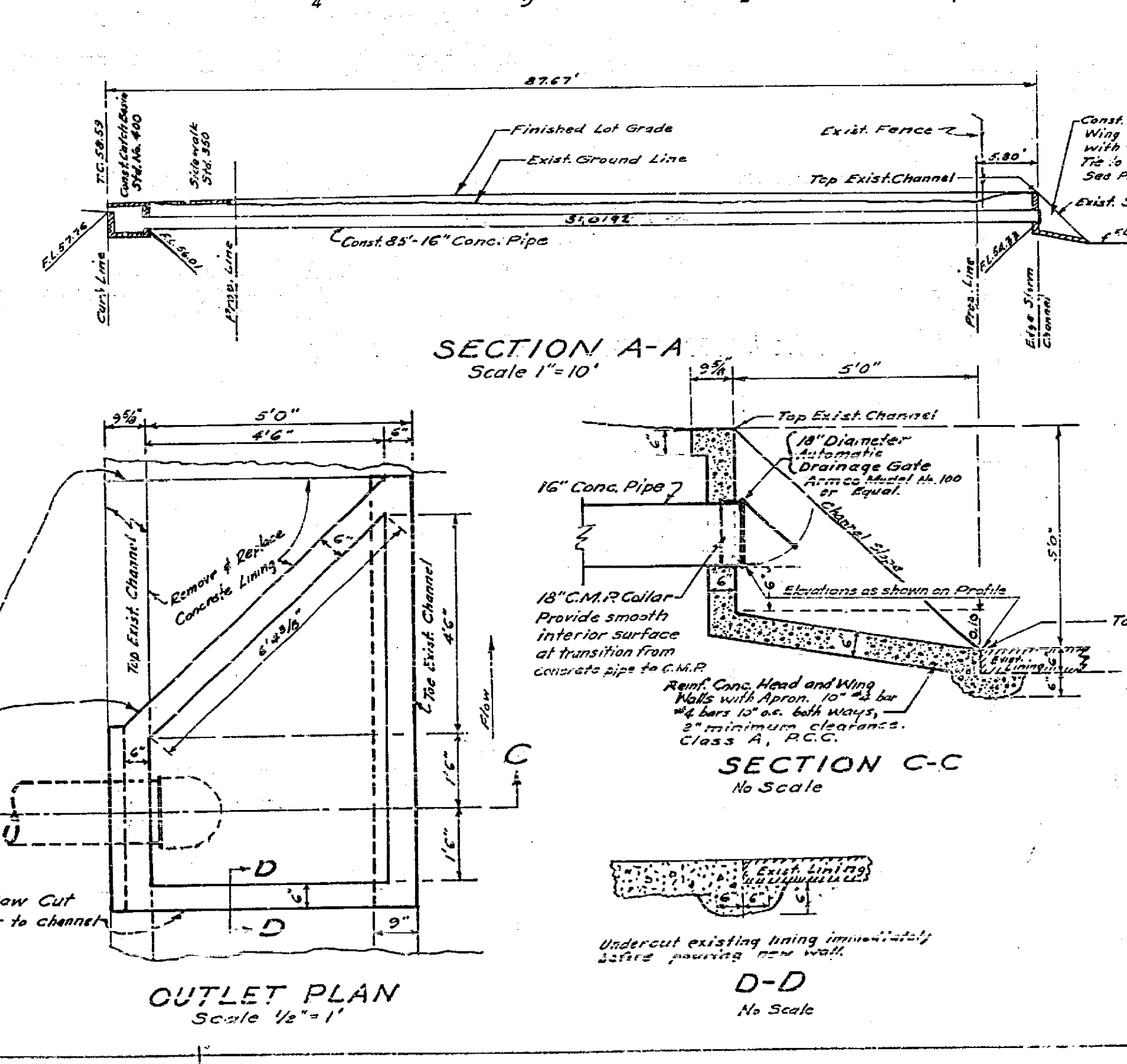
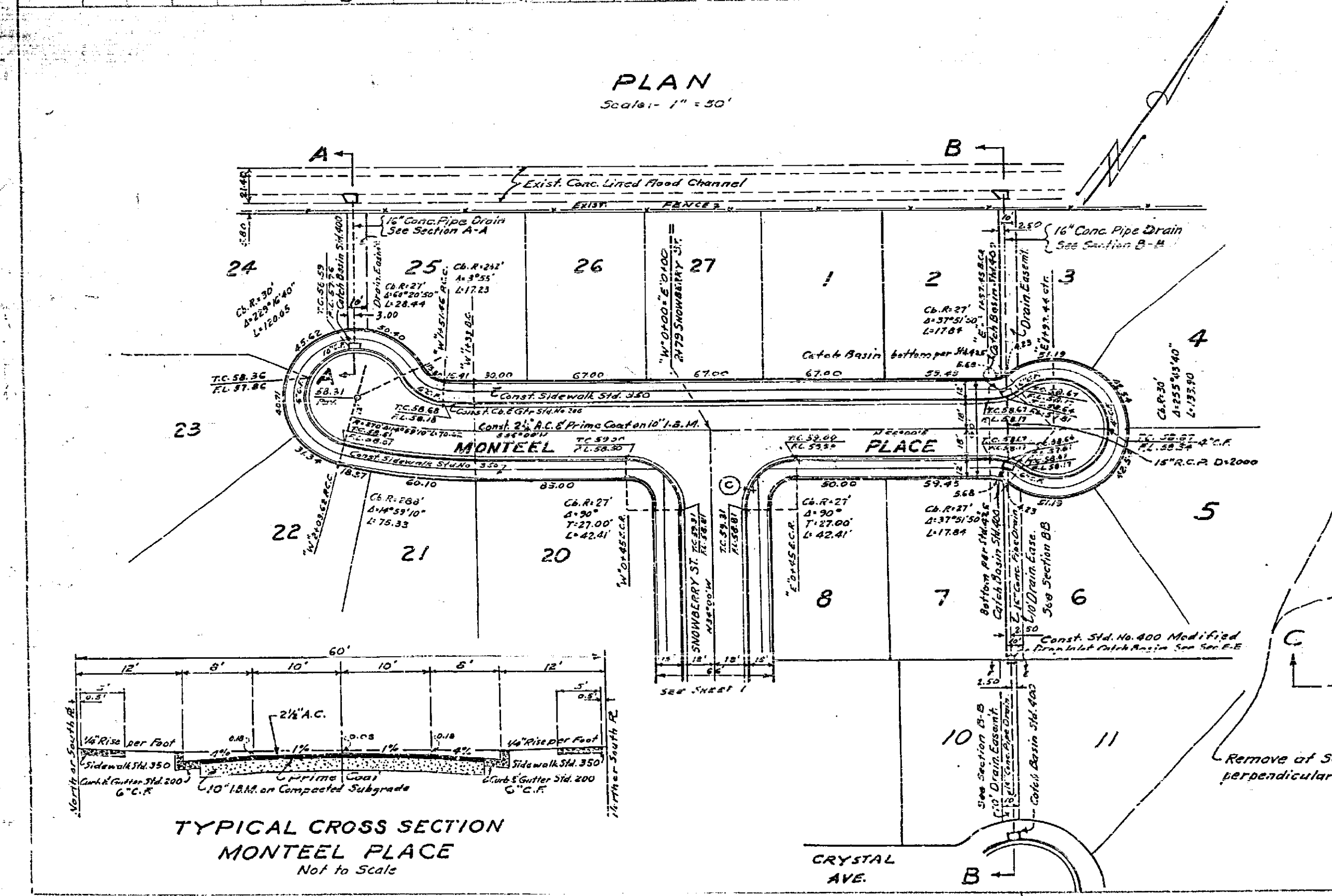
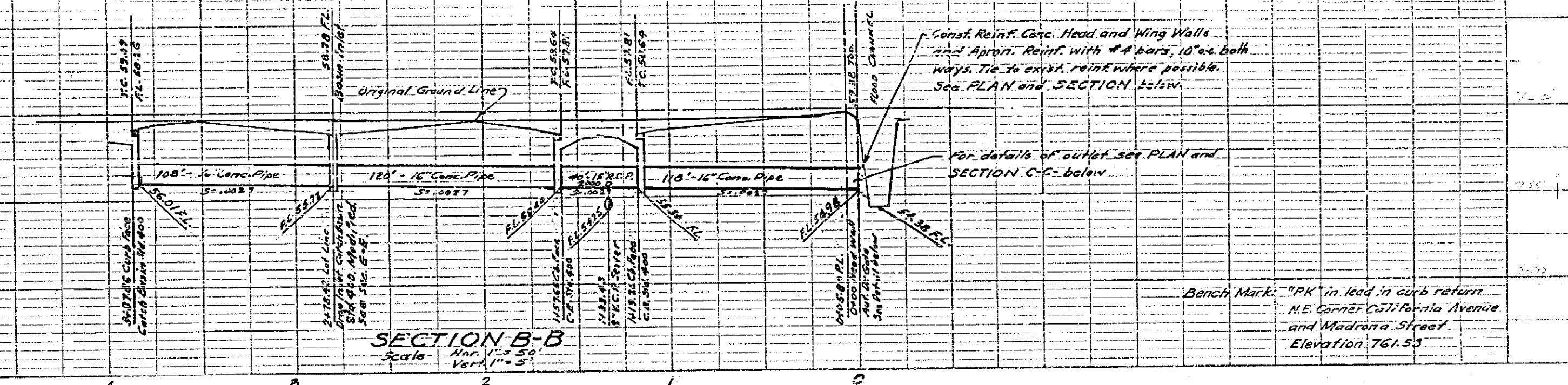
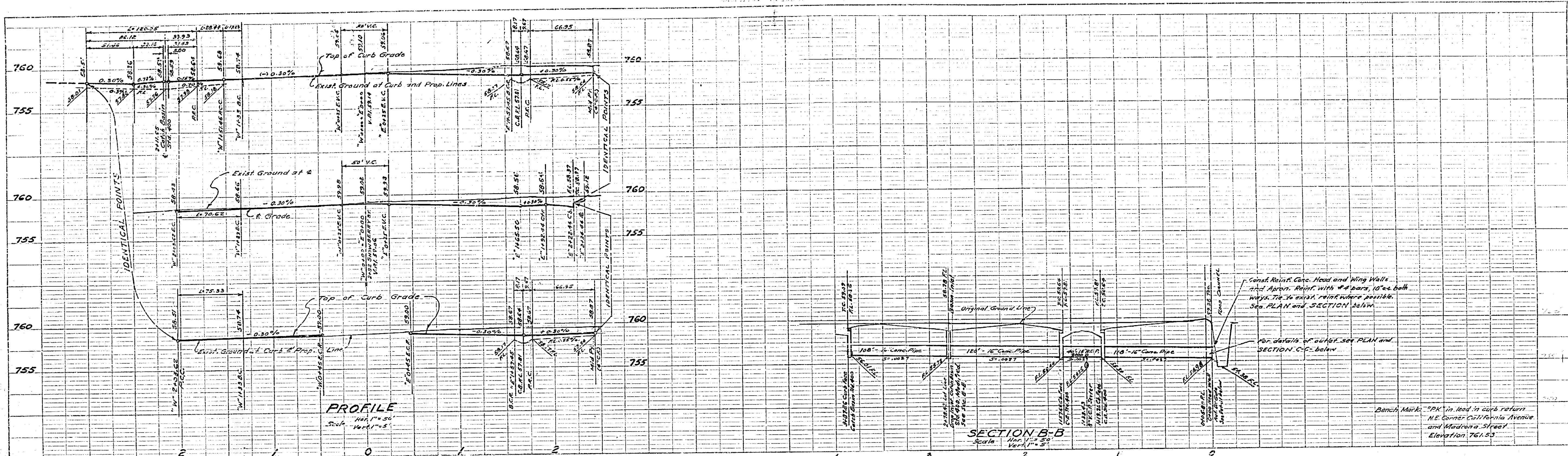

STREET NAME SIGN SCHEDULE	
(A)	SHELBY DR. 4200
(A)	CRYSTAL AVE. 8500
(B)	CRYSTAL AVE. 8400
(B)	SNOWBERRY ST. 4200
(C)	SNOWBERRY ST. 4200
(C)	MONTEEL PL. 8400

Note: Street name signs and posts to be furnished and installed by subdivider, per Std. 602.

NOTE: General Notes see Sheet # 3

REVISIONS		
MARK	DATE	DESCRIPTION

DESIGNED BY: *[Signature]*
 DRAWN BY: *[Signature]*
 RECOMMENDED BY: *[Signature]*
 ASSISTANT CITY ENGINEER

CHECKED BY: *[Signature]*
 DATE: May 21, 1962

APPROVED BY: *[Signature]*
 DIRECTOR OF PUBLIC WORKS

McKee & CRAWLEY
 SURVEYORS AND ENGINEERS
 Riverside, California
 Approved: *[Signature]* Field Bk. No. 9155
 R.E. No. 9155 Date: 5-3-62

CITY OF RIVERSIDE CALIFORNIA
 DEPARTMENT OF PUBLIC WORKS

TRACT NO. 2353
 STREET PLAN & PROFILE
 MONTEEL PLACE
 STORM DRAIN DETAILS

R-597
 SHEET 2 OF 3

PROFILE
 SCALE: 1" = 50'
 DATE: 5-3-62

PLAN
 SCALE: 1" = 50'
 DATE: 5-3-62

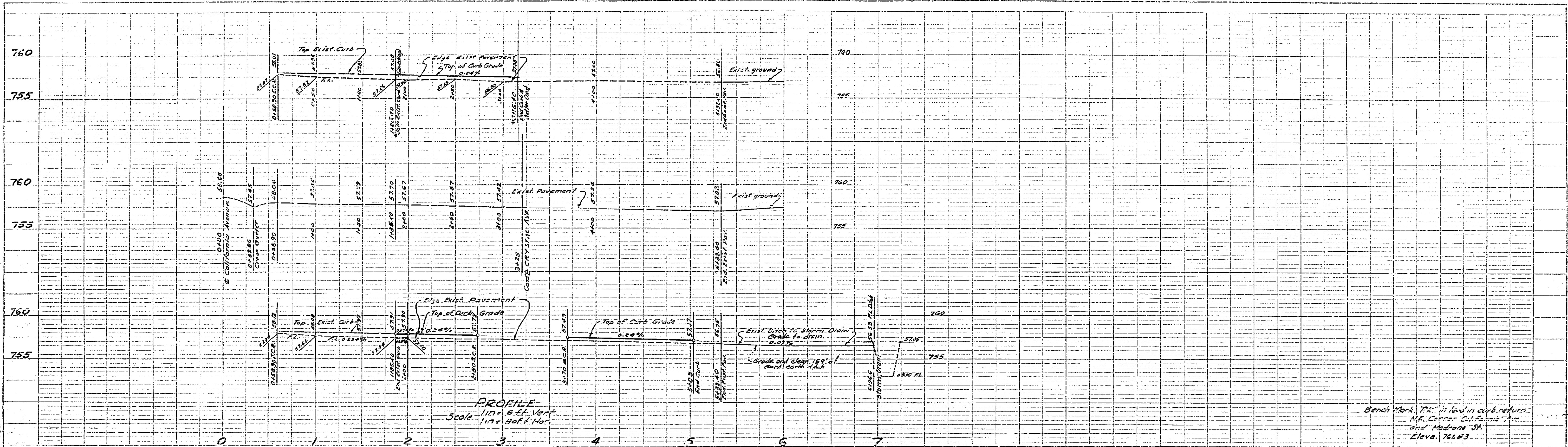

PROFILE
 DATE: 5/1/62
 DRAWN BY: [Signature]
 CHECKED BY: [Signature]
 APPROVED BY: [Signature]

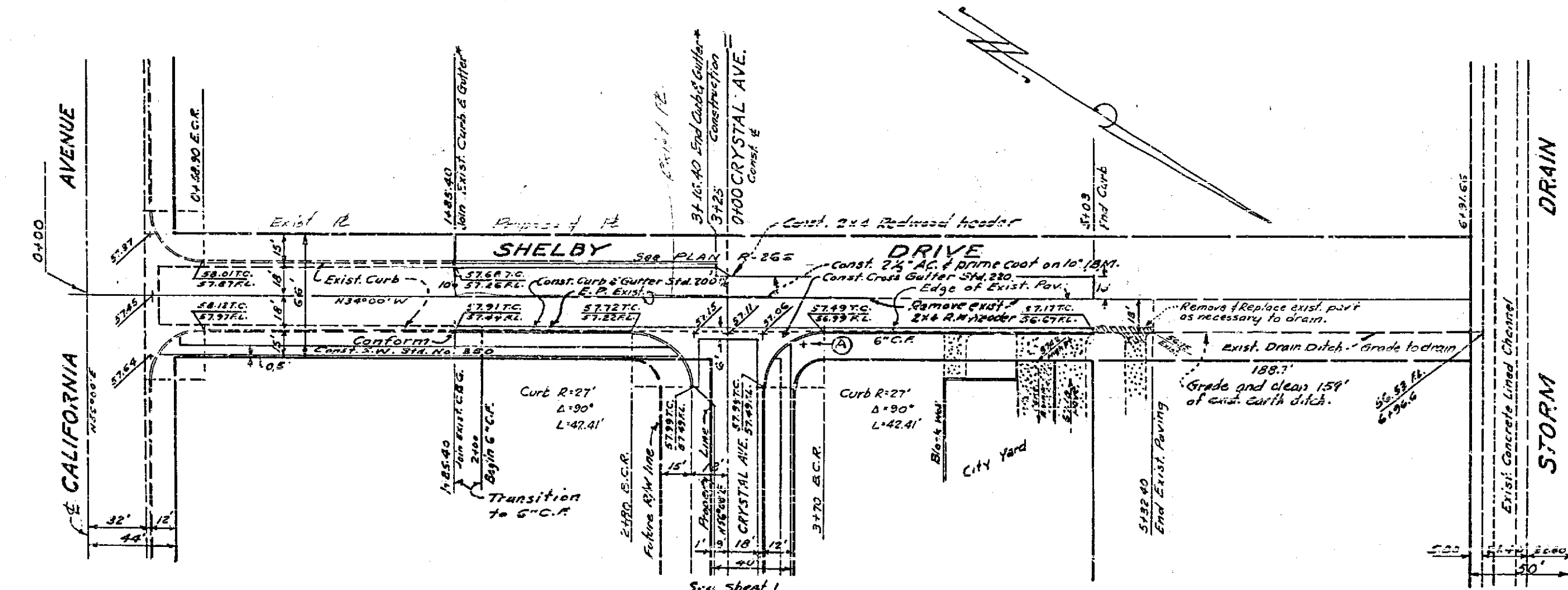

- GENERAL NOTES**
1. The contractor is required to take due precautionary measures to protect the utilities or structures shown and any other utilities or structures of the site. It shall be the contractor's responsibility to notify the owners of the utilities or structures concerned before starting work.
 2. All work and materials shall comply with the Specifications No. 461 and Standards of the City of Riverside Dept. of Public Works.
 3. If the subdivider desires to reduce the requirement for imported Base Material, additional soil tests may be taken at subdividers expense after streets are prepared to rough grade. Subdivider will contact inspection Div. Dept. of Public Works before making tests. The City of Riverside will make a test of Base Material in place before paving can be installed. Results of this test must indicate the base material is satisfactory to the inspection Division.
 4. Prime coat and paint binder will be required.

PLAN
 DATE: 5/1/62
 DRAWN BY: [Signature]
 CHECKED BY: [Signature]
 APPROVED BY: [Signature]

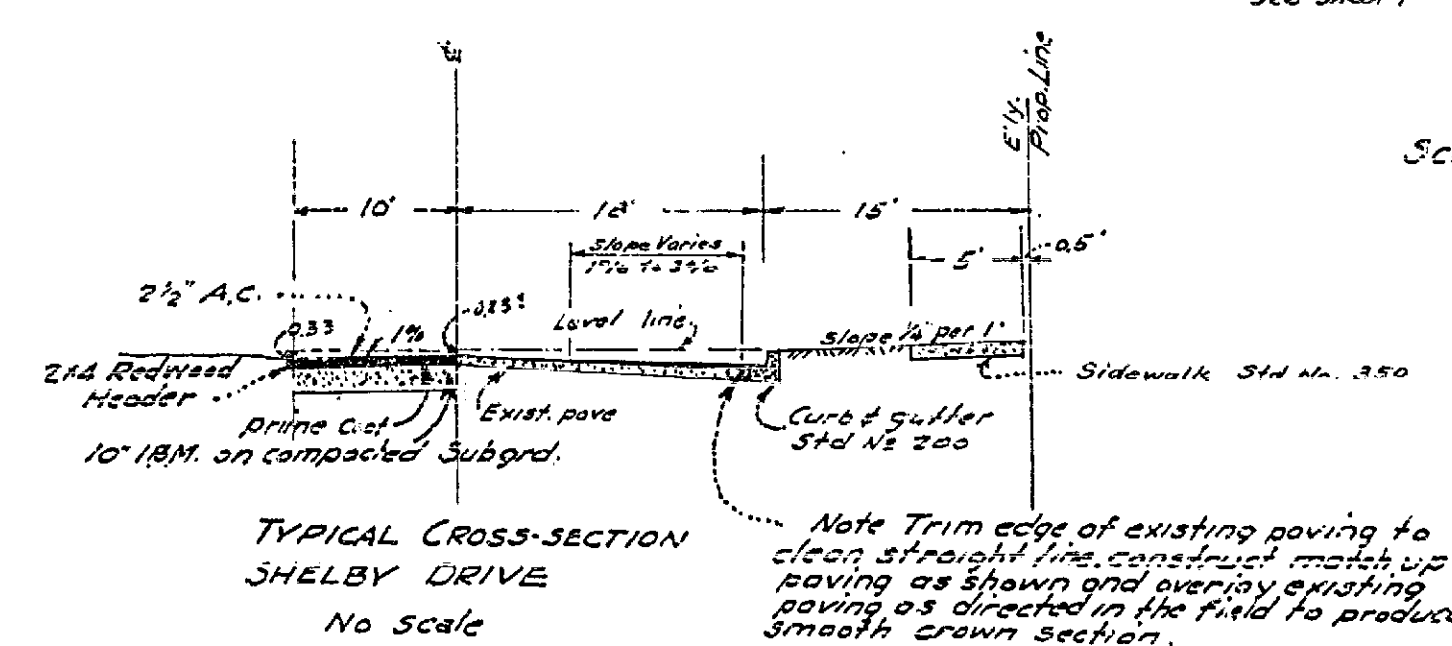

PLAN
 Scale 1/4" = 50'

TYPICAL CROSS-SECTION
 SHELBY DRIVE
 No Scale

Note: Trim edge of existing paving to clean straight line, compact and patch up paving as directed in the field to produce smooth drain section.

McKEE & CRAWLEY
 SURVEYORS AND ENGINEERS
 Riverside, California
 Approved: *George O. Crawley* Field Bk. Date: 5-3-62
 R.E. No. 5122

REVISIONS		DESCRIPTION
MARK	DATE	
4	5-12-62	Added masterly curb & gutter from Sta. 1+85.40 to Sta. 2+12.40. A.C. Paving extend to 2+12.40.

CITY OF RIVERSIDE CALIFORNIA
 DEPARTMENT OF PUBLIC WORKS

TRACT NO. 2353
 STREET PLAN & PROFILE
 SHELBY DRIVE

DESIGNED BY: [Signature]
 DRAWN BY: [Signature]
 RECOMMENDED BY: [Signature] ASSISTANT CITY ENGINEER

CHECKED BY: [Signature] DATE: 5/1/62

APPROVED BY: [Signature] DIRECTOR OF PUBLIC WORKS

R-597
 SHEET 3 OF 3