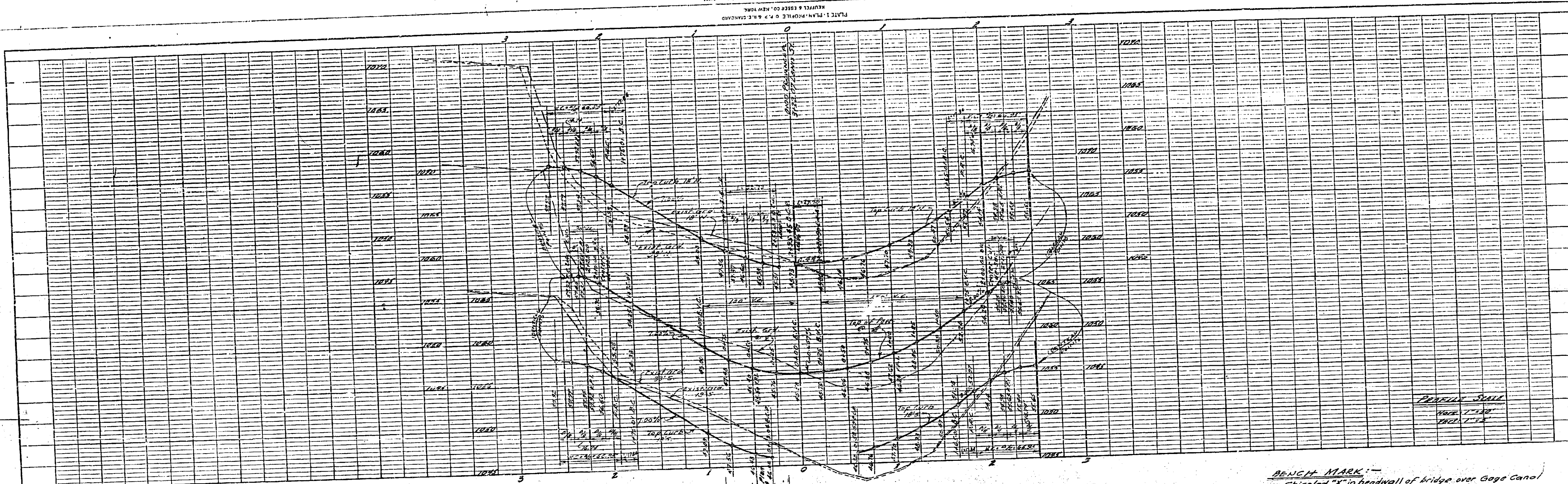
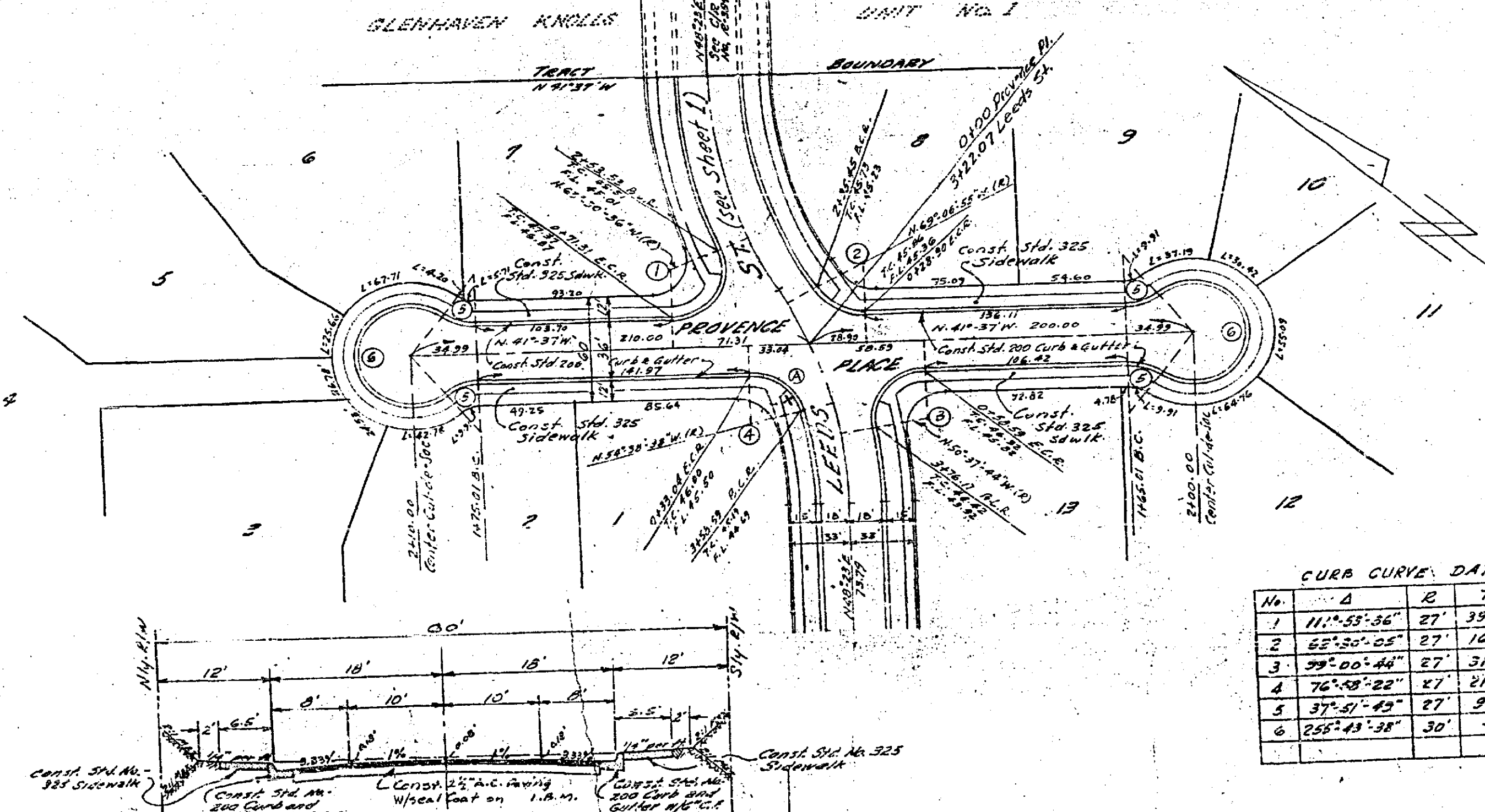

PLATE 1 - PLAN, PROFILE & SECTION OF R.R. & GAGE CANAL
 REFERENCE & ESTATE CO. NEW YORK
 U.S. CO. NO. 347-111



Profile Scale
 1" = 10'
 1" = 100'

BENCH MARK: -
 Chisled "X" in headwall of bridge over Gage Canal
 at S.E. corner Glenhaven & Fairview Aves.
 ELEVATION = 1018.51' F.B. 206/21
 SOURCE: LEAD BOLT IN P.P. 1905-1 ON S. SIDE
 OF GAGE CANAL 200' WEST OF GLENHAVEN
 ELEV. 1019.85
 (THIS B.M. WAS SET FROM G.M. ABOVE
 BEFORE IT WAS REMOVED)



CURB CURVE DATA

No.	A	B	T	L
1	111° 53' 36"	27'	39.55'	52.73'
2	65° 20' 05"	27'	16.38'	29.45'
3	99° 00' 40"	27'	31.62'	46.66'
4	76° 58' 22"	27'	21.67'	36.37'
5	37° 51' 49"	27'	9.26'	17.34'
6	258° 43' 38"	30'	-	133.30'

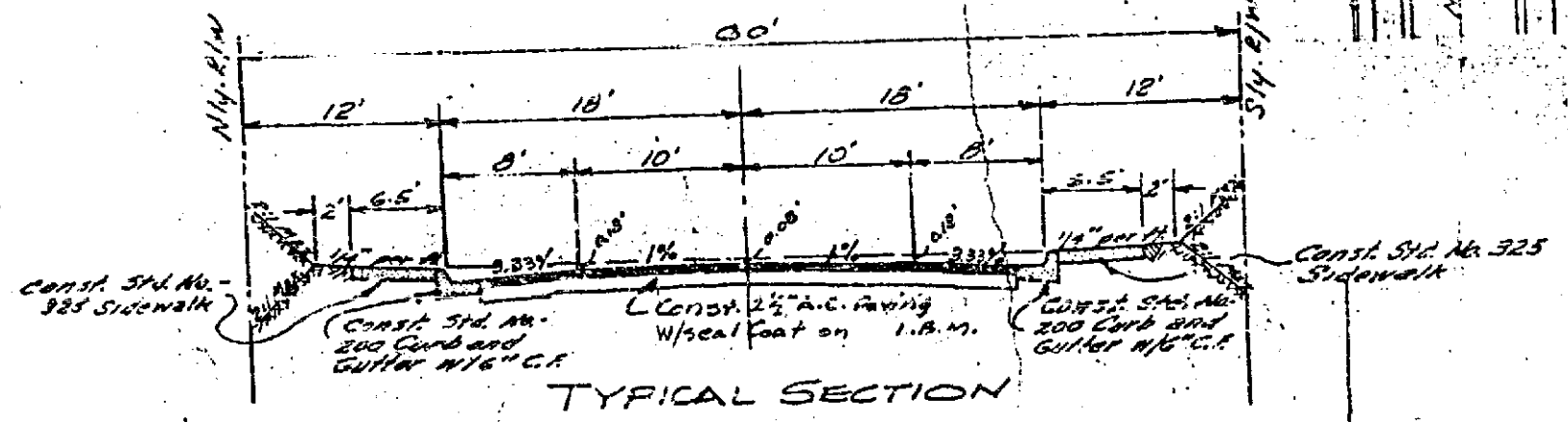

ALBERT A. WEBB ASSOCIATES
 CIVIL ENGINEERS - RIVERSIDE, CALIFORNIA
 APPROVED BY P. N. J. DEB. DATE 7/3/62
 21, 3876

CITY OF RIVERSIDE, CALIFORNIA
 DEPARTMENT OF PUBLIC WORKS
 STREET PLAN & PROFILE
 PROVENCE PLACE
 TRACT NO. 2073

REVISION		DATE	DESCRIPTION

DATE: July 16, 1962
 DRAWN: REC
 CHECKED: ADD TAVEL
 SCALE: Horiz. 1" = 50'
 Vert. 1" = 2'
 W.D. 60-222
 F.B. 286, 417
 APPROVED BY: [Signature]
 DIRECTOR OF PUBLIC WORKS
 DATE: 7-16-62
 NO. R-618
 SHEET 2 OF 3

PROFILE

DATE	
NO.	

PLAN

DATE	
NO.	

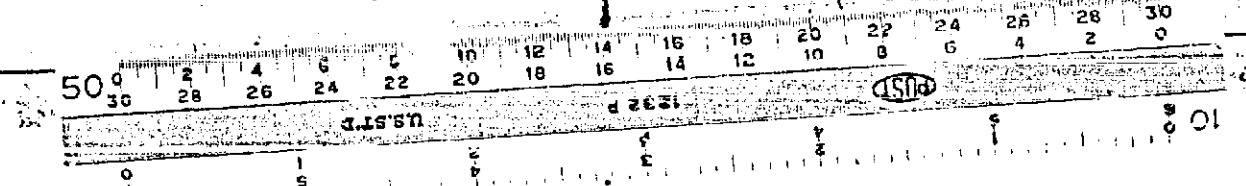

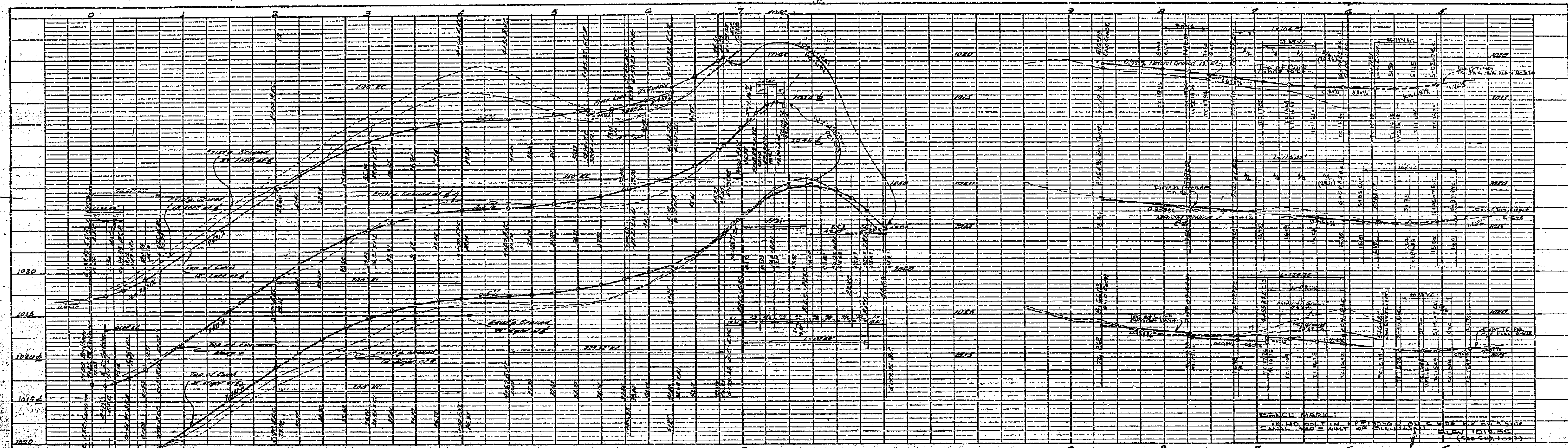

NO.	DATE	DESCRIPTION
1		PREPARED
2		REVISED
3		REVISED
4		REVISED
5		REVISED

STATION	CHORD BEHIND DATA	CHORD	ANGLE	AREA
1	27' 27" 52' 01"	21.8'	26.67'	
2	27' 27" 21' 40"	20.18'	43.52'	
3	27' 27" 00' 00"	29.00'	42.41'	
4	30' 28' 42' 12"	10.00'	13.31'	
5	30' 28' 42' 12"	10.00'	13.31'	

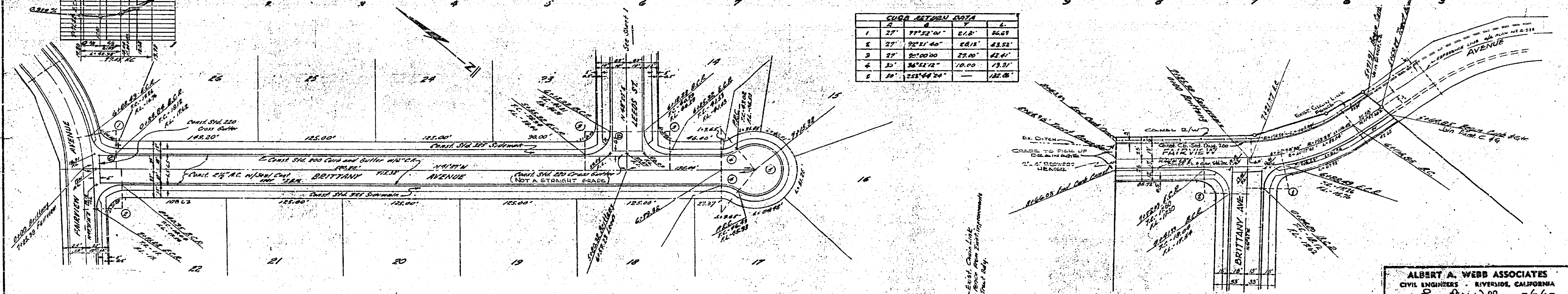

NO.	DATE	DESCRIPTION
1		PREPARED
2		REVISED
3		REVISED
4		REVISED
5		REVISED

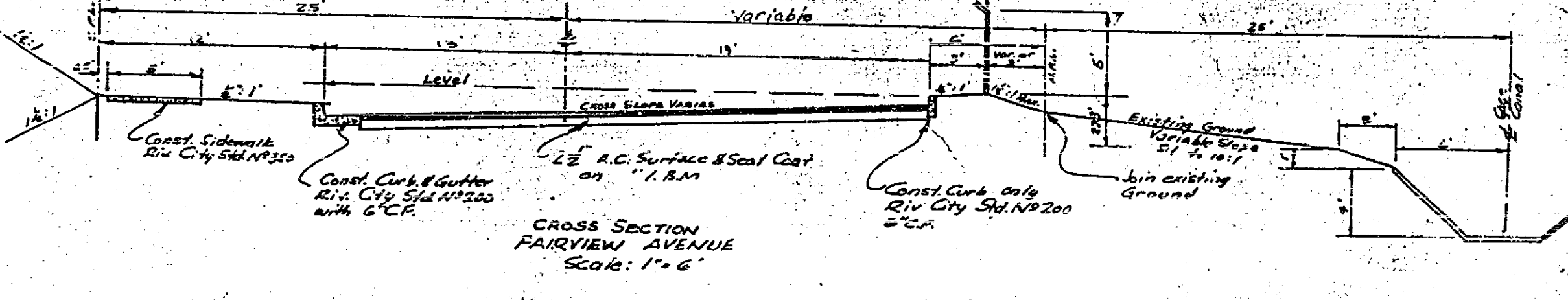
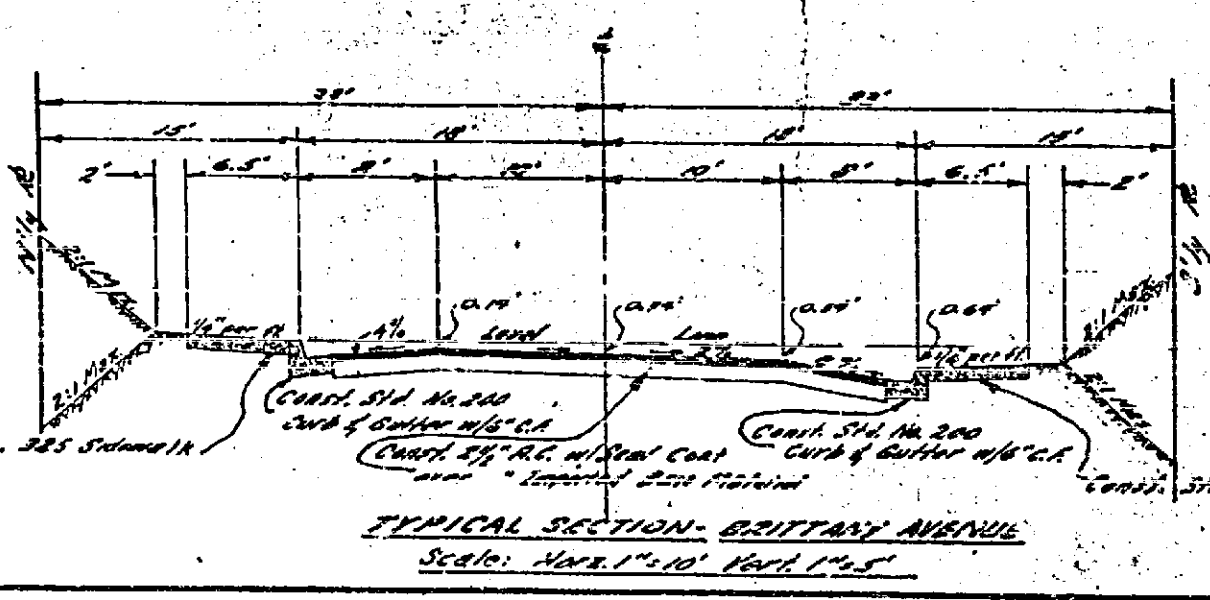

REVISION		CITY OF RIVERSIDE, CALIFORNIA DEPARTMENT OF PUBLIC WORKS	
MARK	DATE	DESCRIPTION	

ALBERT A. WEBB ASSOCIATES
 CIVIL ENGINEERS - RIVERSIDE, CALIFORNIA
 APPROVED: *Albert A. Webb* DATE 7/5/67
 CITY ENGINEER

STREET PLAN & PROFILE
 FAIRVIEW AVENUE
 BRITTANY AVENUE
 TRACT NO. 2073

DATE: 7/5/67
 DRAWN: J.M.
 CHECKED AND REVISIONS: J.M./J.S.
 APPROVED BY: *Albert A. Webb*
 NO. R-618
 DATE: 7-16-67 SHEET 3 OF 3

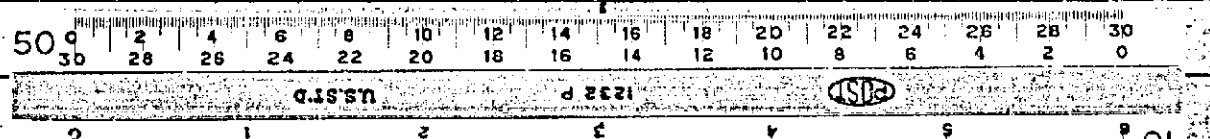



QUANTITY ESTIMATE

Conc. Cross Gutter	1,044	SF
2 1/2" A.C. f Seal Coat	43,670	SF
Imported Dose Material (bedding)	1,875	CY
2x4" Redwood Header	30	LF
Standard No 200 Curb Gutter (C&G)	3,456	LF
Standard No 200 Curb only (C&G)	280	LF
Standard No 125 Curb Sidewalk	14,425	SF
Standard No 350 R Sidewalk	5,275	SF

STREET NAME SIGN SCHEDULE

A	LEEDS ST.	2100
B	PROVENCE PL.	5400
C	LEEDS ST.	2100
D	BRITTANY AVE.	5400
E	FAIRVIEW AVE.	2100
F	BRITTANY AVE.	5400

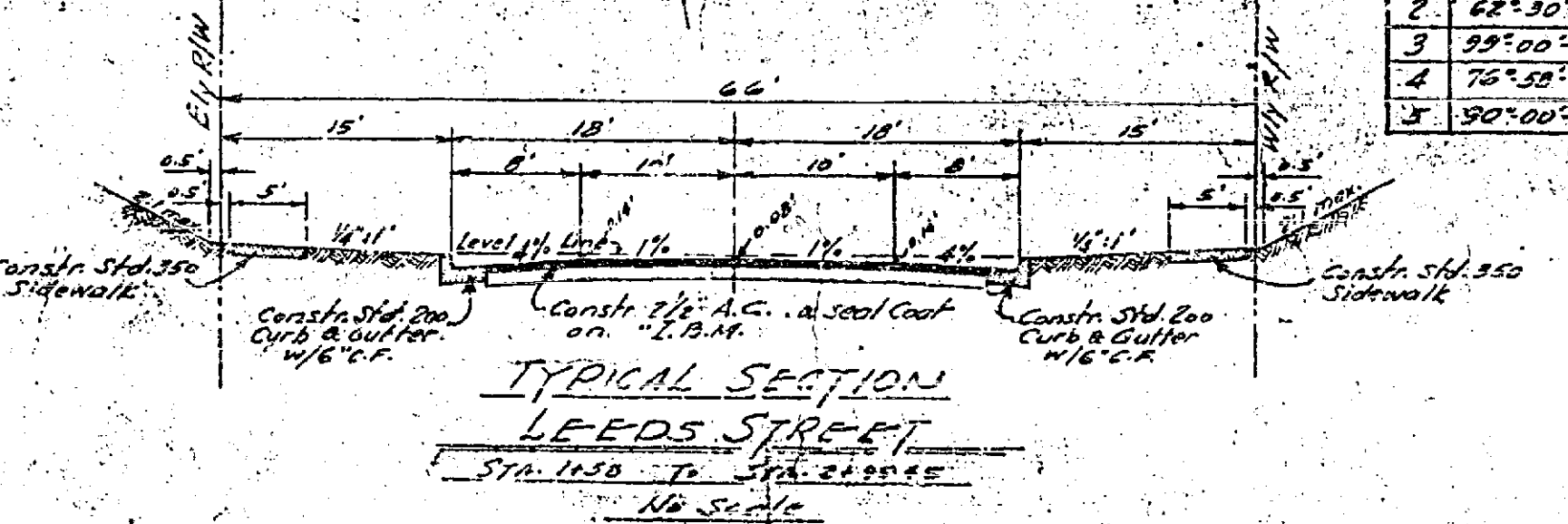
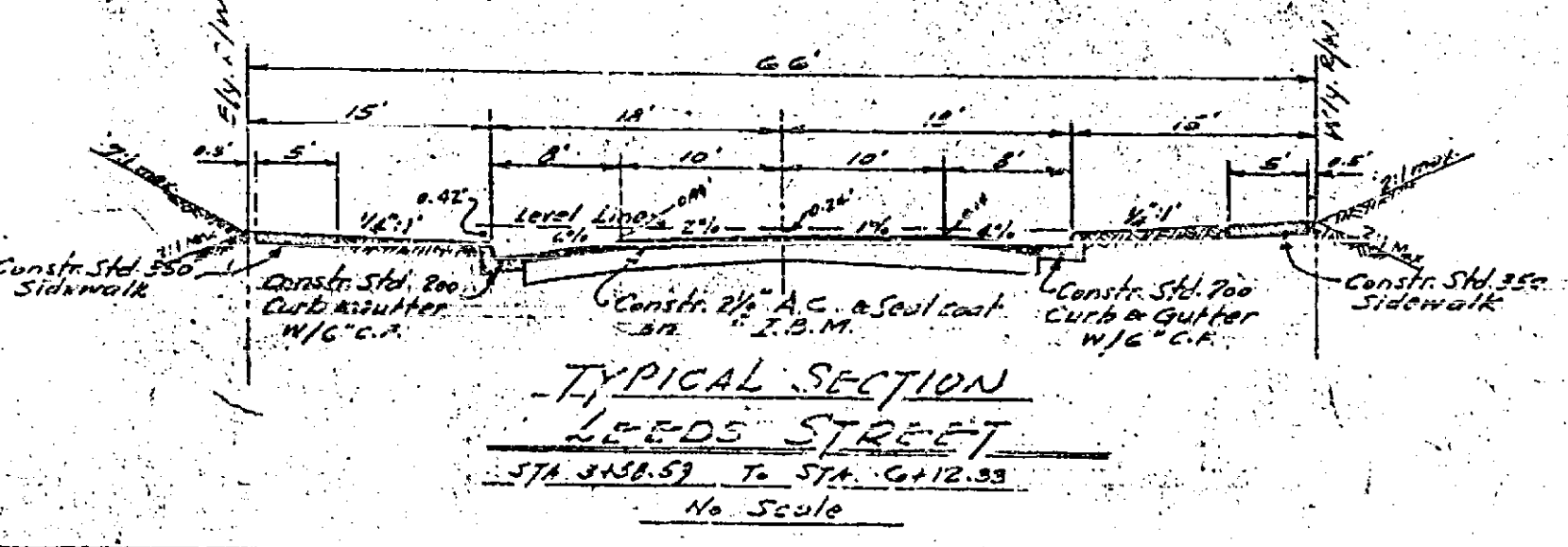

CURB CURVE DATA

No.	A	R	T	L
1	111°53'36"	27'	39.95'	52.78'
2	62°30'35"	27'	16.88'	29.45'
3	89°00'44"	27'	31.42'	46.66'
4	76°58'22"	27'	21.47'	36.27'
5	90°00'20"	27'	29.00'	42.81'

- GENERAL NOTES**
1. THE CITY OF RIVERSIDE WILL TAKE A SOIL TEST TO DETERMINE THE REQUIREMENT ON MIXED BASE MATERIAL AFTER THE STREETS HAVE BEEN REFERRED TO ROAD GRADE.
 2. Construction to be in accordance with Standards and Specific Ordinance No. 461 of the City of Riverside Department of Public Works.
 3. Street name signs and post to be furnished and installed by the Subcontractor as per City Specifications and Standard No. 662.
 4. True edge of existing paving where new paving joins existing pavement to clean straight line.
It shall be the responsibility of the contractor to clear the right-of-way in accordance with the provisions of law as it affects such utility including irrigation lines and appurtenances, and at no cost to the City.
 5. Prime Coat and Patch Binder are required.

ALBERT A. WEBB ASSOCIATES
 CIVIL ENGINEERS - RIVERSIDE, CALIFORNIA
 APPROVED: *[Signature]* DATE 7/8/62
 11 2872

REVISION		
MARK	DATE	DESCRIPTION

CITY OF RIVERSIDE, CALIFORNIA
 DEPARTMENT OF PUBLIC WORKS
STREET PLAN & PROFILE
LEEDS STREET
 TRACT NO. 2073
 APPROVED BY: *[Signature]*
 DIRECTOR OF PUBLIC WORKS
 DATE 7-16-62
 NO. D-618
 SHEET 1 OF 3

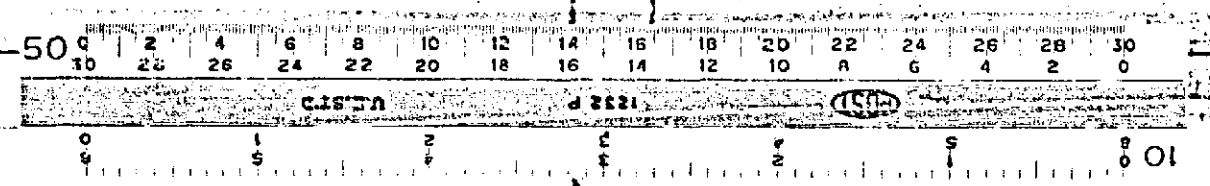

PROFILE

DATE	
BY	
CHECKED	
SCALE	

PLAN

DATE	
BY	
CHECKED	
SCALE	