

B.M. (State) - Brass cap in cone 393' ft.
 575+55 & Improvement.
 ELEV. = 801.44

NOTE - all const. shall be in accordance with City of Riverside Standard Specs.
 no. 461 and standard dwgs.

B.M. (State) - chiseled on 24"
 M.H. pin 208' ft. 588 +02
 ELEV. = 800.88

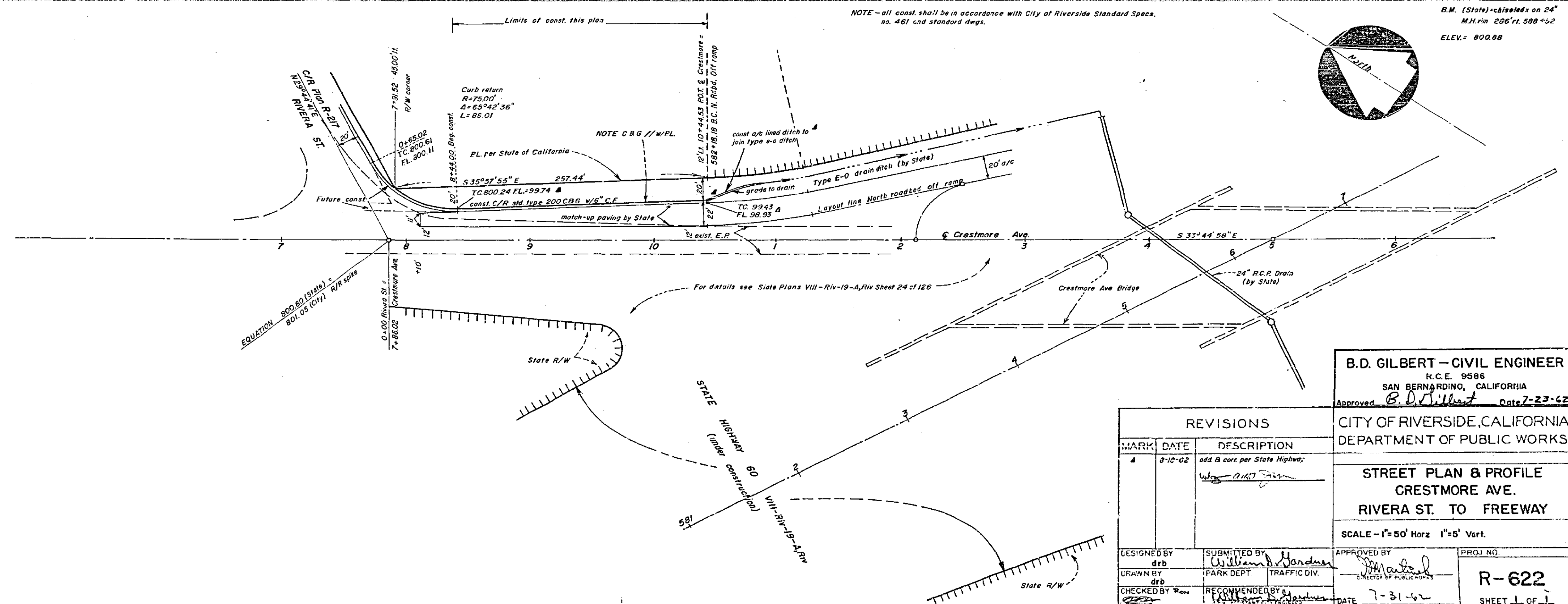

REVISIONS		
MARK	DATE	DESCRIPTION
#	8-10-62	add 8 corr. per State Highway; w/2-11-62

B.D. GILBERT - CIVIL ENGINEER
 R.C.E. 9586
 SAN BERNARDINO, CALIFORNIA
 Approved: *B.D. Gilbert* Date 7-23-62

CITY OF RIVERSIDE, CALIFORNIA
 DEPARTMENT OF PUBLIC WORKS

STREET PLAN & PROFILE
CRESTMORE AVE.
RIVERA ST. TO FREEWAY

SCALE - 1"=50' Horiz 1"=5' Vert.

DESIGNED BY: drb
 DRAWN BY: drb
 CHECKED BY: drb

SUBMITTED BY: *William B. Hansen*
 PARK DEPT. TRAFFIC DIV.
 RECOMMENDED BY: *William B. Hansen*

APPROVED BY: *Marked*
 DATE: 7-31-62

PROJ. NO. R-622
 SHEET 1 OF 1

