

NOTE: Prior to excavation or construction in this area notify the Telephone Co. 24 hours in advance at OV-40071 or KI-76606

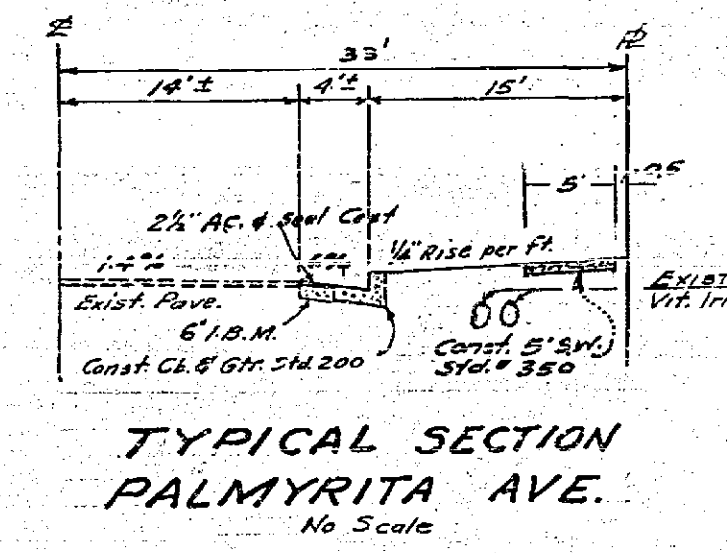

- Notes**
- 1 Bench Mark is spike in curb on La Cadena Dr. West, 13' South of Palmyrita Avenue, Elevation 881.503.
 - 2 All work and materials shall comply with the specifications No. 461, Standards of the City of Riverside, Department of Public Works.
 - 3 If the subdivider desires to reduce the requirement for Imported Base Material, additional soil tests may be taken at the subdividers expense after streets are prepared to rough grade. Subdivider will contact Inspection Division, Dept of Public Works, before making test. The City of Riverside will make a test of Base Material in place before paving can be installed; results of this test must indicate the Base Material is satisfactory to the Inspection Division.
 - 4 Trim edge of existing paving to a clean straight line. Construct match-up paving as shown; and overlay existing paving as directed in the field to produce a smooth crown section.
 - 5 Any relocation of, or repairs to existing irrigation pipe lines resulting from improvements hereon to be at expense of developer.

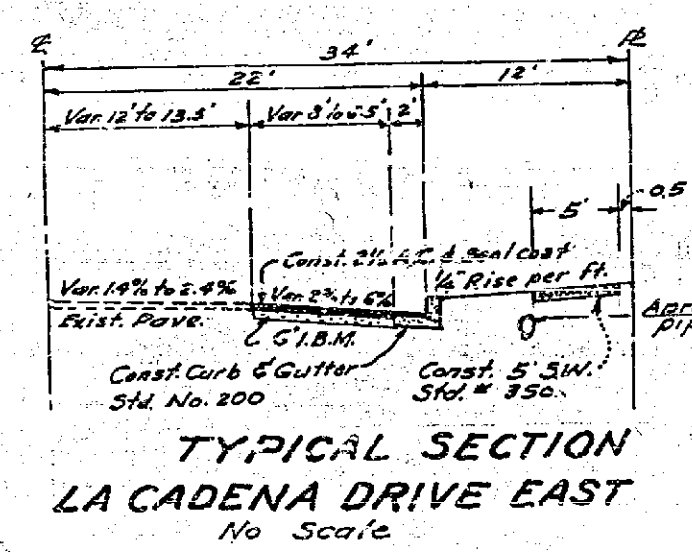
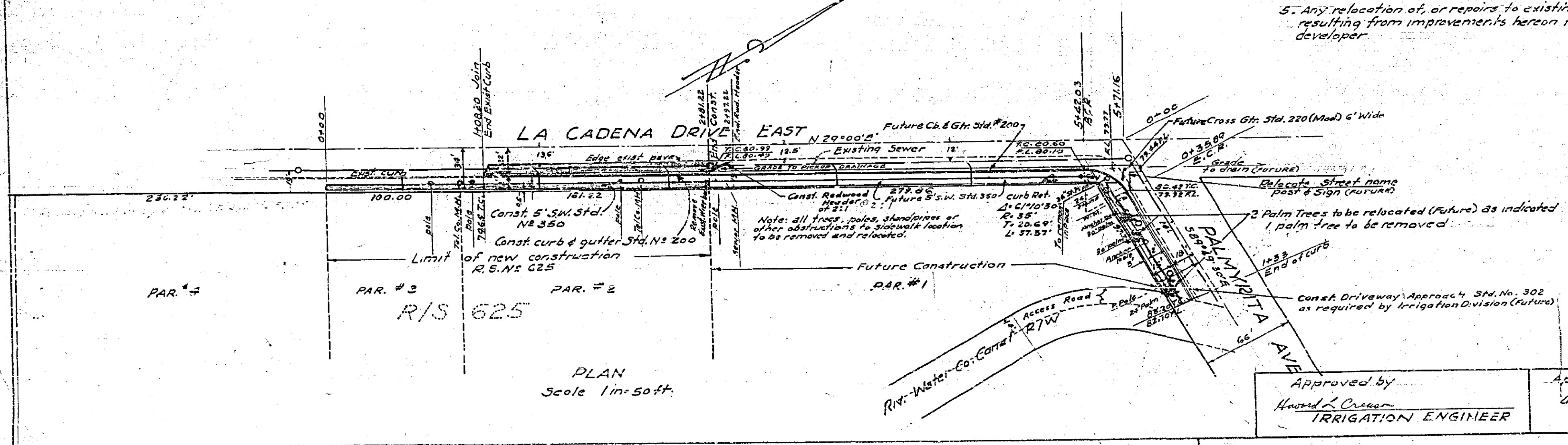

MCKEE & CRAWLEY
 SURVEYORS AND ENGINEERS
 Riverside, California
 Approved: *George O. Crawley* R.E. #19455 Date: 12-21-62

REVISIONS		DESCRIPTION
MARK	DATE	

CITY OF RIVERSIDE CALIFORNIA
 DEPARTMENT OF PUBLIC WORKS
R/S 625
STREET PLANS & PROFILES
LA CADENA DRIVE EAST
& PALMYRITA AVENUE

DESIGNED BY: _____
 DRAWN BY: _____
 CHECKED BY: *WJS*
 RECOMMENDED BY: _____
 APPROVED BY: *George O. Crawley*
 DATE: *Dec 31 1962*
R-627
 SHEET 1 OF 1