

- GENERAL NOTES**
- All construction shall be in accordance with standards and specifications No. 461 of the City of Riverside Department of Public Works.
 - It shall be the responsibility of the contractor to clear the Right of Way in accordance with the provisions of law as it affects each utility including irrigation lines and appurtenances, and at no extra cost to the City of Riverside.
 - Trim edge of existing paving to a clean straight line. Construct match-up paving and overlap on existing paving as directed in the field to produce a smooth crown surface.
 - The City of Riverside will take a soil test to determine the Impaired Base Material thickness after the Streets have been rough graded. Prime coat will be required.
 - All curb depressions to be approved by City Traffic Engineer after submission of detailed Plot Plan.

REVISIONS		
MARK	DATE	DESCRIPTION
Δ	11-29-67	I.D.M. Requirement
Σ	11/29/67	Revised C.B. of Sta 8+42.50 and added C.B. detail. L. 95% width 24" dia

DESIGNED BY: [Signature]
DRAWN BY: [Signature]
CHECKED BY: ADD [Signature]
RECOMMENDED BY: [Signature] ASSISTANT CITY ENGINEER

J. F. DAVIDSON-CIVIL ENGINEER
R.E. NO. 862
RIVERSIDE, CALIFORNIA

APPROVED BY: [Signature] DATE 9-20-67

CITY OF RIVERSIDE, CALIFORNIA
DEPARTMENT OF PUBLIC WORKS

STREET PLAN & PROFILE
EAST
LA CADENA FRONTAGE ROAD
BETWEEN
OXFORD STREET & CITRUS STREET
HORIZ. SCALE 1"=40' VERT. SCALE 1"=4'

APPROVED BY: [Signature]
Director of Public Works

NO. A-632
DATE 10-5-67
SHEET 1 OF 2

PRIVATE ENGINEER'S NOTICE TO CONTRACTORS
Private and Public utilities lines if shown on these plans reflect available record data. The contractor shall be responsible for locating all lines affecting this work and for any change or protection of these lines and shall notify the utility line owners prior to construction.

Note: So called Gas Co. is to be called before start of excavation to be sure for exact location & depth of pipes.

Check top for existing structure per Riv. City Std. 415 (with 100% cover) to Riv. City Std. 416. Frame and cover Riv. City Std. 416. Top of box to be same elev. as TC.

15' spacing with Airport protection bar. Ex. C. B. on Frontage Road. Remove existing walls as necessary to expose steel and construct walls, apron, openings, and pipe.

BENCH MARK: USGS Bench Cap in Concrete 7'11" N. Side Columbia, 30'2" W. of AT&SF RR W. Side. Elev. 892.872
T.B.M. 20' Top 34" IR SW Cor. Lot 26 Elev. 890.46

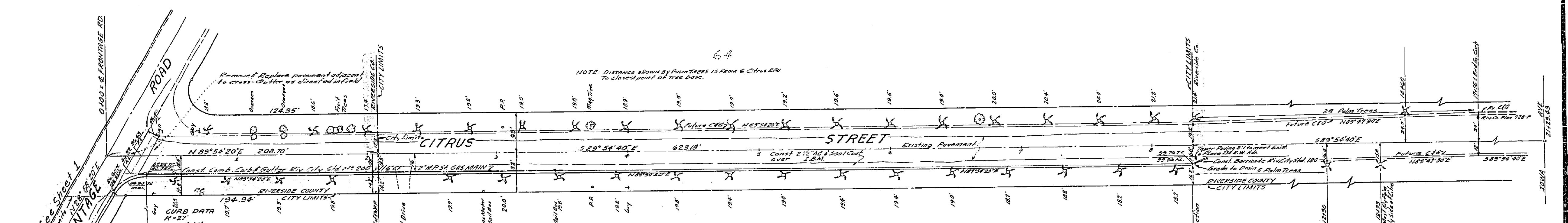
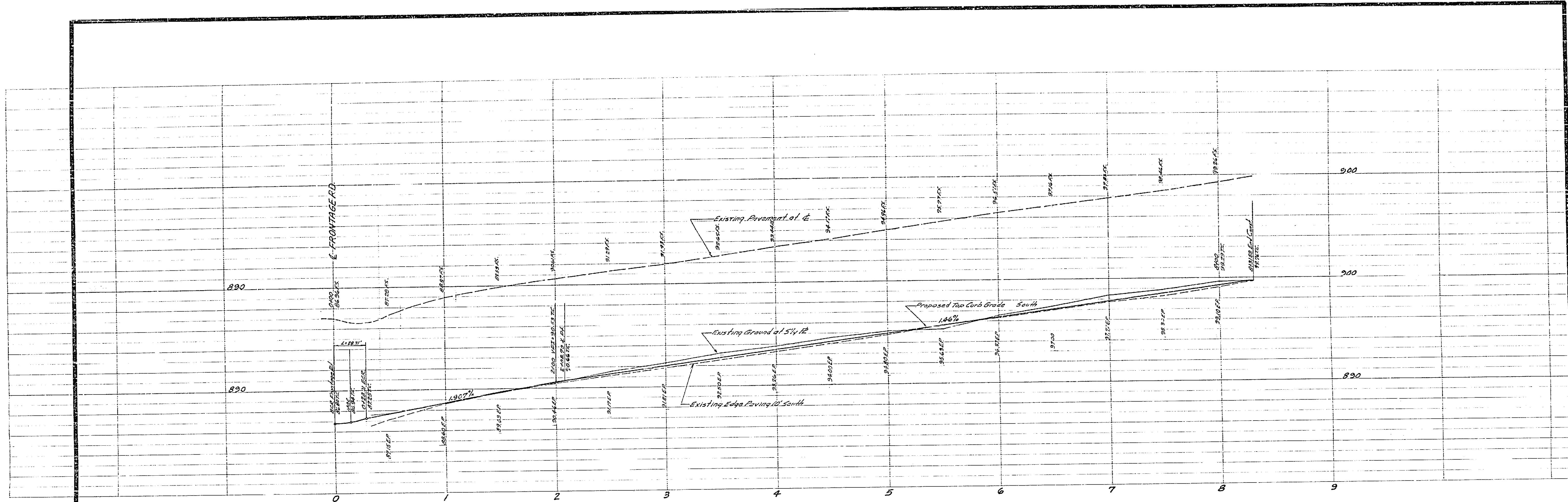

NOTE: CURB LINE IS NOT PARALLEL TO E. OF R/W 54.2+08.70 TO 81.5+15.8

NOTE: DISTANCE SHOWN BY PAINT TREES IS FROM E. CITRUS R/W TO CLOSEST POINT OF TREE BASE.

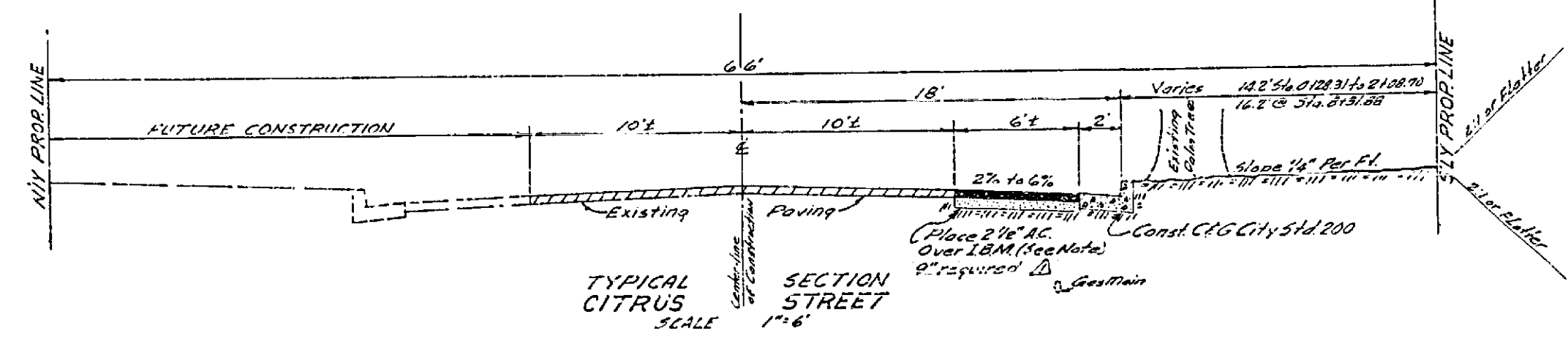

REVISIONS		
MARK	DATE	DESCRIPTION
A	11-23-62	I.S.M. requirements

FOR CONSTRUCTION IN COUNTY

APPROVED BY: *[Signature]*
 City of Riverside
 Riverside, California
 Date: 12-2-62 For Road Commission

J. F. DAVIDSON - CIVIL ENGINEER
 R.E. NO. 862
 RIVERSIDE, CALIFORNIA

APPROVED BY: *[Signature]* DATE 2-28-62
 Director of Public Works
 City of Riverside

CITY OF RIVERSIDE, CALIFORNIA
DEPARTMENT OF PUBLIC WORKS

STREET PLAN & PROFILE
CITRUS STREET

FROM LACADENA 83+88' EASTERLY
 HORIZ. SCALE 1"=40' VERT. SCALE 1"=4'

DESIGNED BY: *[Signature]*
 DRAWN BY: *[Signature]*
 RECOMMENDED BY: *[Signature]*
 ASSISTANT CITY ENGINEER

CHECKED BY: *[Signature]*
 ADD

APPROVED BY: *[Signature]*
 Director of Public Works
 Date: 10-5-62

NO. R-632
 SHEET 2 OF 2

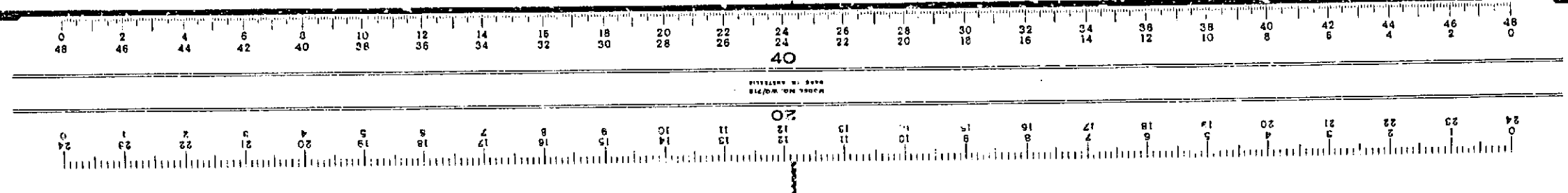

RD 788-27

2/98