

PROFILE	DATE
NO. 1	3-19-63
NO. 2	
NO. 3	
NO. 4	
NO. 5	
NO. 6	
NO. 7	
NO. 8	
NO. 9	
NO. 10	
NO. 11	
NO. 12	
NO. 13	
NO. 14	
NO. 15	
NO. 16	
NO. 17	
NO. 18	
NO. 19	
NO. 20	
NO. 21	
NO. 22	
NO. 23	
NO. 24	
NO. 25	
NO. 26	
NO. 27	
NO. 28	
NO. 29	
NO. 30	
NO. 31	
NO. 32	
NO. 33	
NO. 34	
NO. 35	
NO. 36	
NO. 37	
NO. 38	
NO. 39	
NO. 40	
NO. 41	
NO. 42	
NO. 43	
NO. 44	
NO. 45	
NO. 46	
NO. 47	
NO. 48	
NO. 49	
NO. 50	

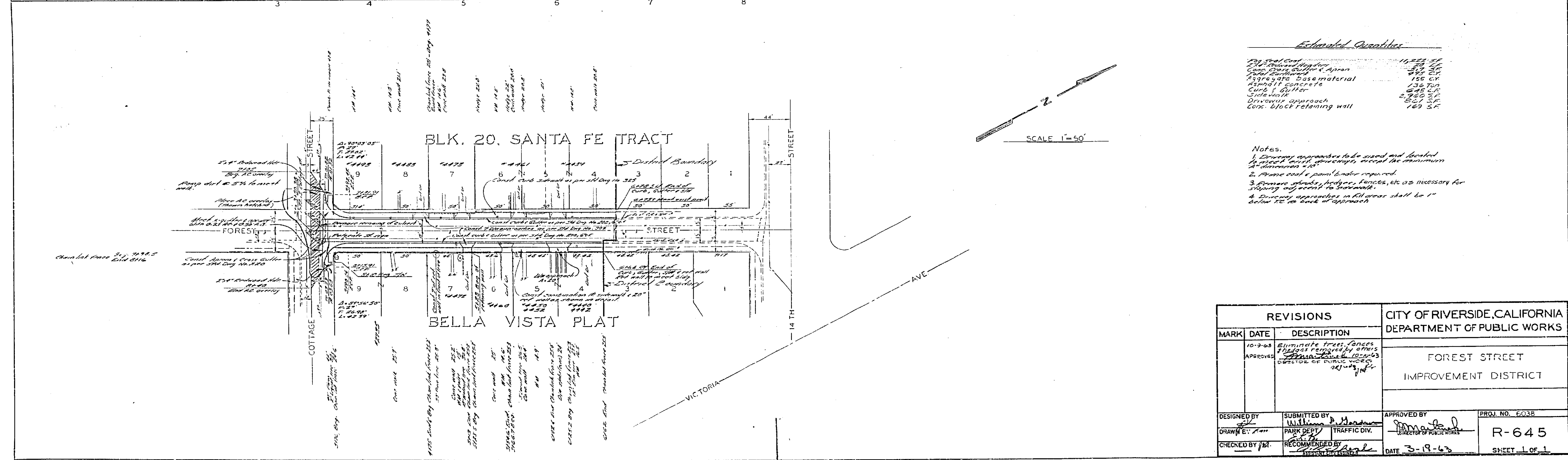

Estimated Quantities

Excavation	11,222 cu yd
Gravel	250 cu yd
Crushed Stone	150 cu yd
Asphalt Concrete	136 Ton
Concrete	2,950 cu yd
Reinforcing Steel	250 cu yd
Driveway Approach	250 cu yd
Concrete Block Retaining Wall	140 cu yd

- Notes.*
1. Driveway approaches to be paved and located to meet utility requirements, except the minimum 4' driveway width.
 2. Prime coat & paint/sealer required.
 3. Remove grades, bridges, fences, etc. as necessary for shifting adjacent to sidewalk.
 4. Driveway approaches in full view shall be 1' below the back of approach.

PLAN	DATE
NO. 1	3-19-63
NO. 2	
NO. 3	
NO. 4	
NO. 5	
NO. 6	
NO. 7	
NO. 8	
NO. 9	
NO. 10	
NO. 11	
NO. 12	
NO. 13	
NO. 14	
NO. 15	
NO. 16	
NO. 17	
NO. 18	
NO. 19	
NO. 20	
NO. 21	
NO. 22	
NO. 23	
NO. 24	
NO. 25	
NO. 26	
NO. 27	
NO. 28	
NO. 29	
NO. 30	
NO. 31	
NO. 32	
NO. 33	
NO. 34	
NO. 35	
NO. 36	
NO. 37	
NO. 38	
NO. 39	
NO. 40	
NO. 41	
NO. 42	
NO. 43	
NO. 44	
NO. 45	
NO. 46	
NO. 47	
NO. 48	
NO. 49	
NO. 50	

REVISIONS		CITY OF RIVERSIDE, CALIFORNIA	
MARK	DATE	DESCRIPTION	DEPARTMENT OF PUBLIC WORKS
	10-2-62	Eliminate trees, fences, bridges removed by others	FOREST STREET IMPROVEMENT DISTRICT
APPROVED		Director of Public Works	
DESIGNED BY		SUBMITTED BY	APPROVED BY
DRAWN BY		PARK DEPT	TRAFFIC DIV.
CHECKED BY		RECOMMENDED BY	DATE 3-19-63
		PROJECT NO. 6038	R-645
			SHEET 1 OF 1