

DATE	
BY	
NO.	
PLAN	
NOTE BOOK	
ALIGNMENT CHECKED	
BY	
NO.	

DATE	
BY	
NO.	
PROFILE	
NOTE BOOK	
GRADES CHECKED	
BY	
NO.	

- NOTES**
1. CONST. S/W PER STD. DWG. #350
 2. CONST. S/W APPROACH, SIZE AND LOCATION TO BE DETERMINED BY OWNERS IN CONFORMANCE WITH STD. DWG. #302
 3. CONST. C & G, PER STD. DWG. #200 JOIN EXIST. C & G, STA. 0+29.40 AND STA. 2+10.70
 4. ALL CONSTRUCTION SHALL BE IN ACCORDANCE WITH THE CITY OF RIVERSIDE STD. SPEC. N 1461
 5. IT SHALL BE THE RESPONSIBILITY OF THE CONTRACTOR TO CLEAR THE RIGHT OF WAY IN ACCORDANCE WITH THE PROVISION OF LAW AS IT AFFECTS EACH UTILITY, INCLUDING IRRIGATION LINES AND APPURTENANCES, AND AT NO COST TO THE CITY OF RIVERSIDE.

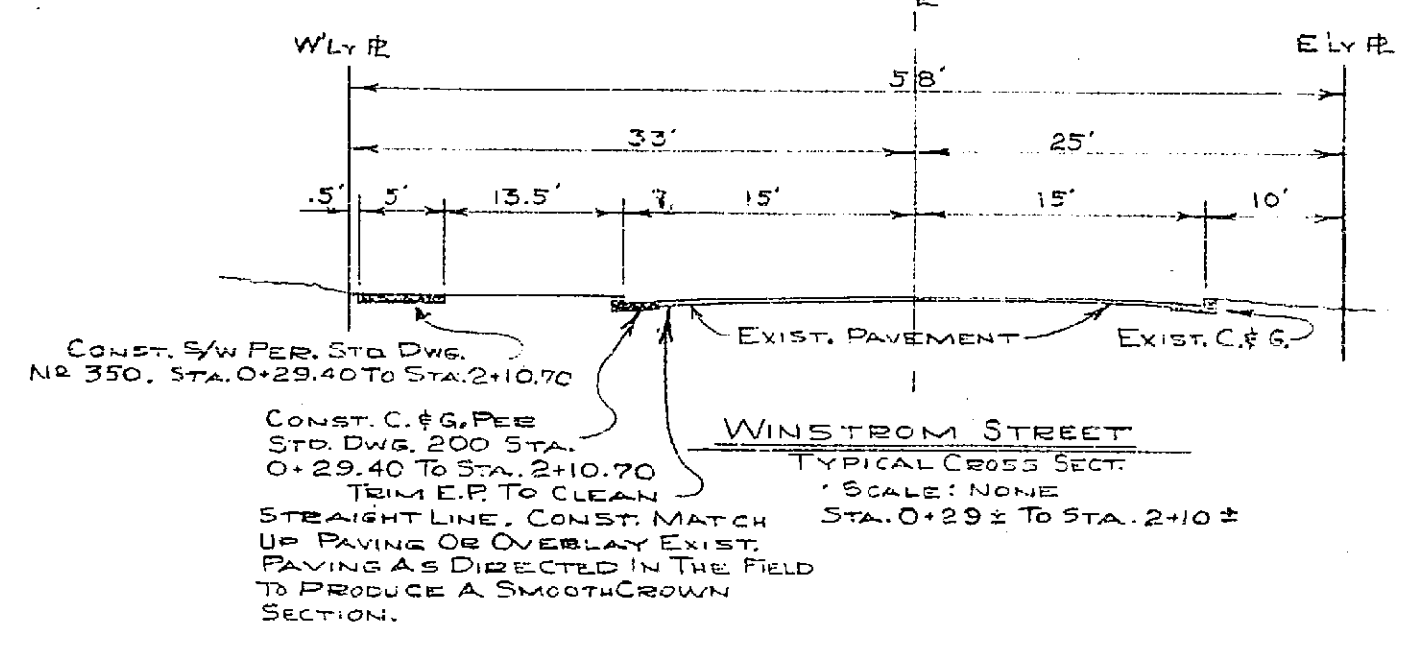
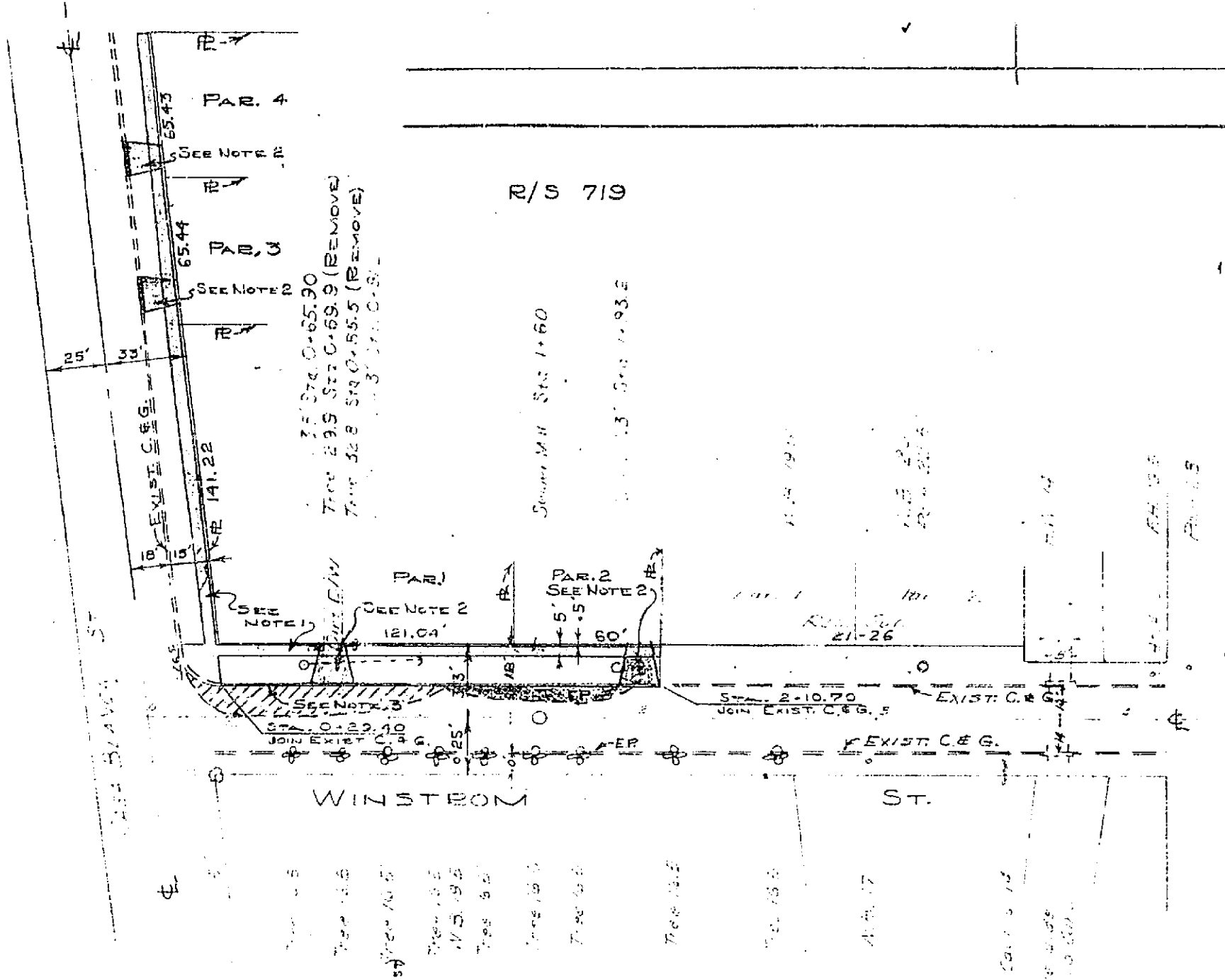

- LEGEND:**
- [Hatched pattern] OVERLAY EXIST. PAVING TO PRODUCE A SMOOTH CROWN.
 - [Dotted pattern] MATCH UP PAVING TO PRODUCE A SMOOTH CROWN.

B.M. EL. 859.53 R.B. SHIKE IN POLE #11188J S.W. COR. WINSTROM & CASA BLANCA ST. F.B. 407-29

SCALE: HORIZ. 1"=50'
VERT. 1"=5'

F.B. W-1 P6231-33

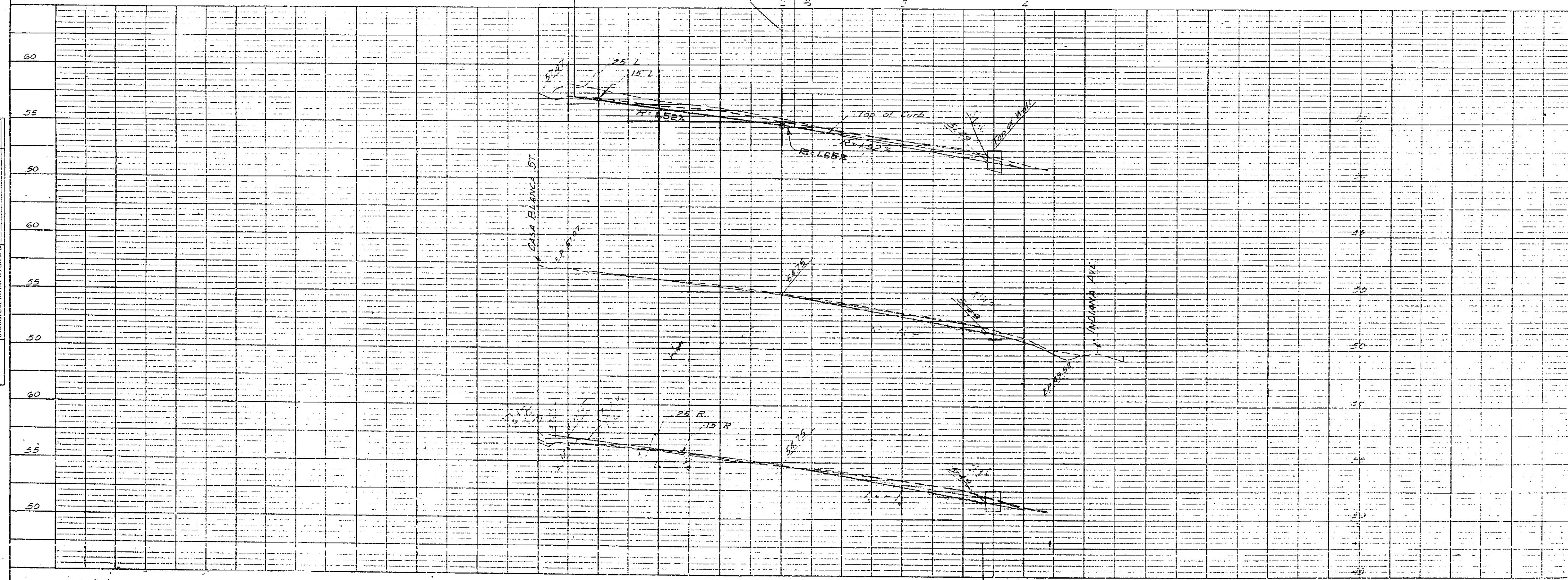

REVISIONS		CITY OF RIVERSIDE, CALIFORNIA DEPARTMENT OF PUBLIC WORKS	
MARK	DATE	DESCRIPTION	
		WINSTROM ST.	
		CASA BLANCA ST. TO INDIANA AVE.	
		ADAPTED FROM PLAN NO. 1484	
DESIGNED BY	CAE	SUBMITTED BY	M
DRAWN BY	A.F.W.	PARK DEPT.	TRAFFIC DIV.
CHECKED BY		RECOMMENDED BY	
		APPROVED BY	
		DATE	2-1-52
		PROJ. NO.	R-661
		SHEET	1 OF 1

PLATE 1: PLAN-PROFILE, P.A.S.
CLEARANCE PAPER CO. S.F. CAL.
NO. 200012

