

- General Notes**
- It shall be the responsibility of the Contractor to clear the right of way in accordance with the provisions of law as it affects each utility including irrigation lines and appurtenances and of no cost to the City.
  - Construction shall be in accordance with the City of Riverside Department of Public Works, Specifications No. 451 and Standard Drawings.
  - Prime coat, seal coat, and paint binder are required.
  - Grading will require a permit under Ordinance 3093 for a cut or fill exceeding 100 cubic yards or a fill over one foot in depth.
  - Contractor shall contact Santa Fe Railroad Division Office in San Bernardino 48 hours prior to any construction within the City.
  - Prior to construction the Contractor shall sign a Santa Fe Railroad safe-harmless letter agreement and obtain Santa Fe Railroad approval of insurance.

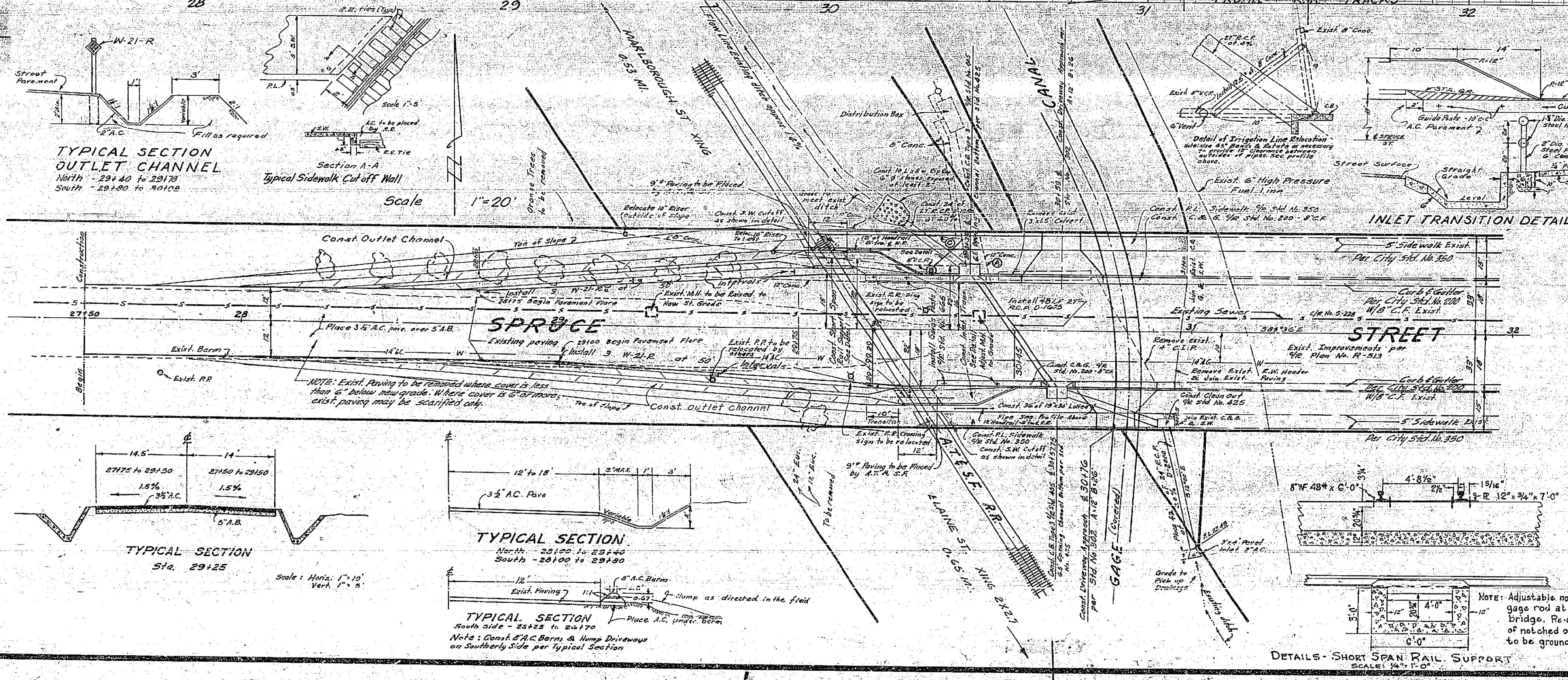
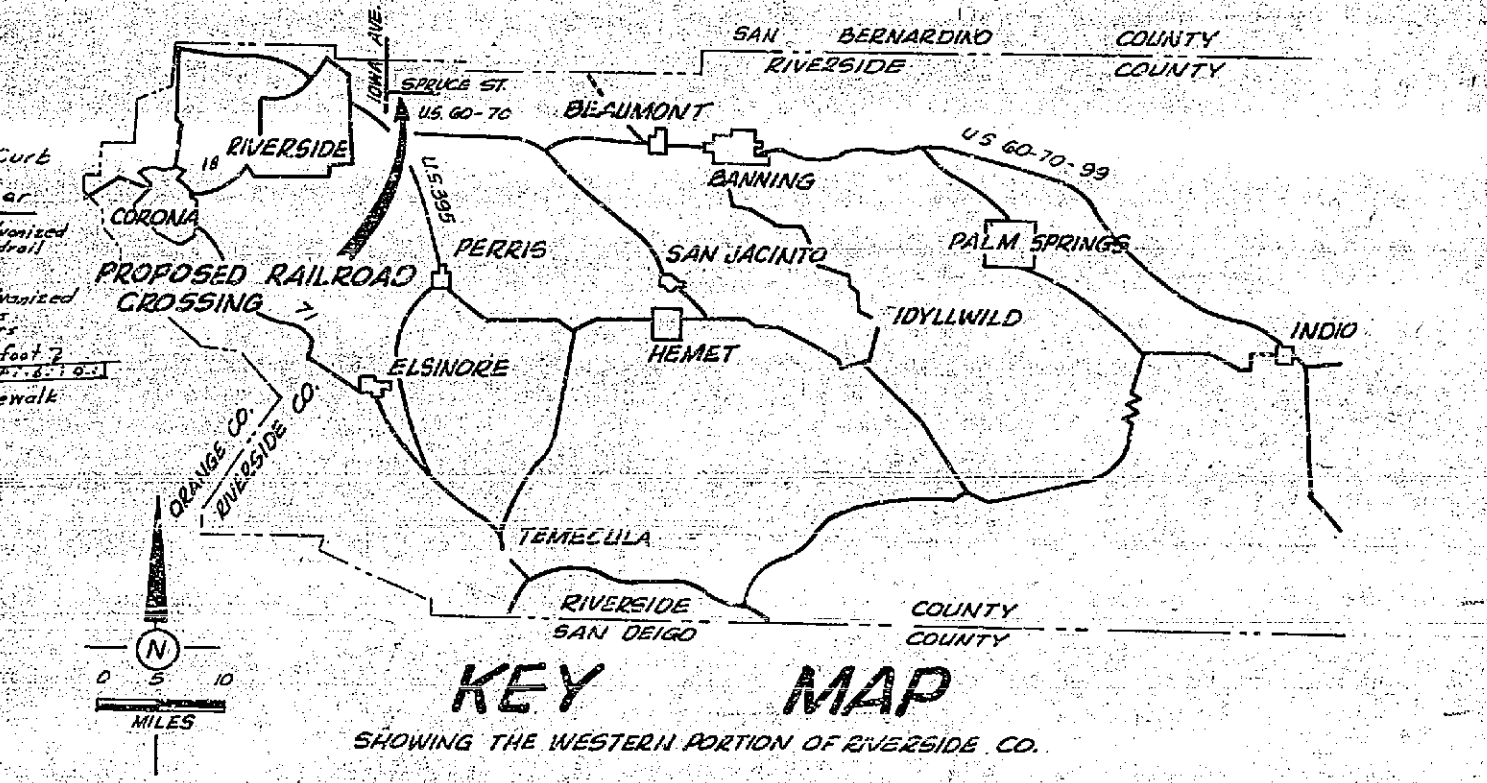
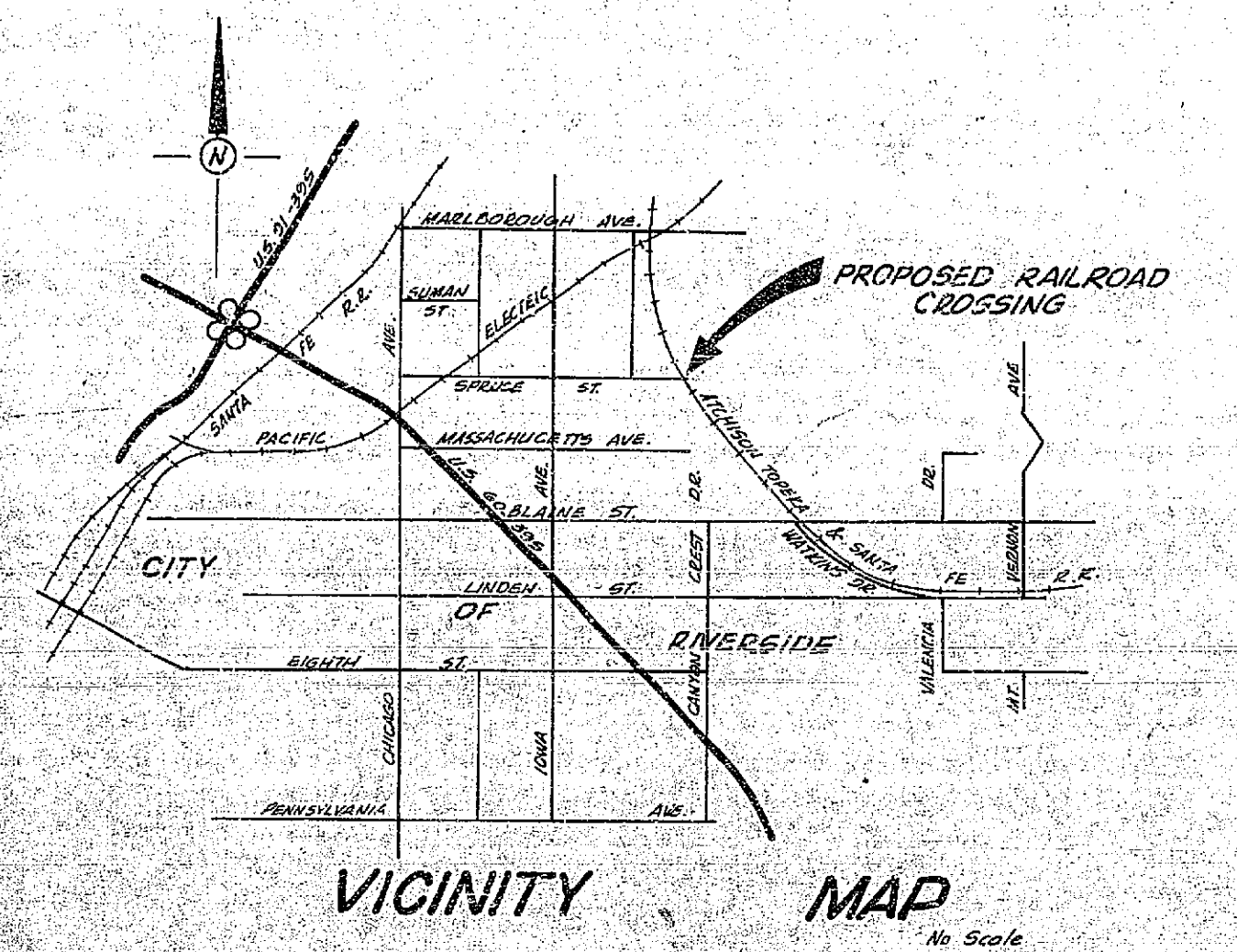

Approved by Gage Canal Company <i>[Signature]</i> 1/10/65 Date		J. F. DAVIDSON-CIVIL ENGINEER R.E. NO. 862 RIVERSIDE, CALIFORNIA APPROVED BY <i>[Signature]</i> DATE 2/11/65	
<b>REVISIONS</b>			
MARK	DATE	DESCRIPTION	
<b>CITY OF RIVERSIDE, CALIFORNIA DEPARTMENT OF PUBLIC WORKS</b>			
<b>STREET PLAN &amp; PROFILE PROPOSED IMPROVEMENT OF SPRUCE ST. (INDIANAPOLIS AVE) AND A.T. &amp; S.F. RAILWAY CROSSING NO. 2 X-2-02</b>			
DESIGNED BY <i>[Signature]</i>	CHECKED BY <i>[Signature]</i>	APPROVED BY <i>[Signature]</i> Director of Public Works	NO. R-676
RECOMMENDED BY <i>[Signature]</i> ASSISTANT CITY ENGINEER	DATE 1-11-65	SHEET 1 OF 1	