

PROFILE	DATE
930	
928	
930	
928	
930	
928	

EL. 927.875 S&L IN  
B.M. NE CORN. BET. OF  
DOUGLASS & LOMA VISTA  
F.B.'L' 37/39  
SCALE S. VERT. 1" = 2'  
HORIZ. 1" = 20'

- NOTES:**
1. ALL CONST. SHALL BE IN ACCORDANCE WITH STANDARDS AND SPECIFICATIONS NO. 461 OF THE CITY OF RIVERSIDE, DEPT. OF PUBLIC WORKS.
  2. IT SHALL BE THE RESPONSIBILITY OF THE CONTRACTOR TO CLEAR THE RIGHT OF WAY IN ACCORDANCE WITH THE PROVISIONS OF THE LAW AS IT AFFECTS EACH UTILITY, INCLUDING IRRIGATION LINES AND APPURTENANCES, AND AT NO COST TO THE CITY.
  3. TRIM EDGE OF PAVING TO CLEAN STRAIGHT LINE. CONSTRUCT MATCH UP PAVING AS SHOWN AND OVERLAY EXISTING PAVING AS DIRECTED IN THE FIELD TO PRODUCE A SMOOTH CROWN SECTION.
  4. PRIME COAT, PAINT BINDER, AND SEAL COAT WILL BE REQUIRED.
  5. DEPRESS CURB AT EXISTING P.W.'S TO CONFORM TO STD. DWG. # 302.

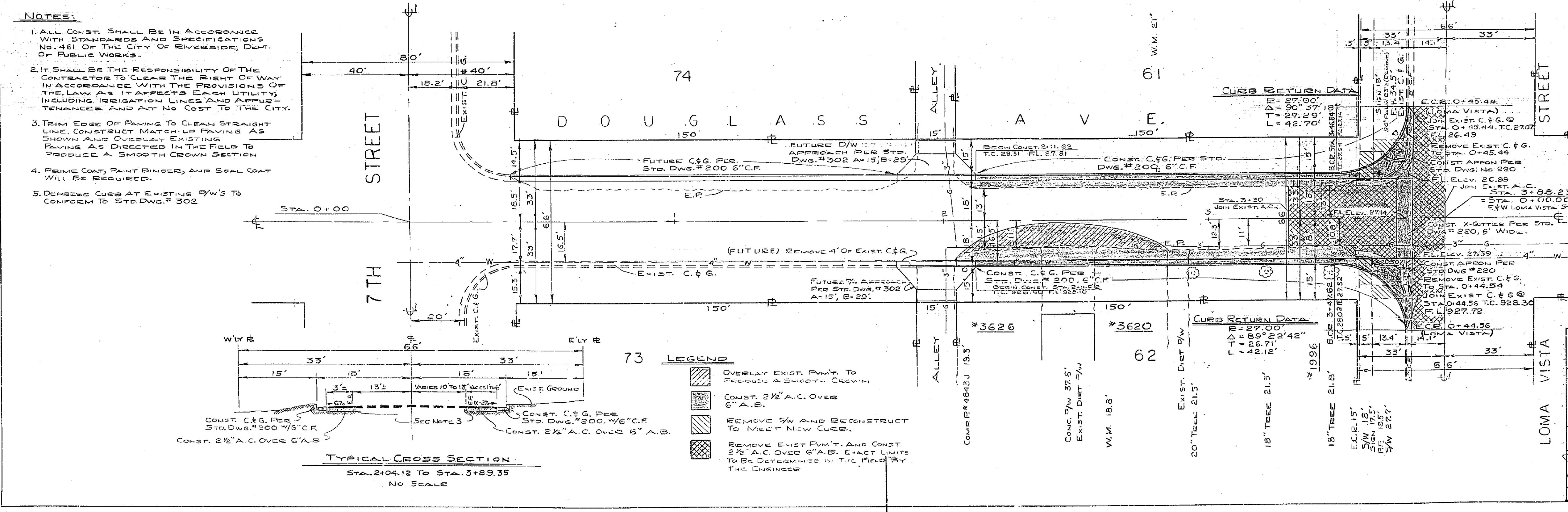

REVISIONS		
MARK	DATE	DESCRIPTION

DESIGNED BY *DAW* SUBMITTED BY *L.A. L...*  
 DRAWN BY *A.F.W.* PARK DEPT. *...*  
 CHECKED BY *...* RECOMMENDED BY *...*

**CITY OF RIVERSIDE, CALIFORNIA**  
 DEPARTMENT OF PUBLIC WORKS

**DOUGLASS AVE.**  
 7TH TO LOMA VISTA

STA. 0+00 TO STA. 3+88.23

APPROVED BY *...* PROJ. NO. 1012  
 DATE 7-15-63 R-680  
 SHEET 1 OF 1

PLAN	DATE