

**General Notes**

1. All work and materials shall comply with the Specifications, Needs and Standards of the City of Riverside, Dept. of Public Works.
2. The contractor is required to take due precautionary measures to protect the utilities or structures shown and any other utilities or structures on the site. It shall be the contractor's responsibility to notify the owners of the utilities or structures concerned before starting work.
3. Irrigation lines and appliances to be removed or relocated by contractor as directed by irrigation company involved.
4. B.M. is on curb, east end of return, of N.E. corner VICTORIA and CENTRAL AVE. Elev. 949.62'
5. Prime Coat, Seal Coat & Paint binder required.
6. New B.M. is chiseled on top, west end of divider island & CENTRAL AVE. 50' east of E VICTORIA AVE. Elev. 949.62'

|                |              |
|----------------|--------------|
| PROJECT        | NO. 11-6-63  |
| DATE           | 4-1-64       |
| DESIGNED BY    | W.C. Crawley |
| DRAWN BY       | W.C. Crawley |
| CHECKED BY     | W.C. Crawley |
| APPROVED BY    | W.C. Crawley |
| RECOMMENDED BY | W.C. Crawley |
| DATE           | 4-1-64       |

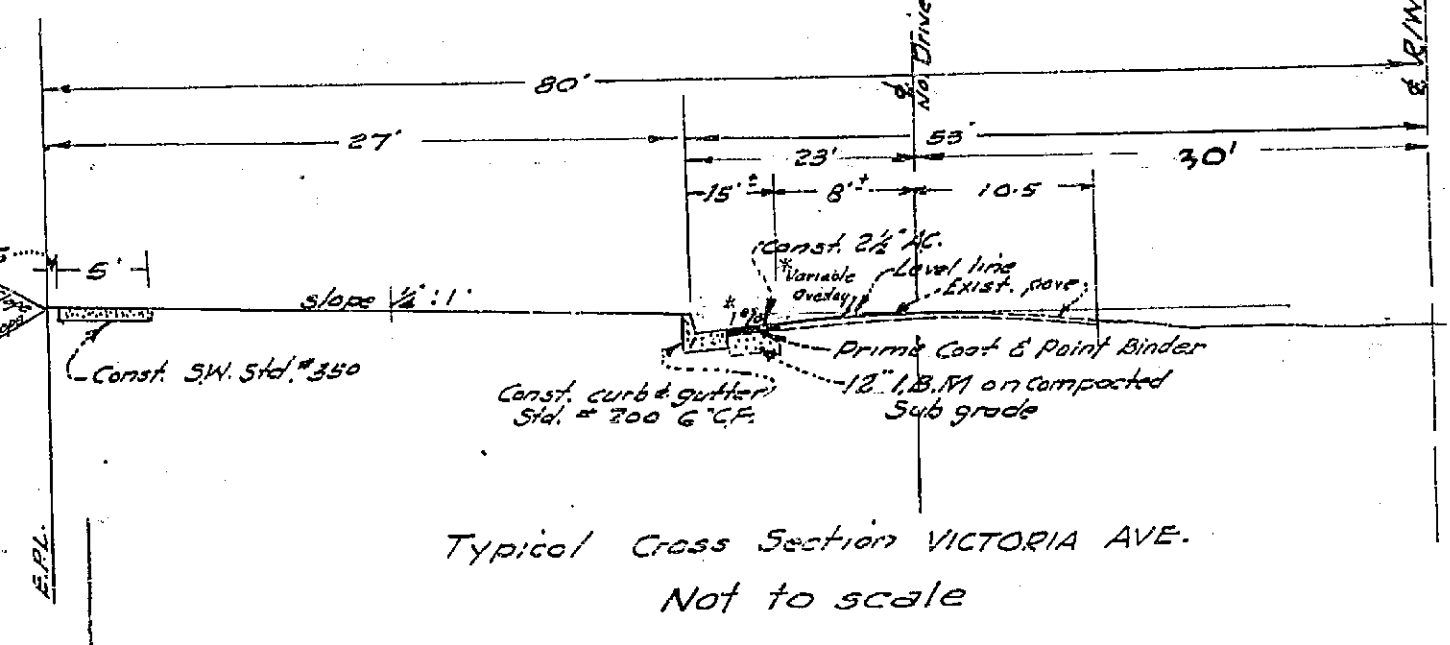
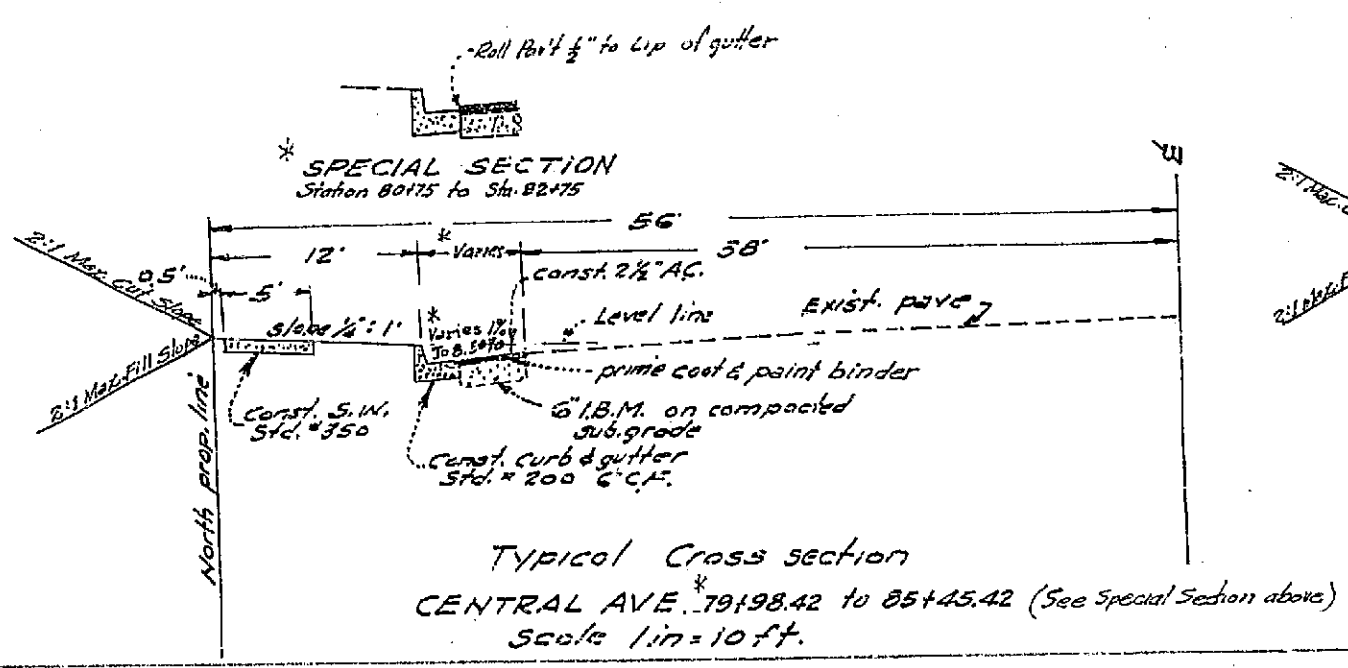
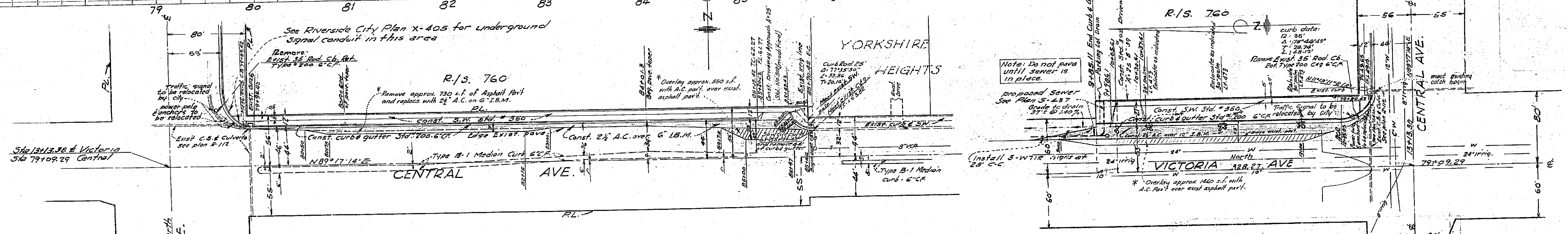

|  |        |  |   |
|--|--------|--|---|
| <b>McKee &amp; Crawley</b><br>SURVEYORS AND ENGINEERS<br>Riverside, California<br>Approved: <i>George O. Crawley</i> Date: 3-22-63<br>P.E. No. 9455                    |        | <b>PARK AND RECREATION DEPARTMENT</b><br>Approved: <i>Edna R. Vandier</i> 11-6-63<br>Date: 3-22-63<br>Parks Superintendent |   |
| <b>REVISIONS</b>   |        | <b>CITY OF RIVERSIDE CALIFORNIA DEPARTMENT OF PUBLIC WORKS</b>   |   |
| MARK   | DATE   | DESCRIPTION  |   |
| *  | 6-1-66 | Added existing part, part of removal and grade change on Victoria Ave. between Victoria and Central Aves. W.C. Crawley     |   |
| DESIGNED BY: <i>W.C. Crawley</i><br>DRAWN BY: <i>W.C. Crawley</i><br>CHECKED BY: <i>W.C. Crawley</i><br>RECOMMENDED BY: <i>W.C. Crawley</i><br>ASSISTANT CITY ENGINEER |        |  | APPROVED BY: <i>Edna R. Vandier</i><br>DIRECTOR OF PUBLIC WORKS<br>DATE: 4-1-64<br>SHEET 1 OF 2 |



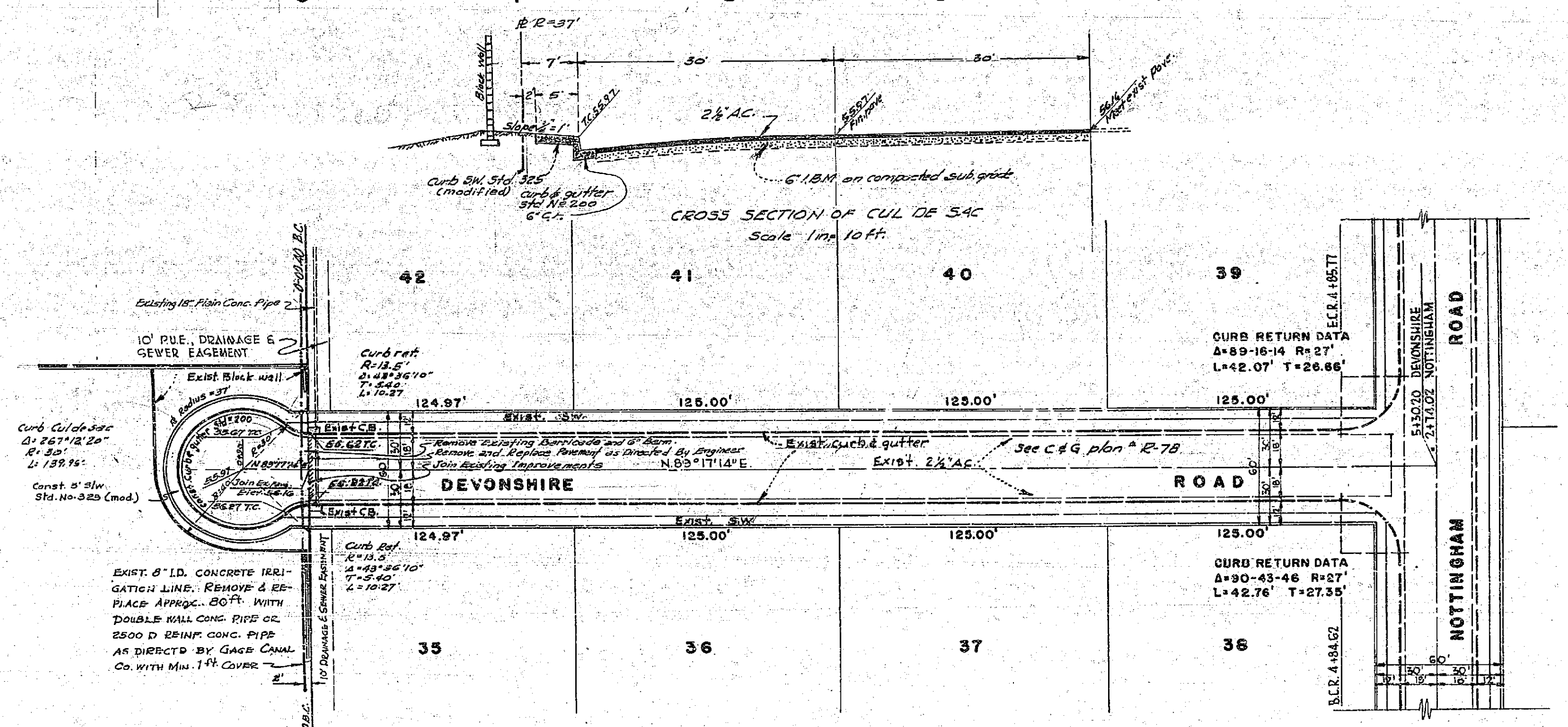
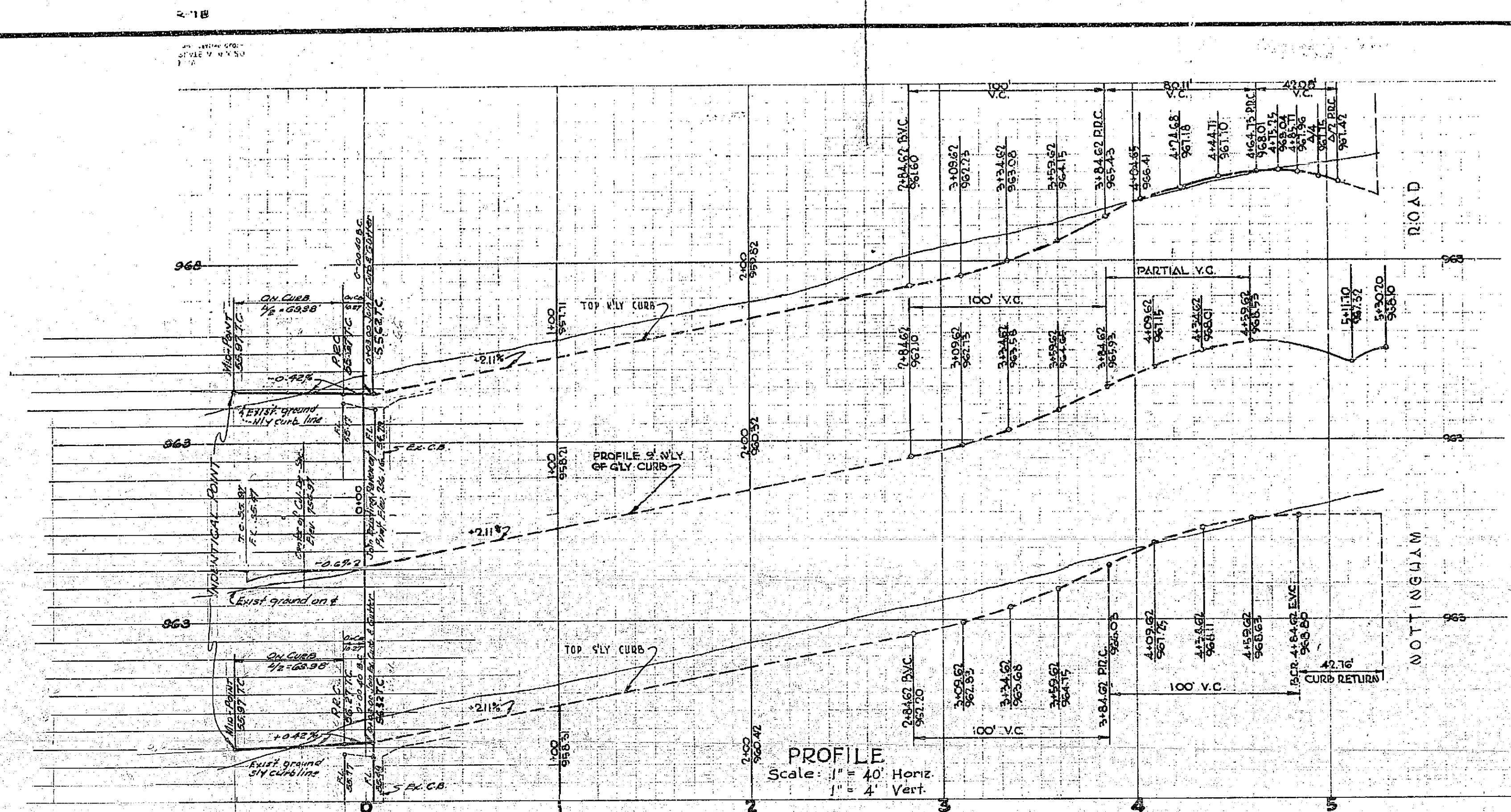

**GENERAL NOTES:-**

1. THE CONTRACTOR IS REQUIRED TO TAKE DUE PRECAUTIONARY MEASURES TO PROTECT THE UTILITIES OR STRUCTURES SHOWN AND ANY UTILITIES OR STRUCTURES AT THE SITE. IT SHALL BE THE CONTRACTOR'S RESPONSIBILITY TO NOTIFY THE OWNERS OF UTILITIES OR STRUCTURES CONCERNED BEFORE STARTING WORK.
2. ALL WORK AND MATERIALS SHALL COMPLY WITH THE SPECIFICATIONS NO. 461 AND STANDARD DRAWINGS OF THE CITY OF RIVERSIDE DEPARTMENT OF PUBLIC WORKS.
3. PRIME COAT AND PAINT BINDER WILL BE REQUIRED.
4. THE CITY OF RIVERSIDE WILL TAKE A SOIL TEST TO DETERMINE THE REQUIREMENT ON IMPORTED BASE MATERIAL AFTER THE STREETS HAVE BEEN PREPARED 2 INCH GRADE.
5. STREET NAME SIGNS AND POSTS TO BE FURNISHED AND INSTALLED BY THE SUBDIVIDER PER CITY SPECIFICATIONS AND STANDARD DRAWING NO. 662.
6. CONTRACTOR SHALL NOT PLACE ROCK LARGER THAN 6" WITHIN 5' OF PROPOSED SEWER SHOWN ON CITY PLAN NO. 5-303.
7. IT SHALL BE THE RESPONSIBILITY OF THE CONTRACTOR TO CLEAR THE RIGHT OF WAY IN ACCORDANCE WITH THE PROVISIONS OF THE LAW AT IT AFFECTS EACH UTILITY INCLUDING IRRIGATION LINES AND APPURTENANCES AND AT NO COST TO THE CITY.
8. New B.M. is chiseled on top of the west end of divider island, & CENTRAL AVE. 50' east of & VICTORIA AVE. Elev. 949.62

|   |                               |   |       |
|---|-------------------------------|---|-------|
| <b>GAGE CANAL</b><br>Approved: <i>[Signature]</i> Date: 11-5-63 |                               | <b>McKee &amp; CRAWLEY</b><br>SURVEYORS AND ENGINEERS<br>Riverside, California<br>Approved: <i>[Signature]</i> Date: 2-26-63<br>R.E. No. 9455           |       |
| <b>REVISIONS</b><br>MARK DATE DESCRIPTION                       |                               | CITY OF RIVERSIDE CALIFORNIA<br>DEPARTMENT OF PUBLIC WORKS<br><b>RECORD OF SURVEY 760</b><br><b>STREET PLAN &amp; PROFILE</b><br><b>DEVONSHIRE ROAD</b> |       |
| DESIGNED BY   | CHECKED BY <i>[Signature]</i> | APPROVED BY <i>[Signature]</i>  | R-684 |
| DRAWN BY  |                               | DIRECTOR OF PUBLIC WORKS  |       |
| RECOMMENDED BY <i>[Signature]</i>                               | ASSISTANT CITY ENGINEER       | DATE 9-1-64   |       |

