

DRIVEWAY SCHEDULE	
REYNARD AVENUE	
1+13.20 RT.	Profile of Beginning of Driveway
2+60.20 EN.	1+50.00 LT.
3+20.00 EN.	4+07.20 RT.
4+07.20 RT.	1+06.00 LT.
2+09.00 LT.	2+60.00 LT.
3+67.40 LT.	3+85.50 LT.
FOOTHILL AVENUE	
1+77.40 LT.	1+95.30 LT.
3+41.00 LT.	3+82.70 LT.
6+06.80 LT.	6+16.10 LT.
7+69.20 LT.	9+11.90 LT.
9+16.00 LT.	11+71.90 LT.
7+89.10 LT.	12+37.70 LT.
All D/W's on RT. side of street.	

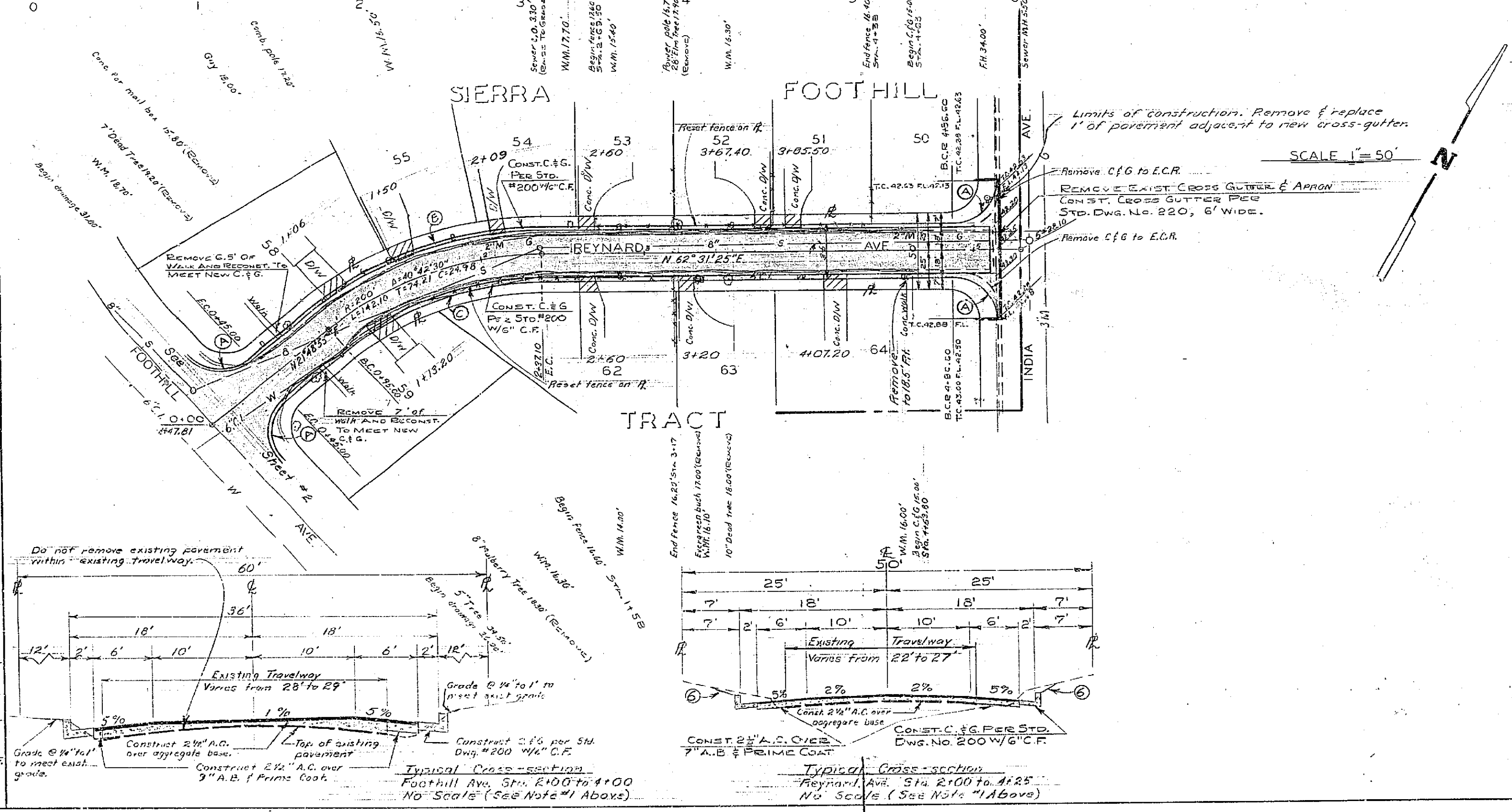

- Structural cross-section will remain the same but crown will have variable slope in portions not shown in typical cross-section.
 - PRIME COAT, PAINT BINDER, AND SEAL COAT ARE REQUIRED.
 - Const. D/W Approaches Per Std. Drawing No. 302 & D/W Schedule A1 left. A = Existing D/W Width, B = Existing D/W Width 17'. Const. curb sidewalk type D/W.
 - IT SHALL BE THE RESPONSIBILITY OF THE CONTRACTOR TO CLEAR THE RIGHT OF WAY IN ACCORDANCE WITH THE PROVISIONS OF THE L.A.S. IT AFFECTS EACH UTILITY, INCLUDING IRRIGATION LINES AND APPURTENANCES, AND AT NO COST TO THE CITY, EXCEPT WATER METERS AND POWER LINES.
 - Existing street signs and mailboxes to be relocated behind curb.
 - Grade behind curb line to meet existing ground within 2' in cut area and meet existing ground of 18' in fill area.
- Legend**
- Remove existing D/W's within R/W and construct D/W approaches per note 3 and D/W schedule A1 left.
 - Pave with maximum of 2 1/2" A.C. USG 7A.B. All as needed over existing paving to bring to grade. Use 70% B. off existing pavements indicated.
 - Overlap existing paving, with variable A.C.
 - Limits of construction.
 - District boundary.

Curb Curve Data				
Sta.	R	Δ	L	T
1	27'	90°00'00"	42.41'	27'
2	18'	40°42'30"	185.01'	76.67'
3	182'	40°42'30"	129.41'	67.52'

REVISIONS		CITY OF RIVERSIDE, CALIFORNIA DEPARTMENT OF PUBLIC WORKS	
MARK	DATE	DESCRIPTION	

DESIGNED BY	SUBMITTED BY	APPROVED BY	PROJ. NO. 6042
DRAWN BY	PAVED BY	TRAFFIC DIV.	R-691
CHECKED BY	RECOMMENDED BY	DATE 12-4-63	SHEET 1 OF 2

