

PROFILE	DATE
NO. 1000	
NO. 1001	
NO. 1002	
NO. 1003	
NO. 1004	
NO. 1005	
NO. 1006	
NO. 1007	
NO. 1008	
NO. 1009	
NO. 1010	

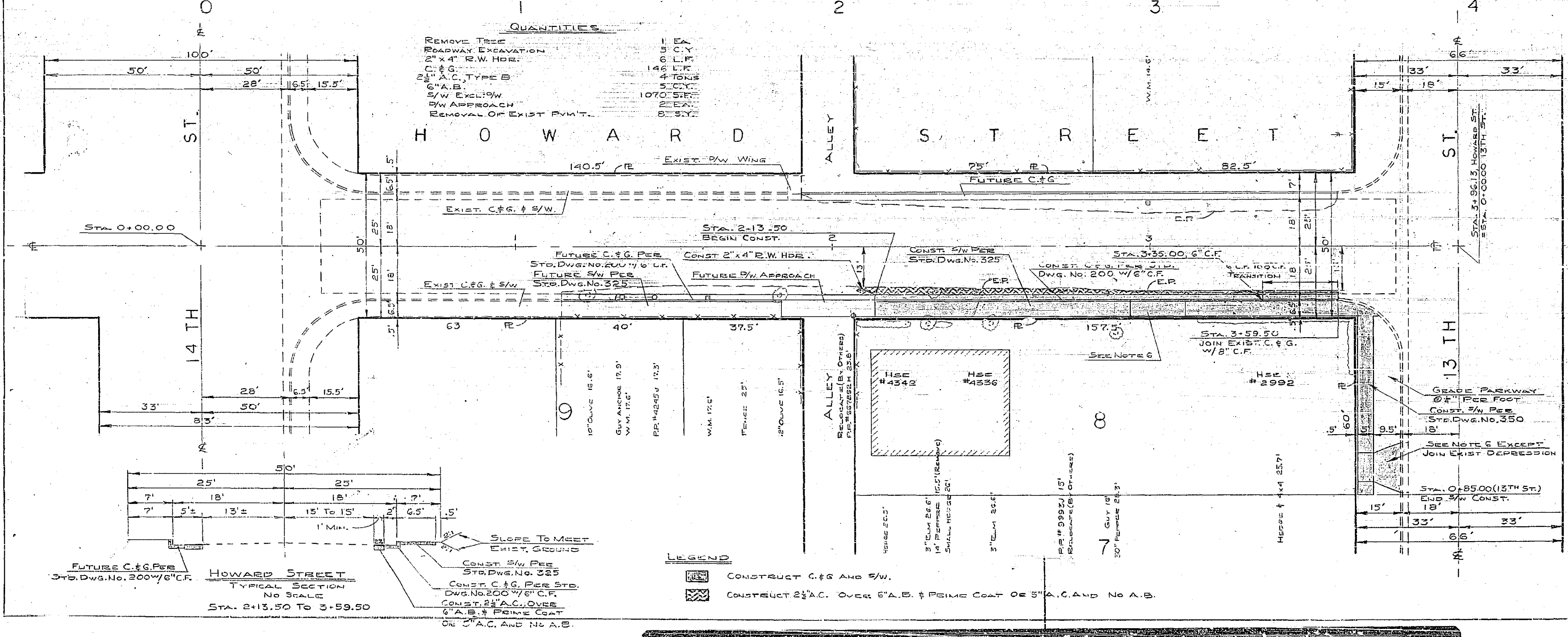

- NOTES:**
1. ALL CONSTRUCTION SHALL BE IN ACCORDANCE WITH STANDARDS AND SPECIFICATIONS NO. 461 OF THE CITY OF RIVERSIDE, DEPARTMENT OF PUBLIC WORKS.
  2. TURN EDGE OF PAVING TO CLEAN STRAIGHT LINE. CONSTRUCTION MATCH UP PAVING AS SHOWN AND OVERLAY EXISTING PAVING AS DIRECTED IN THE FIELD TO PRODUCE A SMOOTH CROWN SECTION.
  3. IT SHALL BE THE RESPONSIBILITY OF THE CONTRACTOR TO CLEAR THE RIGHT OF WAY IN ACCORDANCE WITH THE PROVISIONS OF THE LAW AS IT AFFECTS EACH UTILITY, INCLUDING LEGATION LINES AND APPURTENANCES, AND AT NO COST TO THE CITY.
  4. REMOVE ALL TREES IN RIGHT OF WAY WITHIN LIMITS OF CONSTRUCTION.
  5. PRIME COAT, PAINT, CURBS, AND SEAL COAT WILL BE REQUIRED.
  6. CONSTRUCTION DRIVEWAY APPROACH PER STANDARD DRAWING NO. 302, A=10', B=17'. LOCATION TO BE DETERMINED BY PROPERTY OWNER.
  7. PROVIDE TRANSITION FROM 5% TO EXIST GRADED PARKWAY AT 5%.

PLAN	DATE
NO. 1000	
NO. 1001	
NO. 1002	
NO. 1003	
NO. 1004	
NO. 1005	
NO. 1006	
NO. 1007	
NO. 1008	
NO. 1009	
NO. 1010	

REVISIONS		CITY OF RIVERSIDE, CALIFORNIA DEPARTMENT OF PUBLIC WORKS	
MARK	DATE	DESCRIPTION	

DESIGNED BY: <i>A. B. W.</i>	SUBMITTED BY: <i>William J. ...</i>	APPROVED BY: <i>[Signature]</i>	PROJ. NO. 1012
DRAWN BY: <i>A. B. W.</i>	CHECKED BY: <i>[Signature]</i>	DATE: 7-24-63	R-705
HOWARD STREET 13 TH ST. TO 14 TH ST. 13TH - HOWARD ST. TO 55' EAST			SHEET 1 OF 1