

B.M. Spike in Pole No. 518224 SE Cor Jurupa and Florence, Elev. 778.305
 F.B. 2/1-16
 Scale: Hor. = 1" = 50'
 Vert. = 1" = 5'

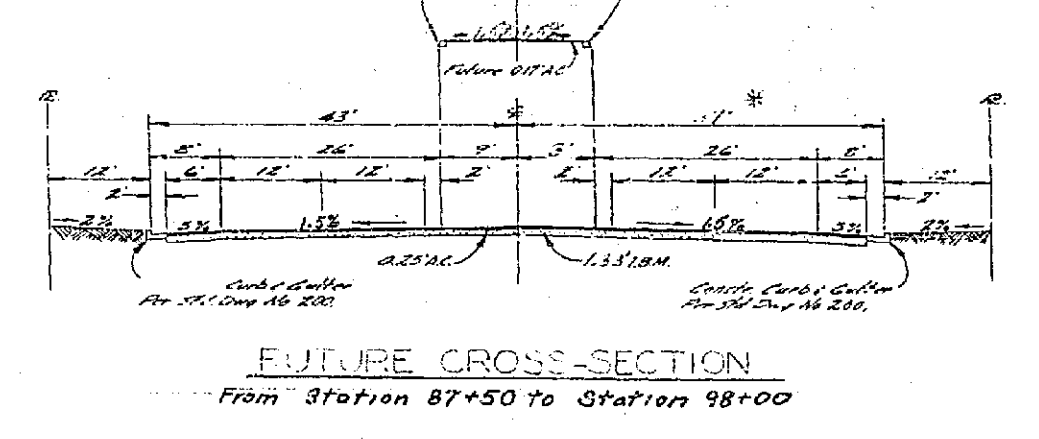

Note:
 Between Station 97+00 and Station 97+25
 the future traveled way R.L. will
 be reduced from 37' to 31'.

1. All construction shall be in accordance with Standards and Specifications No. 461 of the City of Riverside, Department of Public Works.
 2. Turn edge of paving to clean straight line. Construct match up paving as shown and overlap existing paving as directed in the field to produce a smooth crown section.
 3. It shall be the responsibility of the Contractor to clear the right of way in accordance with the provisions of the law and to provide each utility including illumination lines and appurtenances, and at no cost to the City.
 4. Prime coat and seal coat will be required.

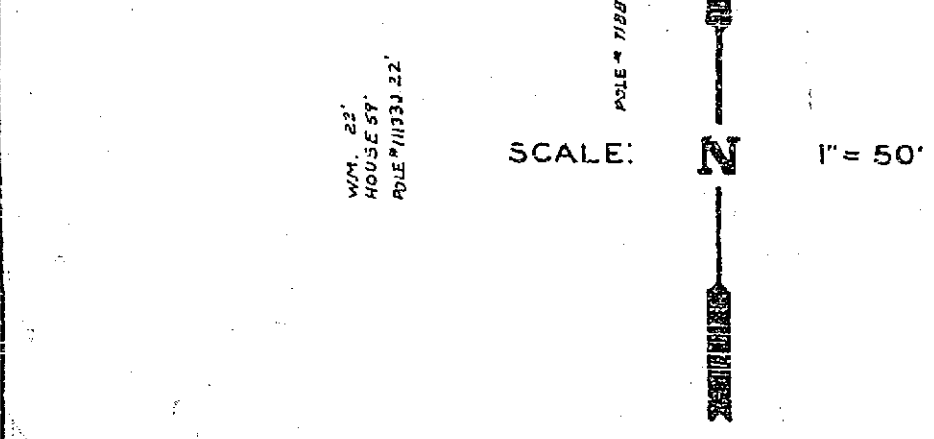
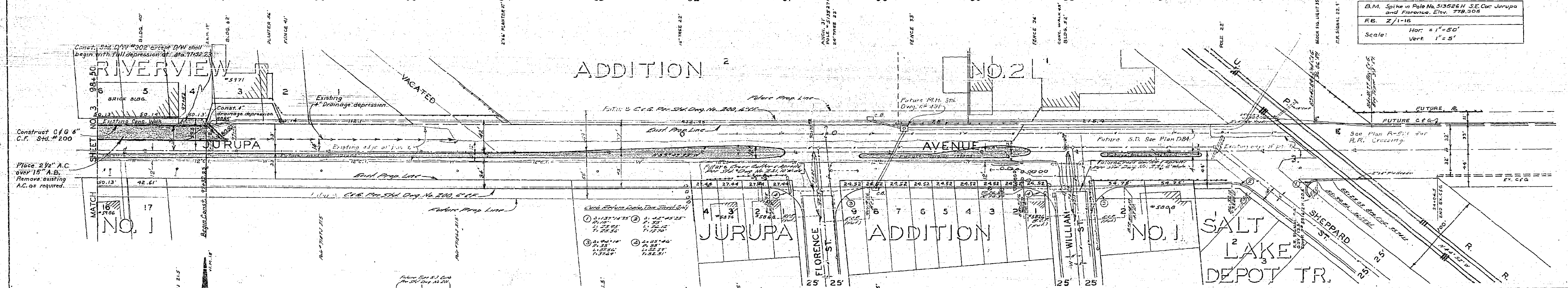
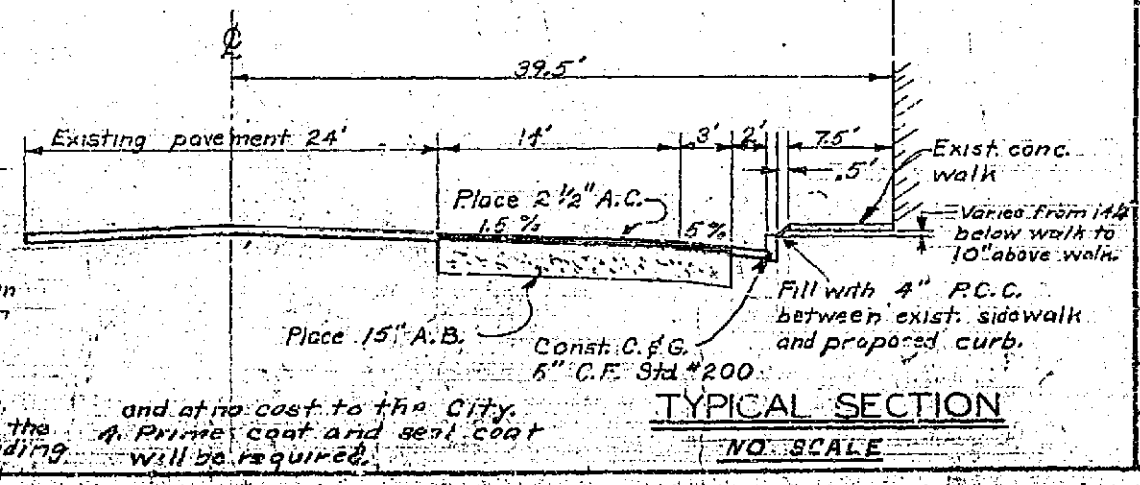

REVISIONS			CITY OF RIVERSIDE, CALIFORNIA DEPARTMENT OF PUBLIC WORKS	
MARK	DATE	DESCRIPTION	JURUPA AVENUE	
			U.P.R.R. WLY TO FREMONT ST.	
			IMPROVEMENTS NORTHERLY OF C. FROM STATION 97+32.23 TO STATION 101+4.73	
DESIGNED BY	SUBMITTED BY	APPROVED BY	PROJ. NO.	
DRAWN BY B.L.	PARK DEPT.	TRAFFIC DIV.	R-708	
CHECKED BY	RECOMMENDED BY	DATE 9-2-63	SHEET 1 OF 2	

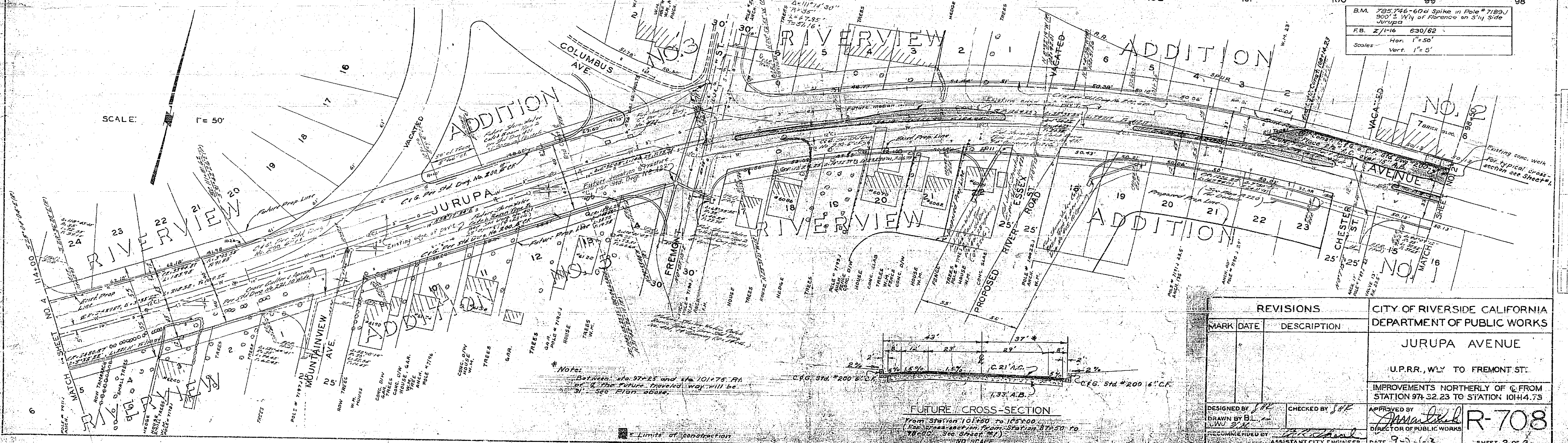
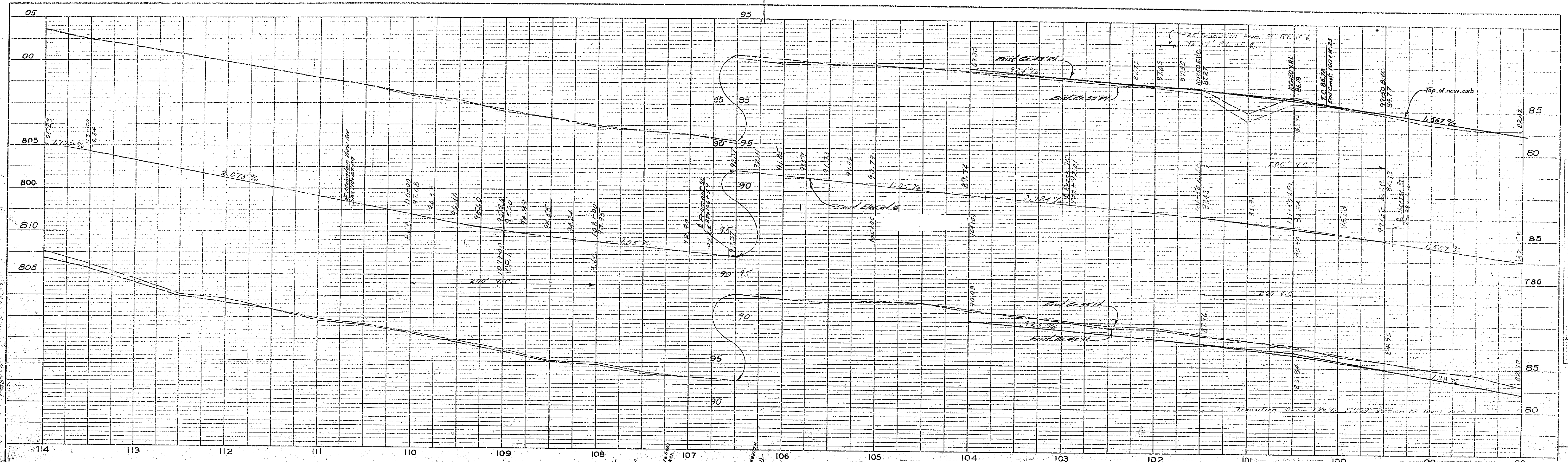

B.M. 785746-604 Spike in Pole #71891
 300' ± Wly of Reference on Sly Side
 Jurupa
 F.B. 2/1-16 630/62
 Scales: Hor. 1"=50'
 Vert. 1"=5'

SCALE: 1"=50'

REVISIONS		CITY OF RIVERSIDE CALIFORNIA DEPARTMENT OF PUBLIC WORKS
MARK	DATE	
		JURUPA AVENUE U.P.R.R., WLY TO FREMONT ST. IMPROVEMENTS NORTHERLY OF C. FROM STATION 97+32.23 TO STATION 101+4.73
DESIGNED BY	CHECKED BY	APPROVED BY
DRAWN BY		DIRECTOR OF PUBLIC WORKS
RECOMMENDED BY	ASSISTANT CITY ENGINEER	DATE 9-2-63

FUTURE CROSS-SECTION
 From Station 101+00 to 101+00
 For Cross-section from Station 87+50 to
 98+00 (See Sheet #1)

R-708
 SHEET 2 OF 2