

NO.	DATE	BY	REVISION
1			AS SHOWN

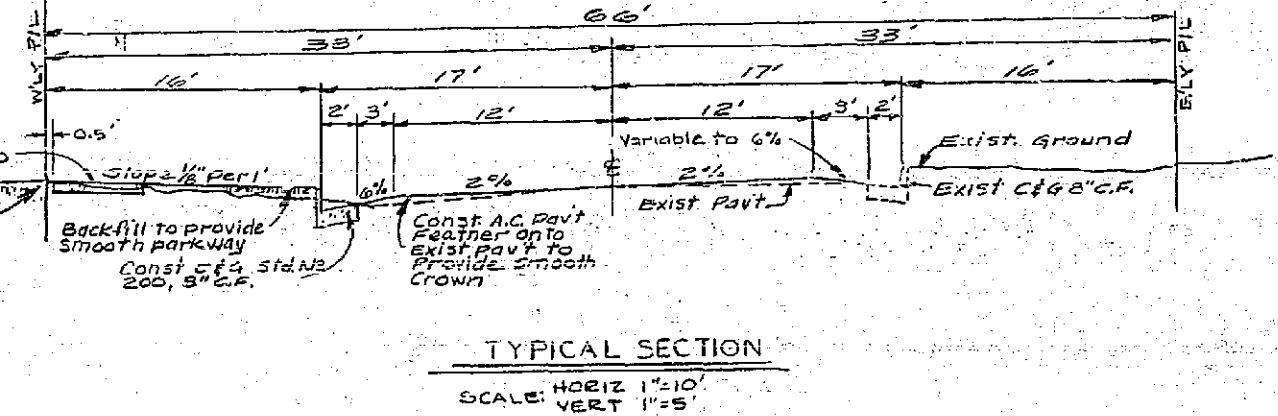
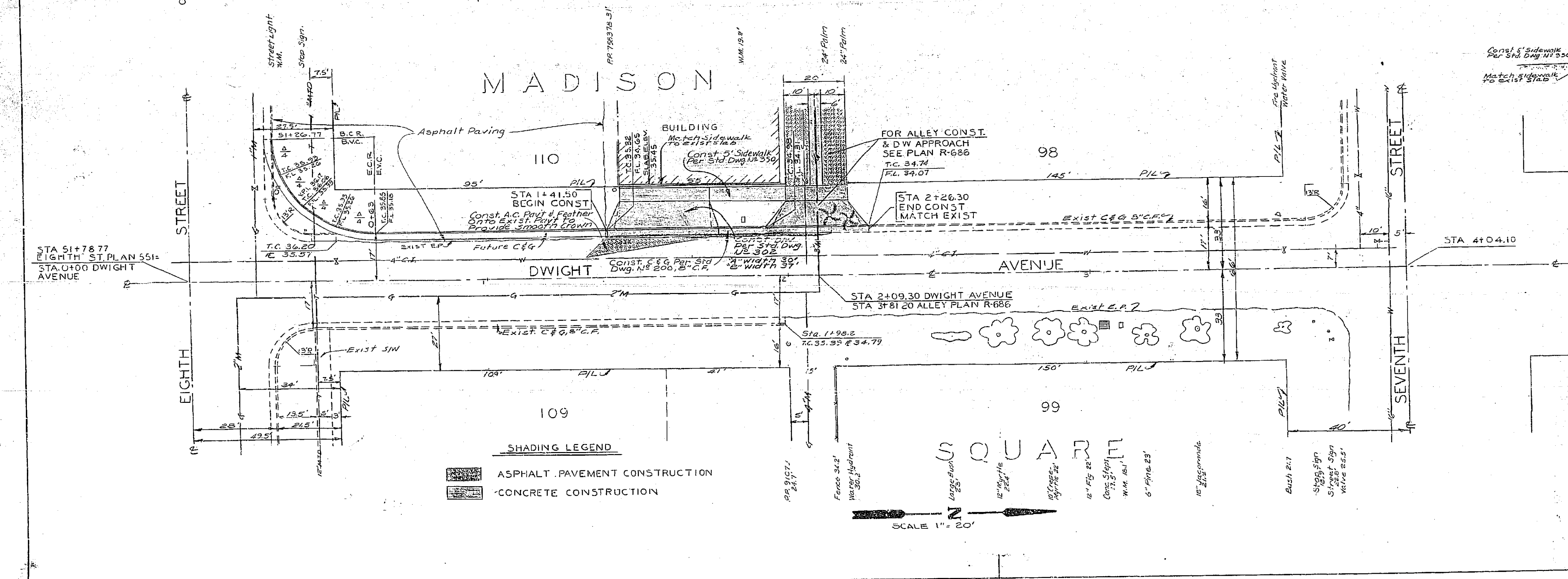

- NOTES:
- All construction shall be in accordance with Standards and Specifications issued by the City of Riverside, Department of Public Works.
  - Trim edge of paving to clean straight line. Construct match up paving as shown and overlay existing paving as directed in the field to produce a smooth crown section.
  - It shall be the responsibility of the Contractor to clear the right of way in accordance with the provisions of the laws of the State of California, including irrigation lines and appurtenances, and at no cost to the City.
  - Shaded area indicates proposed construction.
  - Prime coat, seal binder, and seal coat will be required.

NO.	DATE	BY	REVISION
1			AS SHOWN

REVISIONS		CITY OF RIVERSIDE, CALIFORNIA DEPARTMENT OF PUBLIC WORKS	
MARK	DATE	DESCRIPTION	

DWIGHT AVENUE — BETWEEN — SEVENTH & EIGHTH ST. SUPERSEDES PLAN 680.			
DESIGNED BY 4-1	SUBMITTED BY 10/10/62	APPROVED BY <i>[Signature]</i>	PROJ. NO. 1012
DRAWN BY 1-1	PARK DEPT. TRAFFIC DIV. 7-19-63		R-712
CHECKED BY 1-1	RECOMMENDED BY 1-1	DATE 7-19-63	SHEET 1 OF 1