

REVISIONS	
MARK	DESCRIPTION
Δ	1-14-58 CHANGE GRADE, SEE SHEET 1102 ENW (2007 Rev. 01/07)
DESIGNED BY	CHECKED BY [Signature]
DRAWN BY [Signature]	RECOMMENDED BY [Signature]
ASSISTANT CITY ENGINEER	

J. F. DAVIDSON - CIVIL ENGINEER
 RIVERSIDE, CALIFORNIA
 APPROVED BY [Signature] DATE 12/3/53
 R.E. 1948

CITY OF RIVERSIDE, CALIFORNIA
 DEPARTMENT OF PUBLIC WORKS

ALLEY PLAN & PROFILE
 ALLEY LOT C

TRACT No. 2609
 HORIZ. SCALE 1"=40' VERT. SCALE 1"=4'

APPROVED BY [Signature]
 DIRECTOR OF PUBLIC WORKS

NO. R-714
 DATE 12-3-53 SHEET 3 OF 4

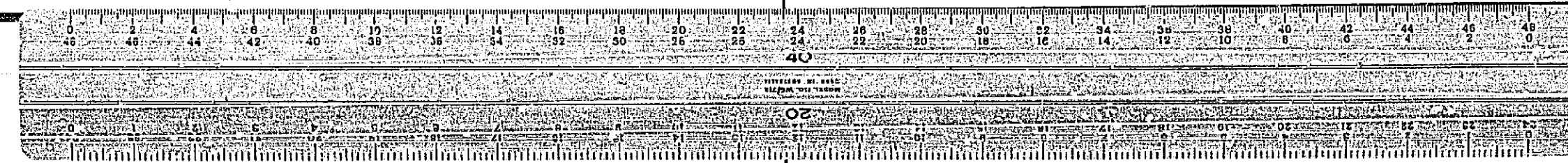

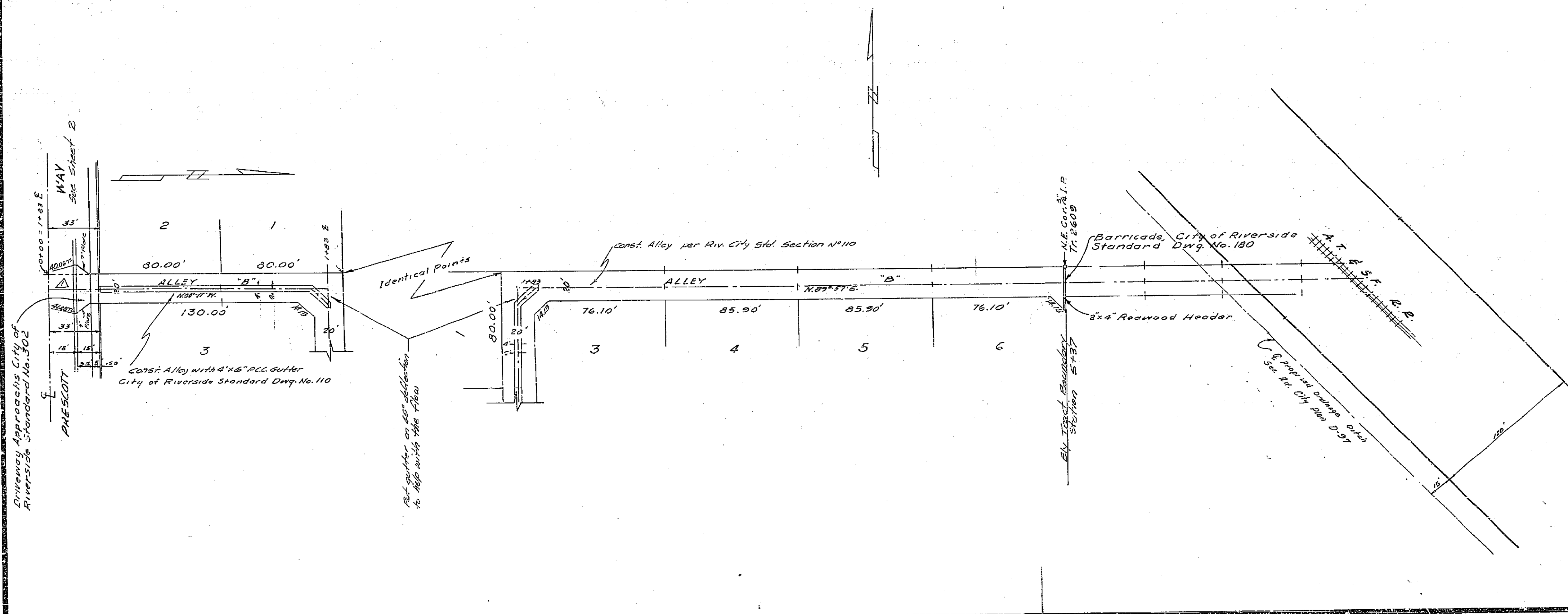
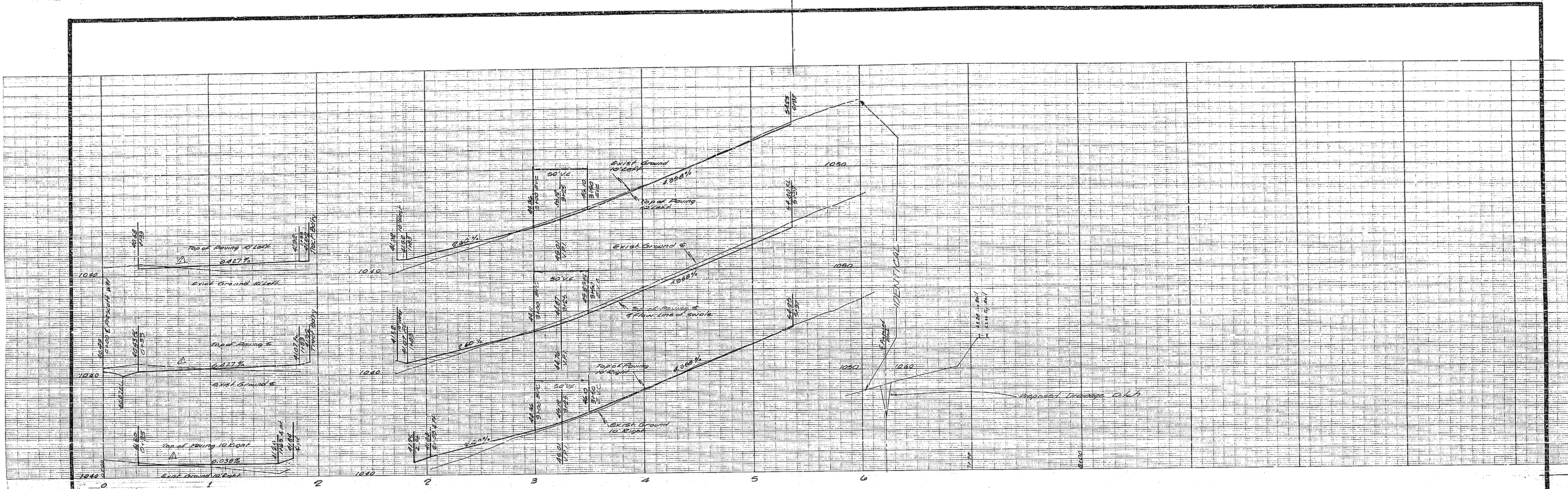

City D.M.
 1" on Top of Fire Hydrant, 56.25' Canyon Crest Dr. London Ct.
 Elev. 1042.00
 10.010

REVISIONS		
MARK	DATE	DESCRIPTION
Δ	1-18-64	CHANGE GRADE, STA 2200 TO 1023 EXIST. 0.427% TO 0.230%

J. F. DAVIDSON-CIVIL ENGINEER
 R.E. NO. 862
 RIVERSIDE, CALIFORNIA
 APPROVED BY *George E. Scott* DATE 6/1/64
 CITY OF RIVERSIDE, CALIFORNIA
 DEPARTMENT OF PUBLIC WORKS
 ALLEY PLAN & PROFILE
 ALLEY LOT B
 TRACI No. 2603
 HORIZ. SCALE 1"=40' VERT. SCALE 1"=4'
 DESIGNED BY
 DRAWN BY
 RECOMMENDED BY *P. B. Heath* ASSISTANT CITY ENGINEER
 APPROVED BY *George E. Scott* DIRECTOR OF PUBLIC WORKS
 DATE 12-3-63 SHEET 2 OF 4

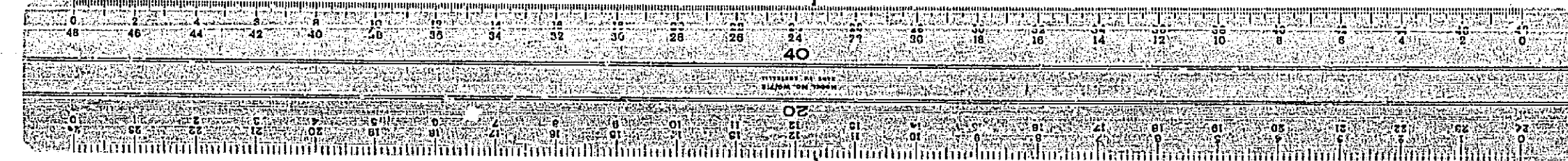

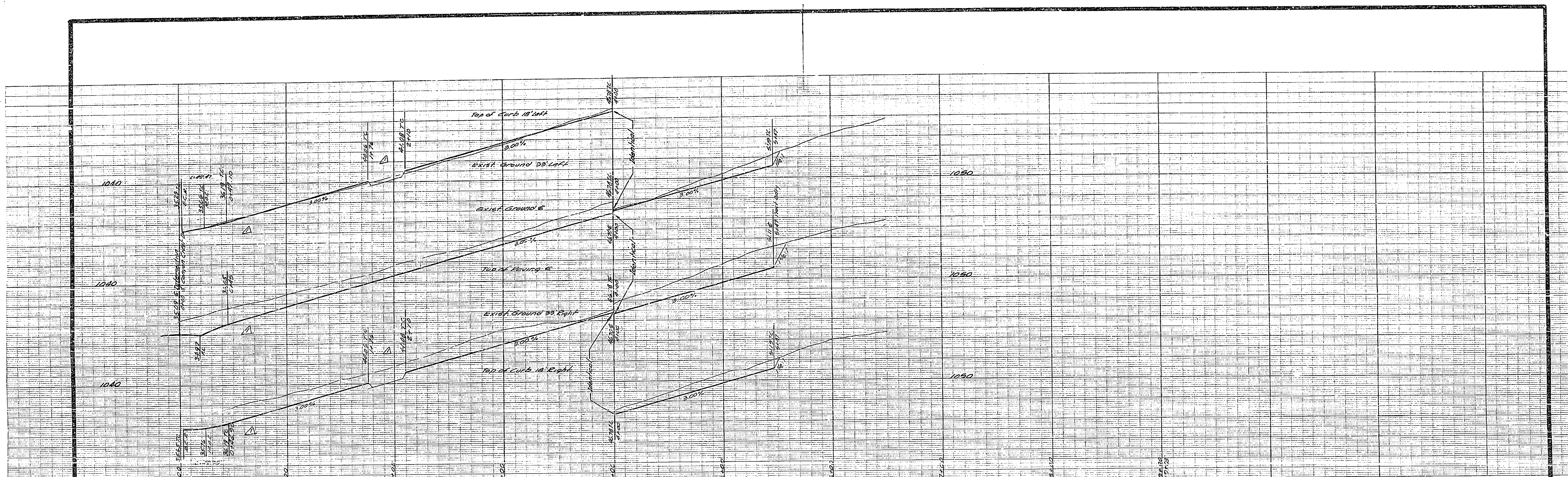

STREET NAME SIGN SCHEDULE

A	CANYON CREST DRIVE	300
	PRESCOTT WAY	800

NOTES:
 1. Furnish and install street name signs and posts per City Std. No. 192
 2. Contact Traffic Division, City of Riverside before ordering signs for street numbers.

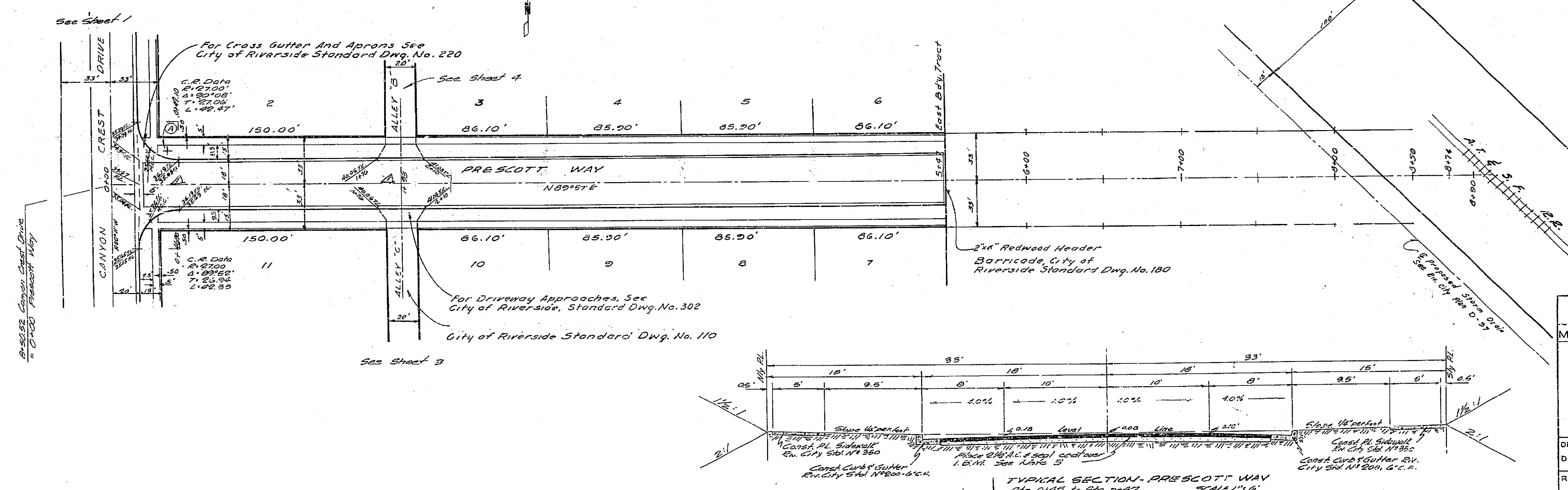

J. F. DAVIDSON-CIVIL ENGINEER
 R.E. NO. 692
 RIVERSIDE, CALIFORNIA
 APPROVED BY *[Signature]* DATE *12-3-63*
CITY OF RIVERSIDE, CALIFORNIA
DEPARTMENT OF PUBLIC WORKS

TRACT No. 2609
 HORIZ. SCALE 1"=40' VERT. SCALE 1"=4'

DESIGNED BY *[Signature]* CHECKED BY *[Signature]*
 DRAWN BY *[Signature]*
 RECOMMENDED BY *[Signature]* ASSISTANT CITY ENGINEER
 DATE 12-3-63 SHEET 2 OF 4

