

PROFILE	SHEET NO.	DATE
NO. 1	1	

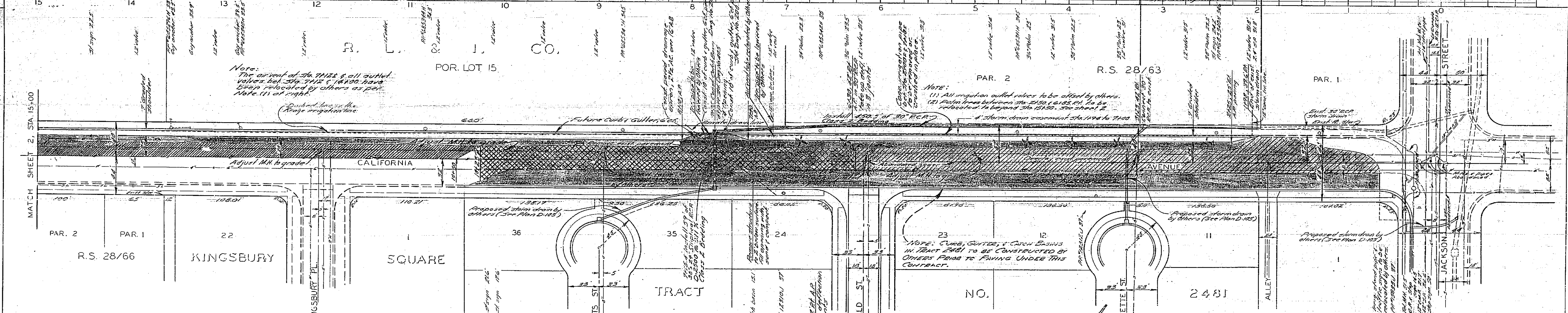

PLAN	SHEET NO.	DATE
NO. 1	1	

- SHADING LEGEND
- Existing pavement to be replaced.
 - New paving to be placed within street widening.
 - Existing pavement to be overlaid with AC.
 - Existing pavement to be removed and replaced.
 - Curb & gutter to be constructed.
 - Storm drains to be constructed.

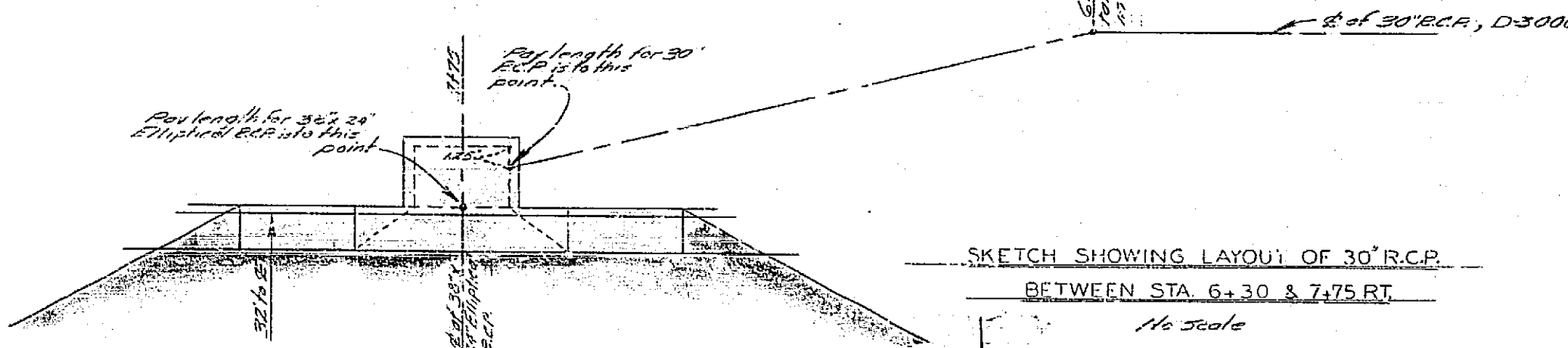

REVISIONS		CITY OF RIVERSIDE, CALIFORNIA	
MARK	DATE	DESCRIPTION	DEPARTMENT OF PUBLIC WORKS
1	12-9-63	Revised plan per first review	MAJOR CITY STREETS PROJECT NO. 118
2	12-9-63	Revised plan per second review	CALIFORNIA AVENUE WIDENING
			JACKSON ST. TO VAN BUREN BLVD.
			JACKSON ST. TO STA. 15+00
DESIGNED BY	SUBMITTED BY	APPROVED BY	PROJ. NO. 3023
DRAWN BY	PARK DEPT.	TRAFFIC DIV.	R-715
CHECKED BY	REG. ENGINEER	DATE 12-9-63	SHEET 1 OF 3

SUPERSEDES PLAN R-240

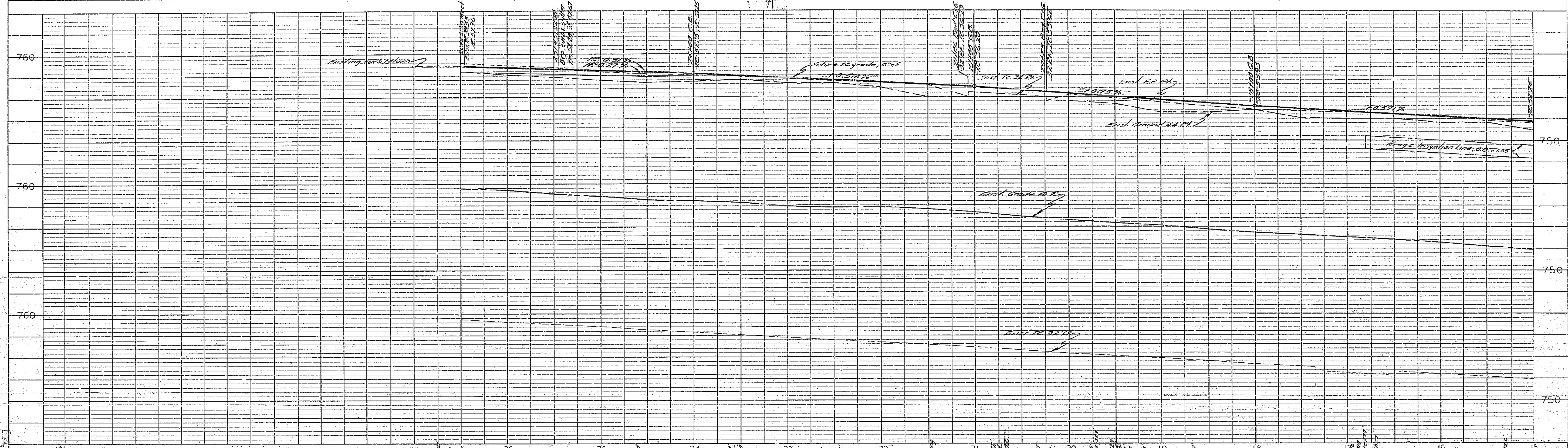

PROFILE	
DATE	12-9-63
BY	[Signature]
CHECKED BY	[Signature]
DESIGNED BY	[Signature]
DRAWN BY	[Signature]
APPROVED BY	[Signature]
PROJECT NO.	3023
SHEET NO.	2 OF 3

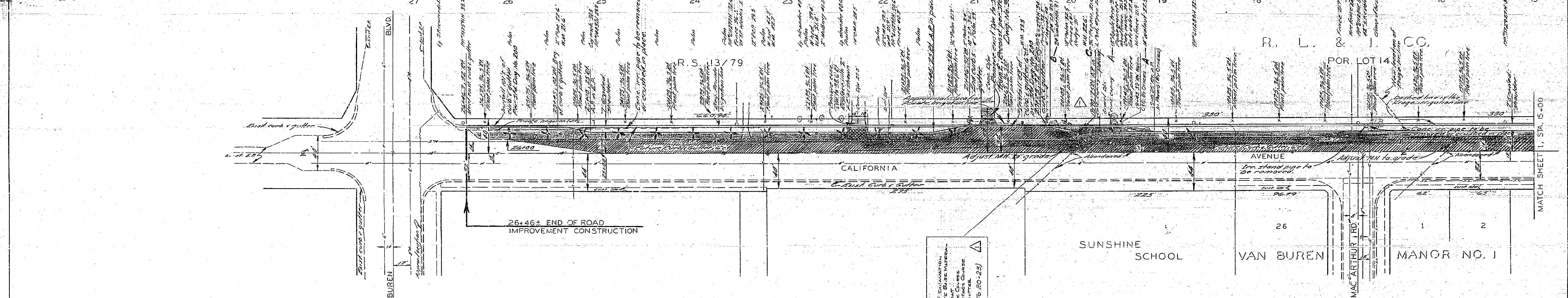

PLAN	
DATE	12-9-63
BY	[Signature]
CHECKED BY	[Signature]
DESIGNED BY	[Signature]
DRAWN BY	[Signature]
APPROVED BY	[Signature]
PROJECT NO.	3023
SHEET NO.	2 OF 3

BY CHANGE
S. V. FURNACE
D. G. AGRESTE
A. C. G. G. G. G.
180 FT. CURB & GUTTER
(Sta. 19+43 TO 20+23)

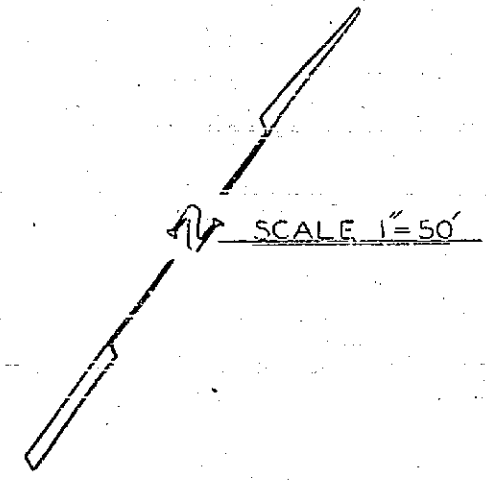

REVISIONS			CITY OF RIVERSIDE, CALIFORNIA DEPARTMENT OF PUBLIC WORKS	
MARK	DATE	DESCRIPTION	MAJOR CITY STREETS PROJECT NO. 118	
Δ	8-2-61	ADDED C & G - 180 FT. CURB & GUTTER STA. 15+13 TO 20+23	CALIFORNIA AVENUE WIDENING JACKSON ST. TO VAN BUREN BLVD. STA. 15+00 TO VAN BUREN BLVD.	
DESIGNED BY	SUBMITTED BY	APPROVED BY	PROJECT NO.	3023
DRAWN BY	PARK DEPT.	TRAFFIC DIV.	R-715	
CHECKED BY	RECOMMENDED BY	DATE	12-9-63	SHEET 2 OF 3
SUPERSEDES PLAN R-240				

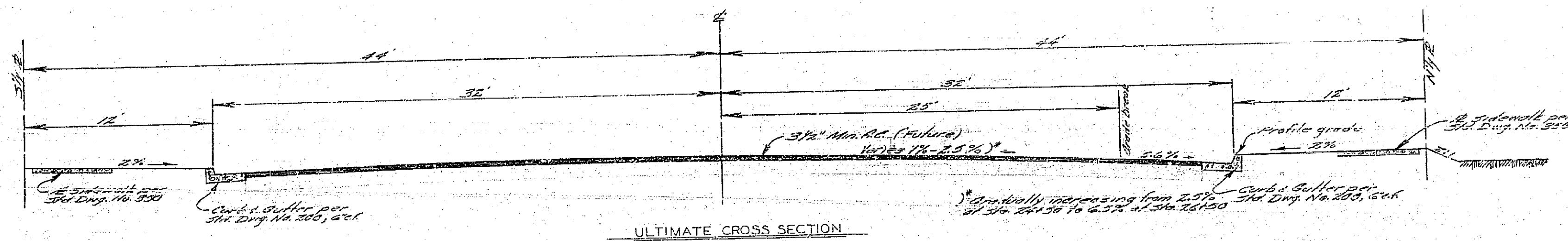

ULTIMATE CROSS SECTION

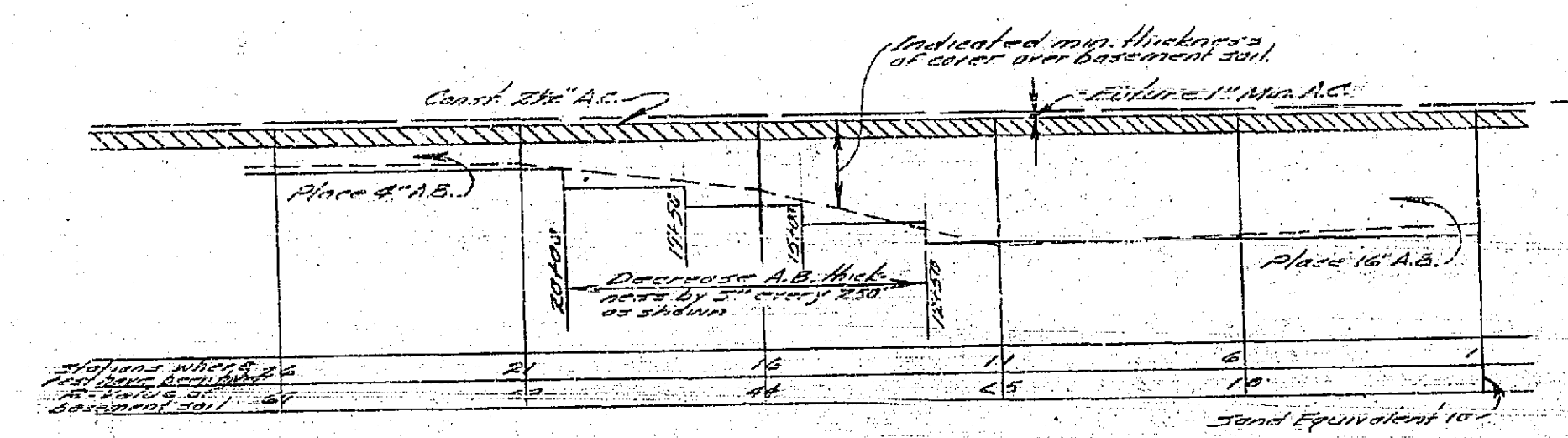
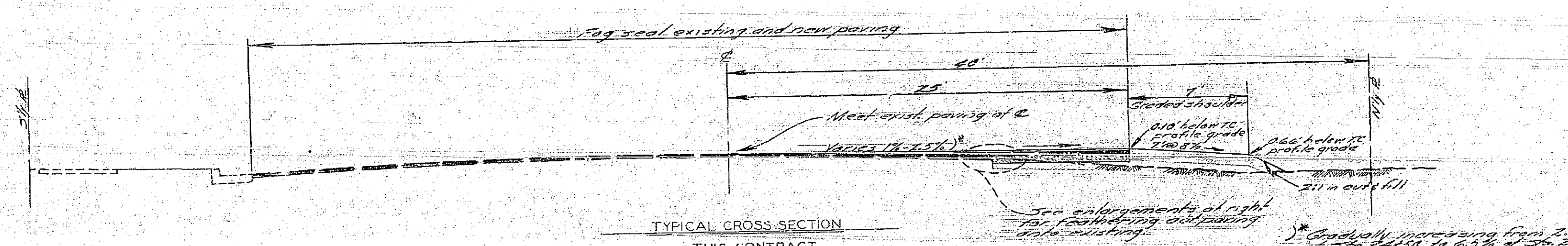
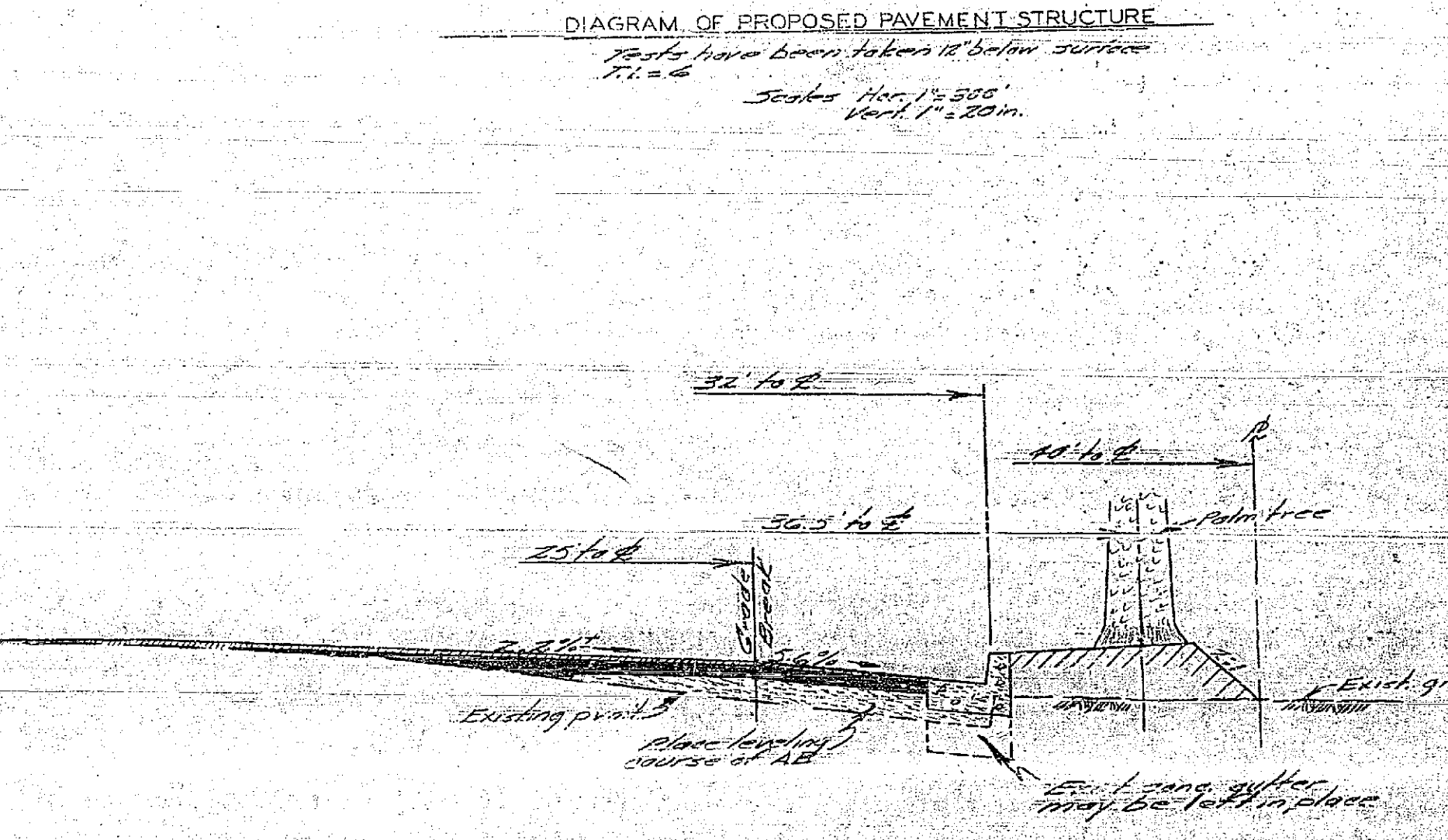

DIAGRAM OF PROPOSED PAVEMENT STRUCTURE



TYPICAL CROSS SECTION THIS CONTRACT



TYPICAL CROSS SECTION

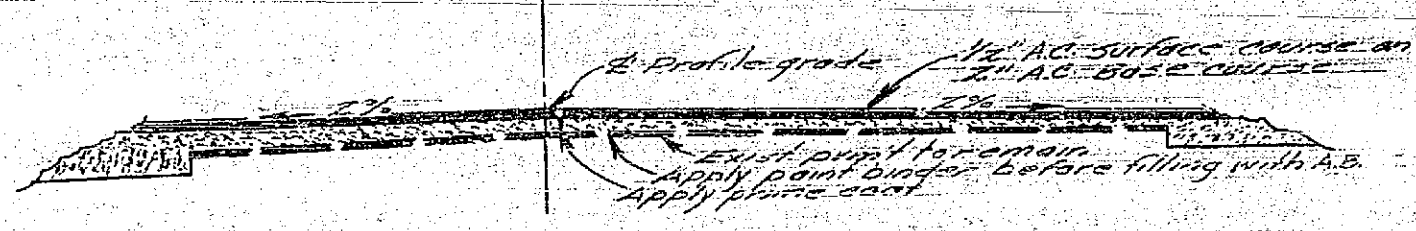

TYPICAL CROSS SECTION FOR OVERLAY

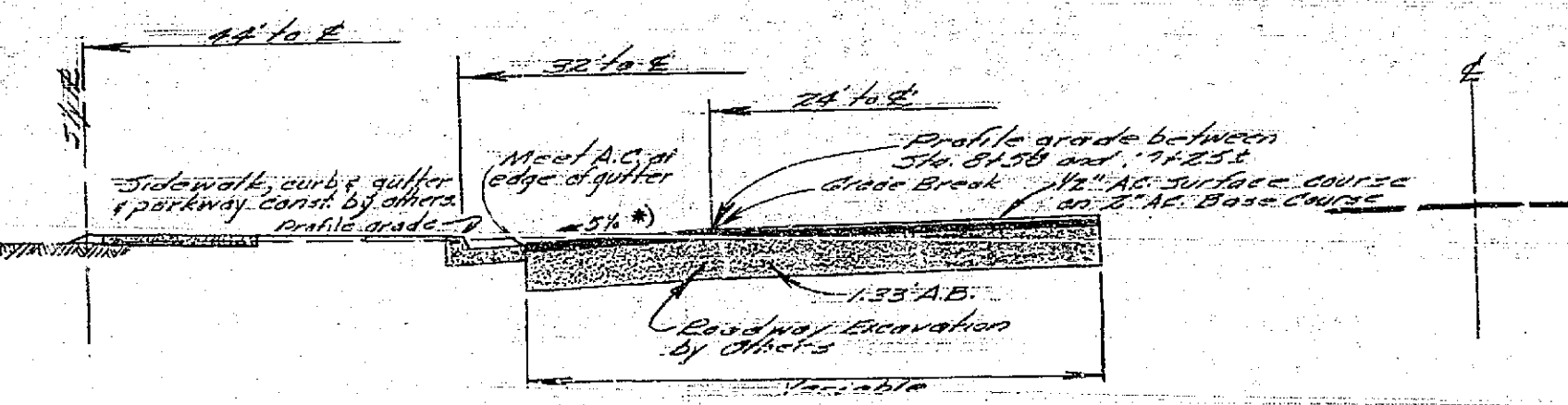

TYPICAL CROSS SECTION LEFT SIDE

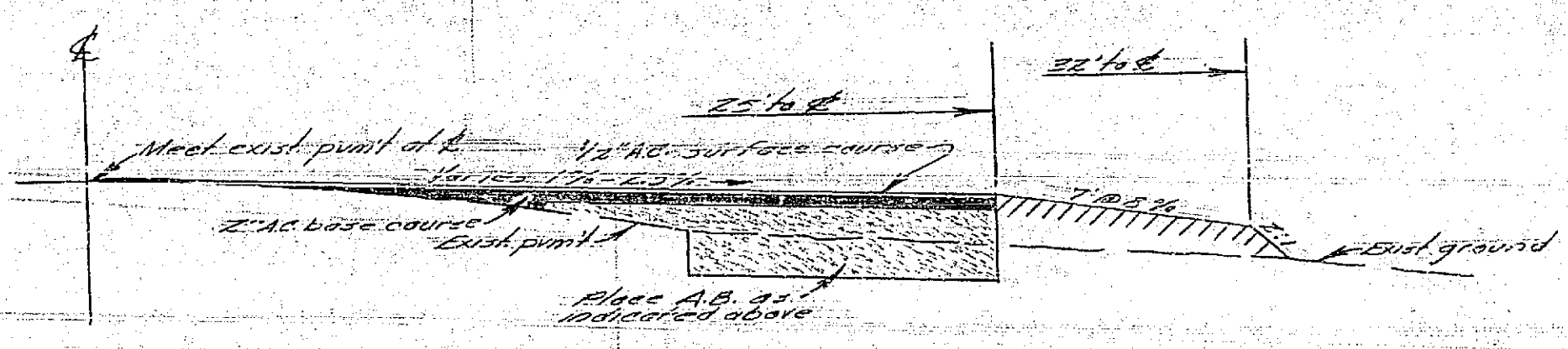

TYPICAL CROSS SECTION FOR OVERLAYING EXISTING PAVING

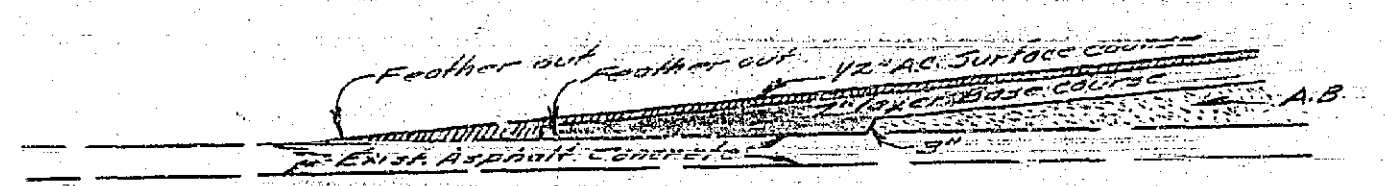

DETAIL FOR JOINING EXISTING PAVING AT STA. 0+65

Note: All drawings on this sheet are 1"=2' unless otherwise noted.

REVISIONS			CITY OF RIVERSIDE, CALIFORNIA DEPARTMENT OF PUBLIC WORKS	
MARK	DATE	DESCRIPTION	MAJOR CITY STREETS PROJECT NO. 118	
1135A		Revised plan on final 50% scale revision from 100% scale plan.	CALIFORNIA AVENUE WIDENING	
1135B		Revised plan on final 50% scale revision from 100% scale plan.	JACKSON ST. TO VAN BUREN BLVD.	
			CROSS SECTION & DETAIL SHEET	
DESIGNED BY	U.S. ...	SUBMITTED BY	APPROVED BY	PROJ. NO. 3023
DRAWN BY	...	TRAFFIC DIV.	...	R-715
CHECKED BY	...	ASSISTANT CITY ENGINEER	DATE 12-9-63	SHEET 3 OF 3