

DATE	
BY	
REVISIONS	
NOTED	
PROFILES	
GRADES CHECKED	
CONSTRUCTION	

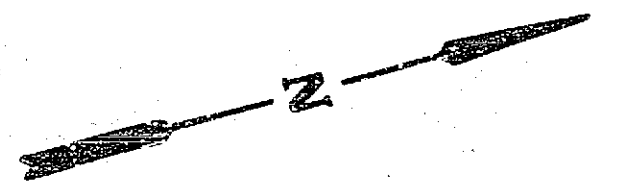

- NOTES**
1. ALL CONSTRUCTION SHALL BE IN ACCORDANCE WITH STANDARDS AND SPECIFICATIONS NO. 461 OF THE CITY OF RIVERSIDE, DEPARTMENT OF PUBLIC WORKS.
  2. IT SHALL BE THE RESPONSIBILITY OF THE CONTRACTOR TO CLEAR THE RIGHT OF WAY IN ACCORDANCE WITH THE PROVISIONS OF THE LAW AS IT AFFECTS EACH UTILITY, INCLUDING IRRIGATION LINES AND APPURTENANCES, AND AT NO COST TO THE CITY.
  3. PRIME COAT, PAINT BINDER, AND SEAL COAT WILL BE REQUIRED.

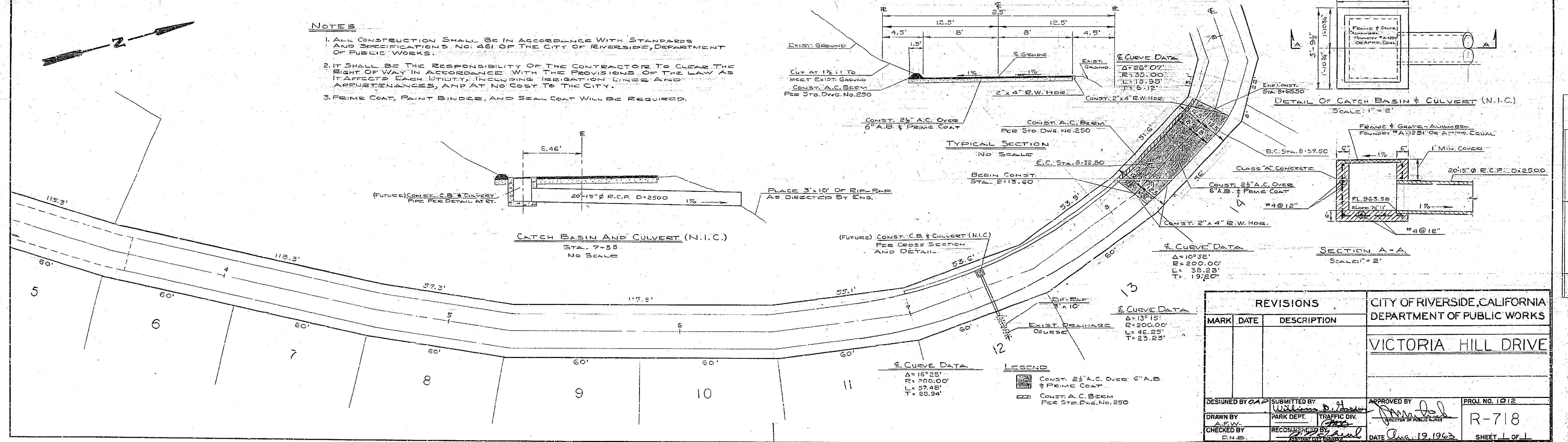

DATE	
BY	
REVISIONS	
NOTED	
PLAN	
GRADES CHECKED	
CONSTRUCTION	

<b>REVISIONS</b> MARK   DATE   DESCRIPTION		CITY OF RIVERSIDE, CALIFORNIA DEPARTMENT OF PUBLIC WORKS <b>VICTORIA HILL DRIVE</b>	
DESIGNED BY	2021	SUBMITTED BY	William D. ...
DRAWN BY	...	TRAFFIC DIV.	...
CHECKED BY	...	RECOMMENDED BY	...
		APPROVED BY	...
		DATE	Aug. 19, 1963
		PROJ. NO.	1012
			R-718
			SHEET 1 OF 1



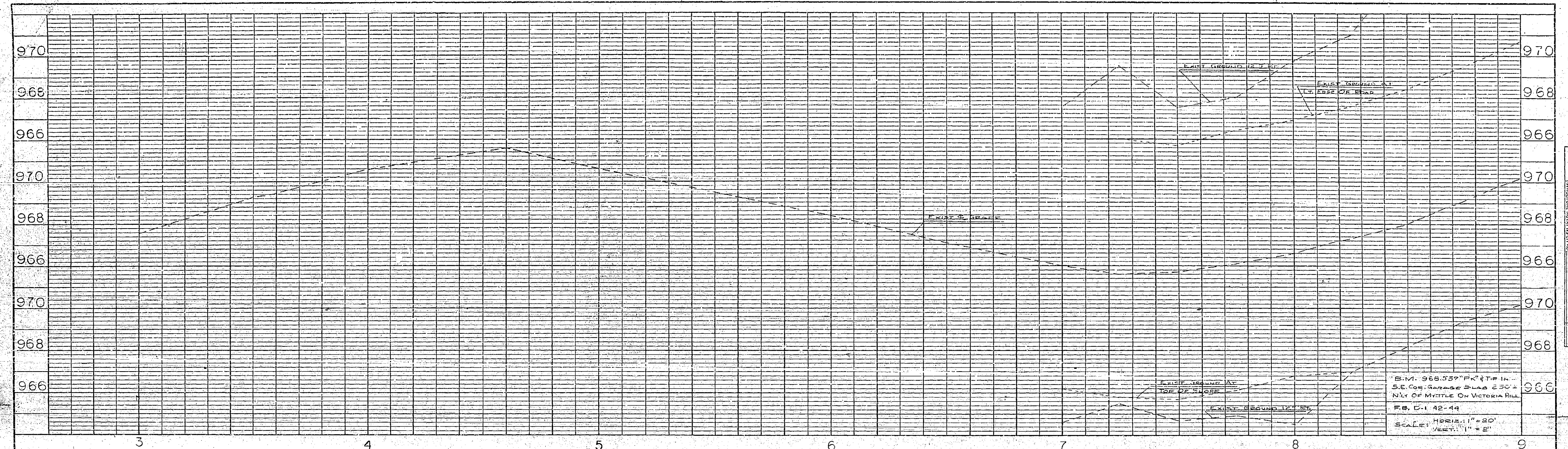

PROFILE	
NO. 1	DATE
DATE	BY
CHECKED	DATE

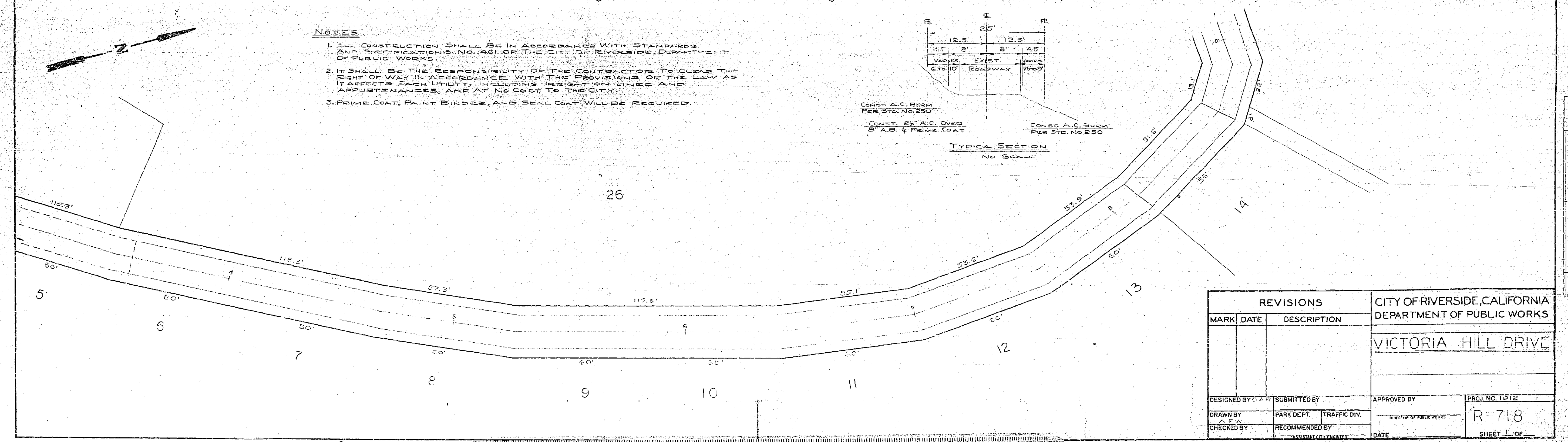

PLAN	
NO. 1	DATE
DATE	BY
CHECKED	DATE

REVISIONS			CITY OF RIVERSIDE, CALIFORNIA DEPARTMENT OF PUBLIC WORKS	
MARK	DATE	DESCRIPTION	VICTORIA HILL DRIVE	
DESIGNED BY		SUBMITTED BY	APPROVED BY	PROJ. NO. 1012
DRAWN BY		PARK DEPT.   TRAFFIC DIV.	SHEET NO. OF PUBLIC WORKS	R-718
CHECKED BY		RECOMMENDED BY	DATE	SHEET 1 OF

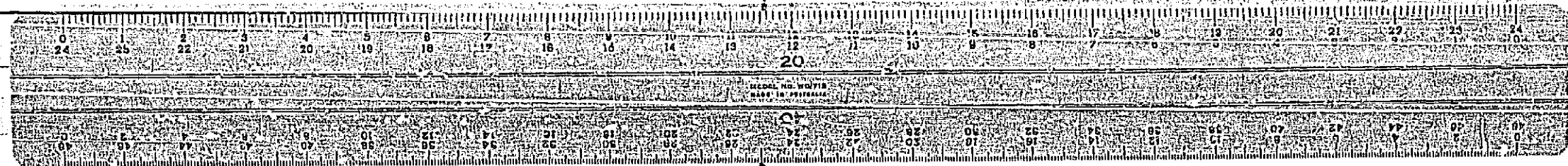



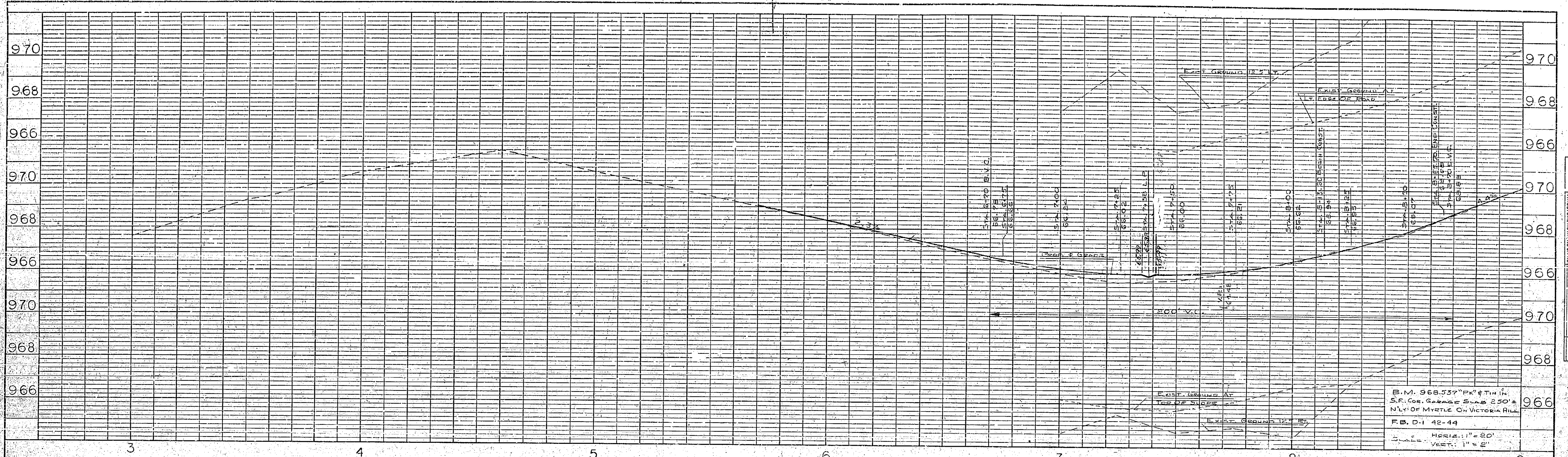

NO.	DATE	DESCRIPTION

E.M. 968.537' Pk + T in  
 S.F. Cor. Garage Slab 250' S  
 N.L. OF MYRTLE ON VICTORIA HILL  
 FB. D-1 42-44  
 Scale: Horiz.: 1" = 20'  
 Vert.: 1" = 2'

- NOTES**
1. ALL CONSTRUCTION SHALL BE IN ACCORDANCE WITH STANDARDS AND SPECIFICATIONS NO. 481 OF THE CITY OF RIVERSIDE, DEPARTMENT OF PUBLIC WORKS.
  2. IT SHALL BE THE RESPONSIBILITY OF THE CONTRACTOR TO CLEAR THE RIGHT OF WAY IN ACCORDANCE WITH THE PROVISIONS OF THE LAW AS IT AFFECTS EACH UTILITY, INCLUDING IRRIGATION LINES AND APPURTENANCES, AND AT NO COST TO THE CITY.
  3. PRIME COAT, PAINT BINDER, AND SEAL COAT WILL BE REQUIRED.

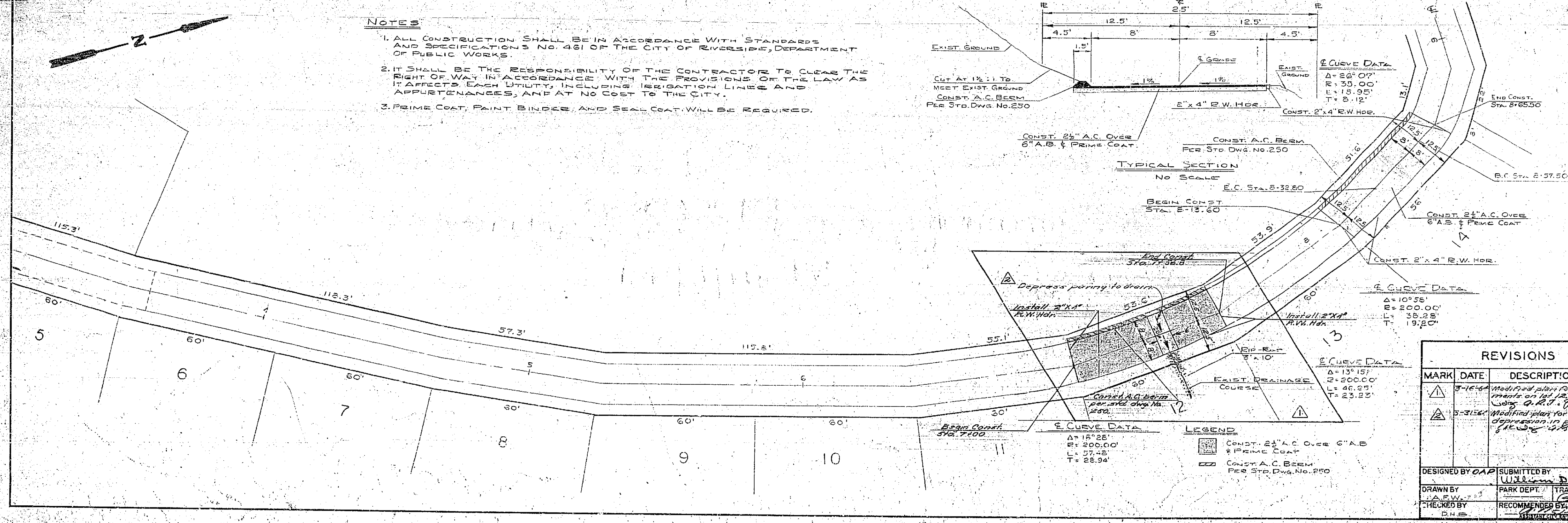
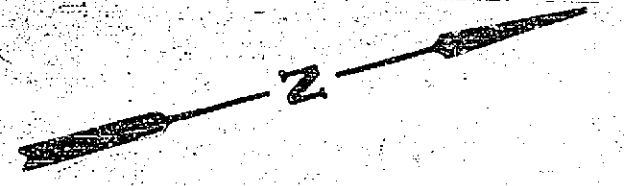

REVISIONS			CITY OF RIVERSIDE, CALIFORNIA DEPARTMENT OF PUBLIC WORKS	
MARK	DATE	DESCRIPTION	VICTORIA HILL DRIVE	

DESIGNED BY G.A.P.	SUBMITTED BY WILLIAM D. [Signature]	APPROVED BY [Signature]	PROJ. NO. 1012
DRAWN BY A.P.W.	PARK DEPT. TRAFFIC DIV. [Signature]	DATE Aug 19 1962	R-718
CHECKED BY R.H.E.	RECOMMENDED BY [Signature]	SHEET 1 OF 1	

NO.	DATE	DESCRIPTION

