

TYPICAL SECTION
Sta. 174+33.5 to 185+76.2
NO SCALE

- LEGEND**
- Asphalt Concrete (Type B)
 - Aggregate Base
 - Existing ballast and soil materials obtained from removal operations and respread and compacted in bottom of trench prior to placing aggregate base.

- NOTES:**
1. Sections 175+00 through 185+76 show existing conditions and approximate limits of resurfacing after track removal.
 2. Prime coat and paint binder will be required.
 3. The existence and location of any underground utility pipes and structures shown are obtained from available records. The Contractor is required to take due precautionary measures to protect the utility lines shown and any other utility lines not shown on this plan.

VERT. SCALE: 1"=10'

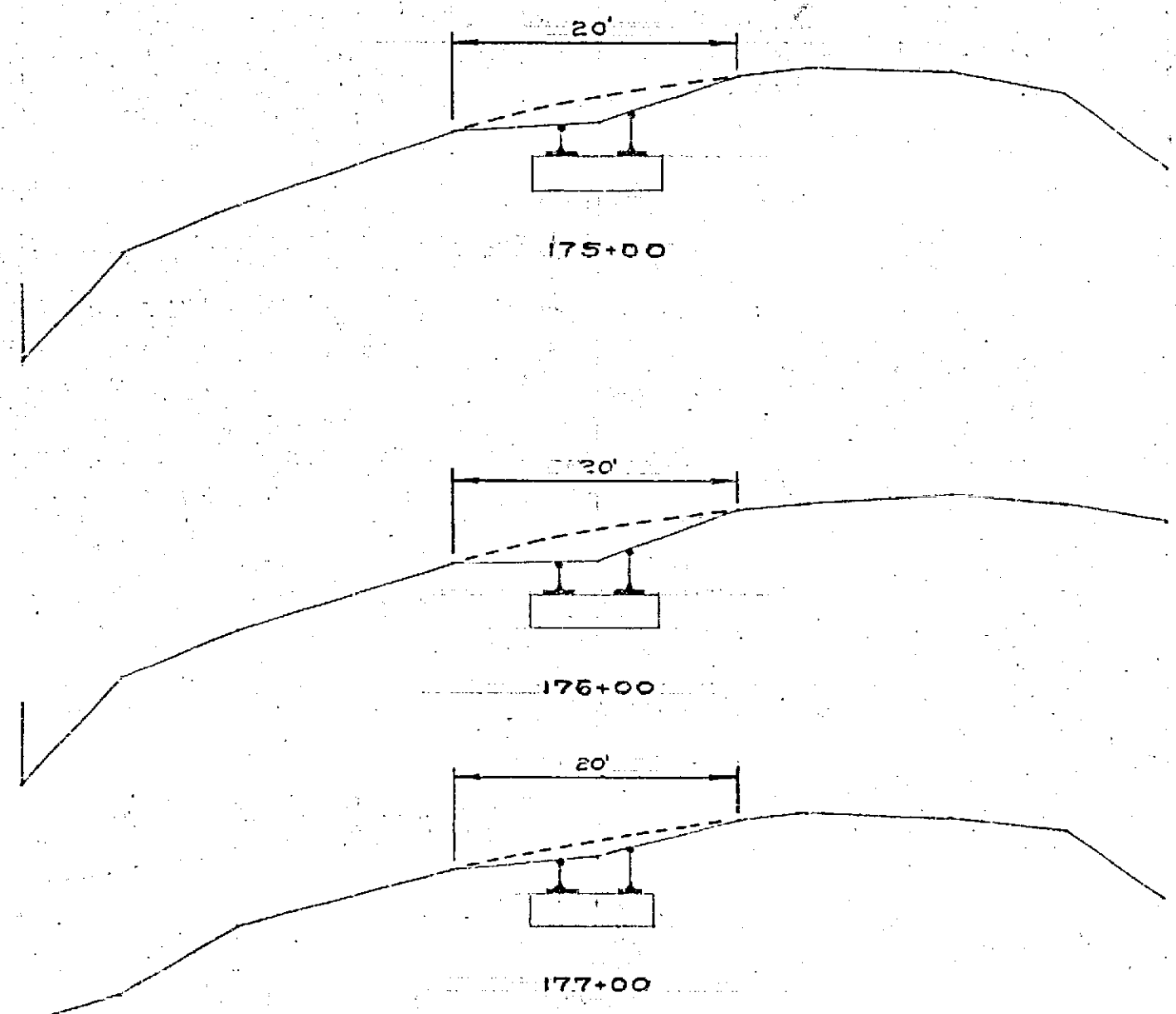

REMOVE EXISTING TRACKS AND RESURFACE PER TYP. SECTION AT LEFT.

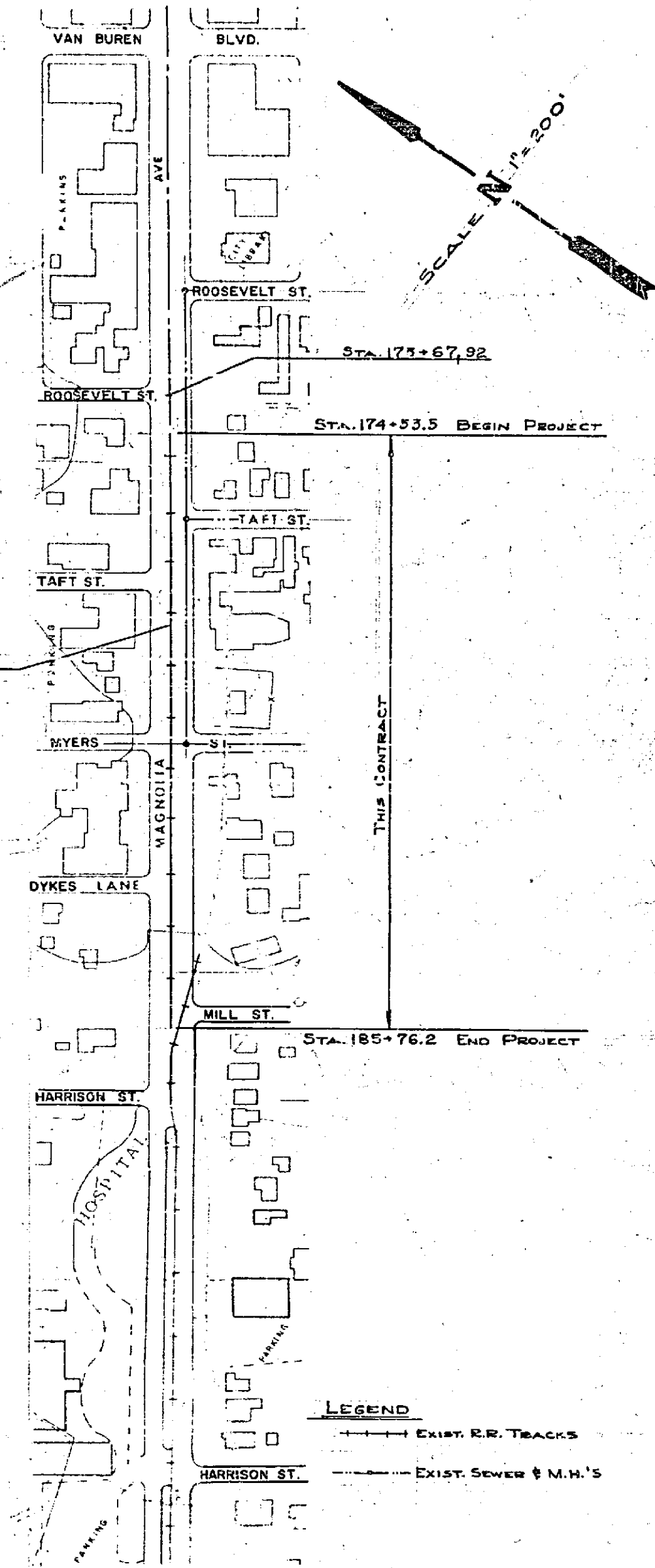

REVISIONS			CITY OF RIVERSIDE, CALIFORNIA DEPARTMENT OF PUBLIC WORKS	
MARK	DATE	DESCRIPTION	MAJUN CITY STREETS - PROJECT NO. 121	
	11-21-63	REVISION PER STATE REVIEW: A.W. CAPWELL	MAGNOLIA AVENUE ROOSEVELT TO HARRISON	
			TRACK REMOVAL & RESURFACING	
DESIGNED BY	SUBMITTED BY	APPROVED BY	PROJECT NO.	3082
DRAWN BY	PARK DEPT.	TRAFFIC DIV.	R-730	
CHECKED BY	RECOMMENDED BY	DATE	10-18-63	SHEET OF

Ties St. 6'
P. 15 1/2' x 1'