

PROFILE	DATE	BY	DATE
NO. 1	10/11/63	H.M.G.	
NO. 2			
NO. 3			

PLAN	DATE	BY	DATE
NO. 1	10/11/63	H.M.G.	
NO. 2			
NO. 3			

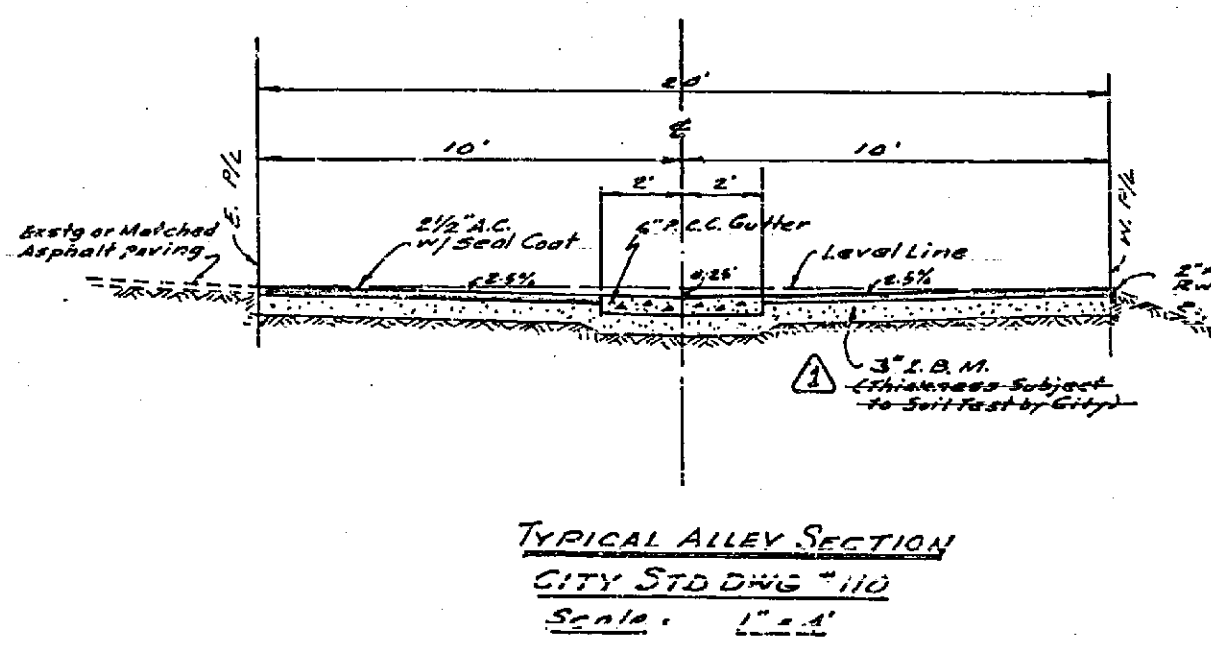
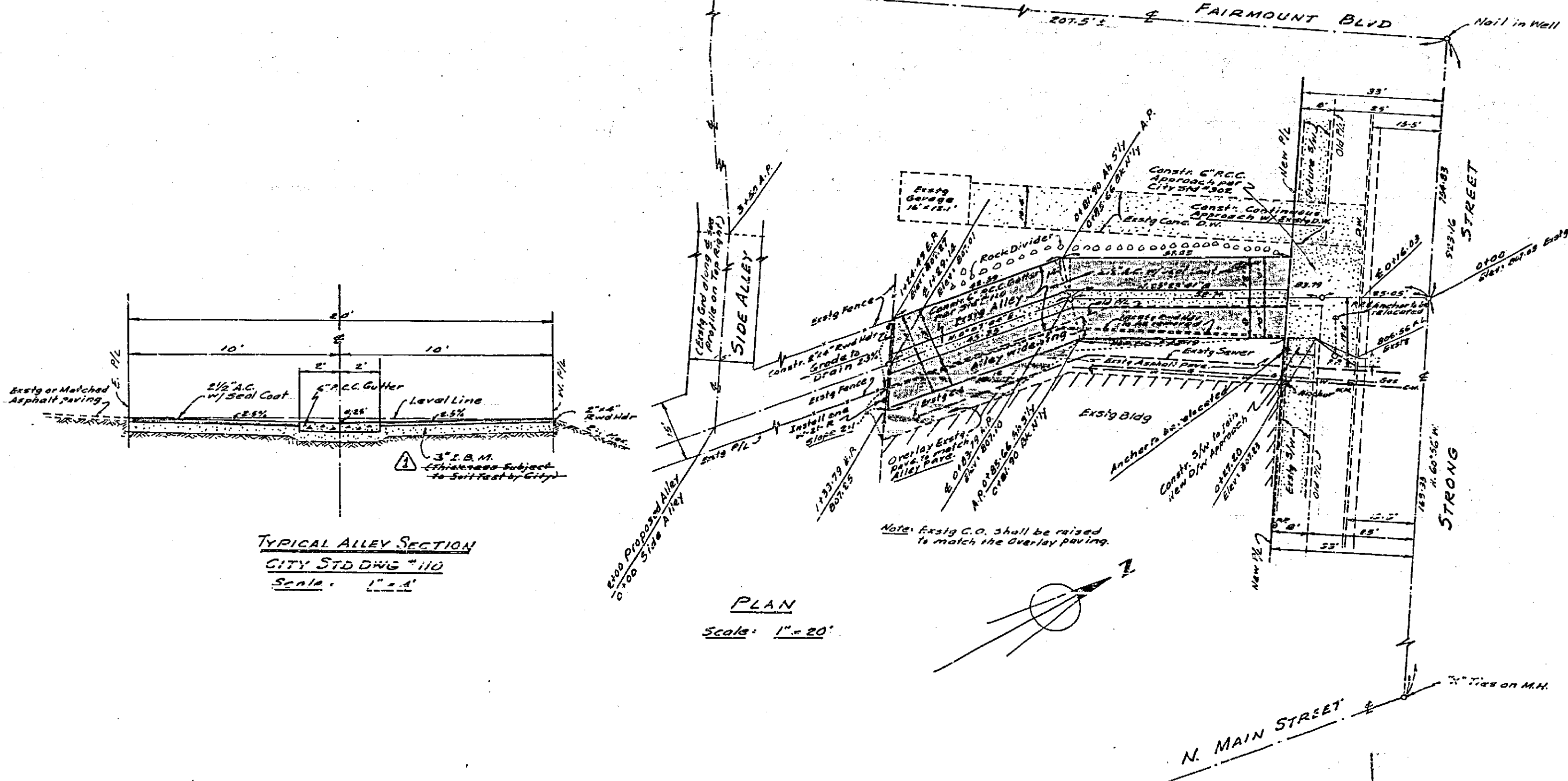

- GENERAL NOTES**
1. ALL WORK SHALL CONFORM TO SPECIFICATION NO. 461 AND APPLICABLE STANDARD DRAWINGS OF THE CITY OF RIVERSIDE.
 2. IT SHALL BE THE RESPONSIBILITY OF THE CONTRACTOR TO CLEAR THE RIGHT OF WAY IN ACCORDANCE WITH THE PROVISION OF LAW AS IT AFFECTS EACH UTILITY INCLUDING ITS APPURTENANCE, AND AT NO COST TO THE CITY.
 3. POWER POLE & ANCHOR WITHIN R/W SHALL BE RELOCATED.
 4. THE CITY OF RIVERSIDE WILL TAKE A SOIL TEST TO DETERMINE THE REQUIREMENT ON IMPROVED BASE MATERIAL AFTER THE ALLEY HAS BEEN PREPARED TO ROUGH GRADE.
 5. PRIME COAT & PAINT BINDER ARE REQUIRED.

HUGH M. GALLAHER
 Civil Engineer
 Riverside California
 Approved by *Hugh M. Gallaher* Date 10-11-63

REVISIONS			CITY OF RIVERSIDE CALIFORNIA DEPARTMENT OF PUBLIC WORKS
MARK	DATE	DESCRIPTION	
Δ	2/12/64	Full thickness of base to match existing (see spec. 10-11-63)	R-39-612 ALLEY PLAN & PROFILE 3' WY STRONG STREET W'LY OF MAIN STREET
DESIGNED BY	CHECKED BY	APPROVED BY	R-737 SHEET 1 OF 1
DRAWN BY	ADD	<i>Hugh M. Gallaher</i> DIRECTOR OF PUBLIC WORKS	
RECOMMENDED BY	ASSISTANT CITY ENGINEER	DATE 10-27-63	

BENCH MARK S&L in E. Curb Main St.
 20' N. W. of Shamrock St.
 Elev. 811.708 City 10/11/63