

REVISIONS			CITY OF RIVERSIDE, CALIFORNIA DEPARTMENT OF PUBLIC WORKS	
MARK	DATE	DESCRIPTION		
			CHICAGO AVENUE BET. EIGHTH & THIRD	
			TYPICAL CROSS SECTIONS	
DESIGNED BY	SUBMITTED BY	APPROVED BY	PROJ. NO.	3006
DRAWN BY	PARK DEPT.	DATE	R-743	
CHECKED BY	RECOMMENDED BY	DATE	7-13-64	
			SHEET 4 OF 4	

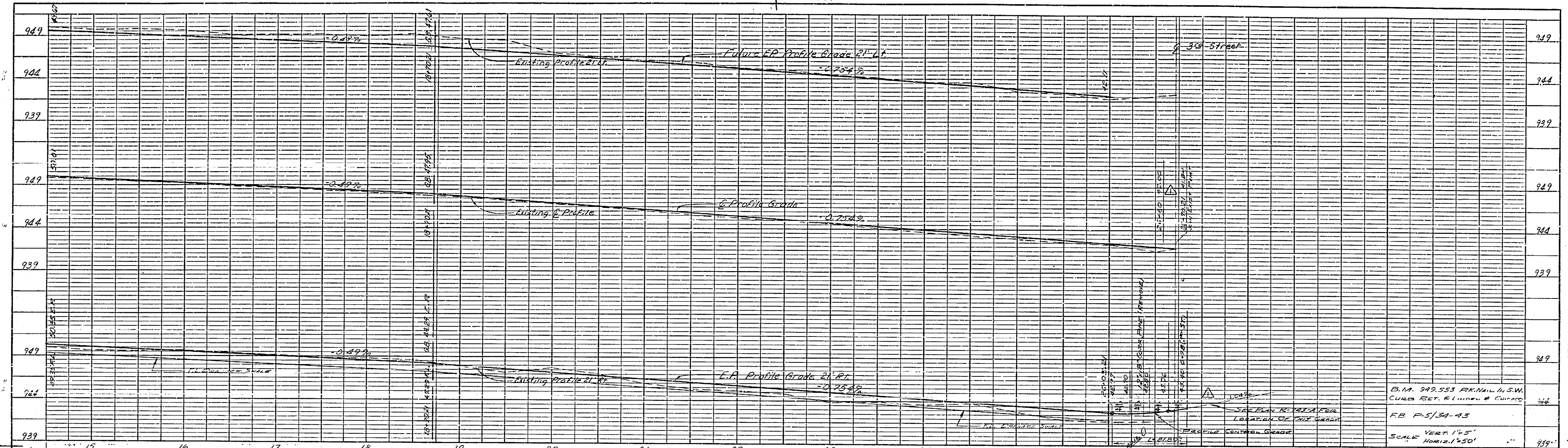

DATE	
BY	
SCALE	
PROJECT	
NOTE BOOK	
NO. OF SHEETS	
NO. OF SHEETS CHECKED	
NO. OF SHEETS REVISIONS	
NO. OF SHEETS TINSCH-10	

DATE	
BY	
SCALE	
PROJECT	
NOTE BOOK	
NO. OF SHEETS	
NO. OF SHEETS CHECKED	
NO. OF SHEETS REVISIONS	
NO. OF SHEETS TINSCH-10	

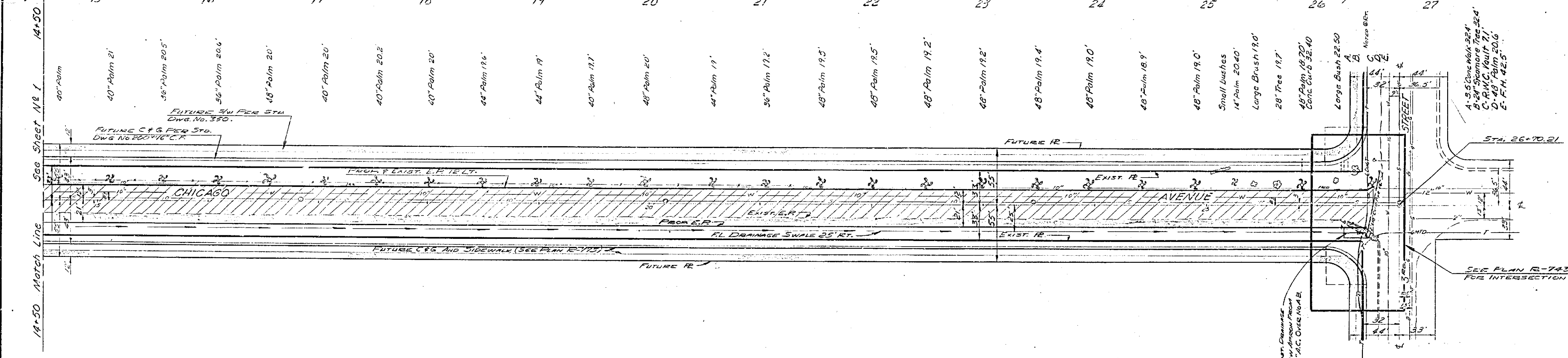

SCALE 1" = 50'

NOTE:
 FOR SIGNING LEGEND SEE SHEET 1

REVISIONS			CITY OF RIVERSIDE, CALIFORNIA DEPARTMENT OF PUBLIC WORKS	
MARK	DATE	DESCRIPTION		
△	7-30-64	REVISED 12% AGENDUM NO. 1 AM. 087 JRM		
			CHICAGO AVENUE BET. EIGHTH & THIRD LINDEN TO THIRD	
DESIGNED BY	SUBMITTED BY	APPROVED BY	PROJ. NO.	
DRAWN BY	PARK DEPT.	TRAFFIC DIV.	R-743	
CHECKED BY	RECOMMENDED BY	DATE	7-13-64	SHEET 2 OF 2

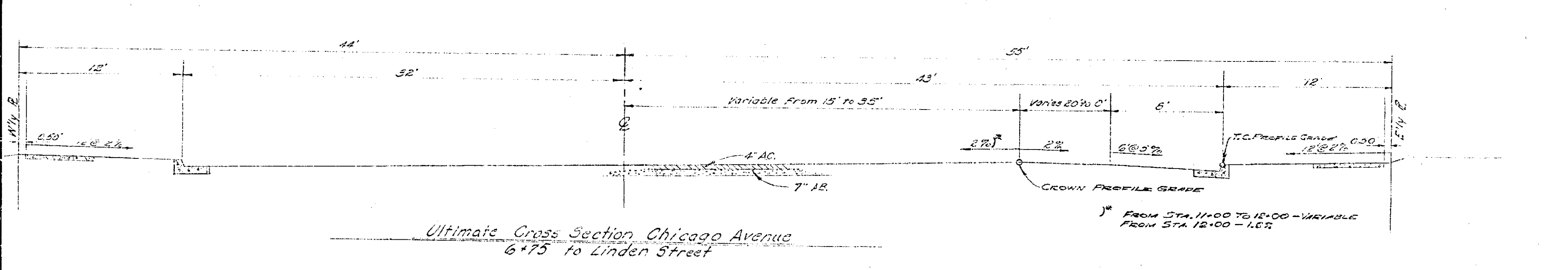
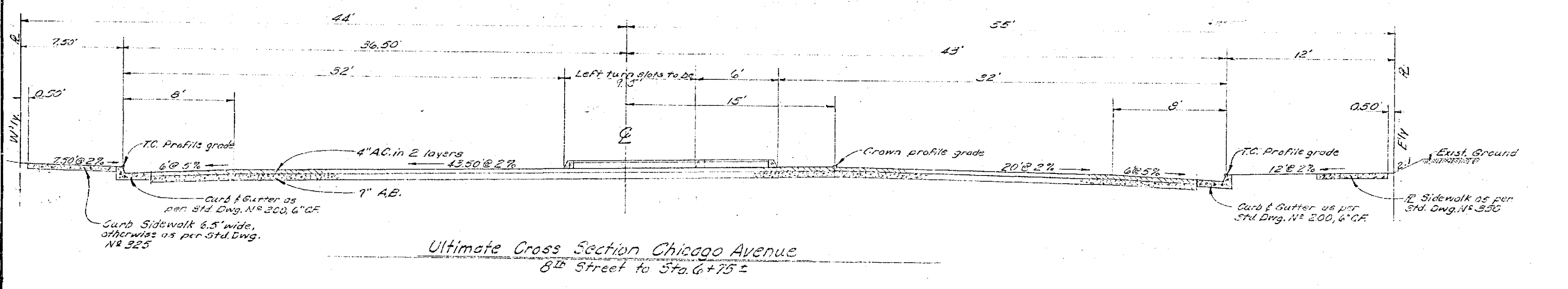
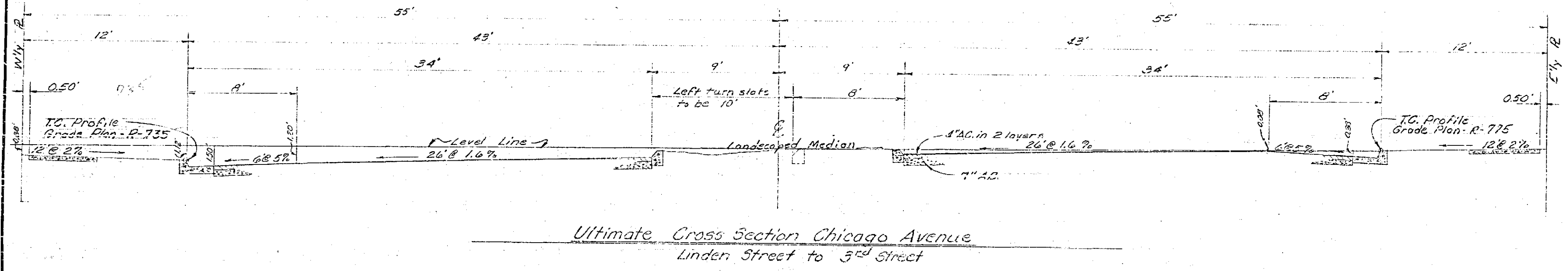
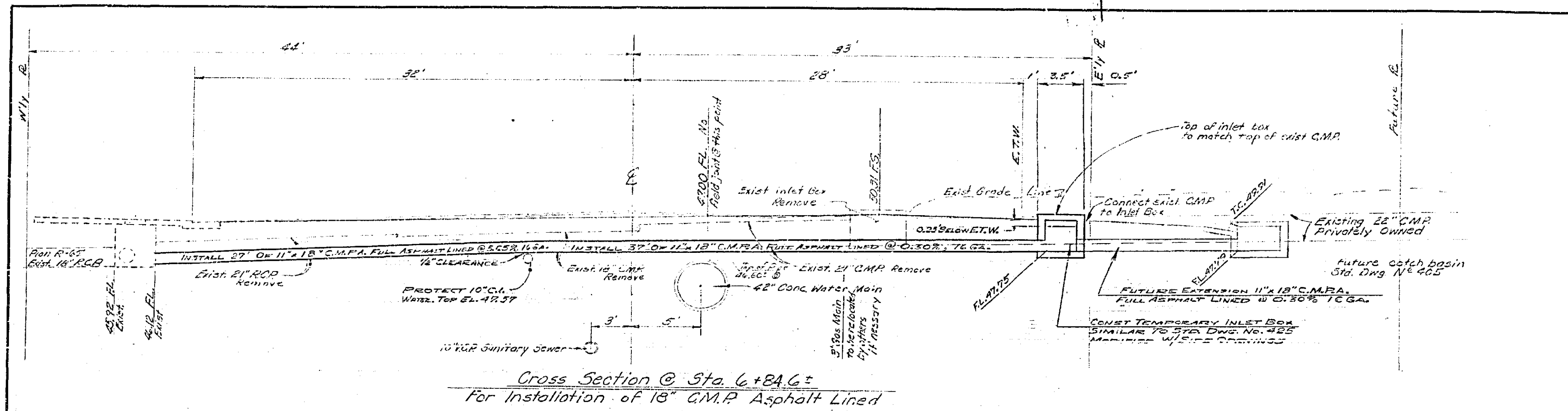

REVISIONS			CITY OF RIVERSIDE, CALIFORNIA DEPARTMENT OF PUBLIC WORKS	
MARK	DATE	DESCRIPTION		
			CHICAGO AVENUE BET. EIGHTH & THIRD TYPICAL CROSS SECTIONS	
DESIGNED BY	QUANTITY BY	APPROVED BY	PROJ. NO. 3006	
DRAWN BY	PARK DEPT.	TRAFFIC DIV.	R-743	
CHECKED BY	RECOMMENDED BY	DATE	SHEET 3 OF 4	

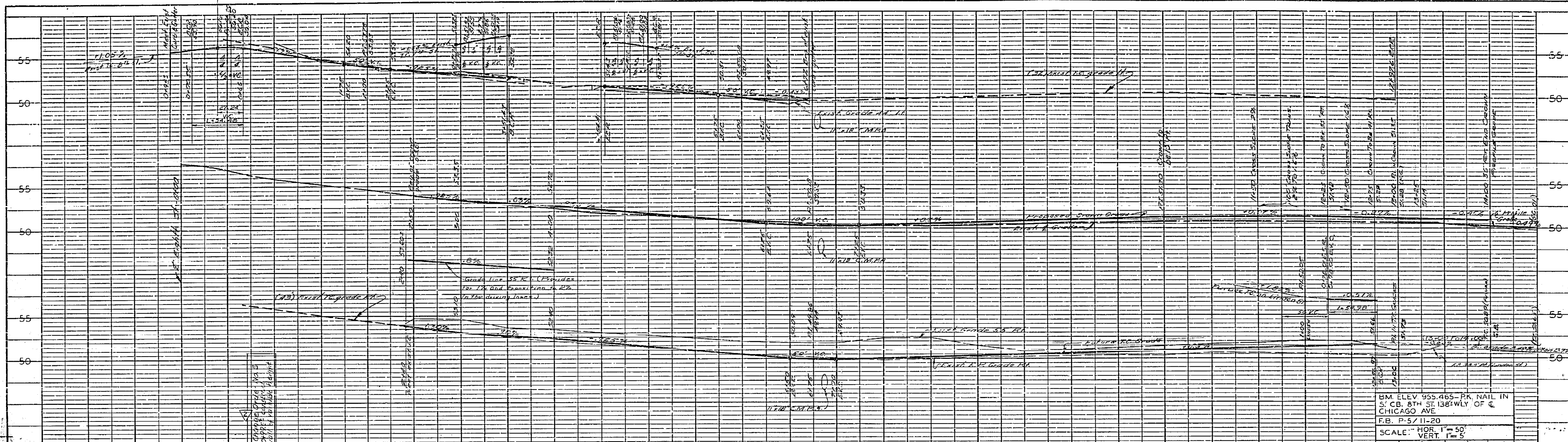

NO.	DATE	DESCRIPTION
1		AS SHOWN
2		AS SHOWN
3		AS SHOWN
4		AS SHOWN
5		AS SHOWN
6		AS SHOWN
7		AS SHOWN
8		AS SHOWN
9		AS SHOWN
10		AS SHOWN
11		AS SHOWN
12		AS SHOWN
13		AS SHOWN
14		AS SHOWN
15		AS SHOWN
16		AS SHOWN
17		AS SHOWN
18		AS SHOWN
19		AS SHOWN
20		AS SHOWN
21		AS SHOWN
22		AS SHOWN
23		AS SHOWN
24		AS SHOWN
25		AS SHOWN
26		AS SHOWN
27		AS SHOWN
28		AS SHOWN
29		AS SHOWN
30		AS SHOWN
31		AS SHOWN
32		AS SHOWN
33		AS SHOWN
34		AS SHOWN
35		AS SHOWN
36		AS SHOWN
37		AS SHOWN
38		AS SHOWN
39		AS SHOWN
40		AS SHOWN
41		AS SHOWN
42		AS SHOWN
43		AS SHOWN
44		AS SHOWN
45		AS SHOWN
46		AS SHOWN
47		AS SHOWN
48		AS SHOWN
49		AS SHOWN
50		AS SHOWN

BM. ELEV. 955.465 P.M. NAIL IN
 S. CB. 8TH ST. 138' W. LY. OF C.
 CHICAGO AVE.
 F.B. P-5/11-20
 SCALE: HOR. 1"=50'
 VERT. 1"=5'

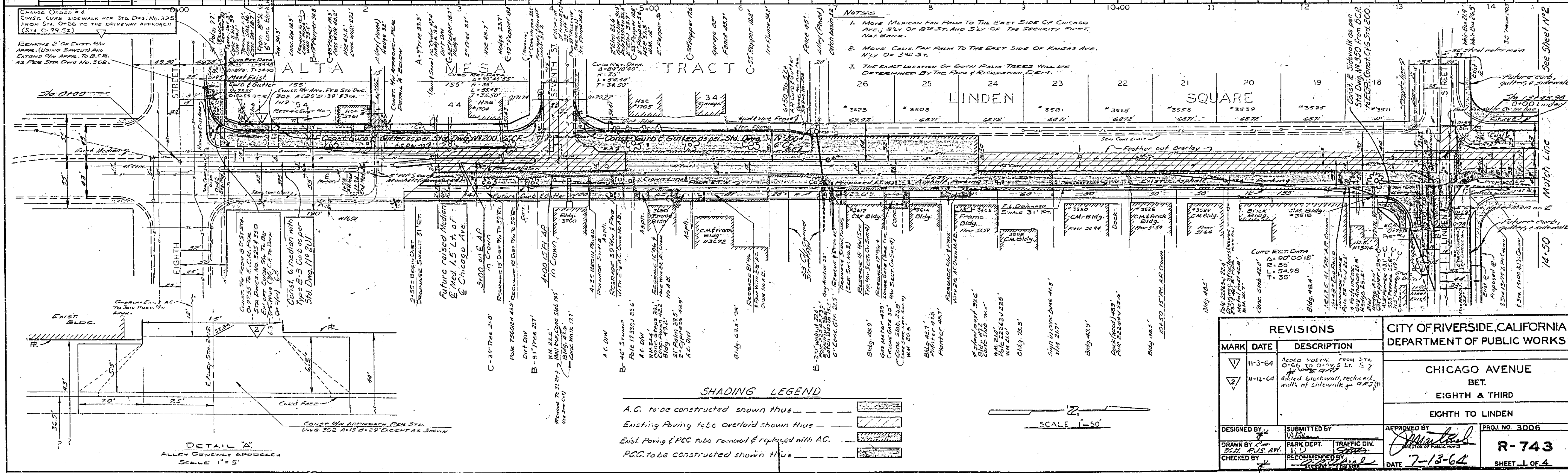

- NOTES
1. MOVE MEXICAN FAN PALM TO THE EAST SIDE OF CHICAGO AVE. SLY. DE 8TH ST. AND SLY. OF THE SECURITY FINET, NAT. BANK.
 2. MOVE CALIF. FAN PALM TO THE EAST SIDE OF KANSAS AVE. NLY. OF 343 ST.
 3. THE EXACT LOCATION OF BOTH PALM TREES WILL BE DETERMINED BY THE PLAN & RESECTION DEPT.

CHANGE CROSS # 4
 CONST. CURB SIDEWALK PER STD. DWS. NO. 325
 FROM STA. 0+00 TO THE DRIVEWAY APPROACH
 (STA. 0+99.52)

REMOVE 2' OF EXIST. 100
 ANNA (LIVING SIDEWALK) AND
 EXTEND 90' ANNA TO B.C.B.
 AS PER STA. DWS. NO. 304.

DETAIL A
 ALLEY DRIVEWAY APPROACH
 SCALE 1"=5'

SHADING LEGEND

A.G. to be constructed shown thus

Existing paving to be overlaid shown thus

Exist. Paving & P.C.C. to be removed & replaced with A.G.

P.C.C. to be constructed shown thus

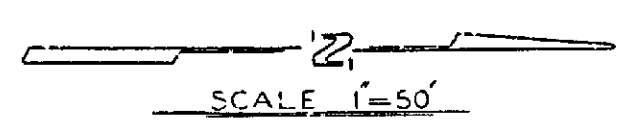

REVISIONS			CITY OF RIVERSIDE, CALIFORNIA DEPARTMENT OF PUBLIC WORKS
MARK	DATE	DESCRIPTION	
▽	11-3-64	ASSED 302' WALK FROM STA. 0+50 TO 0+70 S. LY. OF CHICAGO AVE.	CHICAGO AVENUE BET. EIGHTH & THIRD EIGHTH TO LINDEN
▽	11-12-64	Added sidewalk reduced width of sidewalk at 14+00	
DESIGNED BY	U.S.	SUBMITTED BY	APPROVED BY
DRAWN BY	W.M.	PARK DEPT.	TRAFFIC DIV.
CHECKED BY	W.M.	RECOMMENDED BY	DATE 7-13-64
			PROJ. NO. 3006
			R-743
			SHEET 1 OF 4