

NO.	DATE	BY	DESCRIPTION
1			PREPARED
2			CHECKED
3			APPROVED

BENCH MARK:
Elev 796.45 100' W of Intersection Magnolia Avenue and Crowell Avenue per City F.B. 'T'.

- GENERAL NOTES:**
- It shall be the responsibility of the contractor to clear the right of way in accordance with the provisions of the law and to provide cost estimates including temporary lines and expenditures and of no cost to the city.
 - Construction shall be in accordance with the City of Riverside, Department of Public Works Specifications, Nos. 461 and Standard Drawings.
 - Prime coat and punch binder are required.
 - True edge of existing paving where new paving forms existing pavement to clear of traffic for construction, including opening up storm and sanitary existing pipes as directed in the field to produce a smooth crown section.

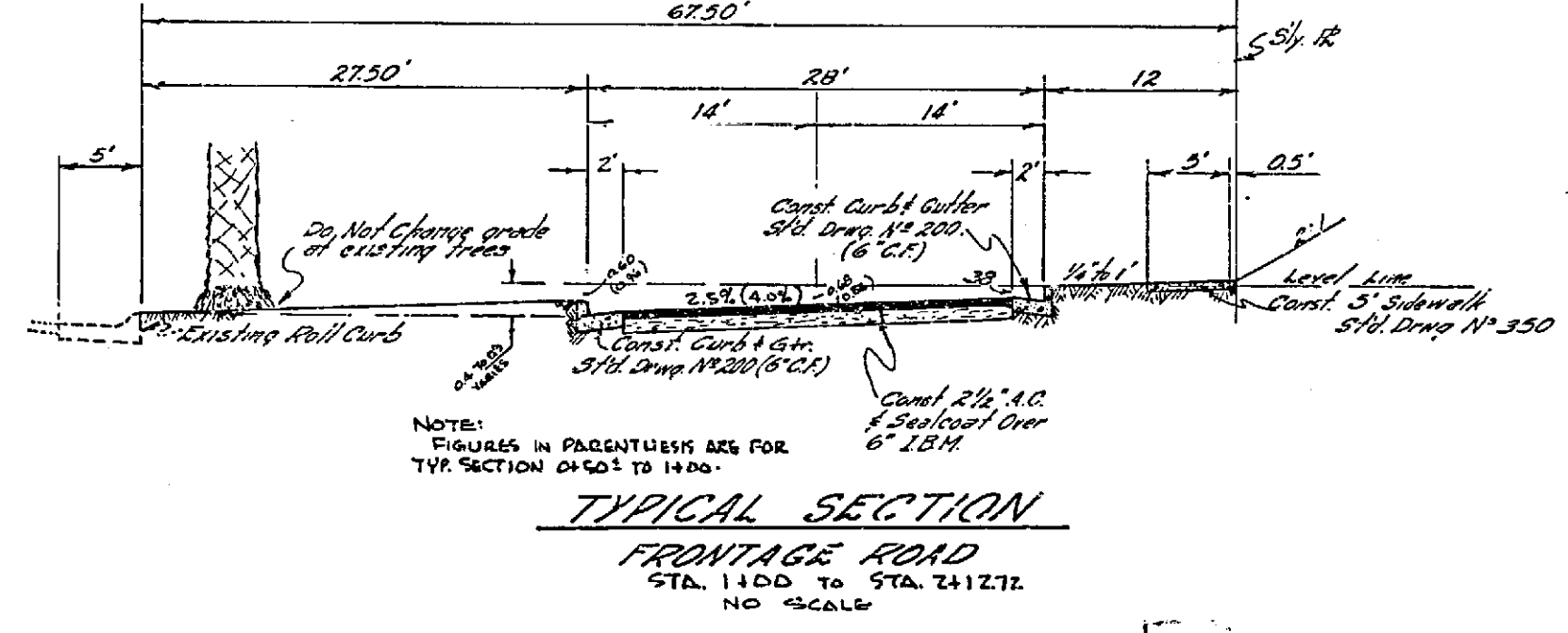
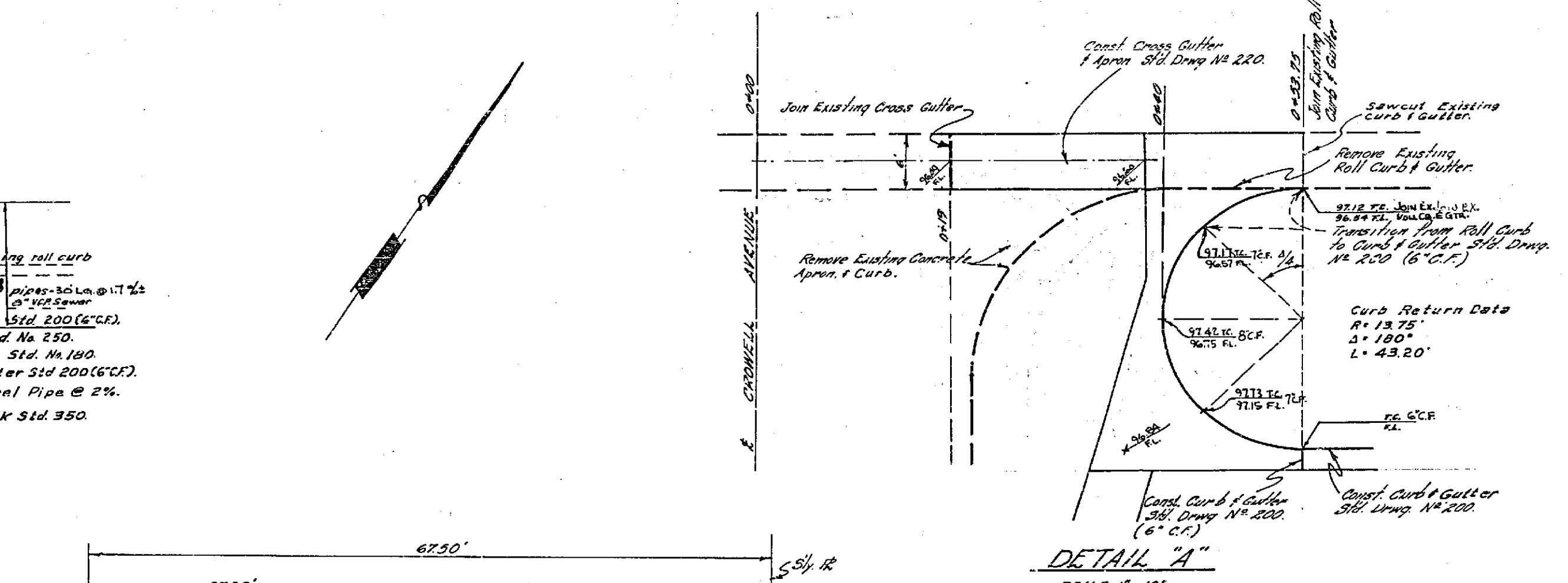
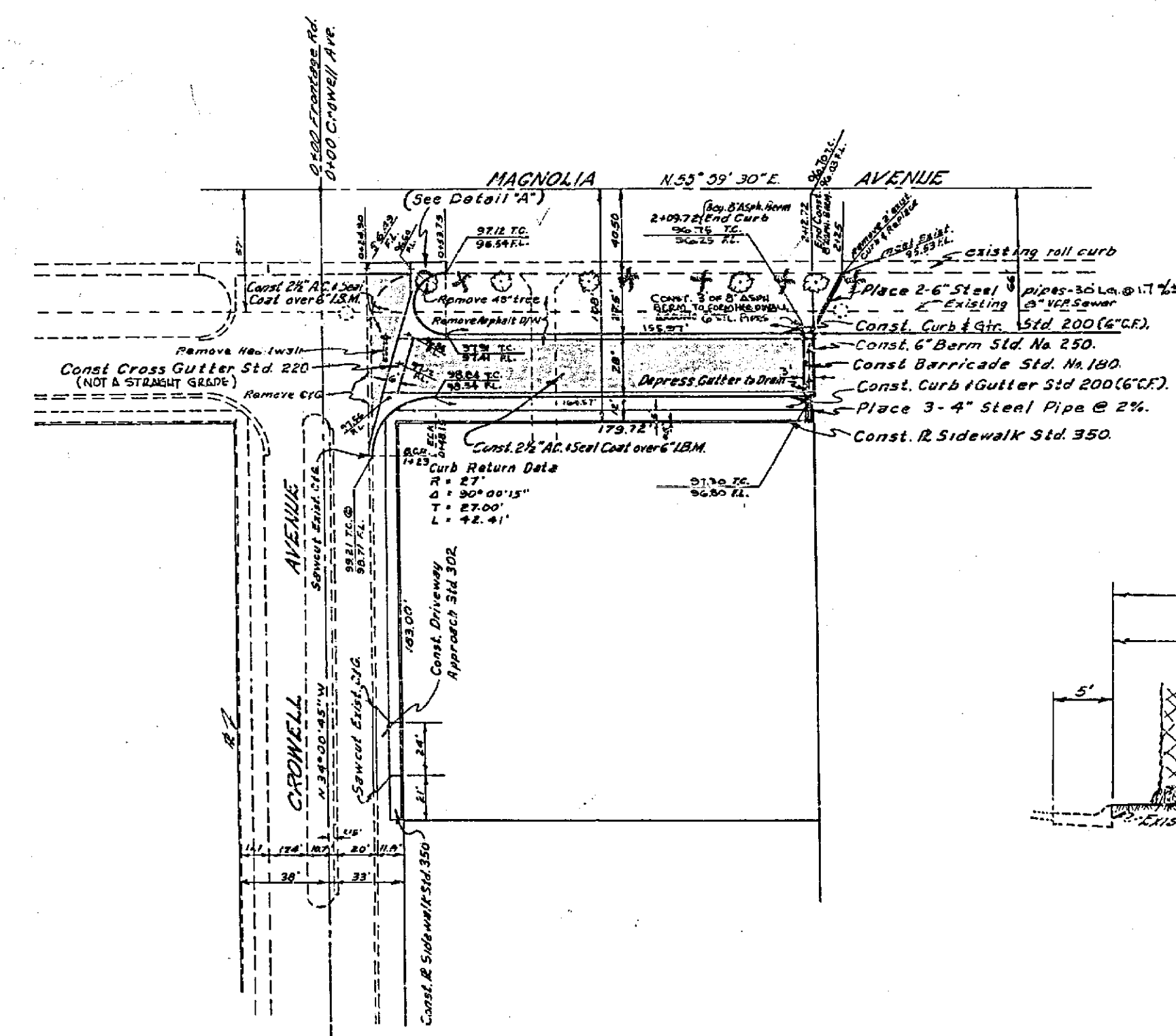

QUANTITY ESTIMATE

2 1/2\"/>	5,475 S.F.
6\"/>	101 C.Y.
Standard No. 200 Curb/Gutter (6\"/>	406 L.F.
Standard No. 350 R. Sidewalk	1,840 S.F.
Standard No. 220 Cross Gutter & Apron	550 S.F.
Standard No. 180 Barricade	1 E.P.
Standard No. 250 Berm (6\"/>	29 L.F.
Standard No. 302 Driveway Approach	1 E.P.
Tree removal	34 L.F.
4\"/>	60 L.F.
6\"/>	123 L.F.
Curb/Gutter removal	130 S.F.

APPROVED <i>John P. ...</i> DATE 9-23-63	ALBERT A. WEBB ASSOCIATES CIVIL ENGINEERS - RIVERSIDE, CALIFORNIA APPROVED <i>Albert A. Webb</i> DATE 8/28/63	
REVISION		
MARK	DATE	DESCRIPTION
CITY OF RIVERSIDE, CALIFORNIA DEPARTMENT OF PUBLIC WORKS		
STREET PLAN & PROFILE		
MAGNOLIA AVENUE FRONTAGE ROAD ZONING CASE R-58-623		
DATE 8/28/63	SCALE 1" = 50'	APPROVED BY <i>Albert A. Webb</i>
DRAWN <i>E.N.L. ...</i>	W.D. 63-229	SHEET NO. R-745
CHECKED <i>W.D. ...</i>	F.B. 427-41	DATE 9-30-63 SHEET 1 OF 1

NO.	DATE	BY	DESCRIPTION
1			PLAN
2			CHECKED
3			APPROVED

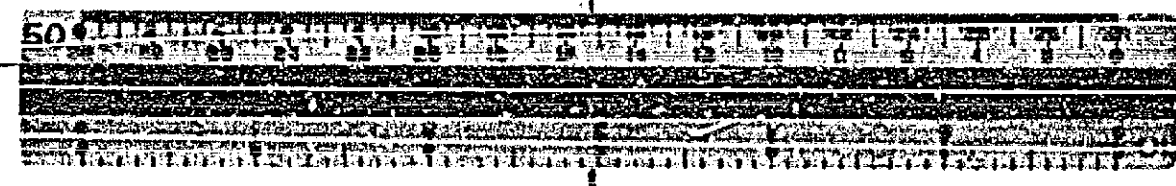

DWG. No. 63-229