

PROFILE
SCALE: 1" = 50' Horiz.
1" = 5' Vert.

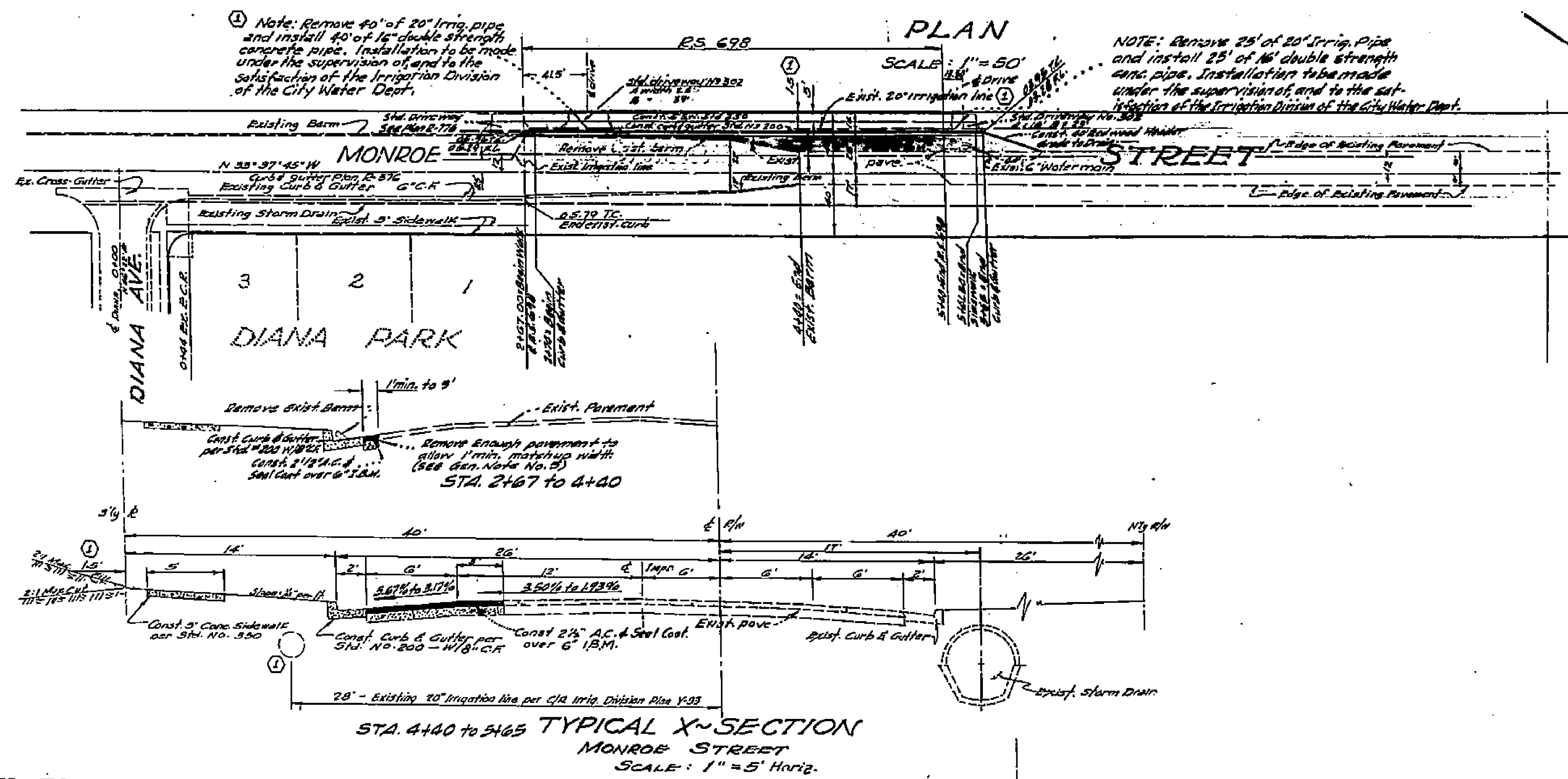

PLAN
SCALE: 1" = 50'

Note: Remove 40' of 20" Irrig. pipe and install 40' of 16" double strength concrete pipe. Installation to be made under the supervision of, and to the satisfaction of, the Irrigation Division of the City Water Dept.

NOTE: Remove 25' of 20" Irrig. pipe and install 25' of 16" double strength concrete pipe. Installation to be made under the supervision of, and to the satisfaction of, the Irrigation Division of the City Water Dept.

- Notes
1. All work and materials shall comply with the specifications No. 461, Standards of the City of Riverside, Dept. of Public Works.
 2. Prime coat, seal coat, and joint binder are required.
 3. Grading will require a permit under Ordinance 4093 for a cut or fill exceeding 100 cubic yards, or a fill over one foot in depth.
 4. B.M. 15 + on bolt on E.H. of S.W. corner of Magnolia Ave and Monroe St. Elev. 781.78
 5. Trim edge of existing paving to clean straight line construct matchup paving as shown and over by existing paving as directed in the field to produce smooth crown section.
 6. It shall be the responsibility of the contractor to clear the right of way in accordance with the provisions of law as it affects each utility, including irrigation lines and appurtenances and at no extra cost to the City of Riverside

STA. 4+40 TO 5+65 TYPICAL X-SECTION
MONROE STREET
SCALE: 1" = 5' Horiz.

IRRIGATION DIV. Approved <i>Harold L. Crean</i> Date: 07/25/63		McKEE & CRAWLEY SURVEYORS AND ENGINEERS Riverside, California Approved <i>George O. Crawley</i> Field Bk. No. 9355 Date 7-2-63	
REVISIONS		CITY OF RIVERSIDE CALIFORNIA DEPARTMENT OF PUBLIC WORKS	
MARK ① 6-16-63	DATE 6-16-63	DESCRIPTION Change vertical location from 15' off R to 15' off L and change location of irrigation permit location to C.	STREET PLAN & PROFILE R/S 693 MONROE STREET BETWEEN DIANA & MAGNOLIA
DESIGNED BY DRAWN BY	CHECKED BY <i>Tom Ludwig</i> J.E.K.	APPROVED BY <i>George O. Crawley</i> DIRECTOR OF PUBLIC WORKS	R-749 DATE Nov 5, 1963 SHE. 1 OF 1

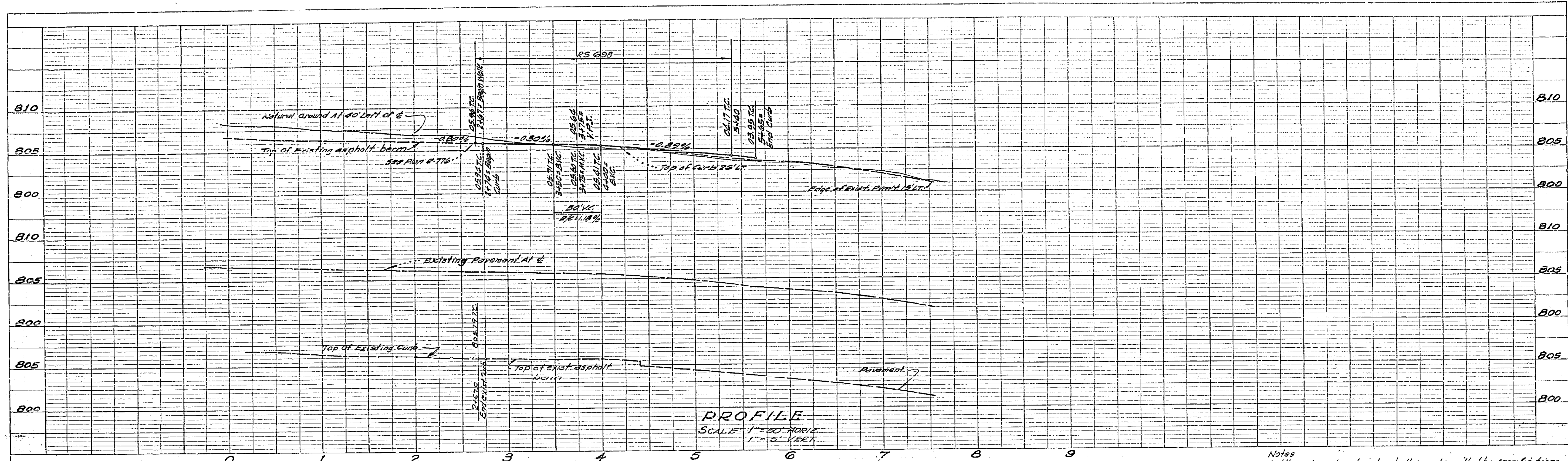

PROFILE
 SCALE: 1" = 50' HORIZ.
 1" = 6' VERT.

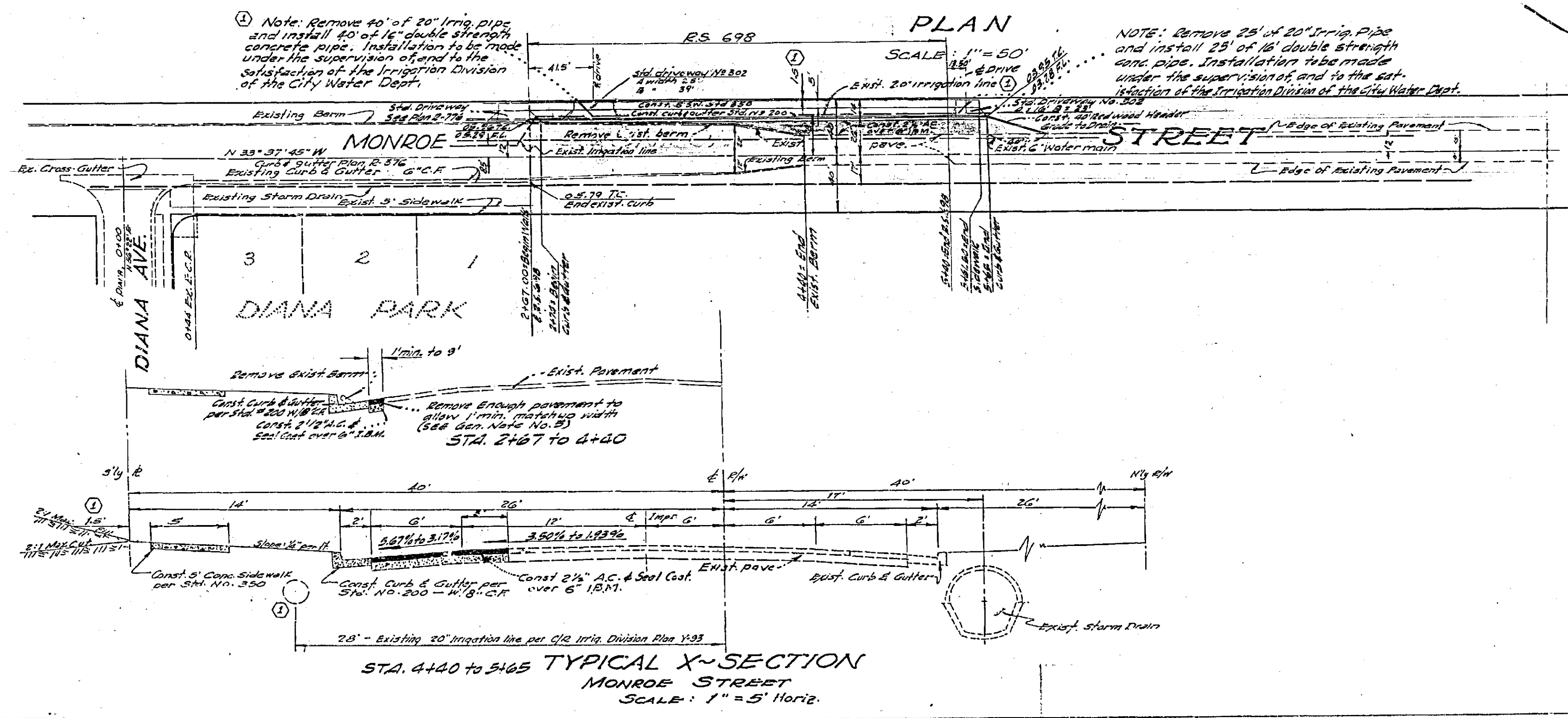

PLAN
 SCALE: 1" = 50'

Note: Remove 4' of 20" Irrig. pipe and install 40' of 16" double strength concrete pipe. Installation to be made under the supervision of and to the satisfaction of the Irrigation Division of the City Water Dept.

Note: Remove 25' of 20" Irrig. Pipe and install 23' of 16" double strength concrete pipe. Installation to be made under the supervision of and to the satisfaction of the Irrigation Division of the City Water Dept.

- Notes
- All work and materials shall comply with the specifications No. 61, Standards of the City of Riverside, Dept. of Public Works.
 - Drill, coat, seal coat, and paint binder are required.
 - Grading will require a permit under Ordinance 3093 for a cut or fill exceeding 100 cubic yards, or a fill over one foot in depth.
 - B.M. 15 on bolt on E.H. of S.W. corner of Magnolia Ave and Monroe St. Elev. 781.78
 - Trim edge of existing paving to clean straight line construct matchup paving as shown and overlay existing paving as directed in the field to produce smooth crown section.
 - It shall be the responsibility of the contractor to clear the right of way in accordance with the provisions of law as it affects such utility, including irrigation lines and appurtenances and at no extra cost to the City of Riverside.

IRRIGATION DIV. Approved: <i>Harold S. Brown</i> Date: 10/25/63		McKee & Crawley SURVEYORS AND ENGINEERS Riverside, California Approved: <i>George O. Crawley</i> R.E. No. 9435	
REVISIONS MARK DATE DESCRIPTION		CITY OF RIVERSIDE, CALIFORNIA DEPARTMENT OF PUBLIC WORKS	
①	2-22-63	Change sidewalk location from 4' off R to 15' off R and change location of irrigation pipe to 16" C.C.	STREET PLAN & PROFILE R/S 698 MONROE STREET BETWEEN DIANA & MAGNOLIA
②	2-15-64	Change limits of curb and revise grade line & typical section. Approved: <i>George O. Crawley</i> R.E. No. 9435	
DESIGNED BY	CHECKED BY <i>Ray W. J. J.</i>	APPROVED BY <i>George O. Crawley</i>	R-749
RECOMMENDED BY <i>J. B. ...</i>	ASSISTANT CITY ENGINEER	DIRECTOR OF PUBLIC WORKS	DATE Nov 6, 1963

PROFILE	DATE	BY	SCALE

PLAN	DATE	BY	SCALE

TYPICAL X-SECTION
 MONROE STREET
 SCALE: 1" = 5' HORIZ.