

ENGINEER'S EST. OF QUANT. FOR STREET CONST.

ITEM	UNIT	QUANTITY
STREET EXCAVATION	YDS ³	25,000
2" 10% ASP. W/LEAK COAT	YDS ²	420
CONCRETE SIDEWALK 12"x12"x4"	YDS ²	420
CONCRETE CURB 6"x6"x4"	YDS ²	420
CONCRETE SIDEWALK 5'x5'x4"	YDS ²	1,140
CONCRETE SIDEWALK 12'x12'x4"	YDS ²	420
CONCRETE SIDEWALK 6'x6'x4"	YDS ²	420
CONCRETE SIDEWALK 3'x3'x4"	YDS ²	420
CONCRETE SIDEWALK 1.5'x1.5'x4"	YDS ²	420
CATCH BASIN 5'x4'x4"	EA.	1
MANHOLE 4'x4'x4"	EA.	1
MANHOLE 2'x2'x4"	EA.	1

STREET NAME SIGN SCHEDULE

STREET NAME	EXISTING SIGN	TO BE RELOCATED
IOWA AVE 3300	1	0
8TH ST 1200	0	1

CURB RETURN & CURVE DATA

STATION	CHORD BEARING	CHORD DIST.	CHORD CURV. RAD.	CHORD CURV. DIST.
0+00	N 89° 12' 12" E	34.91'	3492'	6.21'
1+50	N 89° 05' 50" E	34.91'	3492'	6.21'
3+00	N 89° 05' 50" E	34.91'	3492'	6.21'

SEE STREET LIGHTING & TRAFFIC SIGNAL PLAN X-133 FOR PROPOSED UNDERGROUND ELECTRICAL SYSTEMS

GENERAL NOTES - Street Plans

- It shall be the responsibility of the contractor to clear the right of way in accordance with the provisions of law as it affects such utility including irrigation lines and aqueducts, and of no cost to the City.
- Construction shall be in accordance with the City of Riverside Department of Public Works Specifications No. 40 and Standard Drawings.
- Prime coat and paint binder are required.
- The City of Riverside will take a soil test to determine the requirement on imported base material after the streets have been prepared to rough grade.
- Trim edge of existing pavement where new paving joins existing pavement, to a clean, straight line. Construct match up paving as shown and overlay paving as directed in the field to produce a smooth crown section.
- Grading will require a permit under ordinance 3093 for a cut or fill exceeding 100 cubic yards, or a fill over one foot in depth.

S.S. No. 199

REVISIONS

NO.	DATE	DESCRIPTION

DESIGNED BY: [Signature]
 DRAWN BY: [Signature]
 CHECKED BY: [Signature]
 APPROVED BY: [Signature]
 DATE: Oct 12/16

ALBERT A. WEBB ASSOCIATES
 CIVIL ENGINEERS
 RIVERSIDE, CALIFORNIA

K. IRVING MARSHALL
 LAKE ARROWHEAD, CALIFORNIA

CITY OF RIVERSIDE CALIFORNIA
 DEPARTMENT OF PUBLIC WORKS

STREET PLAN & PROFILE
 IOWA AVE.
 SLY OF EIGHTH ST.
 R/S 725

HORIZ SCALE 1"=50' VERT SCALE 1"=5'

R-750
 SHEET 1 OF 2

PROFILE

NO.	DATE	DESCRIPTION

PLAN

NO.	DATE	DESCRIPTION

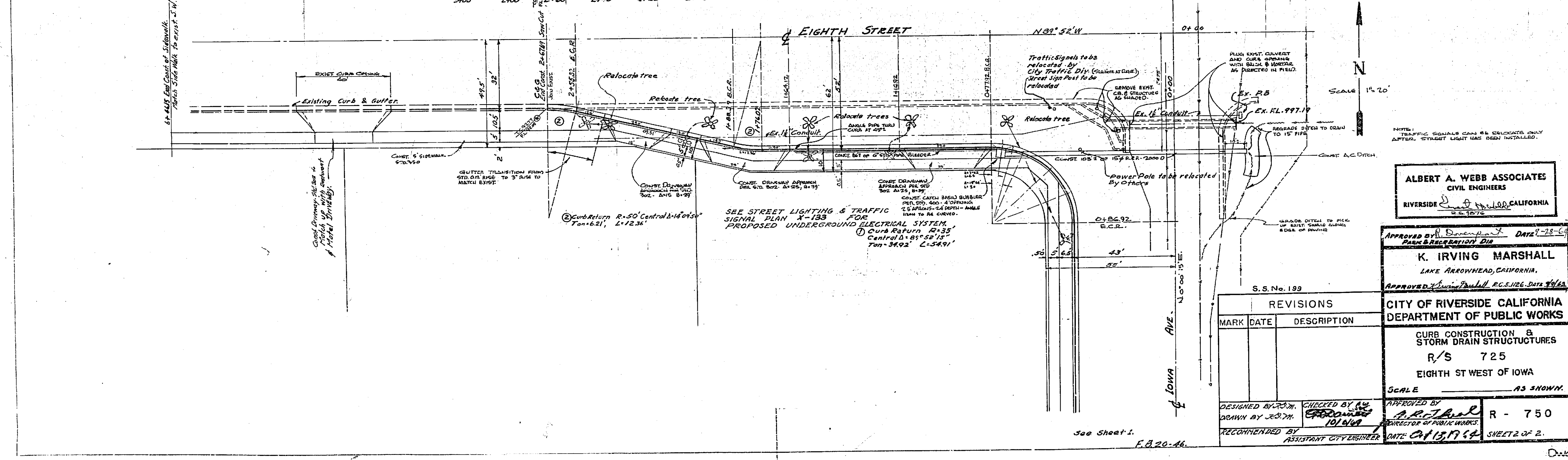
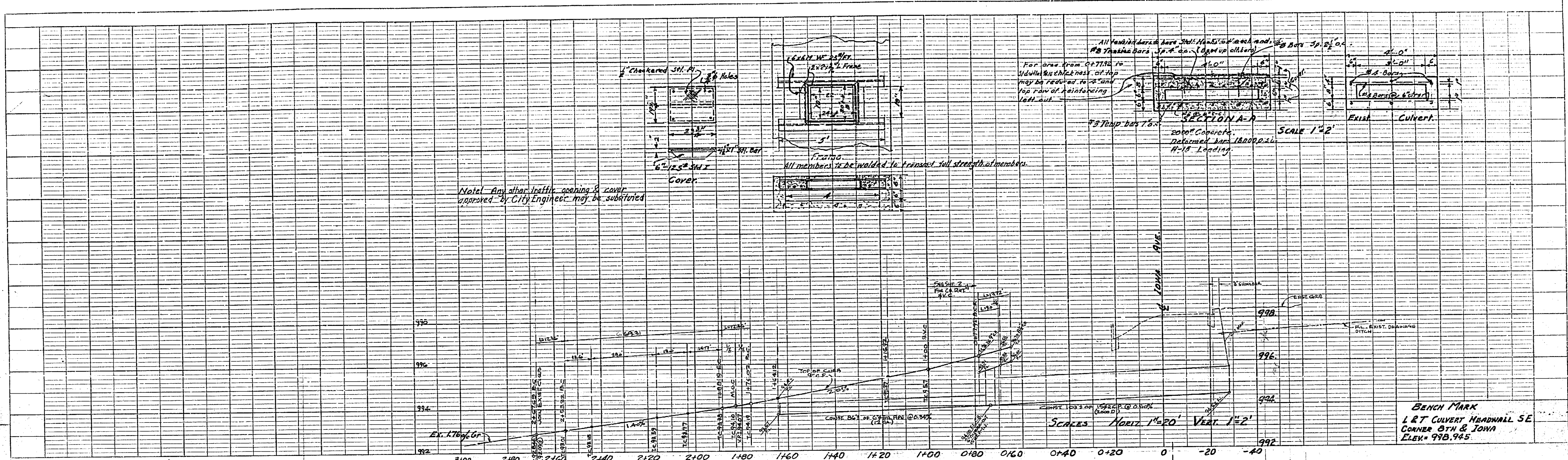

Note: Any other traffic opening & cover approved by City Engineer may be substituted

All vertical bars have 3/8\"/>

BENCH MARK
 L & T CULVERT HEADWALL SE
 CORNER 8TH & IOWA
 ELEV. = 998.945

ALBERT A. WEBB ASSOCIATES
 CIVIL ENGINEERS
 RIVERSIDE, CALIFORNIA

APPROVED BY *[Signature]* DATE 7-28-69
 K. IRVING MARSHALL
 LAKE ARROWHEAD, CALIFORNIA
 APPROVED BY *[Signature]* P.C.E. 126 DATE 7/28/69

REVISIONS		
MARK	DATE	DESCRIPTION

CITY OF RIVERSIDE CALIFORNIA
 DEPARTMENT OF PUBLIC WORKS
 CURB CONSTRUCTION &
 STORM DRAIN STRUCTURES
 R/S 725
 EIGHTH ST WEST OF IOWA
 SCALE AS SHOWN

DESIGNED BY *[Signature]* CHECKED BY *[Signature]* 10/16/69
 DRAWN BY *[Signature]* RECOMMENDED BY *[Signature]* DATE 7/13/69
 APPROVED BY *[Signature]* R - 750
 DIRECTOR OF PUBLIC WORKS SHEET 2 OF 2

PROFILE	DATE

PLAN	DATE

See Sheet 1.
 F.B.20-46