

PROFILE	DATE
NO. 100	
DATE	

Scale: Horiz 1"=50'
 Vert 1"=5'

BENCH MARK: 215V 95800
 NAD 1911 at intersection of
 Palmyrita & S.E. RR

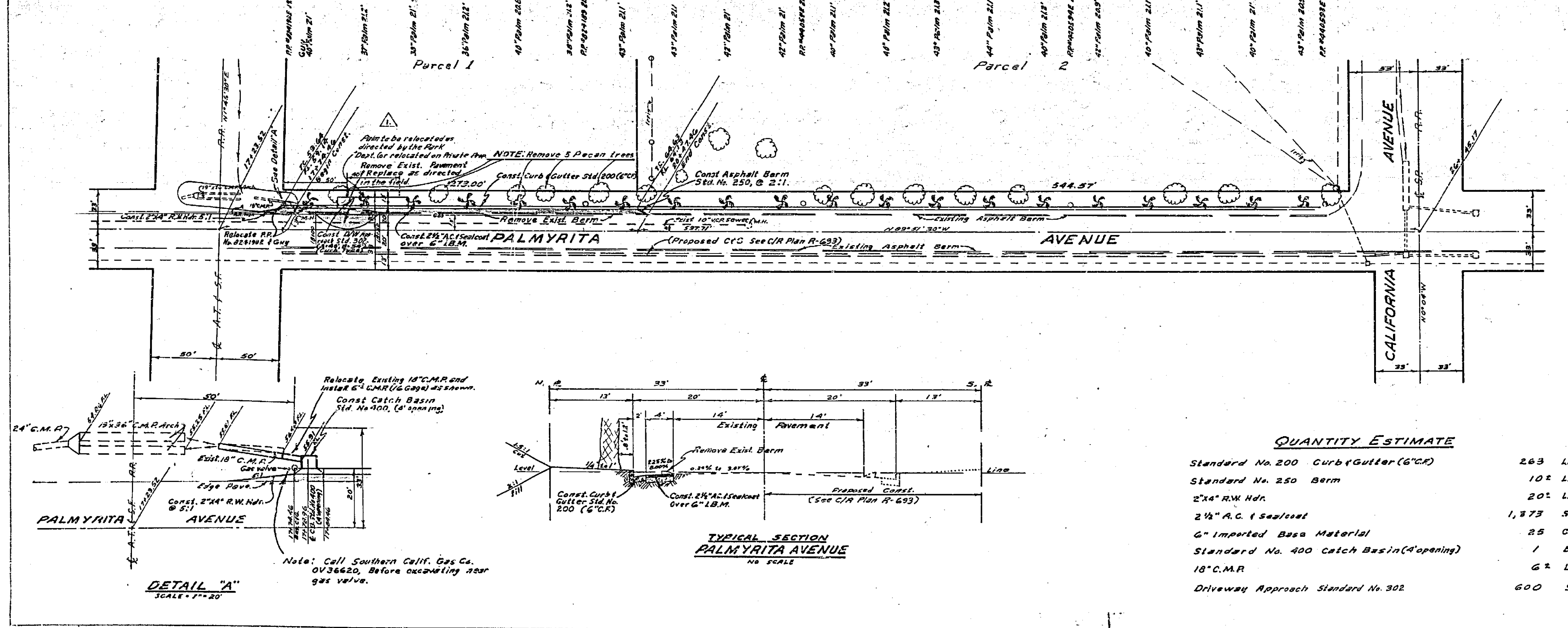

- GENERAL NOTES:**
- Construction to be in accordance with Standards and Specifications No. 461 of the City of Riverside, Dept. of Public Works.
 - Trim edge of existing paving where new paving joins existing pavement, to clean, straight line. Construct match-up paving as shown and verify existing paving as directed in the field to produce a smooth crown section.
 - Prima coat & paint binder are required.
 - It shall be the responsibility of the Contractor to clear the Right of Way in accordance with the provisions of law as it affects each utility including irrigation lines and appurtenances and at no extra cost to the City of Riverside.
 - Location of curb SW driveway approaches to be determined at time of construction for Roll-off that has been approved by the Traffic Dept.

PLAN	DATE
NO. 100	
DATE	

Approved: <i>Ellis R. Hendley</i> MARK SUPERINTENDENT Date: 3-30-64		ALBERT A. WEBB ASSOCIATES CIVIL ENGINEERS - RIVERSIDE, CALIFORNIA APPROVED: <i>Paul N. Webb</i> DATE 10/1/63 11,997%	
REVISION		CITY OF RIVERSIDE, CALIFORNIA DEPARTMENT OF PUBLIC WORKS	
MARK	DATE	DESCRIPTION	STREET PLAN & PROFILE PALMYRITA AVENUE Between AT & SE R.R. & California
Δ	3/26/64	Added D.M. Remove Pecan trees, Relocated Palms, etc. See Plan R-754	
DATE	Oct. 1963	SCALE	1" = 50'
DRAWN	B.E.L.	W.D.	63-235
CHECKED	A.D.D.	F.B.	361/65-73
		DATE	11-17-63
		APPROVED BY	<i>Paul N. Webb</i> DIRECTOR OF PUBLIC WORKS
		NO.	R-754
		SHEET	1 OF 1

QUANTITY ESTIMATE

Standard No. 200 Curb & Gutter (6" C)	263 LF.
Standard No. 250 Berm	102 LF.
2"x4" R.W. Hdr.	202 LF.
2 1/2" A.C. (sealcoat)	1,373 S.F.
6" Imported Base Material	25 CY.
Standard No. 400 Catch Basin (opening)	1 EA.
18" C.M.R.	62 LF.
Driveway Approach Standard No. 302	600 S.F.