

SCALE HORIZ. 1"=20'  
VERT. 1"=2'

PROFILE  
DATE: 10/10/63  
DRAWN BY: [Signature]  
CHECKED BY: [Signature]

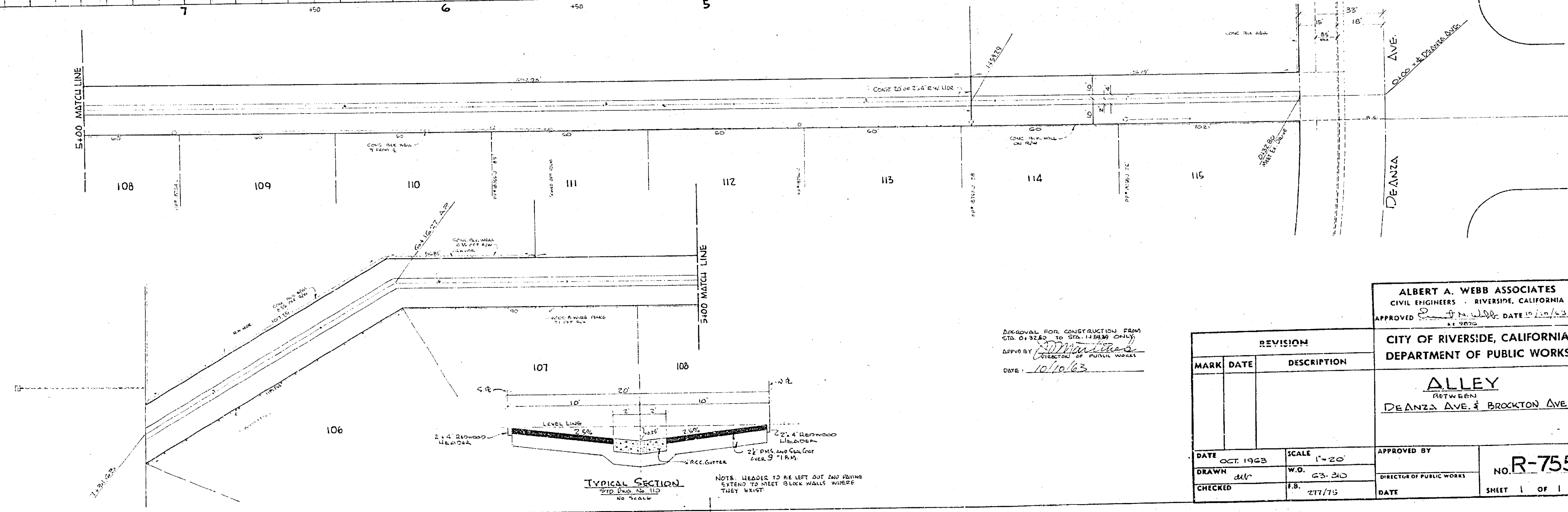

TYPICAL SECTION  
STIP. No. 110  
NOTE: HEADS TO BE LEFT OUT AND ROVING EXTEND TO MEET BLOCK WALLS WHERE THEY EXIST.

APPROVAL FOR CONSTRUCTION FROM STA. 0+32.50 TO STA. 1+39.00 ONLY  
APPROVED BY: [Signature]  
DATE: 10/10/63

ALBERT A. WEBB ASSOCIATES  
CIVIL ENGINEERS RIVERSIDE, CALIFORNIA  
APPROVED [Signature] DATE 10/10/63

CITY OF RIVERSIDE, CALIFORNIA  
DEPARTMENT OF PUBLIC WORKS

ALLEY  
BETWEEN  
DEANZA AVE. & BROCKTON AVE.

REVISION		
MARK	DATE	DESCRIPTION

APPROVED BY: [Signature]  
DIRECTOR OF PUBLIC WORKS  
DATE: 10/10/63

NO. R-755  
SHEET 1 OF 1

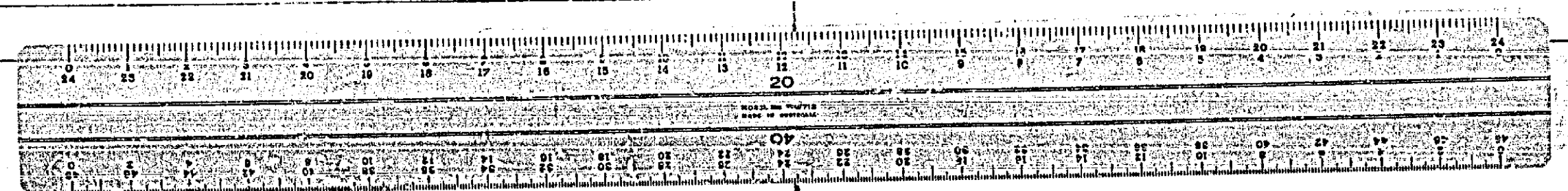

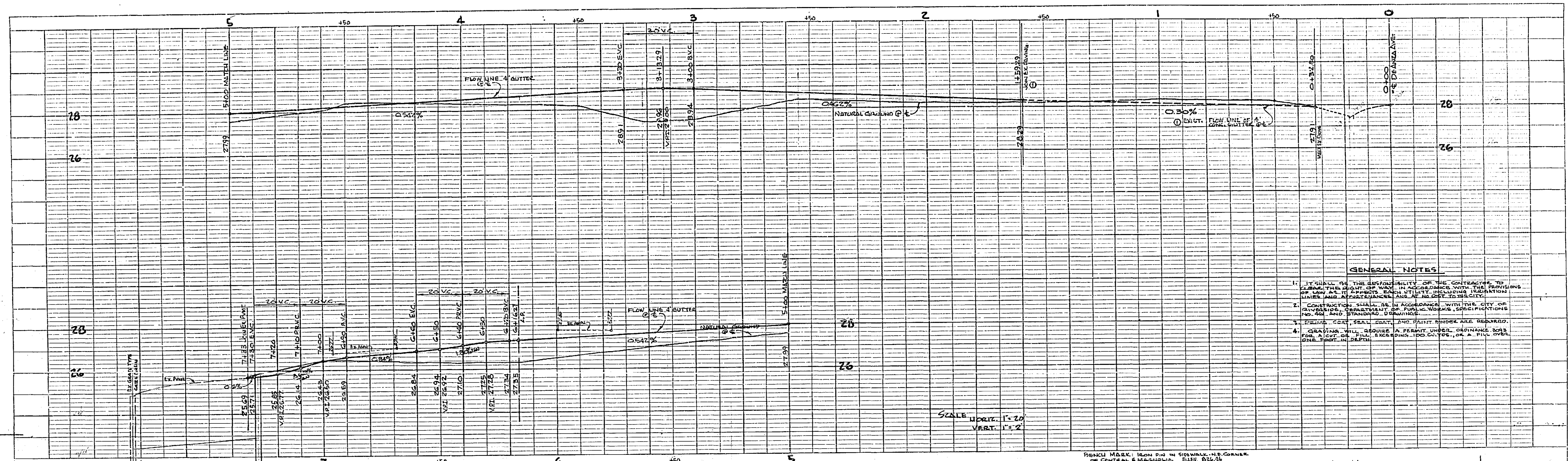

**PROFILE**

DATE	
NO.	
REVISION	
DATE	
BY	
CHECKED	
DATE	

**GENERAL NOTES**

1. IT SHALL BE THE RESPONSIBILITY OF THE CONTRACTOR TO OBTAIN THE RIGHT OF WAY IN ACCORDANCE WITH THE PROVISIONS OF LAW AS IT APPLICABLE TO THE PROJECT INCLUDING NECESSARY PERMITS AND STANDARDS AND TO BE SUBJECT TO THE CITY ENGINEER'S APPROVAL.
2. CONSTRUCTION SHALL BE IN ACCORDANCE WITH THE CITY OF RIVERSIDE, DEPARTMENT OF PUBLIC WORKS SPECIFICATIONS NO. 40 AND STANDARD DRAINING.
3. FILLING, GRASS, SEAL COAT, AND PAINT SHOULD BE REQUIRED.
4. GRADING WILL REQUIRE A PERMIT UNDER ORDINANCE 204 FOR A CUT OR FILL EXCEEDING 120 CUBIC YARDS OR A FILL OVER ONE FOOT IN DEPTH.

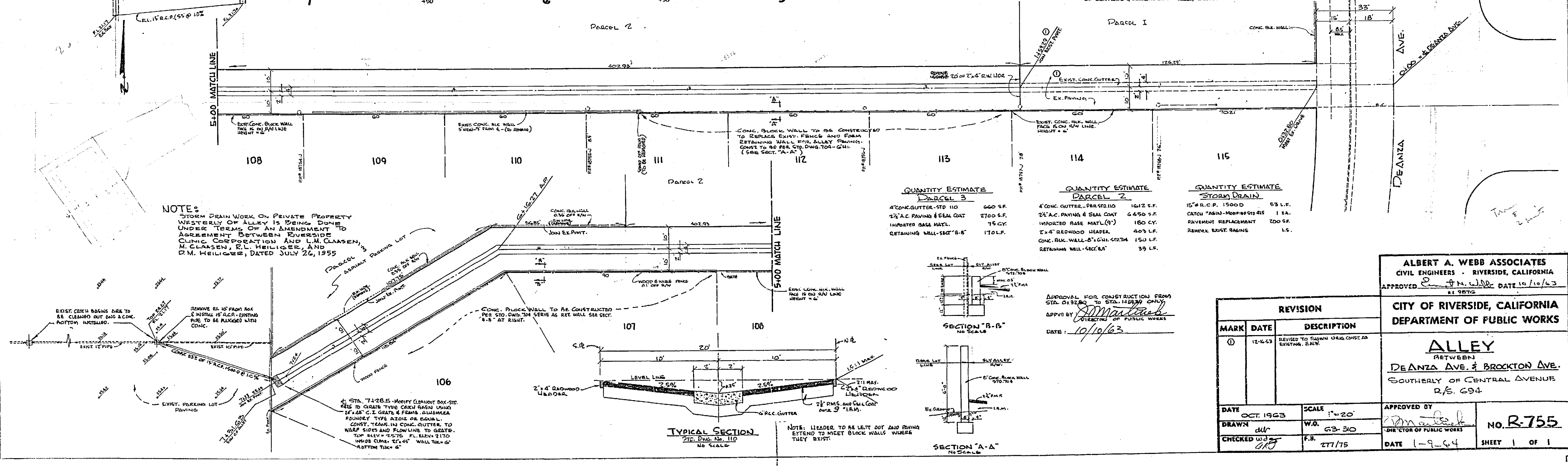

**NOTE:**

STORM DRAIN WORK ON PRIVATE PROPERTY WESTERLY OF ALLEY IS BEING DONE UNDER TERMS OF AN AMENDMENT TO AGREEMENT BETWEEN RIVERSIDE CITY CORPORATION AND L.M. CLAESSENS, M. CLAESSENS, R.L. HEILIGER, AND D.M. HEILIGER, DATED JULY 26, 1955.

**QUANTITY ESTIMATE**

**PARCEL 3**

- 4" CONC. GUTTER - STD 110 660 SF.
- 2 1/2" A.C. PAVING & SEAL COAT 2700 SF.
- IMPORTED BASE MATL. 75 CY.
- RETAINING WALL - 8" x 8" 170 LF.

**QUANTITY ESTIMATE**

**PARCEL 2**

- 4" CONC. GUTTER - PER STD 110 1612 SF.
- 2 1/2" A.C. PAVING & SEAL COAT 6450 SF.
- IMPORTED BASE MATL. (9") 180 CY.
- 2" x 4" REDWOOD HEADS 405 LF.
- CONC. BULK WALL 15" x 12" x 10' 150 LF.
- RETAINING WALL - 4" x 8" 39 LF.

**QUANTITY ESTIMATE**

**STORM DRAIN**

- 15" R.C.P. 1500 D 53 LF.
- CATCH BASIN - MODIFIED 1 EA.
- PAVEMENT REPLACEMENT 200 SF.
- REMOVE EXIST. BASINS 15.

**ALBERT A. WEBB ASSOCIATES**  
 CIVIL ENGINEERS - RIVERSIDE, CALIFORNIA  
 APPROVED: *[Signature]* DATE: 10/10/63  
 BY: RWC

**CITY OF RIVERSIDE, CALIFORNIA**  
 DEPARTMENT OF PUBLIC WORKS  
**ALLEY**  
 BETWEEN  
 DEANZA AVE. & BROCKTON AVE.  
 SOUTHERLY OF CENTRAL AVENUE  
 R/S. 694

REVISION		
MARK	DATE	DESCRIPTION
1	12-16-63	REVISED TO SHOW GROUND CONDS. AS EXISTING, E.M.V.

APPROVED BY: *[Signature]*  
 DATE: 1-9-64  
 SHEET 1 OF 1

**PLAN**

DATE	
NO.	
REVISION	
DATE	
BY	
CHECKED	
DATE	