

PLAN
DATE 12/26/60
DRAWN 481

NO.	CURB RETURN DATA	A	T
1	85'-0"	2.5	22.02
2	50'	2.5	25.00
3	80'	2.5	25.00
4	85'-27'-11"	2.5	22.09
5	84'-32'-48"	2.5	27.07

QUANTITY ESTIMATE

CURB AND GUTTER-TYPE STD. NO. 10	1300 LF
CROSS GUTTER AND APRON-STD. NO. 14	987 SF
2 1/2" PLANT MIX SURFACING-BY COUNTY	1090 SF
2 1/2" PLANT MIX SURFACING-BY SUBDIVIDER	30,570 SF
IMPORTED BASE MATERIAL	907 CY
EXCAVATION	377.6 CY
SIDWALK-STD. NO. 3	10,050 SF
REFLECTOR-W-1-4	1 EA
BARRICADE-STD. NO. 27	1 EA
2"x4" REDWOOD HEADER	150 LF

FIRST REVISION APPROVED October 3, 1961
A.C. KEITH
RIVERSIDE COUNTY ROAD COMMISSIONER
BY *Paul H. Stout* DEPUTY

BENCH MARK
B.R. Spike in P.P. 523504-H N.W. Corner
Ridge & Norwood Ave. ELEV. 75.525
R.P. 2314

APPROVED June 23, 1961
A.C. KEITH
RIVERSIDE COUNTY ROAD COMMISSIONER
BY *Paul H. Stout* DEPUTY

REVISIONS	DATE	BY

MYERSCOUGH SUBDIVISION UNIT NO. 2

STREET PLANS & PROFILES

LA VERNE DRIVE

SCALE 1"=50'
DATE 12/26/60
DRAWN 481
TRACED
CHECKED
F.B. 481-1

ALBERT A. WEBB ASSOCIATES
CIVIL ENGINEERS
200 N. W. 9th St.
RIVERSIDE, CALIFORNIA 92506

W.D. 60-260
SHEET 1
OF 2 SHEETS
DWG. NO. 60-260-1

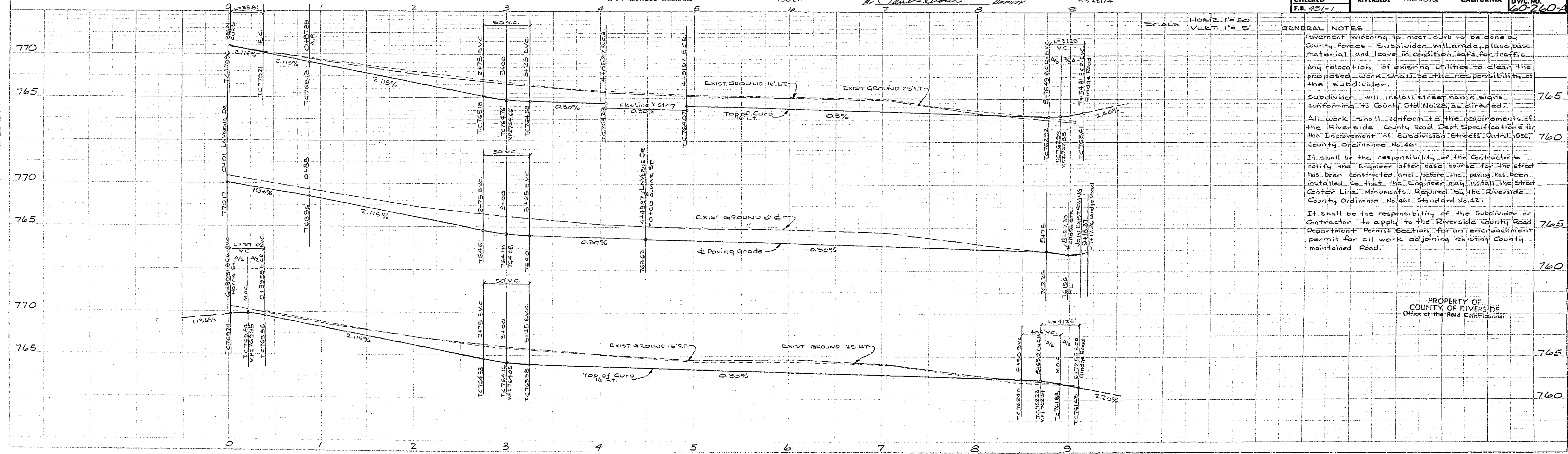

GENERAL NOTES

Pavement widening to meet curb to be done by County forces - Subdivider will grade, place base material and leave in condition safe for traffic.

Any relocation of existing utilities to clear the proposed work shall be the responsibility of the subdivider.

Subdivider will install street name signs conforming to County Std. No. 28, as directed.

All work shall conform to the requirements of the Riverside County Road Dept. Specifications for the Improvement of Subdivision Streets, Dated 10/56, County Ordinance No. 461.

It shall be the responsibility of the Contractor to notify the Engineer after base course for the street has been constructed and before the paving has been installed, so that the Engineer may install the Street Center Line Monuments Required by the Riverside County Ordinance No. 461 Standard No. 42.

It shall be the responsibility of the Subdivider or Contractor to apply to the Riverside County Road Department Permit Section, for an encroachment permit for all work adjoining existing County maintained Road.

PROPERTY OF
COUNTY OF RIVERSIDE
Office of the Road Commissioner

R-812 ~~7750~~

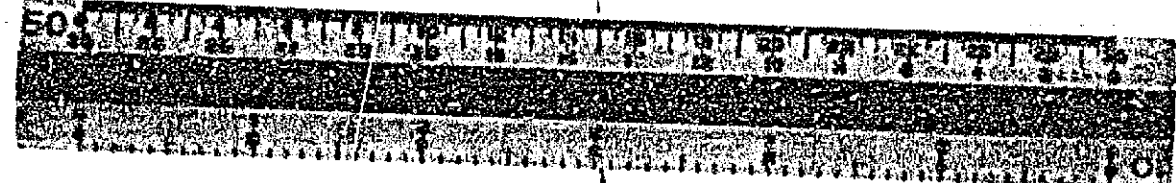

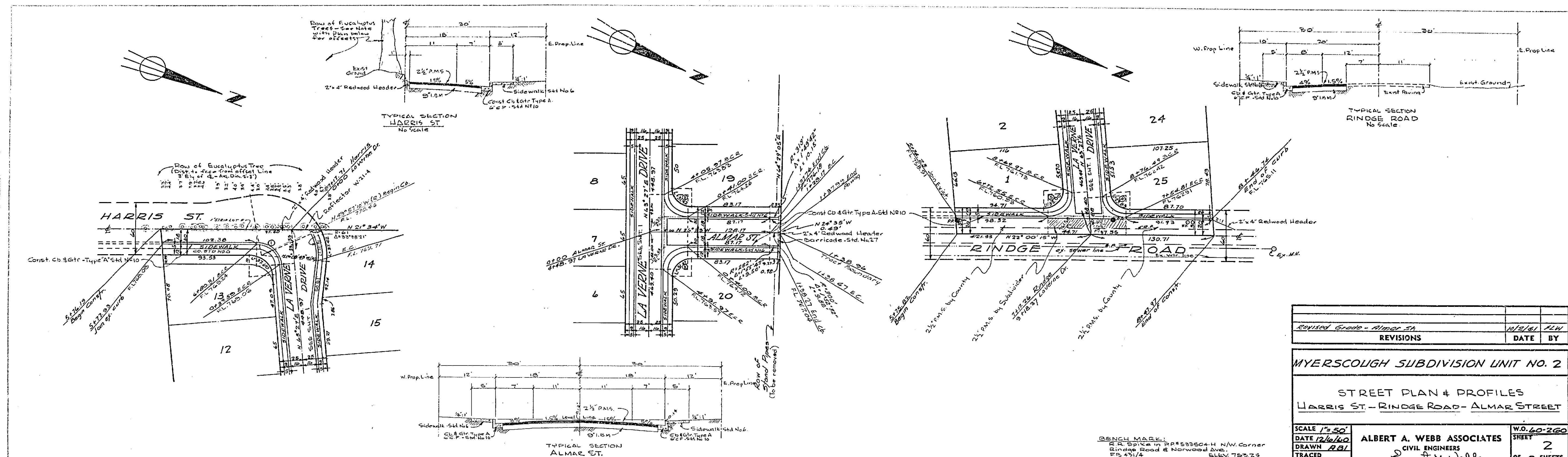

REVISIONS		DATE	BY
Revised Grade - Almar St		11/5/67	ALW

MYERSCLOUGH SUBDIVISION UNIT NO. 2

STREET PLAN & PROFILES
HARRIS ST - RINDGE ROAD - ALMAR STREET

SCALE 1"=50'	ALBERT A. WEBB ASSOCIATES CIVIL ENGINEERS 2505 N. W. 30th RIVERSIDE, CALIFORNIA 92506	W.O. 60-260
DATE 12/6/60		SHEET 2
DRAWN AB		OF 2 SHEETS
CHECKED		DWG. NO. 60-260-2

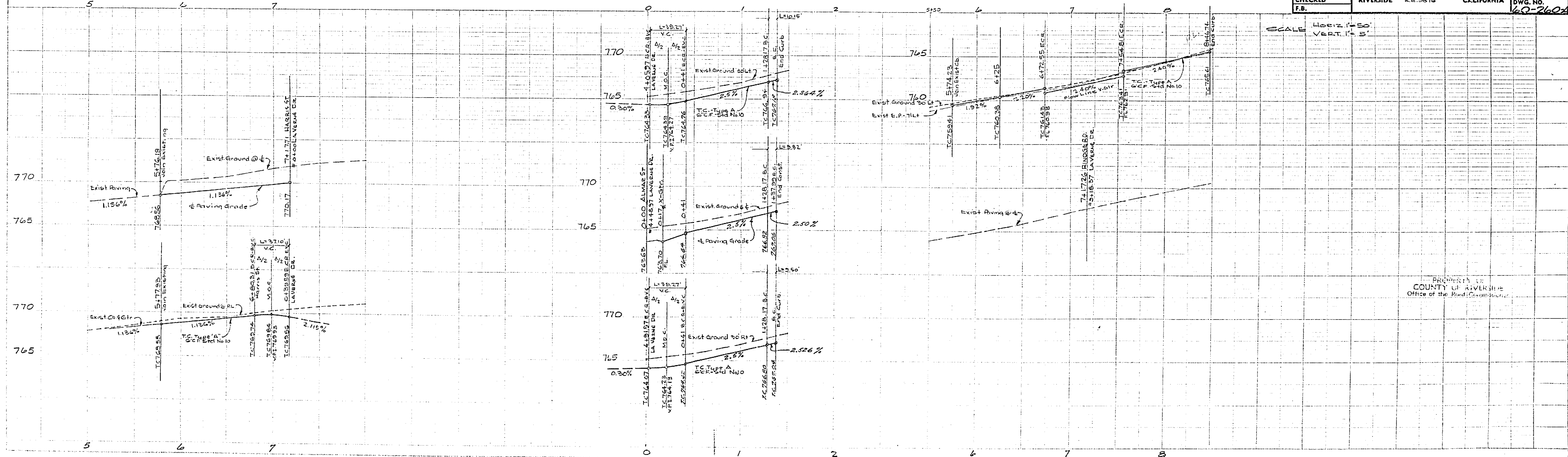

R-812. 7450