

BENCH MARK: Elev. 777.81
 R.R. spike in PP #123771 @ E. side Intersection Hillside & Clifton

QUANTITY ESTIMATE

Curb and Gutter Standard No. 200 (6"CR)	150 L.F.
Curb SW Driveway Approach Standard No. 302	306 S.F.
2 1/2" A.C. seal coat	5,775 S.F.
Barricade Standard No. 180	1 Ea.
Imported Base Material	C.Y.
2"x4" Redwood Header	36 L.F.
Excavation (cut)	570 C.Y.

- GENERAL NOTES:**
- It shall be the responsibility of the contractor to clear the right of way in accordance with the provisions of law as it affects each utility including irrigation lines and appurtenances and at no cost to the City.
 - Construction shall be in accordance with the City of Riverside, Department of Public Works, Specifications No. 461 and Standard Drawings.
 - Prime coat, seal coat, and paint binder are required.
 - Grading will require a permit under Ordinance 3093 for a cut or fill exceeding 100 cubic yards, or a fill over one foot in depth.
 - Trim edge of existing pavement, where new paving joins existing pavement, to a clean, straight line. Construct match-up paving as shown and overlay paving as directed in the field to produce a smooth crown section.
 - The City of Riverside will take a soil test to determine the requirement on imported base material after the streets have been prepared to rough grade. Contractor is to notify City of Riverside when rough grading is accomplished.

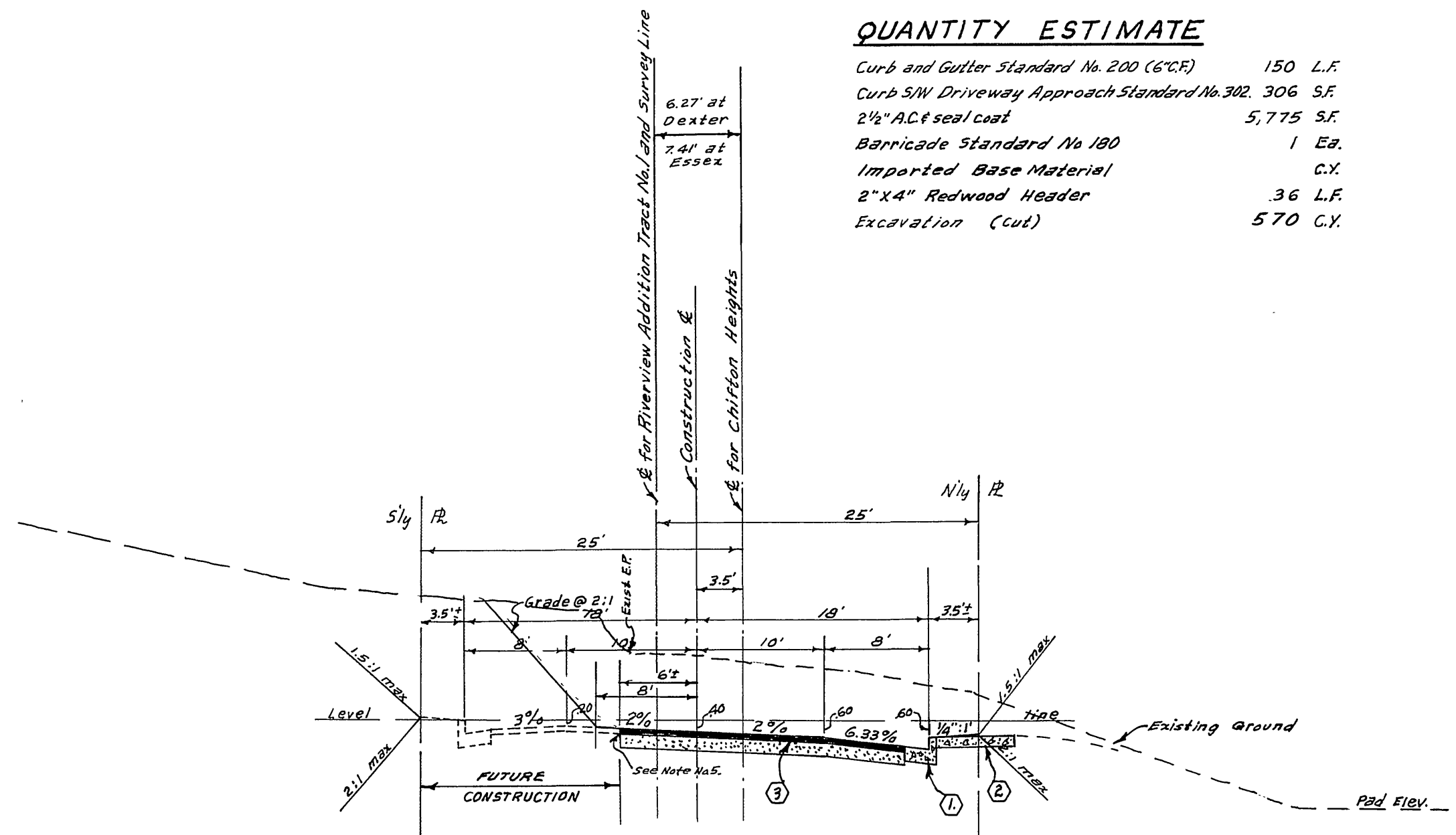

TYPICAL SECTION
MOUNTAIN VIEW AVE.
 Sta. 1+50
 Scale 1"=10' Horiz., 1"=5' Vert.

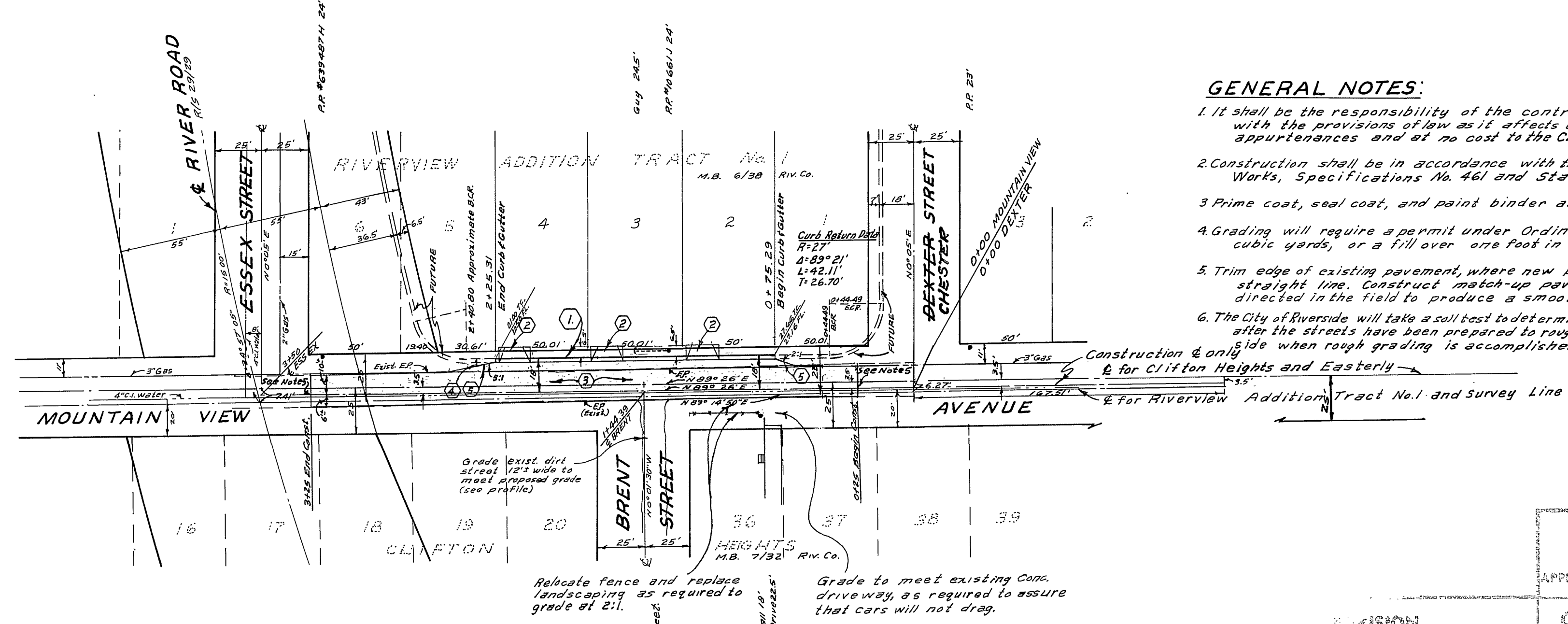

- CONSTRUCTION NOTES:**
- Const. Curb & Gutter Standard No. 200 (6"CR)
 - Const. Curb SW Driveway Approach Standard No. 302 (Back of DW to be level with T.C.)
 - Const. 2 1/2" A.C. seal coat over "I.B.M.
 - Const. Barricade Standard No. 180
 - Const. 2"x4" Redwood Header

NOTICE TO CONTRACTOR
 The existence and location of any underground utility pipes or structures shown on these plans are obtained by search of the available records. To the best of our knowledge, there are no existing utilities except as shown on these plans. The contractor is required to take due precautionary measures to protect the utility lines shown and any other lines not of record or not shown on these plans.

INDEXED		APPROVED BY <i>[Signature]</i> DATE 3/4/64	
CITY OF RIVERSIDE, CALIFORNIA DEPARTMENT OF PUBLIC WORKS		NO R-841	
STREET PLAN & PROFILE MOUNTAIN VIEW AVE. CHESTER BETWEEN DEXTER ST. & ESSEX ST.			
Feb. 1964	SCALE 1"=50'	APPROVED BY <i>[Signature]</i>	NO R-841
B.E.L.	W.A. 63-287	DATE 4-30-64	SHEET 1 OF 1
W.B. & [Signature]	E.D. 487		