

PROFILE  
SCALE Vert. 1"=2'  
HORIZ. 1"=20'

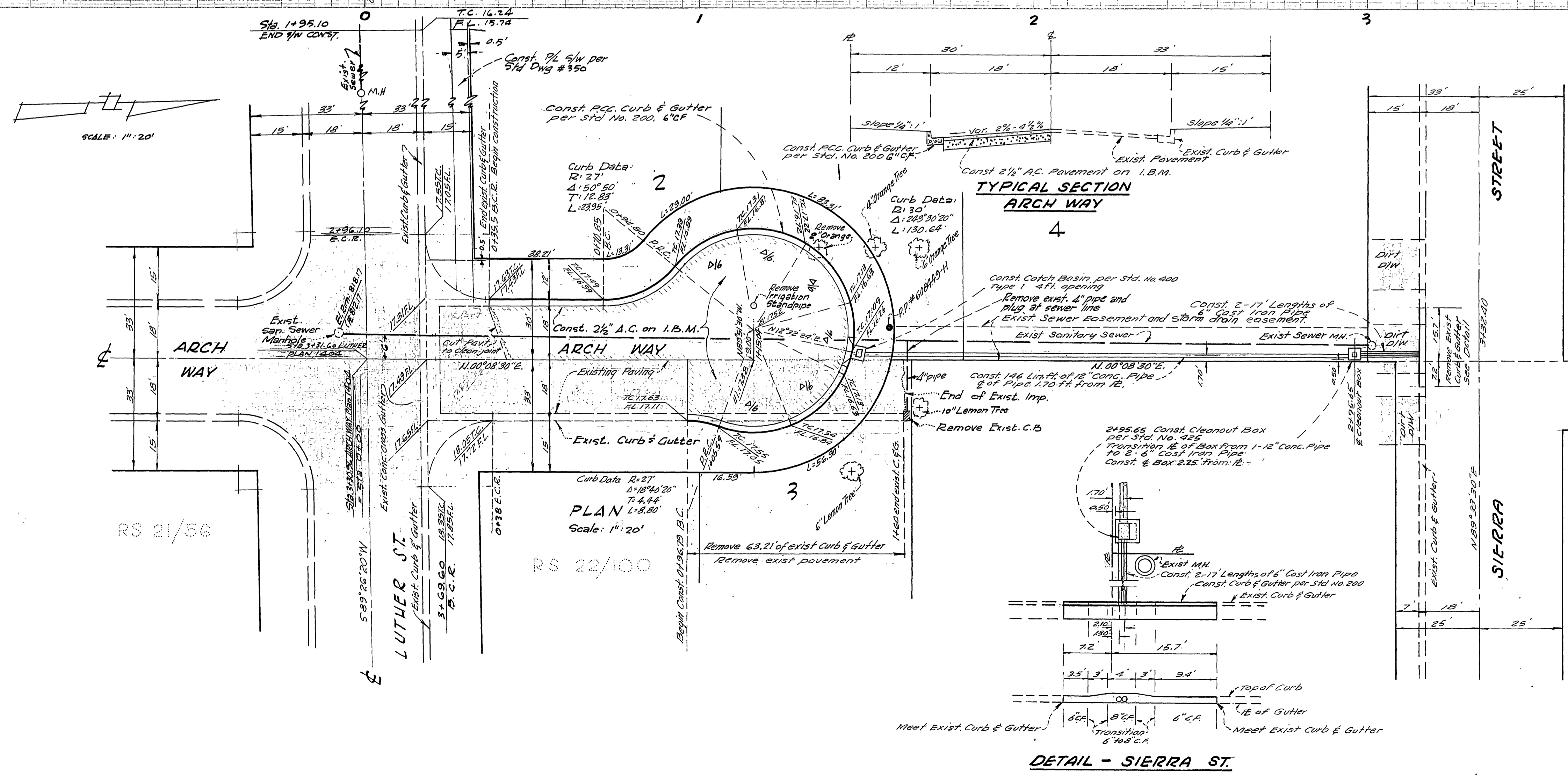

GENERAL NOTES

1. It shall be the responsibility of the Contractor to clear the right of way in accordance with the provisions of law as it affects each utility including irrigation lines and appurtenances and at no cost to the City.
2. Construction shall be in accordance with the City of Riverside, Department of Public Works Specifications No. 401 and Std. Drawings.
3. Prime coat, Seal Coat, and Paint Binder are required.
4. The City of Riverside will take a soil test to determine the requirement for imported base material after the streets have been prepared to rough grade.
5. Street names signs and posts to be furnished and installed by the subdivider per City Specifications and Standard Drawing No. 622.
6. Grading will require a permit under Ordinance 3093 for a cut or fill exceeding 100 cubic yards, or a fill over one foot in depth.

CITY BENCH MARK: st L in S.E. Curb Return at Damon & Sierra Way.  
Elev. 810.91  
T.B.M.#1: L&T in S.E. curb return at Luther & Arch Way.  
Elev. 818.83

INDEXED E.G.  
**CRAWLEY & HAWKINS**  
SURVEYORS AND ENGINEERS  
RIVERSIDE, CALIFORNIA  
Approved: *George O. Crawley* Field Bk. 50/61-63  
R.C.E. NO. 9445 Date 3-26-64

REVISIONS		DESCRIPTION
MARK	DATE	

CITY OF RIVERSIDE, CALIFORNIA  
DEPARTMENT OF PUBLIC WORKS

**STREET PLAN & PROFILE**  
**R.S. 797**  
**ARCH WAY**  
Between Luther St. & Sierra St.

DESIGNED BY	CHECKED BY G.S. <i>Attwood</i>	APPROVED BY <i>George O. Crawley</i>	<b>R-843</b>
DRAWN BY		DIRECTOR OF PUBLIC WORKS	
RECOMMENDED BY <i>G.R. Theobald</i>	ASSISTANT CITY ENGINEER	DATE 5-26-64	

SHEET 1 OF 1