

740 LT.

740 E.

740 RT.

740 LT.

740 E.

740 RT.

# MALLARD ROAD

Bench Mark:  
 Chis X  
 Top of curb West Side  
 Palos Dr. N.E. Cor. Lot 77  
 Greenacres Downs #3  
 Elev. 738.46

### Notice To Contractor

The existence and location of any underground utility pipes or structures shown on these plans are obtained by a search of the available records to the best of our knowledge there are no existing utilities except as shown on these plans. The Contractor is required to take due precautionary measures to protect the utility lines shown and any other lines not of record or not shown on these plans.

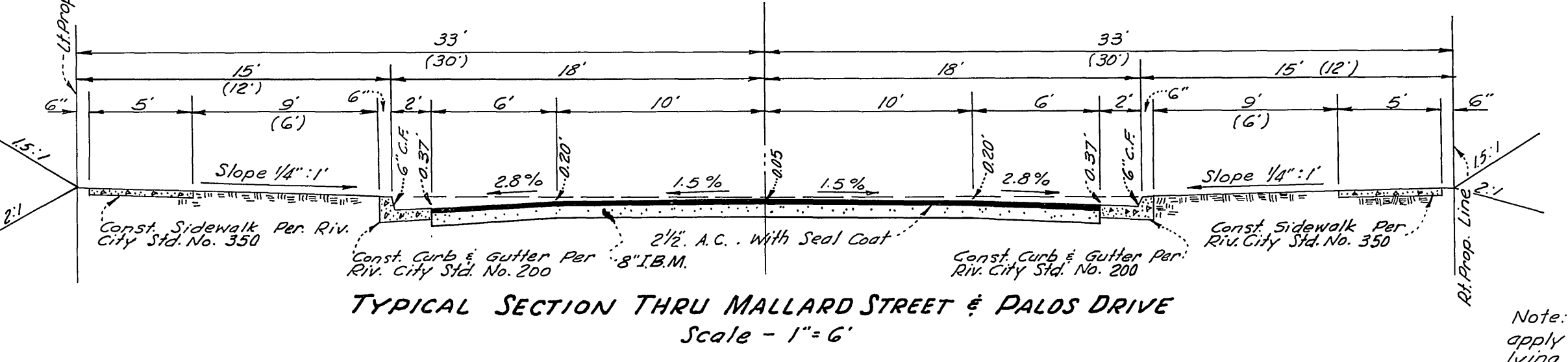

SCALE: HORIZ. - 1" = 40'  
 VERT. - 1" = 4'

Note: Those distances shown in parenthesis apply only to that portion of Palos Drive lying South of Mallard Street.

### General Notes

- If shall be the responsibility of the contractor to clear the right of way in accordance with the provisions of the law as it affects each utility including irrigation lines and appurtenances and at no cost to the city.
- Construction shall be in accordance with the City of Riverside, Dept. of Public Works Specifications No. 461 and Standard Drawings.
- Prime Coat, Seal Coat, and Paint Binder are required.
- Grading will require a permit under Ordinance 3193 for a cut or fill exceeding 100 Cu. Yds. or a fill over one foot in depth.
- Trim edge of existing pavement, where new pavement joins existing pavement, to clean, straight line. Construct match up paving as shown and overlay paving as directed in the field to produce a smooth crown section.
- Street name signs and posts to be furnished and installed by the Developer as per City Std. Dwg. #662.
- Bench Mark - Cross in West Curb of Mallard Rd. at Sta 1+22.94, Elev. 738.32.

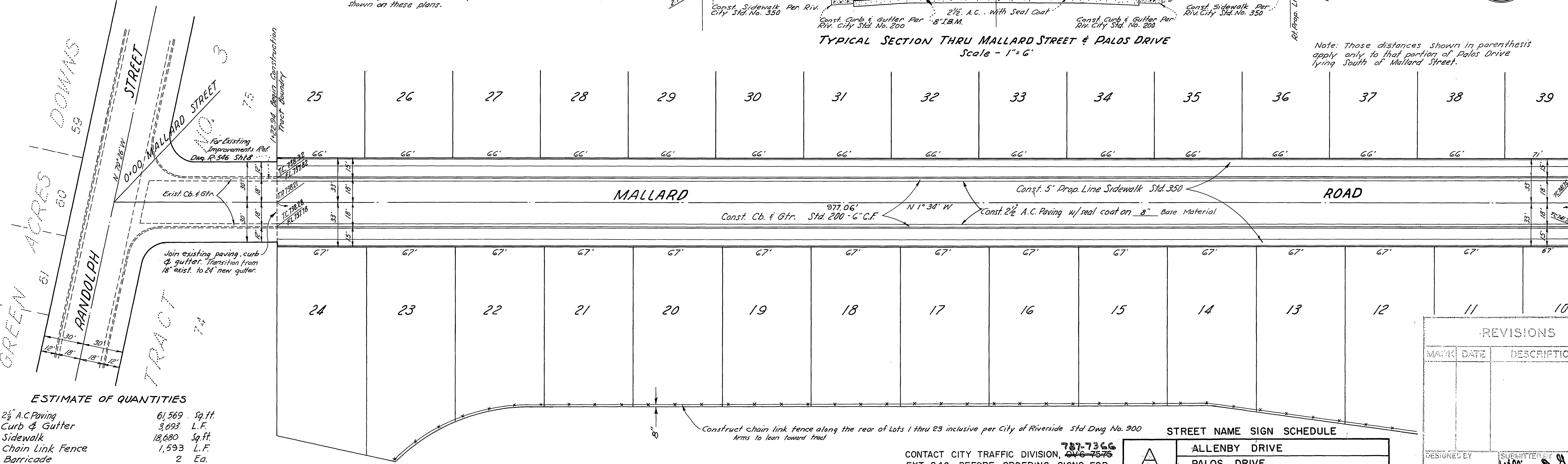

**ESTIMATE OF QUANTITIES**

2 1/2" A.C. Paving	61,569 Sq. Ft.
Curb & Gutter	3,093 L.F.
Sidewalk	18,680 Sq. Ft.
Chain Link Fence	1,593 L.F.
Barricade	2 Ea.

**STREET NAME SIGN SCHEDULE**

A	ALLENBY DRIVE
	PALOS DRIVE
B	MALLARD ROAD
	ALLENBY DRIVE

CONTACT CITY TRAFFIC DIVISION, EXT-246, BEFORE ORDERING SIGNS FOR STREET BLOCK NUMBERS.

**REVISIONS**

MARK	DATE	DESCRIPTION

APPROVED *Charles E. King* DATE 3/18/64  
 RE 13366

**MAXWELL & KING**  
 PO BOX 1421 PH: TU 5-6541  
 SAN BERNARDINO, CALIFORNIA

CITY OF RIVERSIDE, CALIFORNIA  
 DEPARTMENT OF PUBLIC WORKS  
 JOB NO. 63-11-19 FILE NO. E-636  
**STREET PLAN & PROFILE**  
**MALLARD ROAD**  
**TRACT NO. 2852**

DESIGNED BY *William D. Jordan* SUBMITTED BY *William D. Jordan* APPROVED BY *Charles E. King* PROJ. NO. **R-860**  
 DRAWN BY *John* P.L. DEPT. *John* TRAFFIC DIV. *John*  
 CHECKED BY *John* DATE 2-9-65 SHEET 1 OF 2

INDEXED *John*



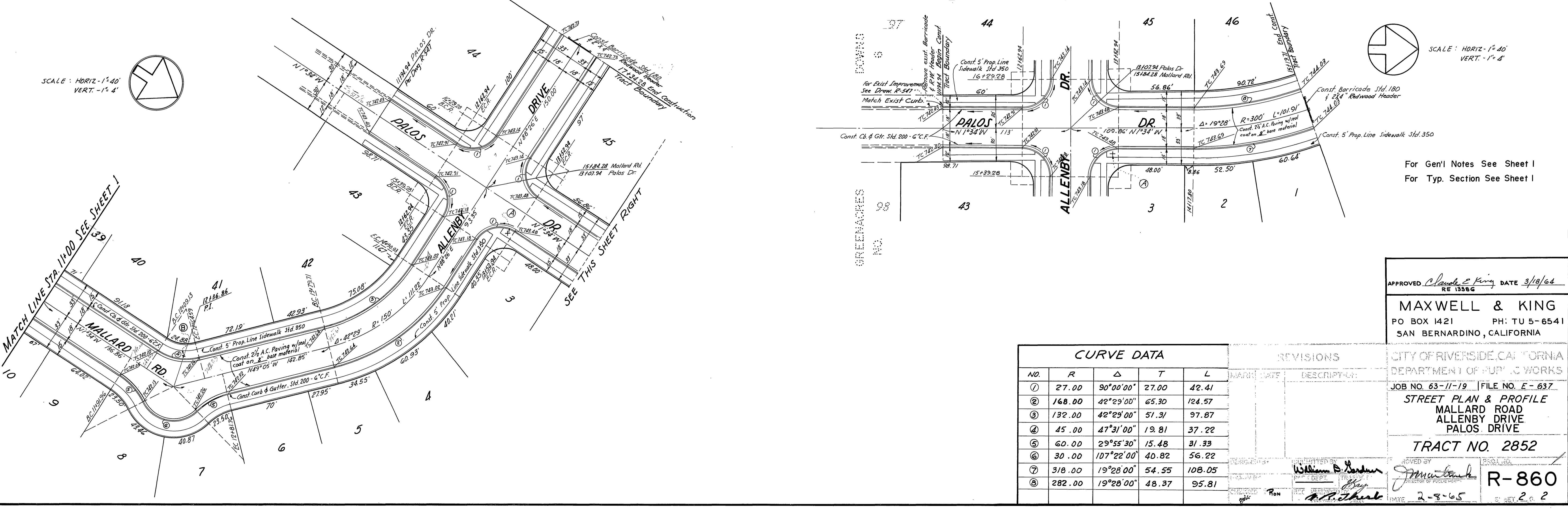
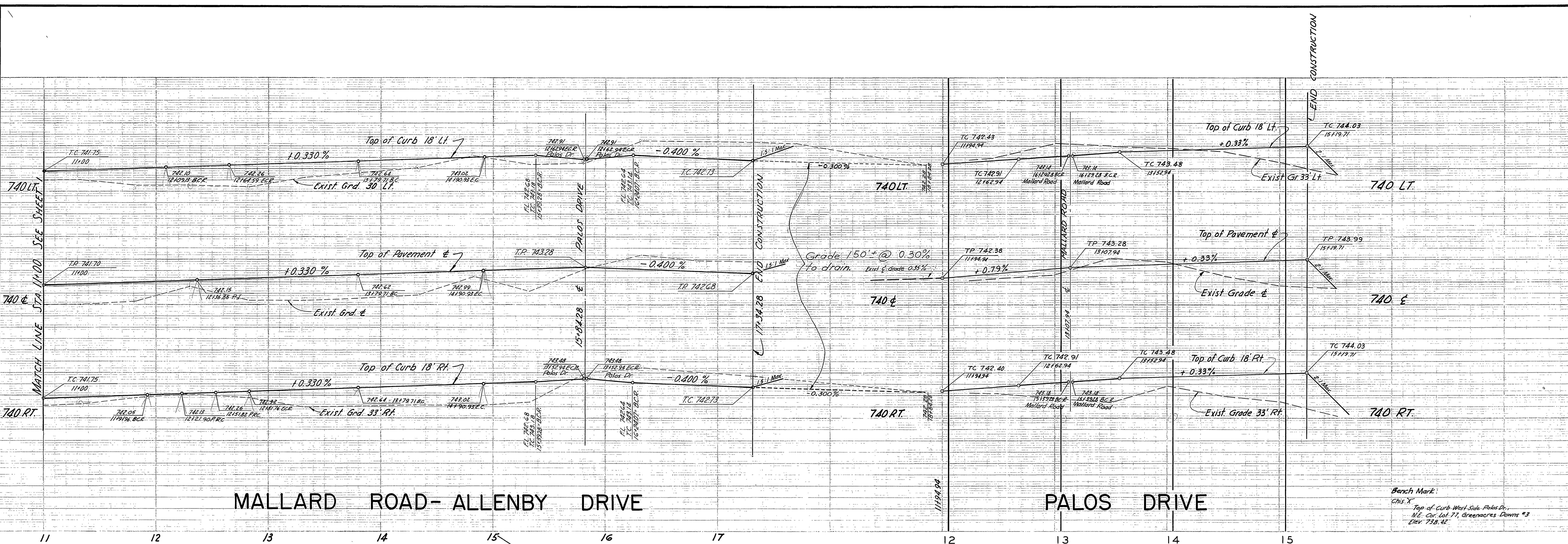

CURVE DATA				
NO.	R	Δ	T	L
①	27.00	90°00'00"	27.00	42.41
②	168.00	42°29'00"	65.30	124.57
③	132.00	42°29'00"	51.31	97.87
④	45.00	47°31'00"	19.81	37.22
⑤	60.00	29°55'30"	15.48	31.33
⑥	30.00	107°22'00"	40.82	56.22
⑦	318.00	19°28'00"	54.55	108.05
⑧	282.00	19°28'00"	48.37	95.81

REVISIONS	
NO.	DESCRIPTION

APPROVED *Charles E. King* DATE 3/18/64  
 RE 13566

**MAXWELL & KING**  
 PO BOX 1421 PH: TU 5-6541  
 SAN BERNARDINO, CALIFORNIA

CITY OF RIVERSIDE, CALIFORNIA  
 DEPARTMENT OF PUBLIC WORKS  
 JOB NO. 63-11-19 FILE NO. E-637

**STREET PLAN & PROFILE**  
 MALLARD ROAD  
 ALLENBY DRIVE  
 PALOS DRIVE

TRACT NO. 2852

DESIGNED BY *William D. Gordon*  
 CHECKED BY *Ray*  
 DATE 2-8-65

PROJECT NO. **R-860**  
 SHEET 2 OF 2