

- GENERAL NOTES**
- IT SHALL BE THE RESPONSIBILITY OF THE CONTRACTOR TO CLEAR THE RIGHT OF WAY IN ACCORDANCE WITH THE PROVISIONS OF LAW AS IT AFFECTS EARTH UTILITY INCLUDING IRRIGATION LINES & APPURTENANCES AT NO COST TO THE CITY.
  - CONSTRUCTION SHALL BE IN ACCORDANCE WITH THE CITY OF RIVERSIDE DEPT. OF PUBLIC WORKS, SPECIFICATIONS NO. 461 & STANDARD DRAWS.
  - PRIME COAT, SEAL COAT, & PAINT BINDER ARE REQUIRED.
  - GRADING WILL REQUIRE A PERMIT UNDER ORDINANCE 3093 FOR A CUT OR FILL EXCEEDING 100 CUBIC YARDS OR A FILL OVER ONE FOOT IN DEPTH.
  - TRIM EDGES OF EXISTING PAVEMENT, WHERE NEW PAVING JAMES EXIST. PAVEMENT, TO A CLEAN, STRAIGHT LINE. CONSTRUCT MATCH UP PAVING AS SHOWN AND OVERLAY PAVING AS DIRECTED IN THE FIELD TO PRODUCE A SMOOTH CROWN SECTION.
  - IF REQUESTED BY CONTRACTOR SLOPE OF APPROACH MAY BE AS STEEP AS 1/4 PER FOOT.

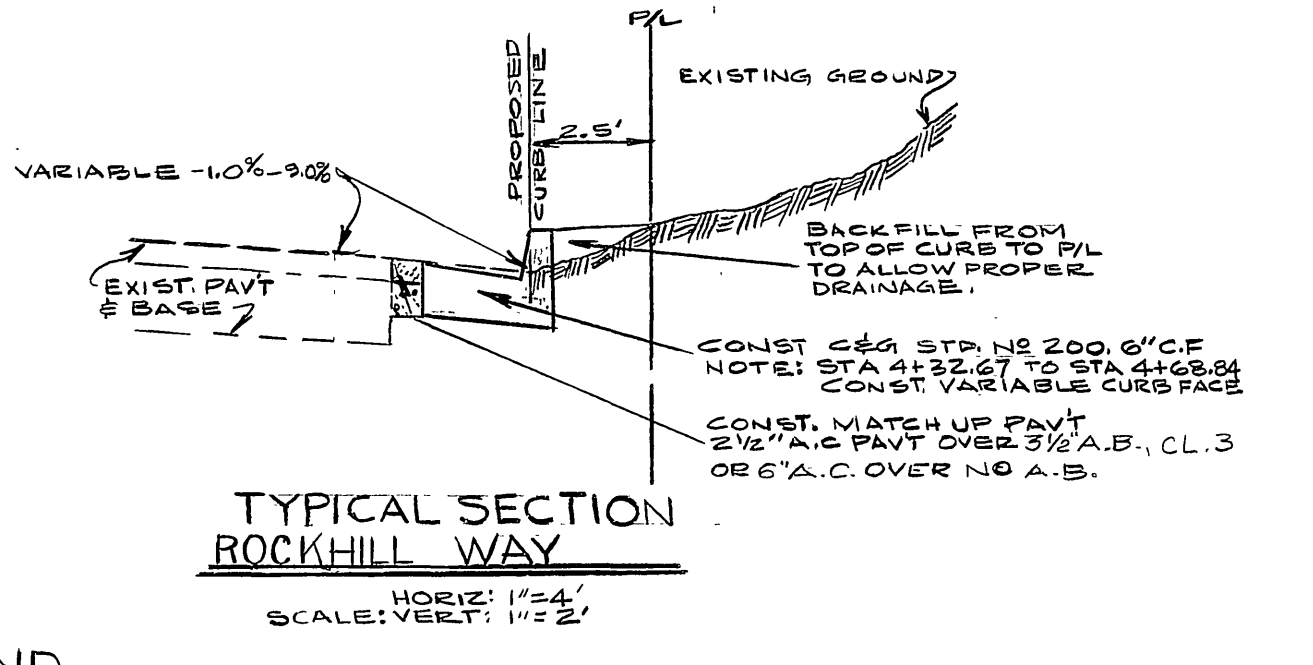
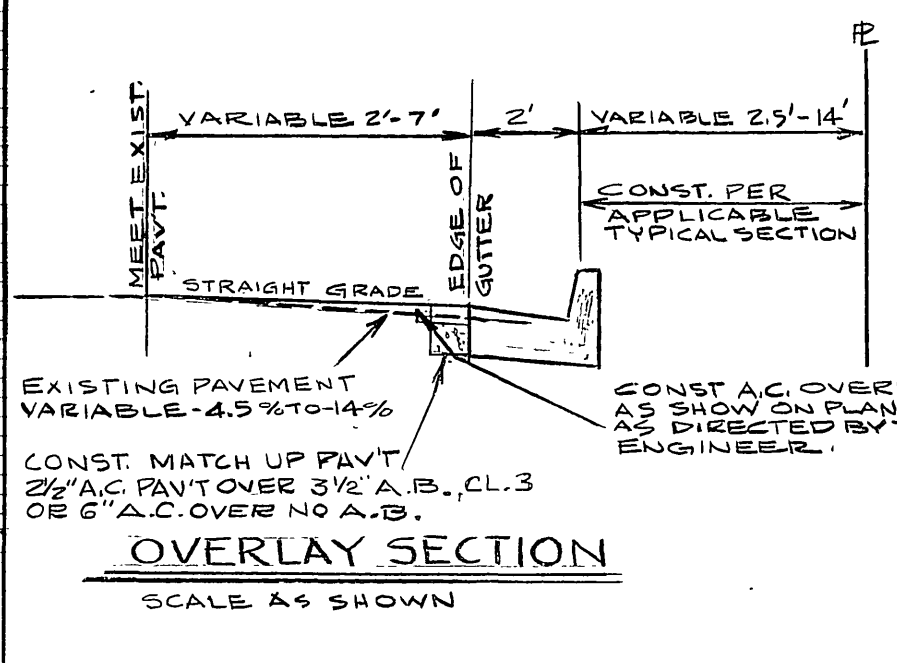
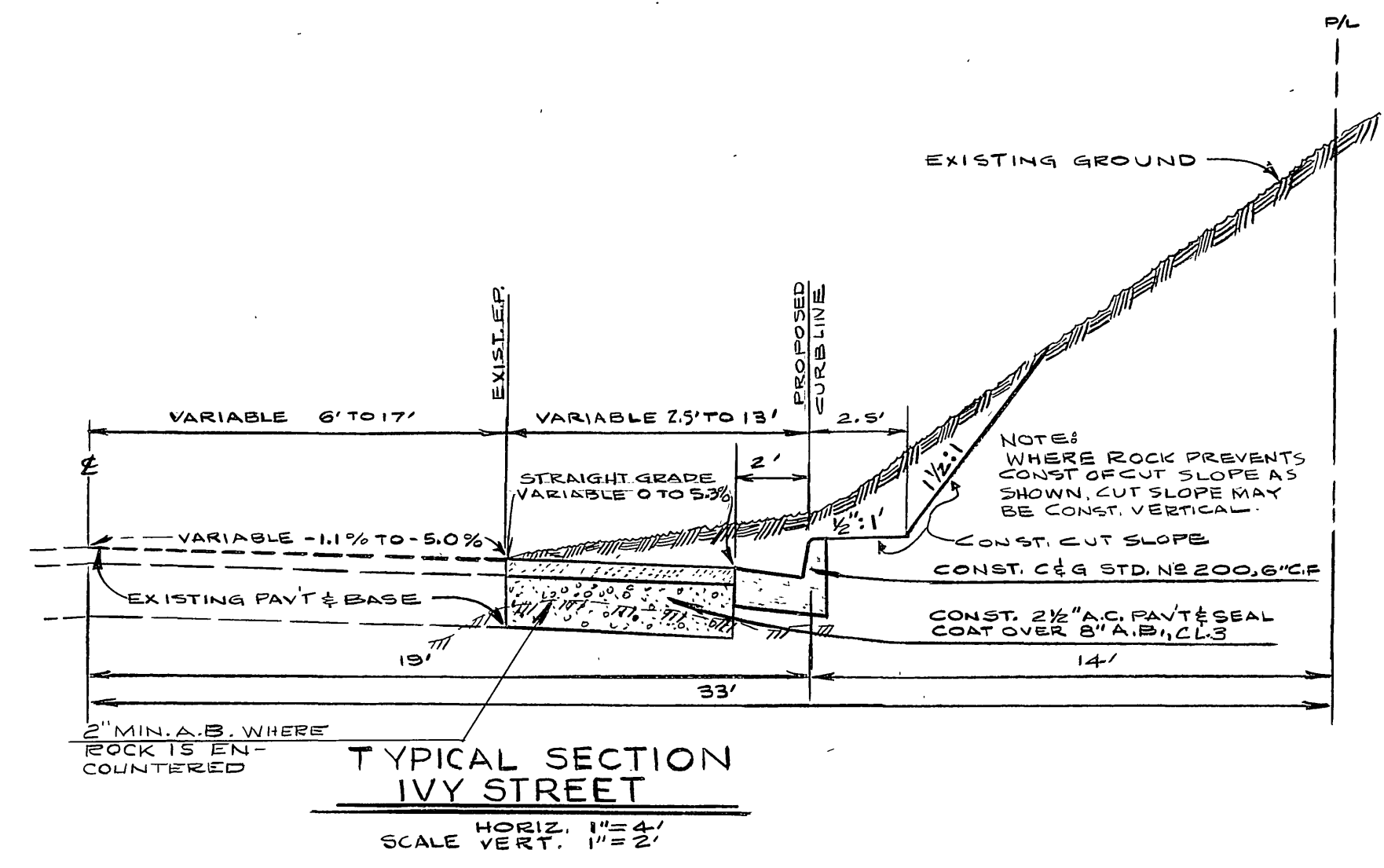

**SHADING LEGEND**

INDICATES CONCRETE CONSTRUCTION.

INDICATES 2 1/2" ASPHALT CONCRETE OVER 8" A.B. OR VARIABLE THICKNESS OVERLAY. (AG&G BASE CLASS 3)

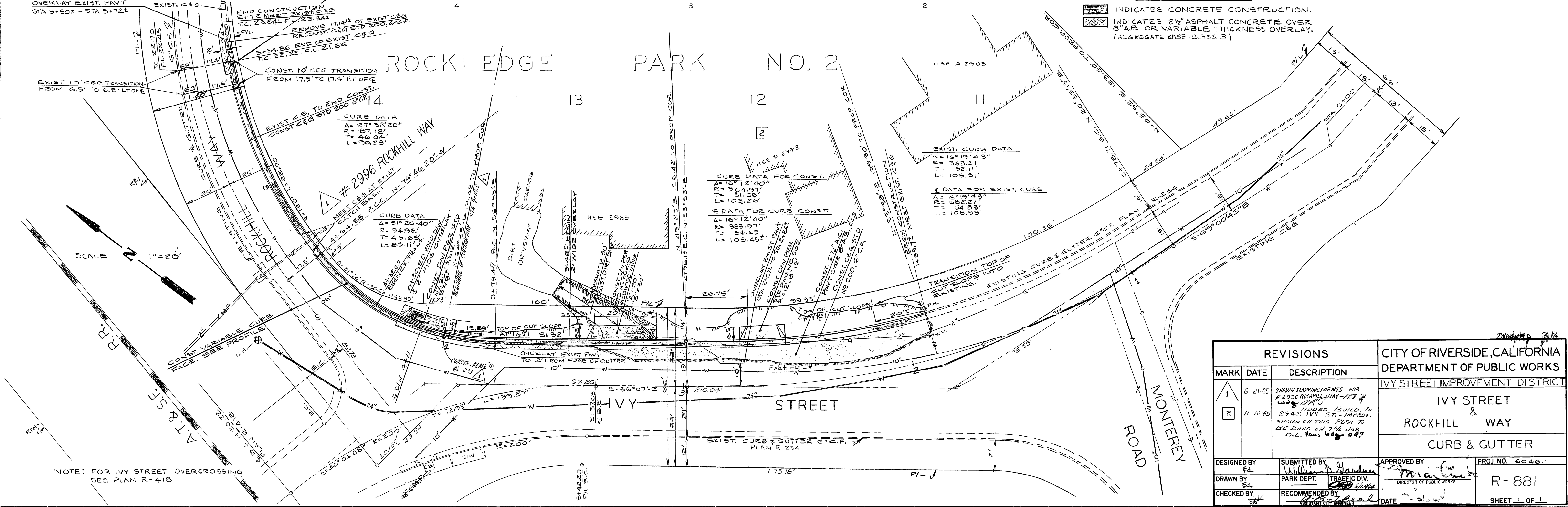

REVISIONS			CITY OF RIVERSIDE, CALIFORNIA DEPARTMENT OF PUBLIC WORKS	
MARK	DATE	DESCRIPTION	IVY STREET & ROCKHILL WAY CURB & GUTTER	
1	6-21-65	SHOWN IMPROVEMENTS FOR #2996 ROCKHILL WAY - ACT 1	CITY OF RIVERSIDE, CALIFORNIA DEPARTMENT OF PUBLIC WORKS IVY STREET & ROCKHILL WAY CURB & GUTTER R-881 SHEET 1 OF 1	
2	11-10-65	ADDED BUILD. TO 2943 IVY ST. IMPROV. SHOWN ON THIS PLAN TO BE DONE ON 7/16/66 D.L. HANS W-8-687		
DESIGNED BY	EL	SUBMITTED BY	APPROVED BY	PROJ. NO. 60461
DRAWN BY	EL	PARK DEPT. TRAFFIC DIV.	DIRECTOR OF PUBLIC WORKS	R-881
CHECKED BY	EL	RECOMMENDED BY	DATE	

**PROFILE**

DATE: \_\_\_\_\_

**PLAN**

DATE: \_\_\_\_\_

NOTE: FOR IVY STREET OVERCROSSING SEE PLAN R-418