

**Legend**

- New Palm Tree
- For Traffic Signal relocation see Plan X-214

**Bench Mark**

3' L. in East curb Brockton  
 15' South of S. R. Jurupa  
 Elev. - 826.186  
 Ref - F.B. R-9/5-22

**General Notes**

Exit sewer lateral which are in conflict with proposed sidewalk shall be reconstructed per sheet 125-44.

Existing traffic signs and mail boxes shall be relocated as directed in the field.

For Typical Cross-Sections see sheet #3

Existing water, power and irrigation facilities within construction area will be relocated by City of Riverside Public Utilities Department

1" = 40' Palm trees shall be relocated as shown on plan and as directed in the field.

All Palm trees not relocated shall be removed and disposed as directed in the field.

All sprinklers within proposed sidewalk area shall be cut and capped at the P/L.

All sprinklers where no sidewalk is proposed shall be cut and capped behind curb line or as directed in the field.

**SCALE** 1" = 40'

REVISIONS			CITY OF RIVERSIDE, CALIFORNIA DEPARTMENT OF PUBLIC WORKS	
MARK	DATE	DESCRIPTION	SS PROJECT NO 128	
①	10-26-68	Per change order #2	JURUPA AVENUE STREET WIDENING	
			BROCKTON AVENUE TO ELENOR STREET	
DESIGNED BY	SUBMITTED BY	APPROVED BY	PROJ. NO. 3074	
DRAWN BY	PARK DEPT.	TRAFFIC DIV.	R-886	
CHECKED BY	RECOMMENDED BY	DATE		

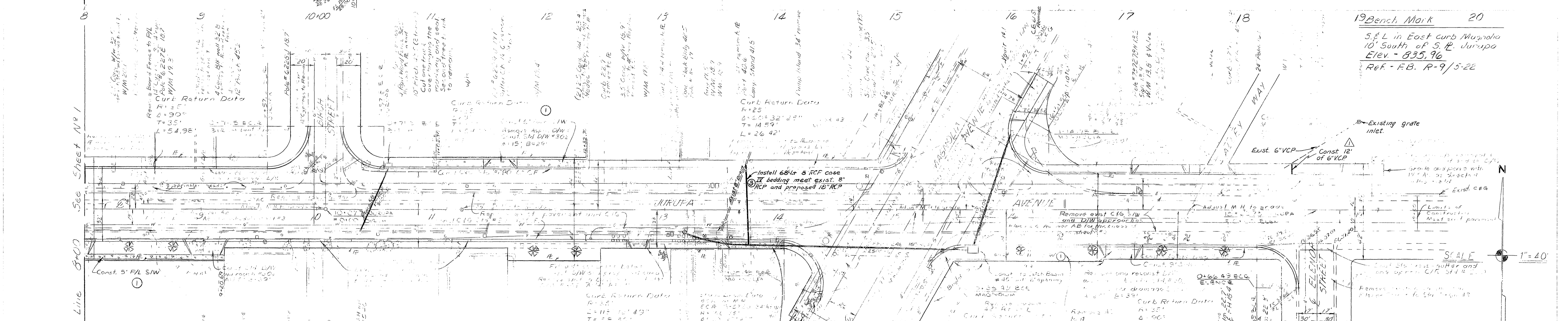

REVISIONS			CITY OF RIVERSIDE, CALIFORNIA DEPARTMENT OF PUBLIC WORKS	
①	10-26-68	Per change order #1 ART	SS PROJECT N° 128	
②	11-9-65	Per change order #3 BE, ART, BSE, ME	JURUPA AVENUE STREET WIDENING	
▲	6-1-66	As built	BROCKTON AVENUE TO ELENOR STREET	
DESIGNED BY	SUBMITTED BY	APPROVED BY	PROJ. NO. 3074	
DRAWN BY B.L.	PARK DEPT. TRAFFIC DIV.	DIRECTOR OF PUBLIC WORKS	R-880 SHEET 2 OF 3	
CHECKED BY	RECOMMENDED BY	DATE 2/3/67		

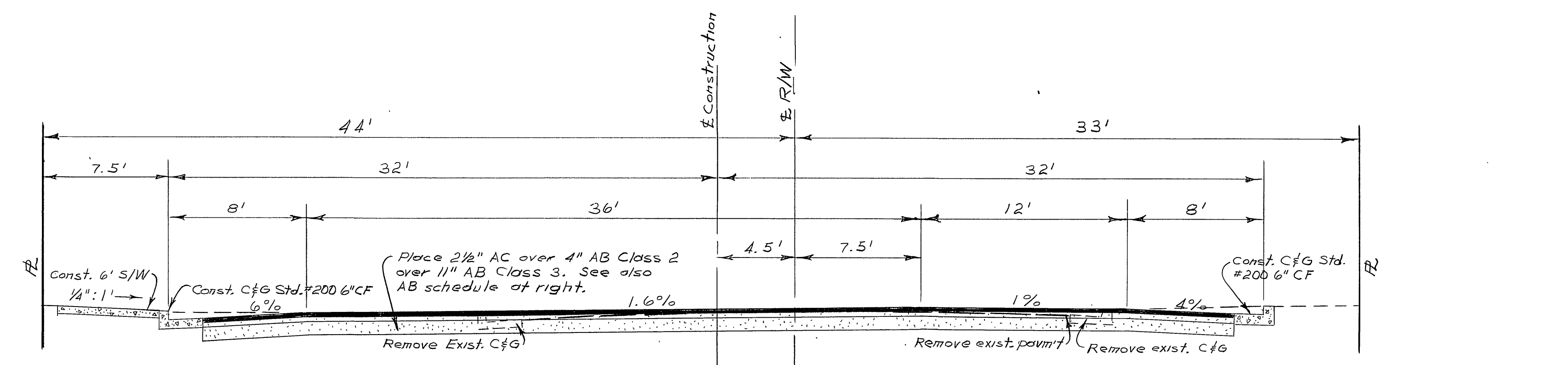

STATION 5+50 TO 8+00\*

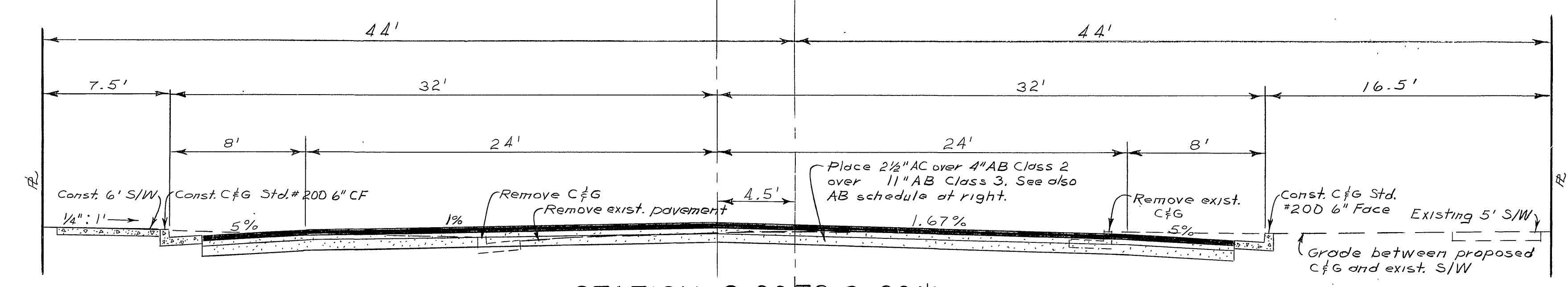

STATION 2+00 TO 3+00\*

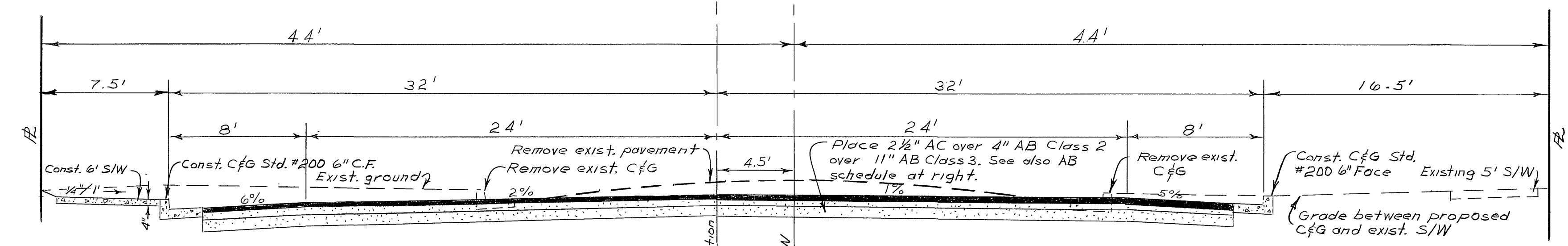

STATION 1+00\*

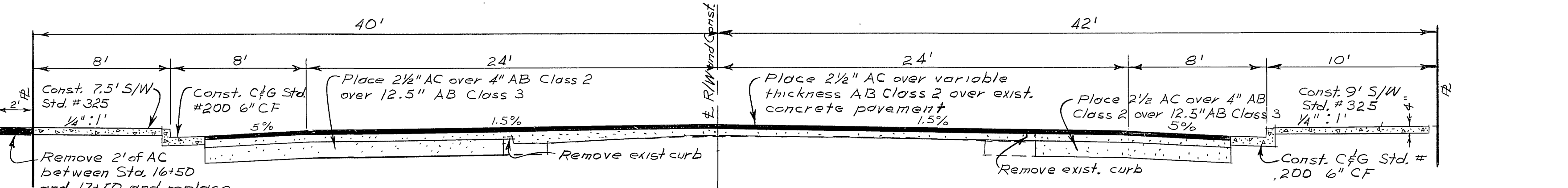

STATION 16+50 TO 19+00\*

TYPICAL CROSS-SECTION

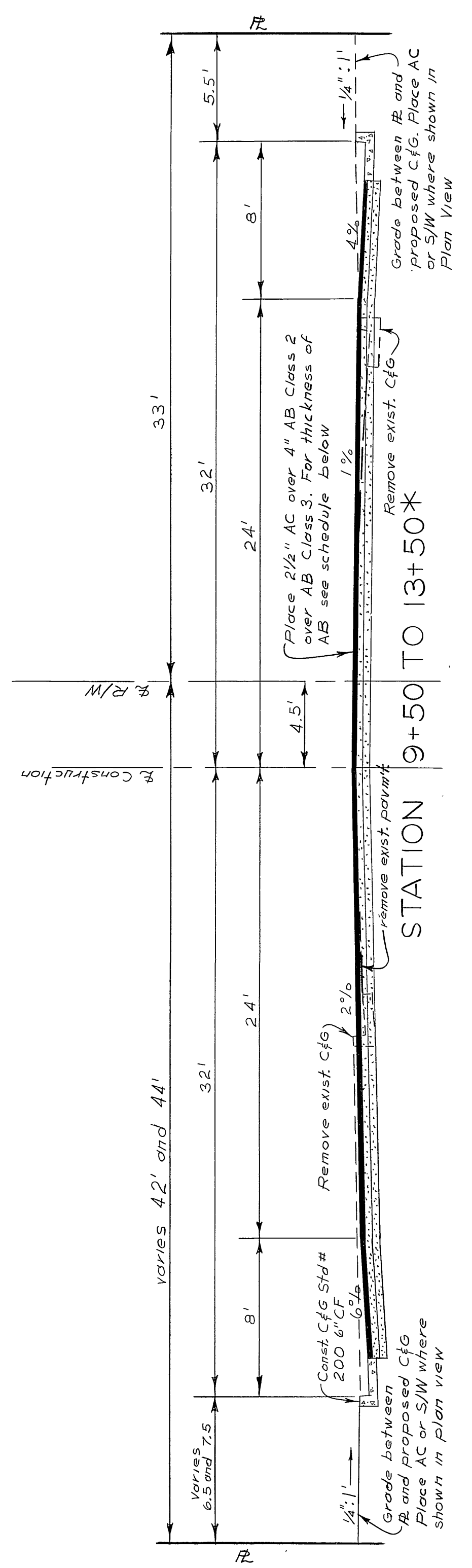

Scale: Horiz. 1"=5'  
 Vert. 1"=5'

\*Note: Structural section of street not covered within limits given above will remain the same, crown slope will be variable within transition.

R-VALUE	COVER	STATION
40	21	1
	17.5	2
	6.5	3
64	25	4
		5
		6
		7
		8
		9
		10
		11
		12
		13
		14
		15
		16
		17
		18
		19

SCALE: 1"=150'  
 HORIZ. 1"=20'  
 VERT. 1"=20'

AGGREGATE BASE SCHEDULE

T1 = 7.0

REVISIONS			CITY OF RIVERSIDE, CALIFORNIA DEPARTMENT OF PUBLIC WORKS	
MARK	DATE	DESCRIPTION		
			S.S. PROJECT N°128	
			JURUPA AVENUE STREET WIDENING	
			BROCKTON AVENUE TO ELENOR STREET	
DESIGNED BY	SUBMITTED BY	APPROVED BY	PROJ. NO.	3074
DRAWN BY	PARK DEPT.	TRAFFIC DIV.	R-8886	
CHECKED BY	RECOMMENDED BY	DATE	3-3-65	
			SHEET 3 OF 3	

PROFILE		BY	DATE
NO.	REVISIONS		

PLAN		BY	DATE
NO.	REVISIONS		