

PROJECT NO.	808
SUBMITTED	
DATE	

DESIGNED BY	ROBERT L. TAYLOR
CHECKED BY	
APPROVED BY	
DATE	

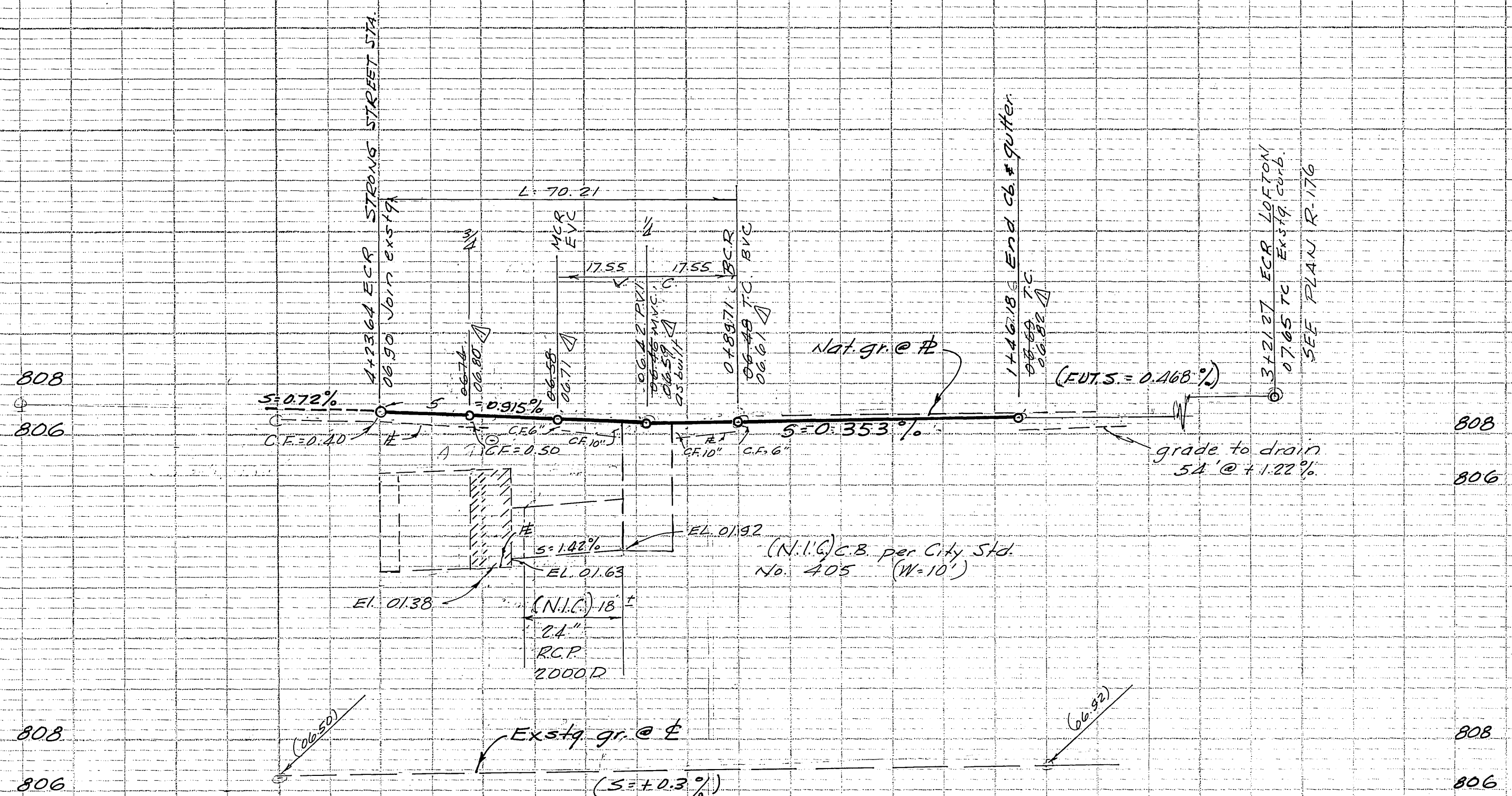

PROFILE  
HORIZ. SCALE 1" = 20'  
VERT. SCALE 1" = 4'

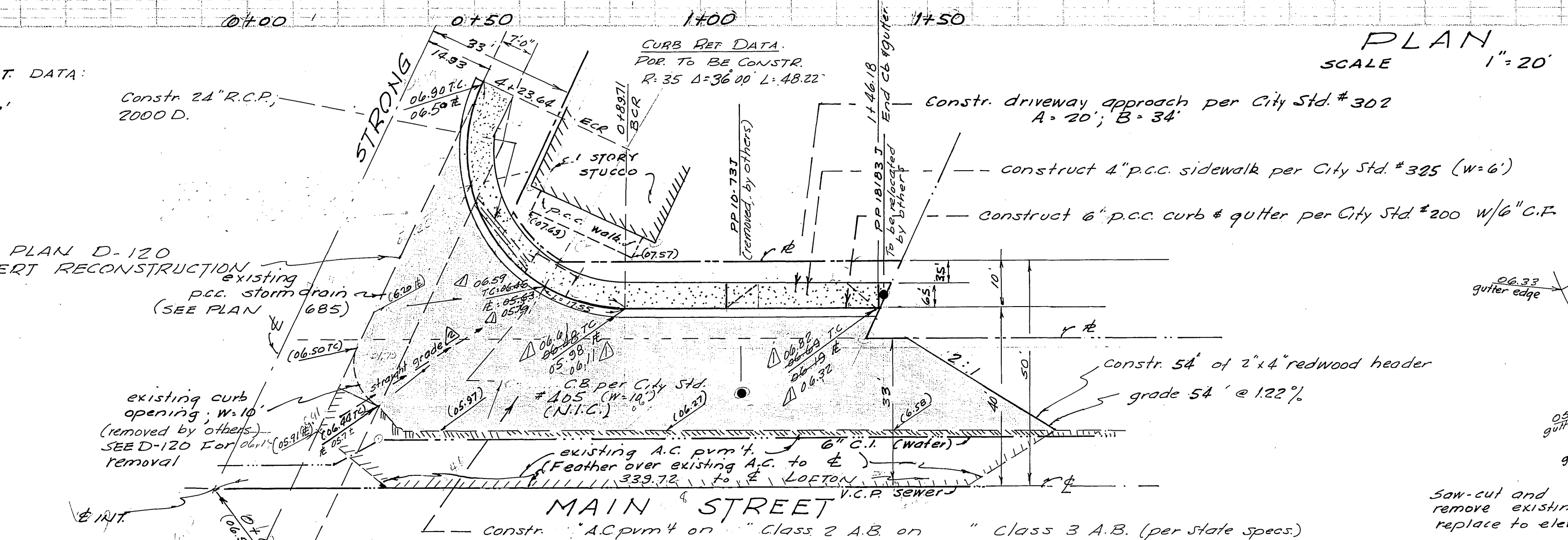

PLAN SCALE 1" = 20'

GENERAL NOTES

- All construction shall be in accordance with standards and Specifications No. 461 of the City of Riverside, Dept. of Public Works.
- Trim edge of existing paving to clean straight line. Construct match up paving and overlay existing pavement as directed in field to produce smooth crown section.
- It shall be the responsibility of the contractor to clear the Right of Way in accordance with the provisions of law as it affects each utility including irrigation lines and appurtenances and at no cost to the City.
- Prime Coat, Paint Binder & seal coat are required
- Grading will require a permit under Ordinance 3093 for a cut or fill exceeding 100 cubic yards or a fill over one foot in depth.
- Existing elevations shown thus (26.37)
- A Soils laboratory will take a soil test to determine the requirement on imported base material after the streets have been prepared to rough grade.
- B.M. 5+L in East curb Main Street, 10' North of E of Stansell Dr. U.S.G.S. El. = 808.40 per F.B. 474/60
- Limit of Developers paving responsibility is 20' from gutter. The Contractor shall contact City Engineer to negotiate construction of balance of pavement.
- The finished subgrade shall have a compaction of not less than 90% for a depth of 0.5 foot as determined by Test Method No. "California 216", immediately prior to placement of the cover.

CURB RET DATA:  
R: 35  
S: 114.57'  
T: 54.85  
L: 70.21

Constr 24" R.C.P., 2000 D.

CURB RET DATA:  
PAR. TO BE CONSTR.  
R: 35 D: 36.00 L: 48.22

Constr driveway approach per City Std. # 302  
A = 20'; B = 34'

construct 4" p.c.c. sidewalk per City Std. # 325 (W=6')

construct 6" p.c.c. curb & gutter per City Std # 200 w/6" C.F.

NOTE: SEE PLAN D-120 FOR CULVERT RECONSTRUCTION

existing p.c.c. storm drain (SEE PLAN 685)

existing curb opening, which (removed by others) SEE D-120 For opening removal

constr. AC pavement on Class 2 A.B. on Class 3 A.B. (per state specs)

saw-cut and remove existing gutter replace to elevations shown.

Detail of Gutter revision no scale.

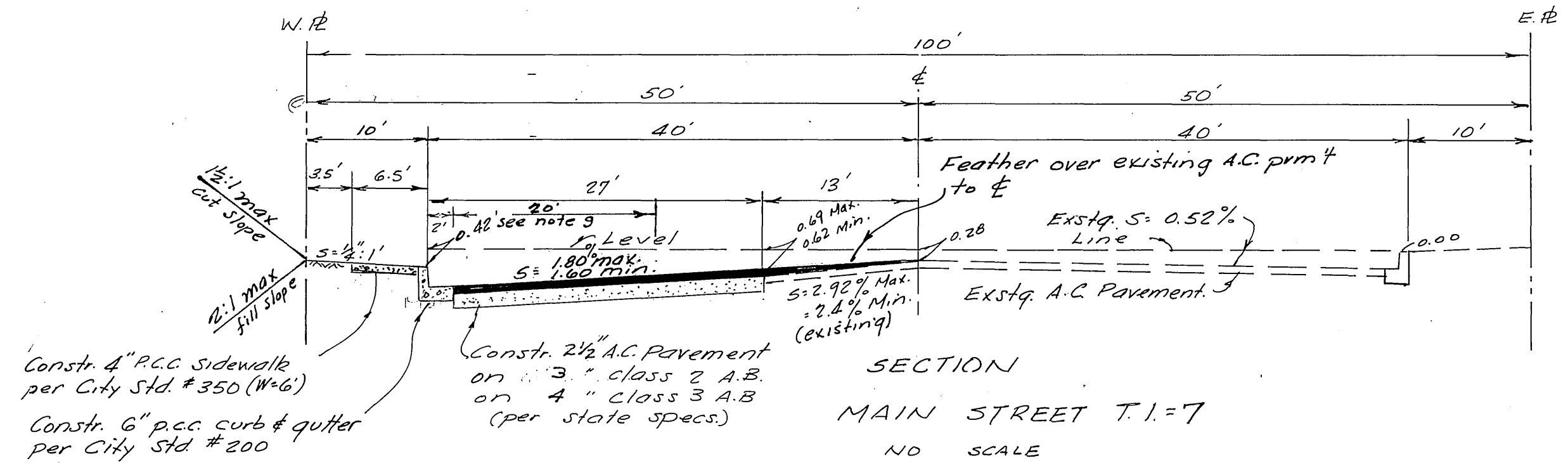

SECTION  
MAIN STREET T.I.=7  
NO SCALE

Constr 4" P.C.C. Sidewalk per City Std # 350 (W=6')

Constr. 6" p.c.c. curb & gutter per City Std # 200

Constr. 2 1/2" A.C. Pavement on 3" class 2 A.B. on 4" class 3 A.B. (per state specs.)

S.S. PROJ. 216

REVISIONS		
MK.	DATE	DESCRIPTION
1	9/18/65	Revise Grades to Conform with as built catch basin R.L.T.
2	9/18/65	revise gutter of as built catch basin with 9" R.L.T.

ROBERT L. TAYLOR  
CIVIL ENGINEER  
RIVERSIDE CALIFORNIA  
Approved: Robert L. Taylor  
DATE: RCE 10 4 70

CITY OF RIVERSIDE CALIFORNIA  
DEPARTMENT OF PUBLIC WORKS

PLAN & PROFILE  
OF  
MAIN & STRONG STREET  
INTERSECTION  
(Main Street from E Strong Street to 126.18' Northernly) R-55-612

DESIGNED BY: RLT  
DRAWN BY: RLT  
RECOMMENDED BY: RLT  
ASSISTANT CITY ENGINEER

APPROVED BY: [Signature]  
DIRECTOR OF PUBLIC WORKS  
DATE: 3-8-65  
SHEET 1 OF 1

R-920