

SWING TIES

HISTORICAL DATA
-CRFB 645/47

() - REC. DIST PER.
CRFB 645/47

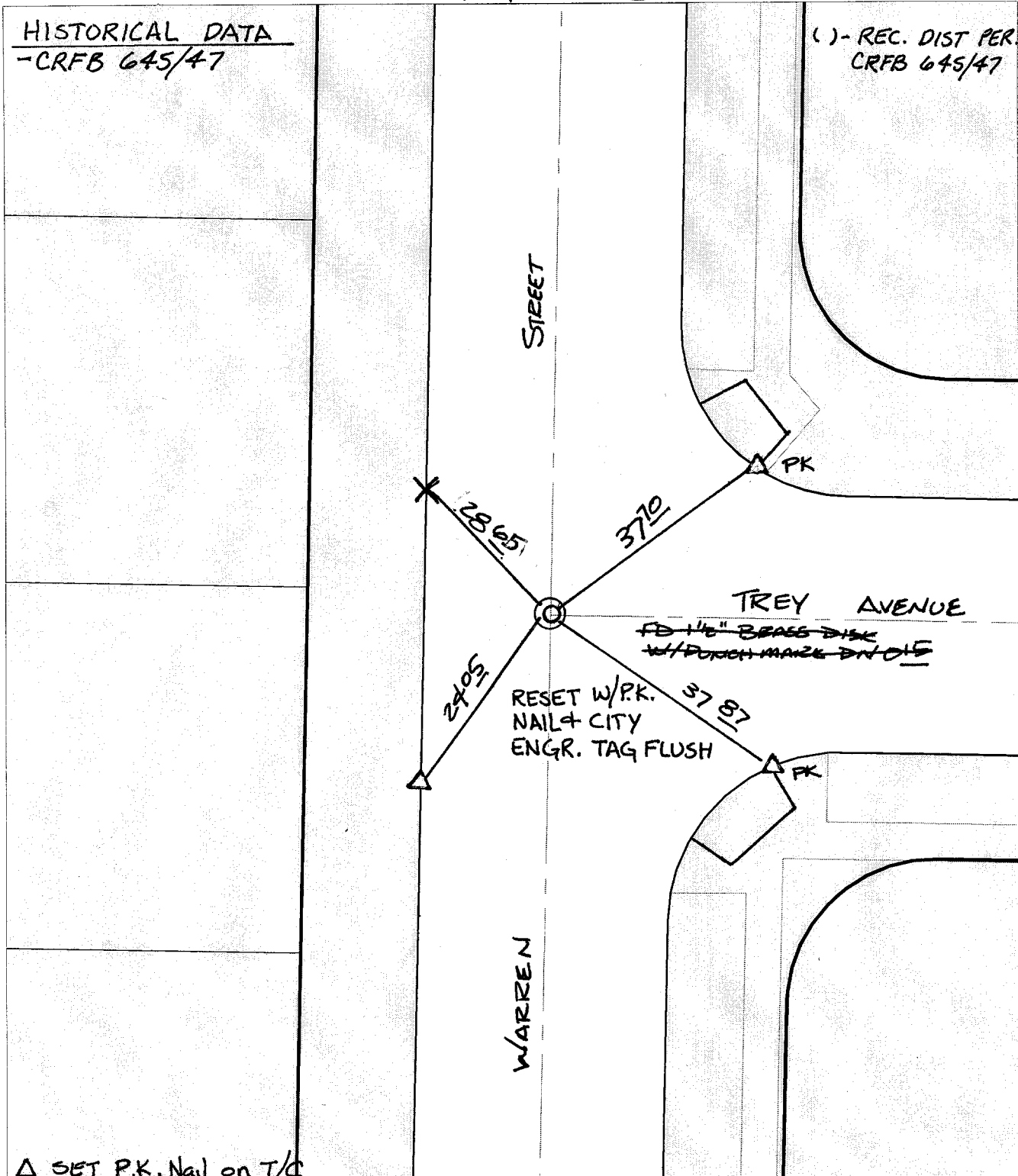

△ SET P.K. Nail on T/C

- × FD. Ramset Nail on T/C ● FD. LD. & TK. on T/C
- FD. "C" Nail on T/C ○ Set LD. & TK. on T/C

P.K. and City Engineer tag to be set @ surface after street construction is complete. (If possible)

Street:
C10020

WARREN ST
TIF

X-Street:
OFFICIAL USE ONLY

TREY AVE

Scale: 1" = 20'

Date: 10/22/01

Drawn by: survey

F.B.:

TR-Sec: T3SR6W-1

OFFICIAL TIE PLAT

CITY OF RIVERSIDE

These ties are for the purpose of perpetuating the found monumentation. No claim is made as to the relationship of the points or lines shown hereon to true boundary locations.



Sheet 1 of 1

Cadme MB: 50-7