

SWING TIES

HISTORICAL DATA

- MB 72/53-55  
- TIE SHT FOR TR4147

Street:  
C10029

MONTGOMERY ST

X-Street:  
OFFICIAL USE ONLY

ECS OF DUVAL PL

- ( ) - REC. DIST. PER TIE SHT FOR TR4147
- ⊙ - ~~FD 1" IP W/RCE~~  
9876 TAG FLUSH  
PER MB 72/53-55  
RESET W/ PK.  
NAIL & CITY ENGR.  
TAG FLUSH

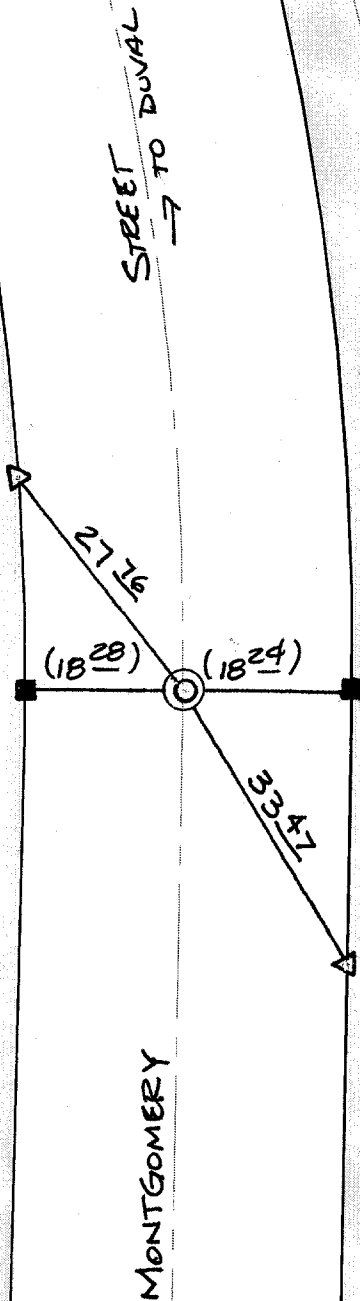

- ✕ FD. Ramset Nail on T/C
- FD. LD. & TK. on T/C
- FD. "C" Nail on T/C
- Set LD. & TK. on T/C

P.K. and City Engineer tag to be set @ surface after street construction is complete. (If possible)

Scale: 1" = 20'

Date: 10/22/01

Drawn by: survey

F.B.:

TR-Sec: T3SR6W-1

**OFFICIAL TIE PLAT**  
CITY OF RIVERSIDE

*These ties are for the purpose of perpetuating the found monumentation. No claim is made as to the relationship of the points or lines shown hereon to true boundary locations.*

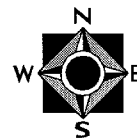

Sheet 1 of 1

Cadme MB: 65-2