

TRANSIT & SWING TIES

HISTORICAL DATA
CRFB 855/27
551/33
T = TRANSIT LINE

Street:  
10102

MOUNTAIN VIEW  
TIF

X-Street:  
OFFICIAL USE ONLY

HILLSIDE

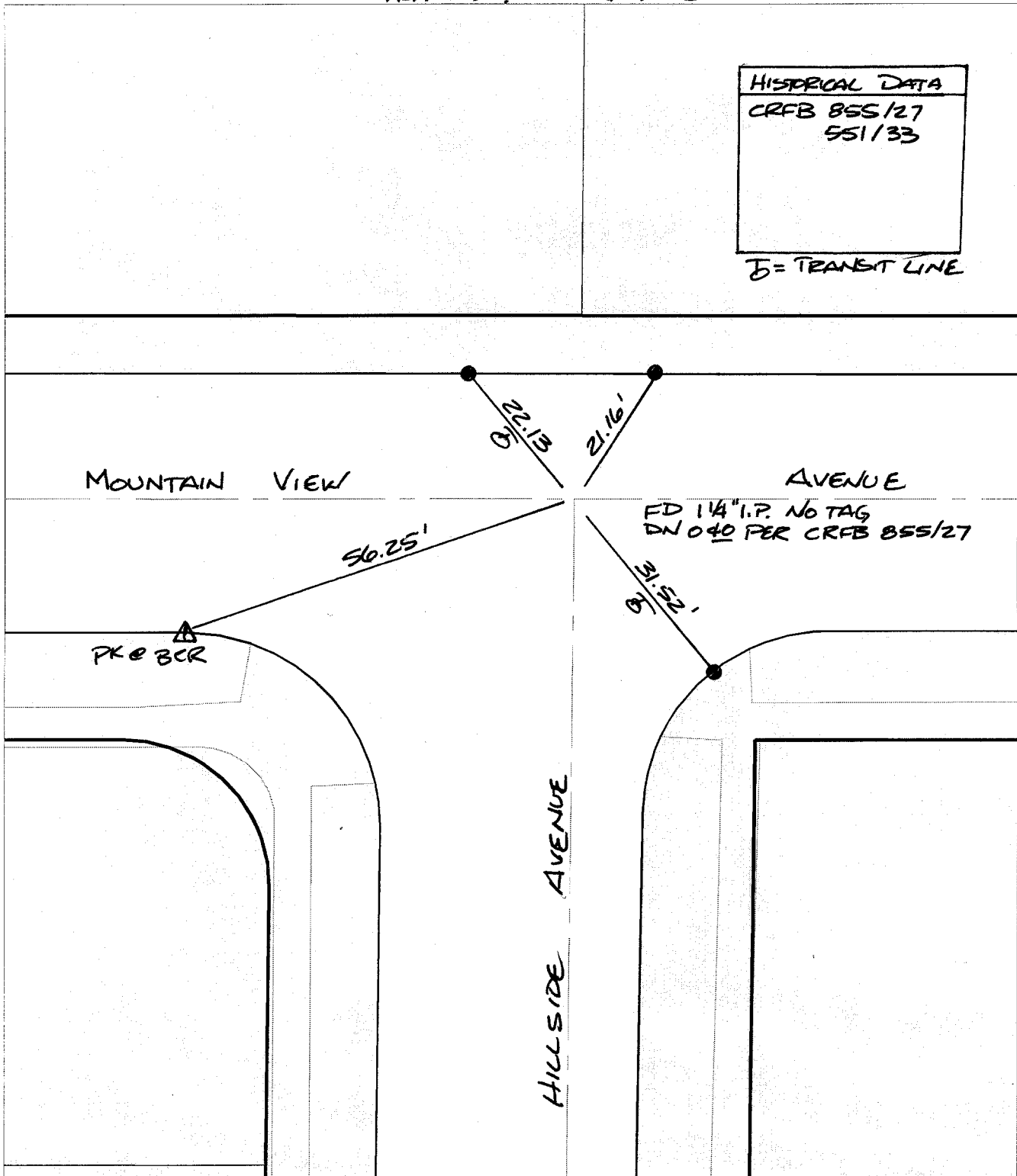

- ✕ FD. Ramset Nail on T/C      ● FD. LD. & TK. on T/C
- FD. "C" Nail on T/C      ○ Set LD. & TK. on T/C

P.K. and City Engineer tag to be set @ surface after street construction is complete. (If possible)

Scale: 1" = 20'  
Date: 03/11/02  
Drawn by: scurtis  
F.B.:  
TR-Sec: T2SR5W-32

## OFFICIAL TIE PLAT

### CITY OF RIVERSIDE

*These ties are for the purpose of perpetuating the found monumentation. No claim is made as to the relationship of the points or lines shown hereon to true boundary locations.*



Sheet 1 of 1  
Cadme MB: 37-7