

Street: MELROSE ST.

OFFICIAL USE ONLY

X-Street: S.E. OF CALIFORNIA AVE

10338716

HISTORICAL DATA:

CRFB 615/20  
FAGG SUB. MB. 3A/20

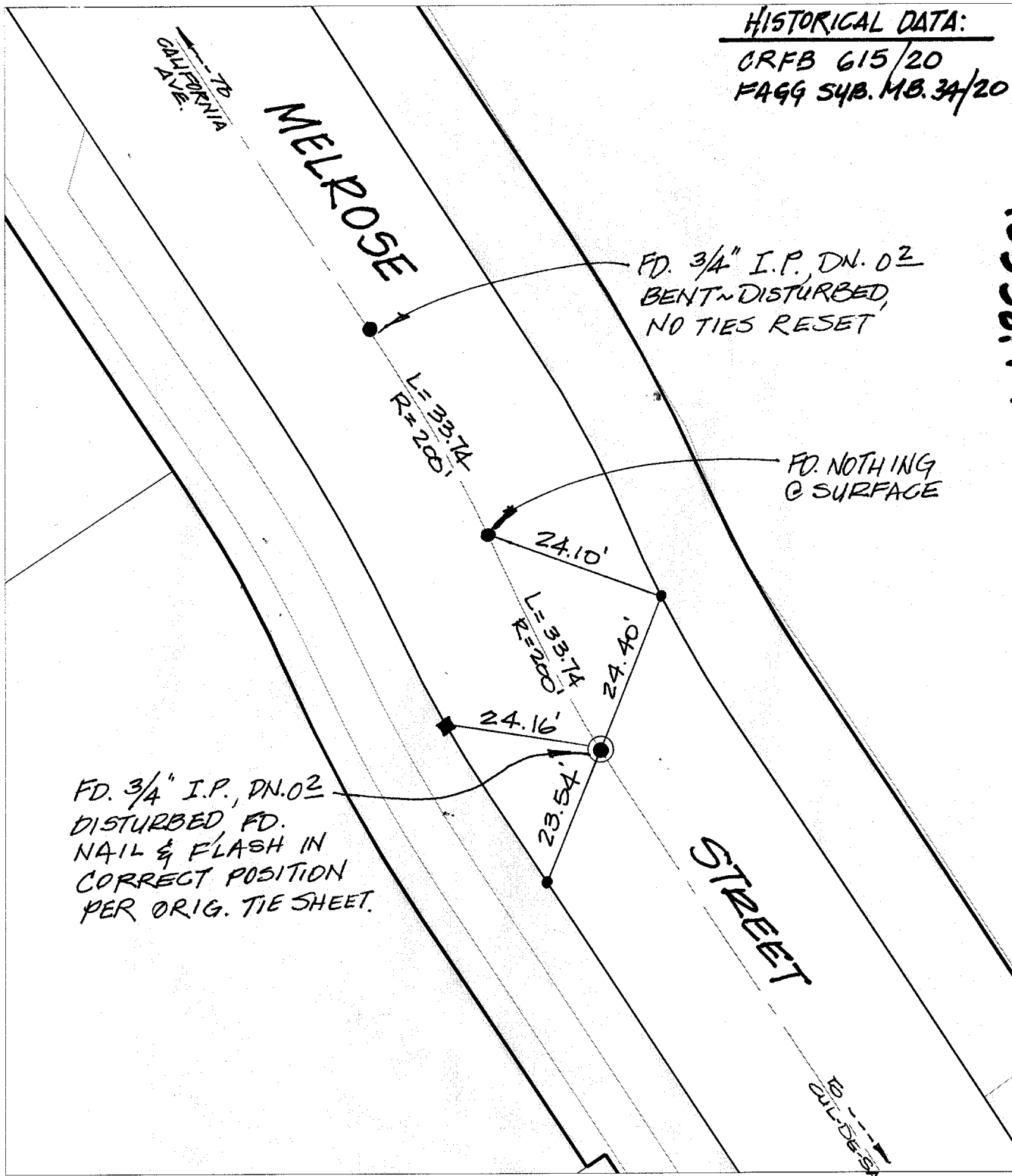

FD. 3/4" I.P., DN.02  
DISTURBED FD.  
NAIL & FLASH IN  
CORRECT POSITION  
PER ORIG. TIE SHEET.

FD. 3/4" I.P., DN.02  
BENT & DISTURBED,  
NO TIES RESET

FD. NOTHING  
@ SURFACE

- ✕ FD. Ramset Nail on T/C
- FD. "C" Nail on T/C

- FD. LD. & TK. on T/C
- Set LD. & TK. on T/C

Scale: 1" = 20'  
 Date: 08/23/99  
 Drawn by: L. Harris, KGE  
 W.O.:  
 F.B.:

**OFFICIAL TIE PLAT**  
**CITY OF RIVERSIDE**

*These ties are for the purpose of perpetuating the found  
 monumentation. No claim is made as to the relationship of  
 the points or lines shown hereon to true boundary locations.*



Sheet of  
 File No.: