

WINDY AVENUE  
AT  
RANDOLPH STREET



Street: **Crest**  
**10380 TIF**

X-Street: **Randolph**  
OFFICIAL USE ONLY

SWING TIES 7/7/97

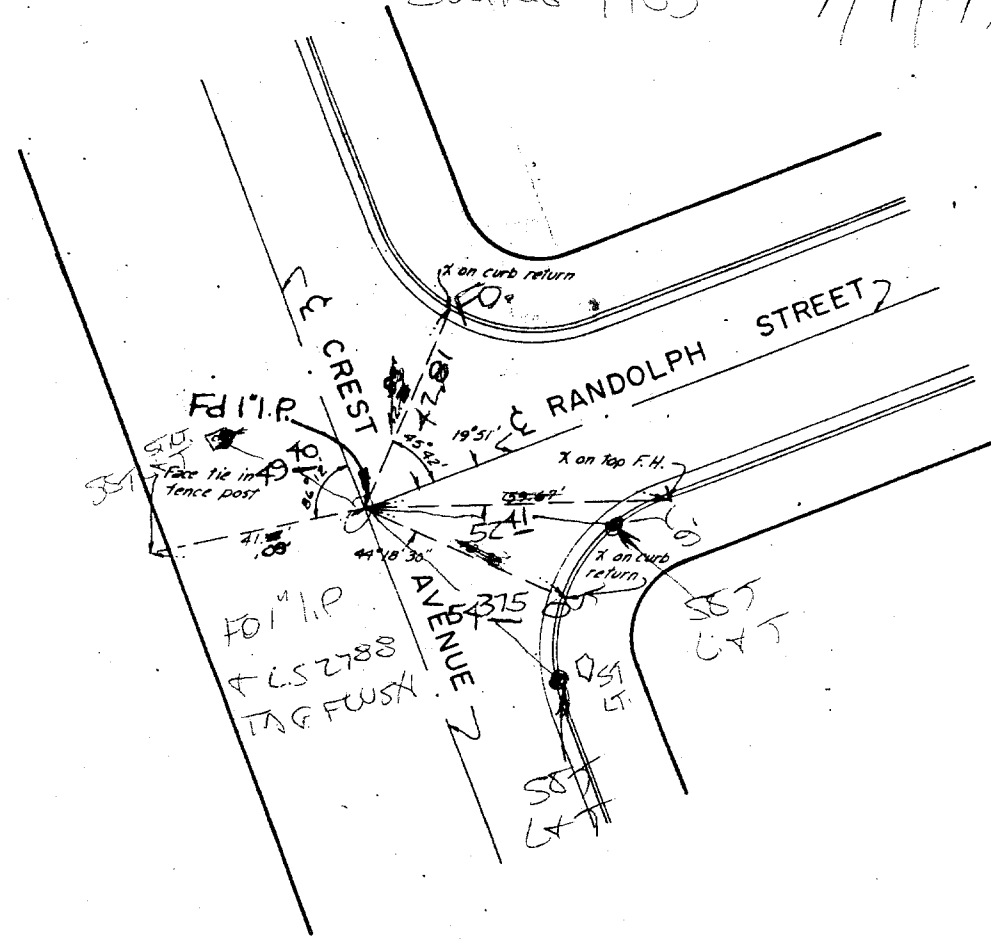

**CENTERLINE TIES**  
TRACT 3780

M.B. 59/69-70, Riverside County, Calif.

**MAXWELL & KING**  
Civil Engineers and Land Surveyors  
422 West 16th St., San Bernardino, California 92405

SCALE: 1" = 30' JOB NO. 68-3-4  
DATE: 6-17-69 DWG NO. A-63

✕ FD. Ramset Nail on T/C  
■ FD. "C" Nail on T/C

● FD. LD. & TK. on T/C  
○ Set LD. & TK. on T/C

Scale:  
Date:  
Drawn by:  
V.O.:  
S.B.:

# OFFICIAL TIE PLAT

## CITY OF RIVERSIDE

*These ties are for the purpose of perpetuating the found monumentation. No claim is made as to the relationship of the points or lines shown hereon to true boundary locations.*

Sheet 1 of 1  
File No.: