

BABB AVENUE  
 AT CREST AVENUE  
 TRANSIT TIES TO  $\pm$  MONUMENT

F.B. B-1/31

Street: **Crest**  
 10401.71F

X-Street:  
 OFFICIAL USE ONLY

**Babb**

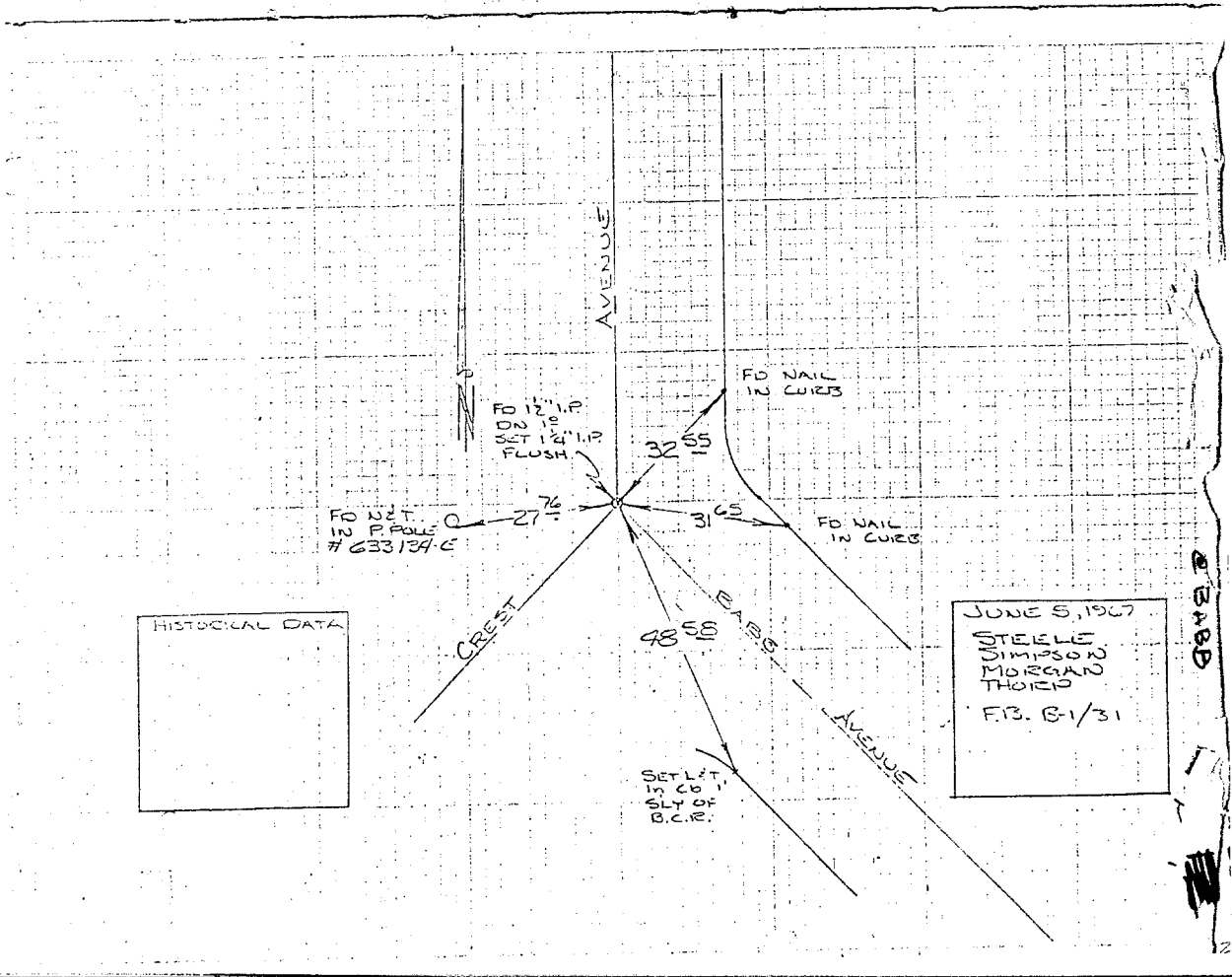

- ✕ FD. Ramset Nail on T/C
- FD. LD. & TK. on T/C
- FD. "C" Nail on T/C
- Set LD. & TK. on T/C

Scale:  
 Date:  
 Drawn by:  
 W.O.:  
 F.B.:

## OFFICIAL TIE PLAT CITY OF RIVERSIDE

*These ties are for the purpose of perpetuating the found monumentation. No claim is made as to the relationship of the points or lines shown hereon to true boundary locations.*

Sheet 1 of 1  
 File No.: