

Street: **OLIVEWOOD**  
10491.11E

X-Street: **KANE**  
OFFICIAL USE ONLY

Olivewood Ave.  
at Kane St.

F.B. 946/67

Survey  
Thorp  
Misson  
Jan. 15, 1971

Transit Ties

Historical Data  
R-1262 F/W  
E.B. 923/38; 58; 63  
R-1262 Construction

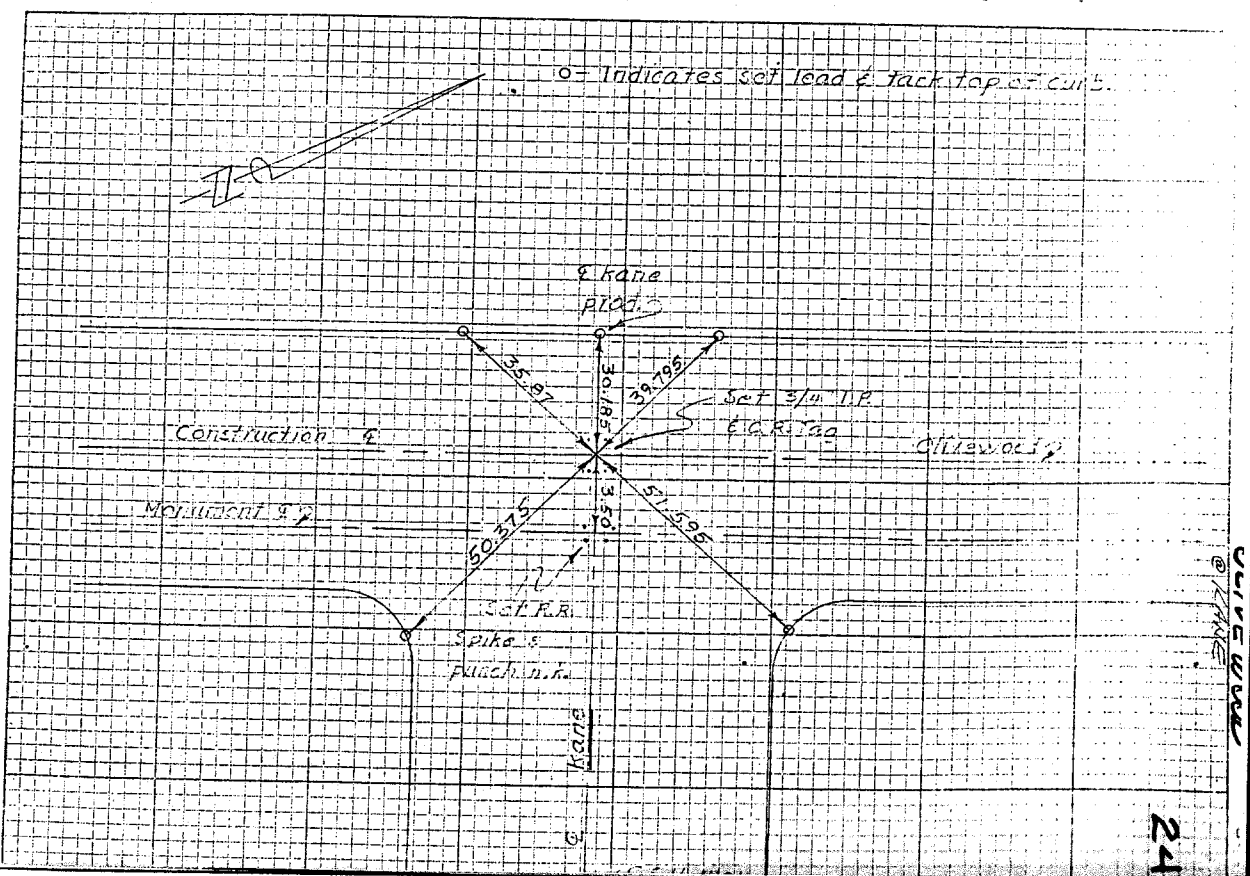

- ✕ FD. Ramset Nail on T/C
- FD. LD. & TK. on T/C
- FD. "C" Nail on T/C
- Set LD. & TK. on T/C

Scale:  
Date:  
Drawn by:  
W.O.:  
F.B.:

## OFFICIAL TIE PLAT

### CITY OF RIVERSIDE

These ties are for the purpose of perpetuating the found  
monumentation. No claim is made as to the relationship of  
the points or lines shown hereon to true boundary locations.

Sheet 1 of 1  
File No.:

24