

HISTORICAL DATA
 CRFB W-1/67
 CRFB 229/22
 CRFB 501/38
 CRFB 750/67

TRANSIT TIES

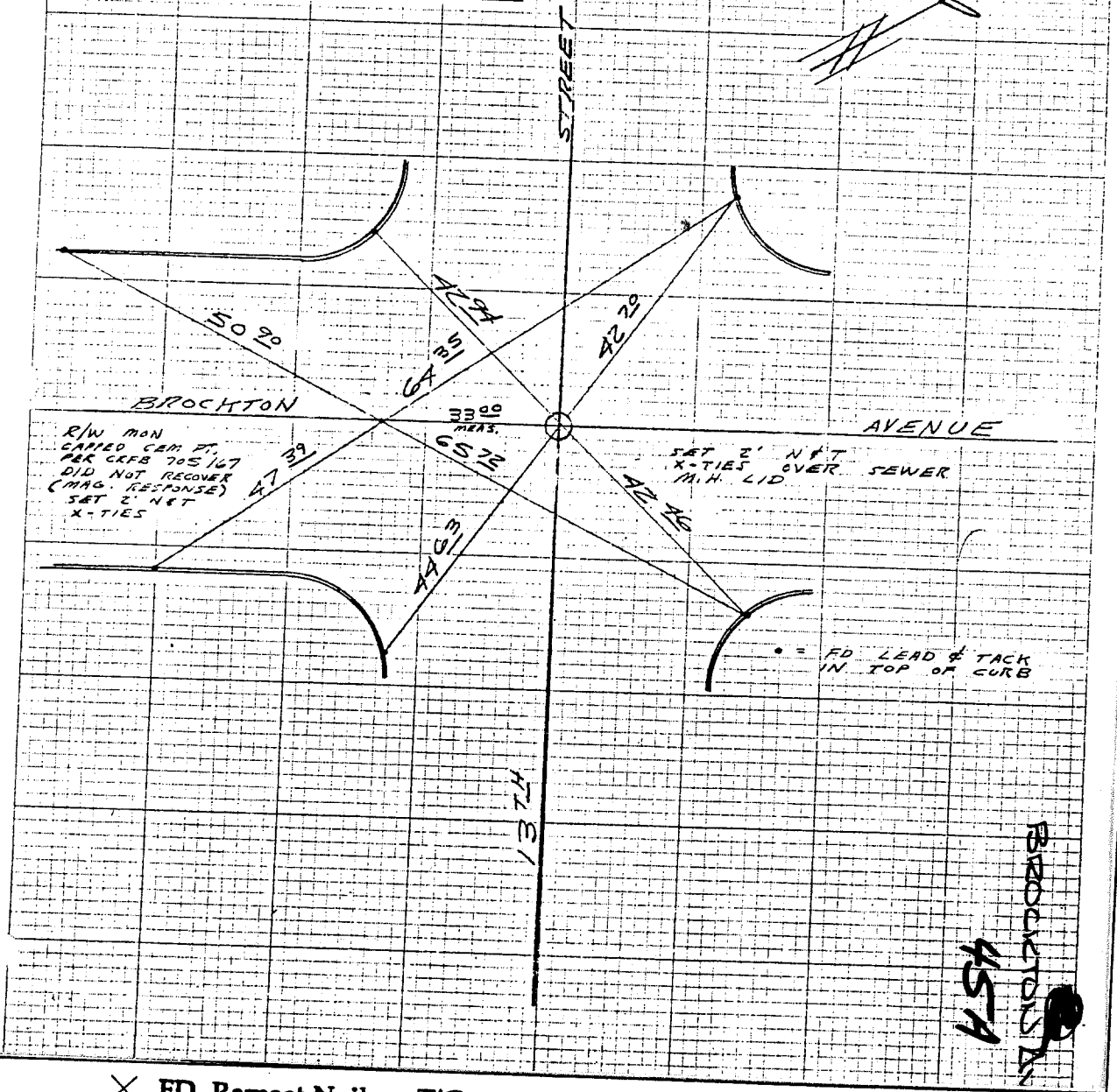

R/W MAN
 CARRIED CEM. PT.
 PER CRFB 705/67
 DID NOT RECOVER
 (MAG. RESPONSE)
 SET 2' NET
 X-TIES

SET 2' NET
 X-TIES OVER SEWER
 M.H. LID

● = FD LEAD & TACK
 IN TOP OF CURB

- ✕ FD. Ramset Nail on T/C
- FD. LD. & TK. on T/C
- FD. "C" Nail on T/C
- Set LD. & TK. on T/C

Scale:
 Date:
 Drawn by:
 V.O.:
 B.:

OFFICIAL TIE PLAT
 CITY OF RIVERSIDE

These ties are for the purpose of perpetuating the found monumentation. No claim is made as to the relationship of the points or lines shown hereon to true boundary locations.

Sheet 1 of 1
 File No.:

Street: BROCKTON AVE
 10570. THE
 OFFICIAL USE ONLY
 X-Street: 13TH ST