

10113.TIF

Street: BROCKTON AVENUE  
X-Street: LINWOOD PLACE  
OFFICIAL USE ONLY

TRANSIT & SWING TIES

REF.: CRFB 852/10  
484/12

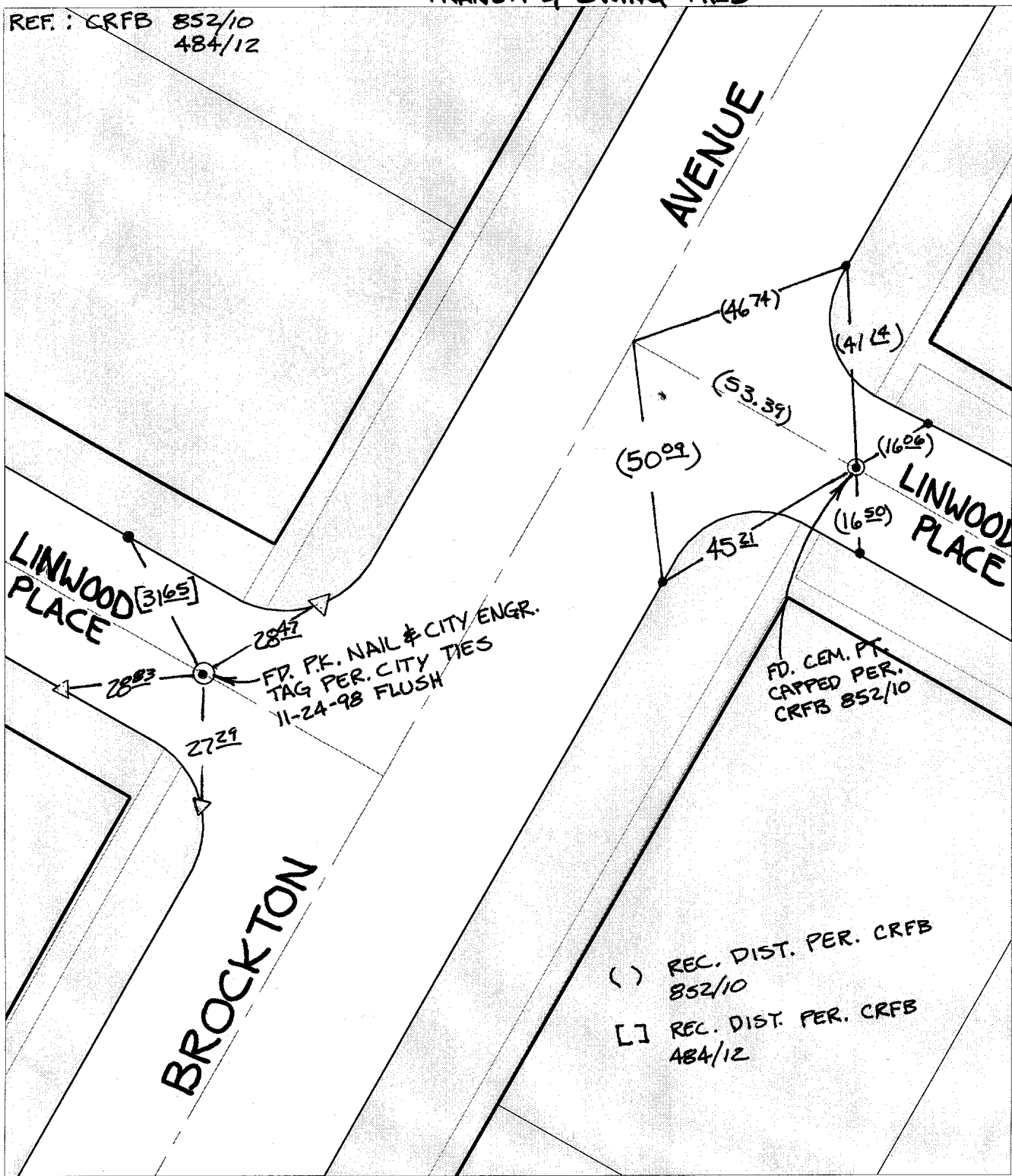

( ) REC. DIST. PER. CRFB 852/10  
 [ ] REC. DIST. PER. CRFB 484/12

- ✕ FD. Ramset Nail on T/C      ● FD. LD. & TK. on T/C      P.K. and City Engineer tag to be set @ surface after street construction is complete. (If possible)
- FD. "C" Nail on T/C      ○ Set LD. & TK. on T/C

Scale: 1" = 30'  
 Date: 09/24/02  
 Drawn by: SURVEY  
 F.B.:  
 TR-Sec: -

**OFFICIAL TIE PLAT**  
 CITY OF RIVERSIDE

*These ties are for the purpose of perpetuating the found monumentation. No claim is made as to the relationship of the points or lines shown hereon to true boundary locations.*



Sheet 1 of 1  
 Cadme MB: 38-6