

Street:
10754.TIF

KANSAS AVE.

X-Street:
OFFICIAL USE ONLY

TWELFTH ST.

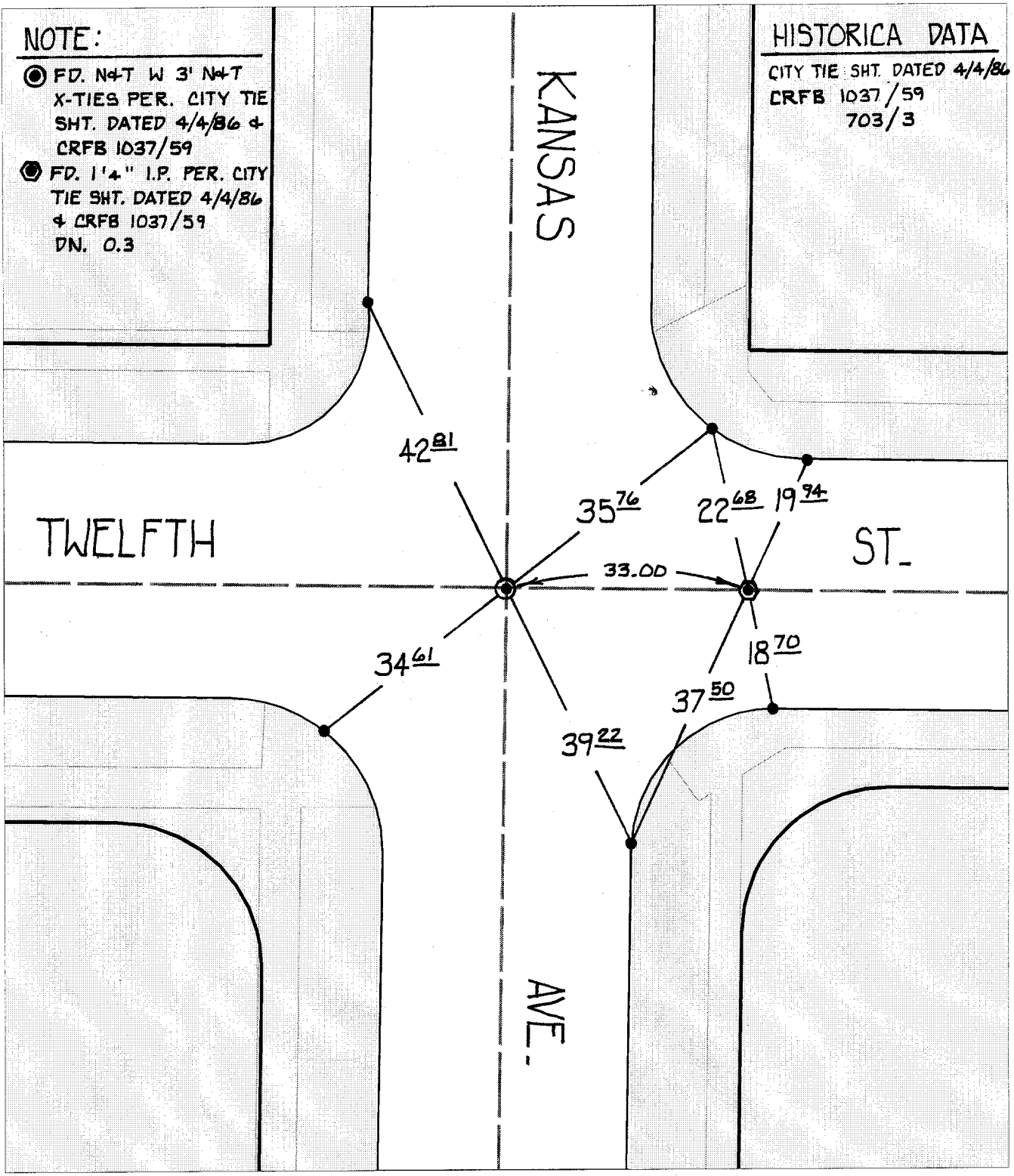

HISTORICAL DATA
CITY TIE SHT. DATED 4/4/86
CRFB 1037/59
703/3

NOTE:
● FD. N+T W 3' N+T
X-TIES PER. CITY TIE
SHT. DATED 4/4/86 +
CRFB 1037/59
● FD. 1'4" I.P. PER. CITY
TIE SHT. DATED 4/4/86
+ CRFB 1037/59
DN. 0.3

- ✕ FD. Ramset Nail on T/C
- FD. LD. & TK. on T/C
- FD. "C" Nail on T/C
- Set LD. & TK. on T/C

Scale: 1" = 20'
Date: 08/16/99
Drawn by: L. Harris
W.O.:
F.B.:

OFFICIAL TIE PLAT

CITY OF RIVERSIDE

These ties are for the purpose of perpetuating the found monumentation. No claim is made as to the relationship of the points or lines shown hereon to true boundary locations.



Sheet 5 of 5
File No.: