

SWING TIES

HISTORICAL DATA

CRFB 703 / 32
514 / 13

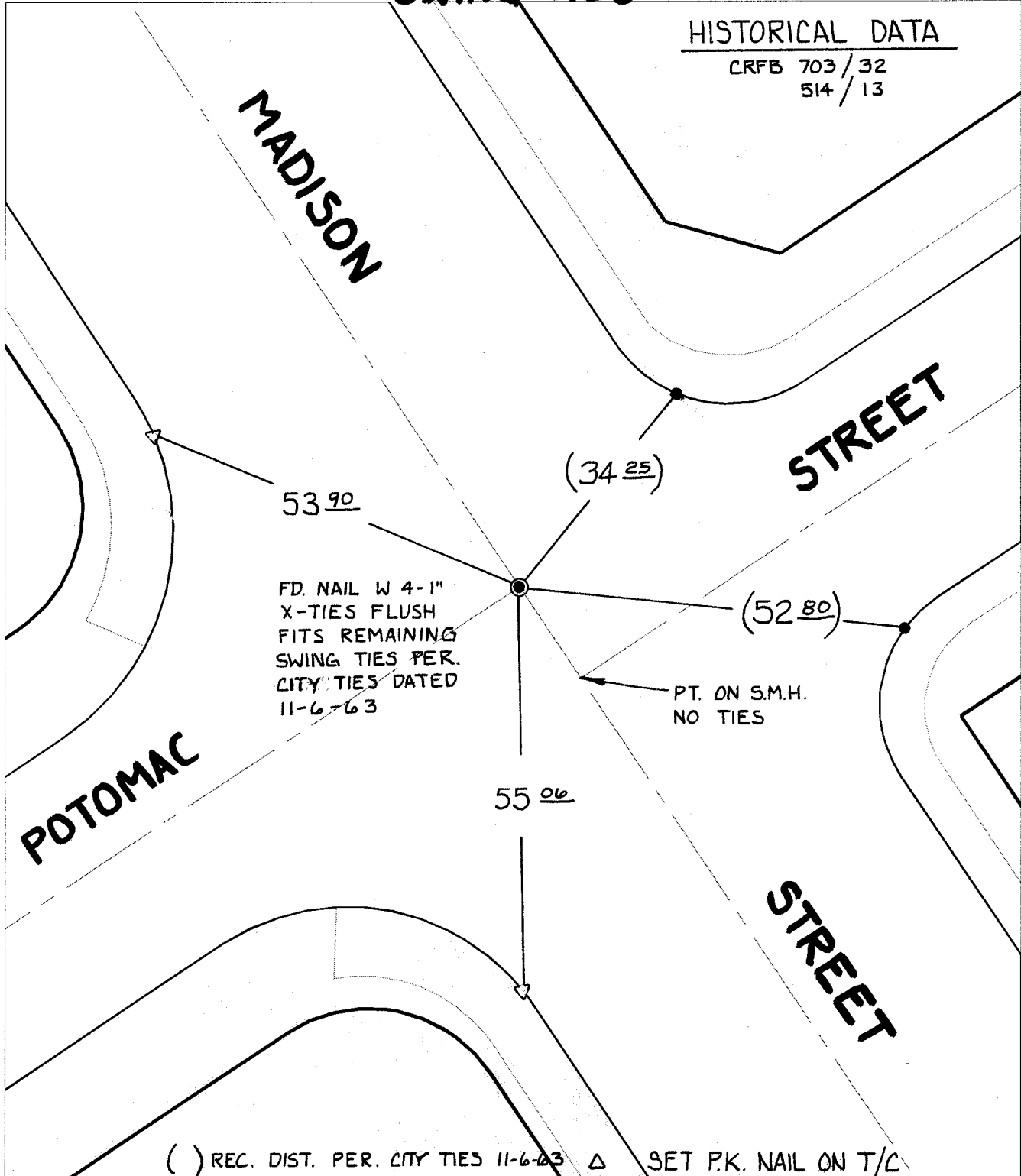

FD. NAIL W 4-1"
X-TIES FLUSH
FITS REMAINING
SWING TIES PER.
CITY TIES DATED
11-6-63

PT. ON S.M.H.
NO TIES

() REC. DIST. PER. CITY TIES 11-6-63 Δ SET P.K. NAIL ON T/C

× FD. Ramset Nail on T/C
■ FD. "C" Nail on T/C

● FD. LD. & TK. on T/C
○ Set LD. & TK. on T/C

Street: **10855.TIF** MADISON STREET
X-Street: POTOMAC STREET
OFFICIAL USE ONLY

Scale: 1" = 20'
Date: 01/24/00
Drawn by: SURVEY
W.O.:
F.B.:

OFFICIAL TIE PLAT CITY OF RIVERSIDE

These ties are for the purpose of perpetuating the found monumentation. No claim is made as to the relationship of the points or lines shown hereon to true boundary locations.



Sheet 1 of 1
File No.: