

11209.TIF

Street: VICTORIA AVENUE X-Street: TWELFTH STREET
OFFICIAL USE ONLY

TRANSIT & SWING TIES

() - INDICATES REC. DIST. PER. CRFB 1038/10

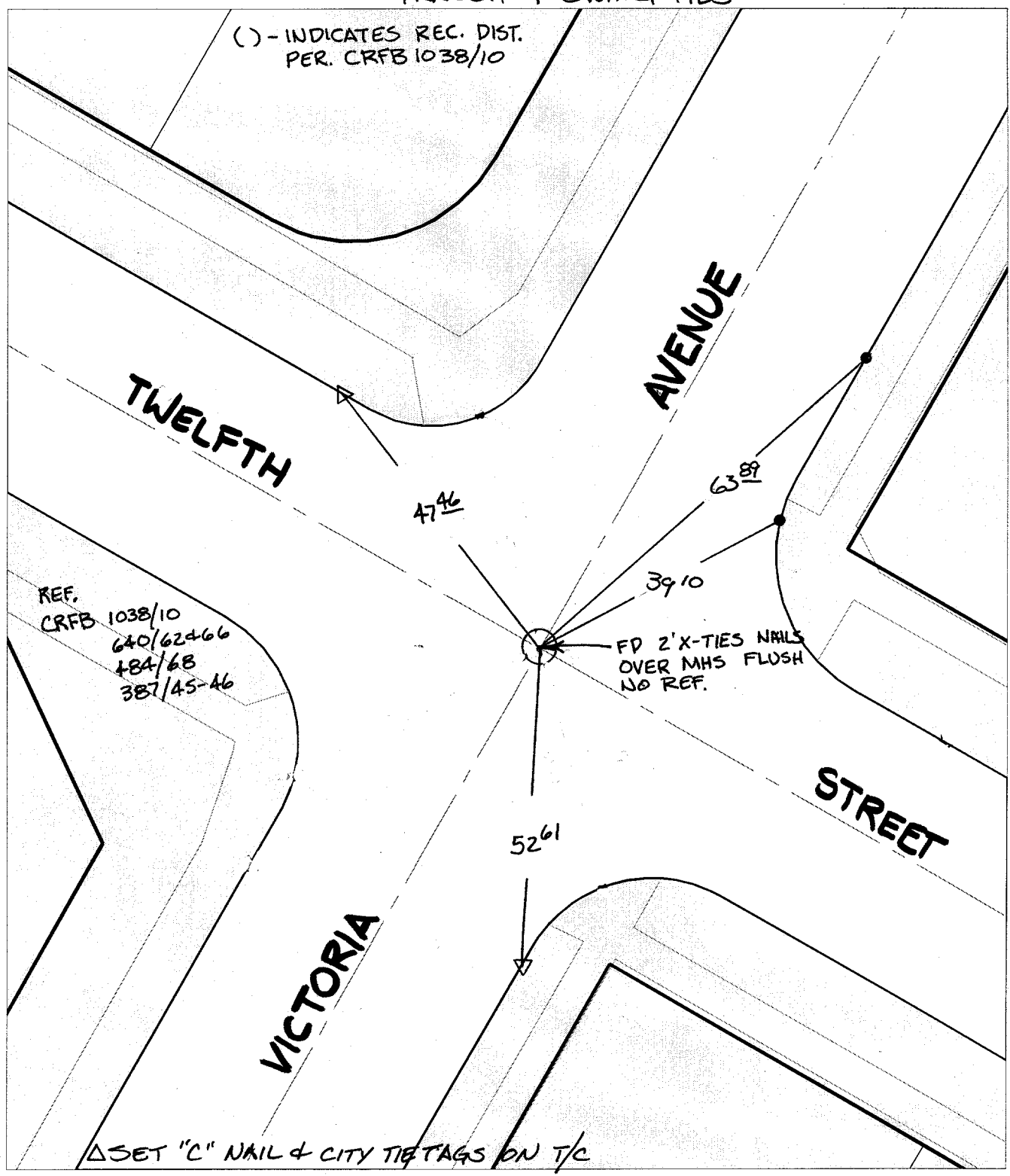

REF. CRFB 1038/10
640/62466
484/68
387/45-46

FD 2' X-TIES NAILS OVER MHS FLUSH NO REF.

△ SET "C" NAIL & CITY TIE TAGS ON T/C

- ✕ FD. Ramset Nail on T/C ● FD. LD. & TK. on T/C P.K. and City Engineer tag to be set @ surface after street construction is complete. (If possible)
- FD. "C" Nail on T/C ○ Set LD. & TK. on T/C

Scale: 1" = 20'
 Date: 02/14/03
 Drawn by: SURVEY
 F.B.:
 TR-Sec: T2SR5W-25

OFFICIAL TIE PLAT
CITY OF RIVERSIDE

These ties are for the purpose of perpetuating the found monumentation. No claim is made as to the relationship of the points or lines shown hereon to true boundary locations.



Sheet 1 of 1
 Cadme MB: 40-3